

If found, Please
return to
Charles Booth
9 Oldelphi Terrace
Strand

Police. 13.R.

B 363

Districts 31. 34.

PARTICULARS FOR ORDERING A
REPETITION OF THIS BOOK.

No. 16079

ROBINSON, PICKERING & HUNT,
9 & 10, ST. DUNSTON'S HILL, E.C.

If found
Please return to
Charles Booth
9 Adelphi Terrace.
Strand. W.C.

COLL U

B 363

[i]

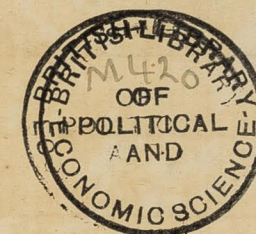

Police Officer.	Division &c.	District	Ecclesiastical Parishes	Page
Inspector Green	L Division - Kennington Lane.	31	Part of St ^e Thomas, St ^e Paul & St ^e Jude.	1
Sergeant Saltmarsh	" " Kennington Road.	31	" St ^e John & All Saints	27
" Waters	" " " "	31	" St ^e Andrew, St ^e John, St ^e Thomas & Christchurch.	47
" O'Dell	M Police Division, Boro' High St ^e .	31	" All Hallows, St ^e Alphage & St ^e George the Martyr	87
H. Barton		31	" St ^e Peter, Christchurch & St ^e Saviour.	115
"		31	" All Hallows, St ^e Michael & St ^e George.	127
"		31	" St ^e Peter, St ^e Saviour & St ^e George.	143
Misses Sewell, Gow &c.	of the Womens University Settlement	31		187
Inspector Green		34	" Trinity & St ^e Mary	191
Sergeant E. Sales		34	" St ^e Mary, Emmanuel, St ^e Mary the Less, St ^e Peter, St ^e Anne & St ^e Mark	223

District covered.

N.

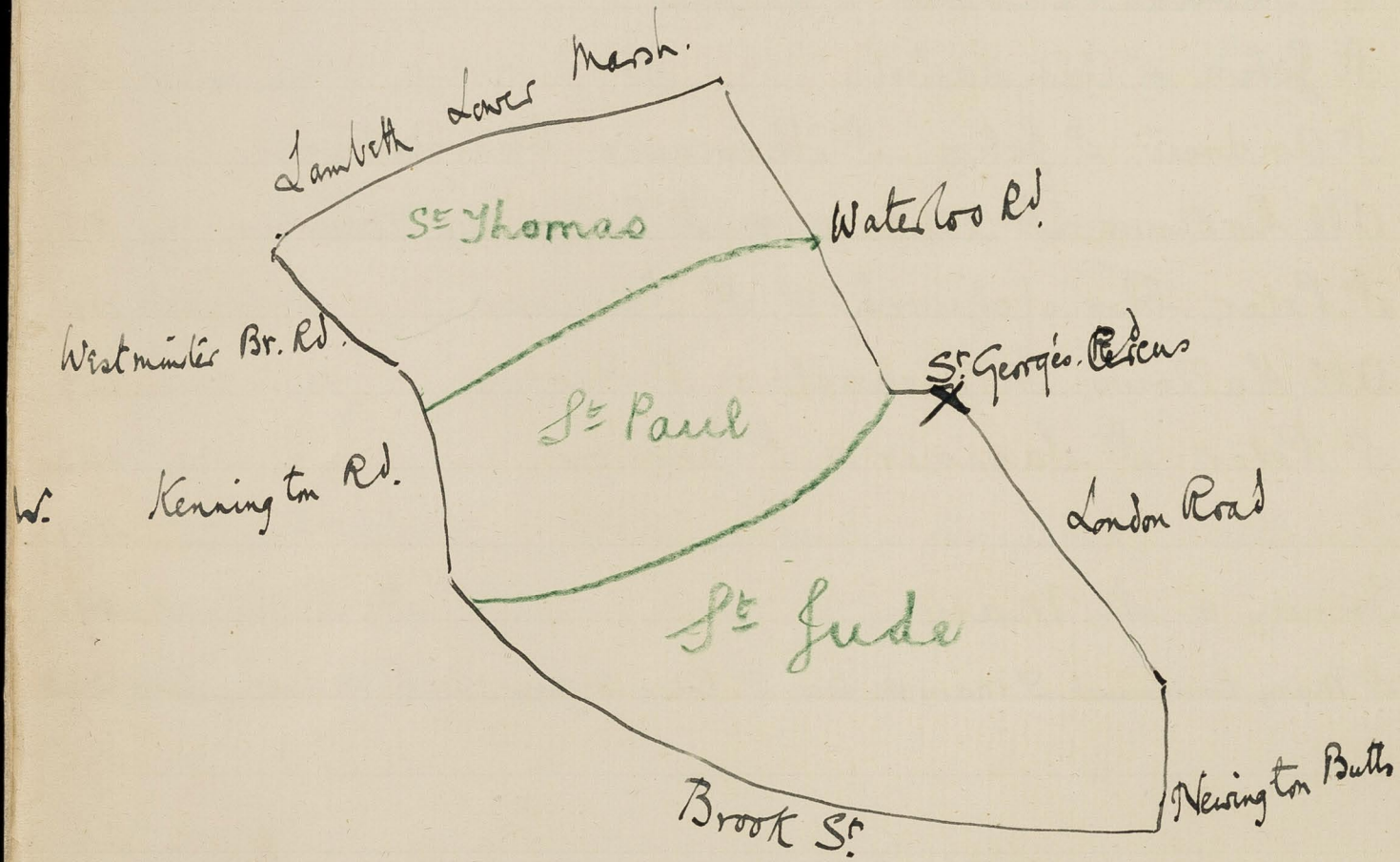

E.

S.

Dodson St. - l.b.^o

April 25th, 26th 1899 **Dist 31** 31 / 8 G.H.D.

with reserve Inspector Albert Green round district bounded on the North by Lambeth Lower Marsh, on the East by the Waterloo Rd, St George's Circus, London Rd & Newington Butts: on the South by Brook St & on the West by Kennington Rd & Westminster Bridge Road: being part of the parishes of St Thomas, St Paul and St Jude.

Inspector Green is a fat man rather over middle height, jovial raticund face, ^{fairmoustache} has been 26 years in the Force & seen service in the Dray Lane District & Notting Dale (3yrs). He has been in this Division over 6th year.

Starting at ~~base~~ St George's Circus: walking Westminster Br. Rd: N up to Dodson St. (late Dale St). 3:25st: some very poor at the S.W. end & in the centre of the E side: mat

Suke St.

very poor.

most of the E side already down & all to come down when
 leases fall in : windows & curtains broken, patched
 dirty, bread in street, cotes burrow, & two
 mattresses lying in the muddy road : a few thieves
 & prostitutes : one of the worst places in the
 Division but not to be compared with Bangor
 St in the matter of vice : lb barrow rather
 than Black of the map at the N corner of Webber
 St & Dodson St are Quinns Bldgs 6st: look poor:
 well kept inside : lb to purple in map purple : on the
 W side opposite Quinns Bldgs Dodson St is
 v poor : E along Webber St, N up C.
Falka Place. late Ann Place: houses on E side
 closed, the W side is Quinns Bldg: lb of map goes
 W along is

Jones St. : 3st : many small shops: better than
Suke St : laboring class above : many windows
 broken & patched : doors open but all with
 a bit of floor cloth or matting : rough looking
 hatless Irishwomen about, but many fairly
 comfortable, bread in st : 4 lb loaf selling in
 one of the shops for 4d : lb : in map lb : out
 of

Jones St.

Lower Street - lb

Gerridge St.

Gilberts Court - db

Gerridge St^e NW end db
SE --- lb

Pearman St. pink.

Pearman St^e - E end lb

of the E end N side is c.

Gilberts Court : 8, 2nd houses: very poor estates: db to lb.
not shown in map: W along Tower St. S down c.

Gerridge St. late Charles St. Jubilee Bldgs make the
NE side: a large block: courtyard well kept: trees.
that part facing webber St. looks poorer than the
rest: ch: clean, well dressed. pl to pas. in map pt.

Gerridge St. itself is lb & set on NW: unmarked in
map: the E side S of webber St. is marked by both
3rd: purple as map: at the corner of the Westm
Br Rd are 4th St Bldgs, working class: purple^{6th}
in map red: the W side of webber St. is taken up
by School exc 1 up poor house db if marked: E to W
along c.

Webber St. : poor, like Tower St. : lb to pas: in
map lb: No lb row E of Jubilee Bldgs on N side.

N into Gerridge St: W along Tower St of its NW end is

Short St. : 3rd: lb as map but inhabited on E side
only: N into c.

Pearman St. : resp: mechanics: dull 3rd, yellow brick
houses: many police from A & L Divisions: it is
now continued as a street eastwards to the db

Mary's Bldgs - lb

Robert's Place - lb

Robert's Place : out of NW end of
Janwell St. : 6. 2nd houses, flowers
at windows : cotes : lb to pur :
in map purple.

Small streets south of Oakley St.

of map : the continuation is like the rest & pink :
the lb. is now better : ^{2nd} some fairly comf at N &
one or 2 still very poor : altogether lb. : N up
Mary's Buildings : 2nd : lb lab : cement paved :
clean : one family to a house : lb to pur : in
map purple : 2 to co

Janwell St. late Isabella St. : 2nd some
with basement : better than Mary's Bldgs :
purple as map : E along co

Thomas' Place : 4 house on N & 2 on S. 3rd.
poor : lb : in map pk : it is continued
E of Coral St. with 5 houses on S side only
lb : in map pk. S down co

Little Thomas St. : narrow : flagged passage :
aly 9 ft between house & house : old in labs
at N end : very poor at S end : N end is
still purple : S is lb to lb : children clean
& well dressed ex stockings & knickerbockers
of the boys ragged : ? mark the whole lb.
E along Whitin St. & N up co

Coral St. : Built 1820. 2nd some with base-
ment : purple as map : W along Oakley
St.

Streets off the South Side of
Lambeth Lower Marsh.

Johanna St. N of Oakley St. db
S —" lb

Grundal Street - db

Oakley St. : 'has a bad reputation for roughness & prostitutes but Green has never been able to understand why: pk & purple as map. it is a 3 storied, woodpaved street. There have been brothels in it: S down c.

Johanna St. : cul des ac, mud, puddles, children playing in them; 2st + attic: many windows broken but oil cloth in all the passages, most doors open: lb to par: in map purple: N of Oakley St. Johan
It is poorer: lb to db: W along c.

Grundal St. late Harriet St. : rough, low class Irish; like Duke St. all doors open: broad etc street full of women & children: [though this is a poor district all the children are remarkable for their clean faces] db in map lb: N into c.

Lower Marsh. : very busy, shopping street, barrows all along the N side: Groves large clothing estab on S side: 3st: pb! to tal in map pb!: S down c.

Frazier St. : at of its E side is a small court (N of Gloucester St.): 8 houses: 4 on N & 4 on S: only 4ft

Corsham Place - db

Streets out of Side of
Lower Marsh.

Frazier Street - lb

4 ft between the houses: very poor, old people; lb: not shown in map: it is called Corsham Place. late Paved Place. The East of General St is called C

General St: ~~does not~~ is in map

Frazier St: it self has small poor shops: lb: in map purple: $\frac{2}{3}$ W along C

Murphy St: late Charles St: working class: 24th. 4th Bldg at NW end: crowds of children: hatless, clean faces: lb: both: in map lb: at of the SW end is a court called C

James' Place: 7, 2nd house: only two rooms to a house: rents 5/- for old tenants & 5/6 for new: lb: both in map lb: at it W end

Murphy St: turns south, W Hann's the great theatrical scene painter's studio is on the W side: & N of it are 2 houses: lb: not

shown in map: S into Oakley St: W along Oakley St: to Westminster Bridge Road: N to Lower Marsh, 2 & S into C

Lambeth Square: 3rd St: small neglected square

Burdett Road S side - lb + db

Streets off the S side of
Westminster Bridge Rd.

Sanfranc St - lb

Barkham Terrace - pk b^d

Square grass trees no flowers in the center: one
takes the house & lets off: Tallyman going his
rounds: pk as map: W into West Br. Rd
& South - turning E at c.

Burdett Road: Burdett Bldg on N side best:
purple: Bldg on S side rather poorer lb:
both go up to the corner of the West Br. rd:
on S side of Bldg are 2 poor rough: 2 poor
houses: db: S to c.

Sanfranc St: 3^r 2st: at the E corner of
Dartlett Rd Sanfranc St is a best house
for all the world like a dwelling house exc
for small lettering over door: this street
is poor: many women have workers, some
of machines: but lb rather than db
of map: E along West Br. Rd & Stan

King Edward St: quiet: semidet on W side:
front garden: apts: pk to pk b^d: one or two
servants: Suite R for Lambeth Rd. the
houses on the N side are called c.

Barkham Terrace: 3rd st: dingy outside: saw
servants: Capt. of A Police Div. lives here: in
the

Jones St.

Black as map.

S. George's Road - pk b²

Lambeth Road - pk b²

in the center is the Upm Baptist Chapel:
 pth road: in map red: it up c.
S. George's Rd.: wood paved: 3: st on W side:
 R.C. Cathedral on E with a house for resident
 priests N of it: pth road: E + S on
Babel St. late Jones St.: 3rd houses both sides.
 the 'worst street about here': no common lodging
 houses but thieves & prostitutes: windows
 broken, patched, stuffed, all doors open,
 no oilcloth or matting in the passages:
 Irish cockneys the majority: port go out
 to Clapham Common don't bring men home.
 'no strong feeling against them in a street
 like this': some flowers in windows: children
 with dirty faces, sore eyes, torn socks,
 hatless: compares with Bangor St: exc
 for the absence of lodging houses & the
 rows here are family rows & not against
 the exercise of authority: police rarely
 hurt: 6 roomed houses, built 12/14.
 Black as map: E along c.
Lambeth Rd.: pth: many without servants:
 in map red: Wally

Whitehorse Yard - purple

Deterioration: W of London Road.

Garden Row - purple

Burman St^e - lb + db

W along West Br Rd: at of S side is
Whitehorse yard: in a private stable yard.
 foreman & washer living above on S.W side & SE
 side only: purple: in map St: E & S from
London Road: bag shopping st: enter:
pt row: in map rd: W at cs
Gladsome St: 2: st. clocks: no servt: some
 mechanics: all go to their work over the water
 no servants: br & scullery: rent £36 to £40 +
 rates & taxes: subletting by one & 2 room:
 rents 6/- to 8/- for 2 room: a large family of
 children w^d not be allowed in these houses.
 the schools of N. side Lane have taken in
 the W end up to the point where the street
 turns abruptly South: ^{pt} St & St up.
Colin-brook St (late Richmond St): like Gladsome
St pt cs map: S from cs
Garden Row: many poor: new 30t flats on
 W side pt: but the whole st: purple to lb: a
 little better than Fove St: in map. pt:
St & St up cs
Burman St: poor & very poor on E side: new ho
 'but

but poor on NW: most of W side taken up by
 new Basford which runs through in to garden
 row: et hdb. in map black: it is a two
 storied st. inhabited by centers, rough, low, not well
 the old houses on the E side let 4 room for 10ft
 12ft. the new on the NW. 25 for 15ft. ~~to~~ S side
 Marshall Street: 20 21: quiet: labourers
 working in mauldags: purple both: in map
 for R: E & N up to

Jaywood St.: 31st: sublet: date dark
 rather narrow: a few poor: rents 36 to 38
 two top floor rooms rent for 6/6
 2nd _____ 7/-
 1st _____ 7/- (these

are more convenient than the other to get
 at but the passage has to come out of
 their side so the rent is the same as for
 the first floor] - the house tenant lives in
 the basement: each floor back room is
 fitted with a range for cooking: washing
 is done in the copper in the basement which
 is common to all: washing days are by
 mutual

Marshall Street - purple

Jaywood St.

mutual arrangement, by floors: ^{pk to pur. in map pk} E & S down
 Princess St. : like gaywood : cobbles paved :
 pk to pur. in map pk : the passage out of the E
 side has one poor (lb) house on N side only :
 W along St George Rd & South down c.
 Ely Place : a few houses : 2nd : on S side only
 pk in map pk : E into c.
 West Square : ^{3rd & 4th} the East side keeps a few
 servants & is pk as map : the rest rather
 pk : messy square : Great deal of loose
 paper : out of the S side is c.
 Austral St. : girls home on W side : pk
 in map purple : out of the S E side ^{of the square} is c.
 Orient St. : rather rough : mixed : badly
 mended road : purple both in map pk :
 that part which runs due E is also
 purple both in map pk : the lb shown
 in the passage leading to Stables St. has
 It up West square the houses standing back
 on the NE side are pk as map : N up.
 West St. : no houses exc 1 cott, a publicho
 on the W side : pk : E along St George Rd

Ely Place - pk

West Square

West Square (exc. E side) pk

going down.

Austral Street - pk

Orient Street - pur.

Hayles Street - purple

Lamlash Street - purple

Elliott's Row - pur

Oswin St. : also at Gates St. 10/1

St John's

Hayles St. : 2 + 30ft : good proportion of poor
Some ladies here who work the Elephant.

Some new pk houses on the NE side but
the whole purple : in map pk : ~~at~~ ^{along}

Lamlash St. late John St. : some police : 2 very poor
houses on N side : these shd be ok & the rest pk or

the whole purple : houses on both sides : pk in
map : N up C

Elliott's Row. : ^{to} map SE but less of it
above on the E side are new Buildings.

Hayles Bldg : 5st : pk : the W side is
not so good : purple in map pk : E + side

~~Dun~~ St. late Temple Street : 4st : quiet
fairly comfortable : pk to ^{in map pk} the SE end

shd be ok in map purple : This & the
preceding streets belong to a Mr Geels

who started life as a labourer & now
owns a great deal of property here & in

Dalwich. : E along St. George's Rd the
corner is all taken by Rabbits' factory

only a caretaker sleeps : there is no pk
behind

Changes.

General Remarks. Green said that the change of the last 10 years had been from bad to better & from best to less good: the bad streets are not quite so bad as they were, the good streets are not nearly so good: Thus the black streets Duke St, Curran St are lb or lb banded: & Tower St formerly lb is now lb: but the pink streets on the side of the London Rd are fast becoming purple: Green ascribed the change to the effect of neighbouring demolitions: the fairly comfortable are the first to move: the poor refuse to & have not the money to go far away if they wished to do so: -
 Then women & children seem to live in the street more than they do in North of the Thames: courts swarmed with children & the main streets with working men & women going to & from their work: more loafers here at the street corners: Top hats rarely to be seen: bowlers soft felt hats & caps the usual head-gear.

Children.

District covered.

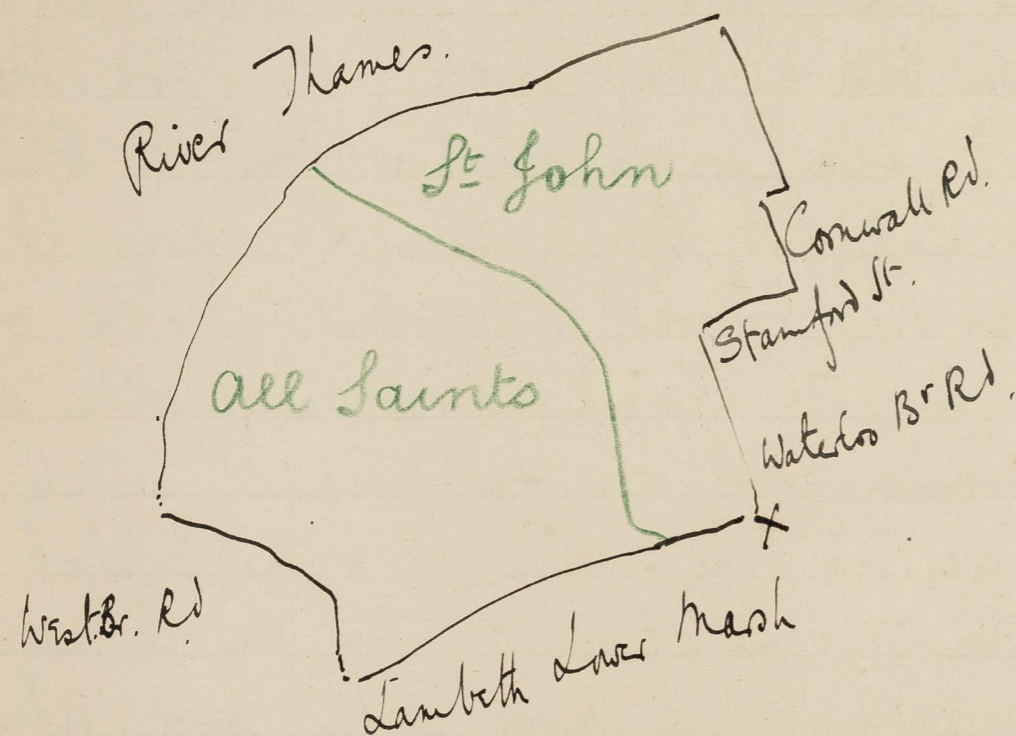

Pear Tree Street - pk

April 28th

Dist 31

Police

31

14

J.H.S

With Sergeant Saltmashe round district bounded on the north by the River Thames, on the E by Cornwall Rd, Stamford St & Waterloo Bridge Rd: on the South by Lambeth Lower Marsh on the west by Westminster Bridge Road: being part of the parishes of St John and All Saints

Sergeant Saltmashe has a round fat face brown moustache, middle height, 21 years service 11 years in this Division. Inspector Goun enquired to not knowing much about the streets east of the Westminster Bridge Road & Supt Wren accordingly recommended Saltmashe.

Starting at the corner of Lower Marsh & Waterloo Road: N up Waterloo Rd & E at corner
Pear tree Street: cul de sac: quiet: 14, 20 houses

pas

Holmes Terrace W of Grove Place lb }
rest lb + 2 }

Grove Place - lb + db

Aubin St - purple

Granby Place - lb

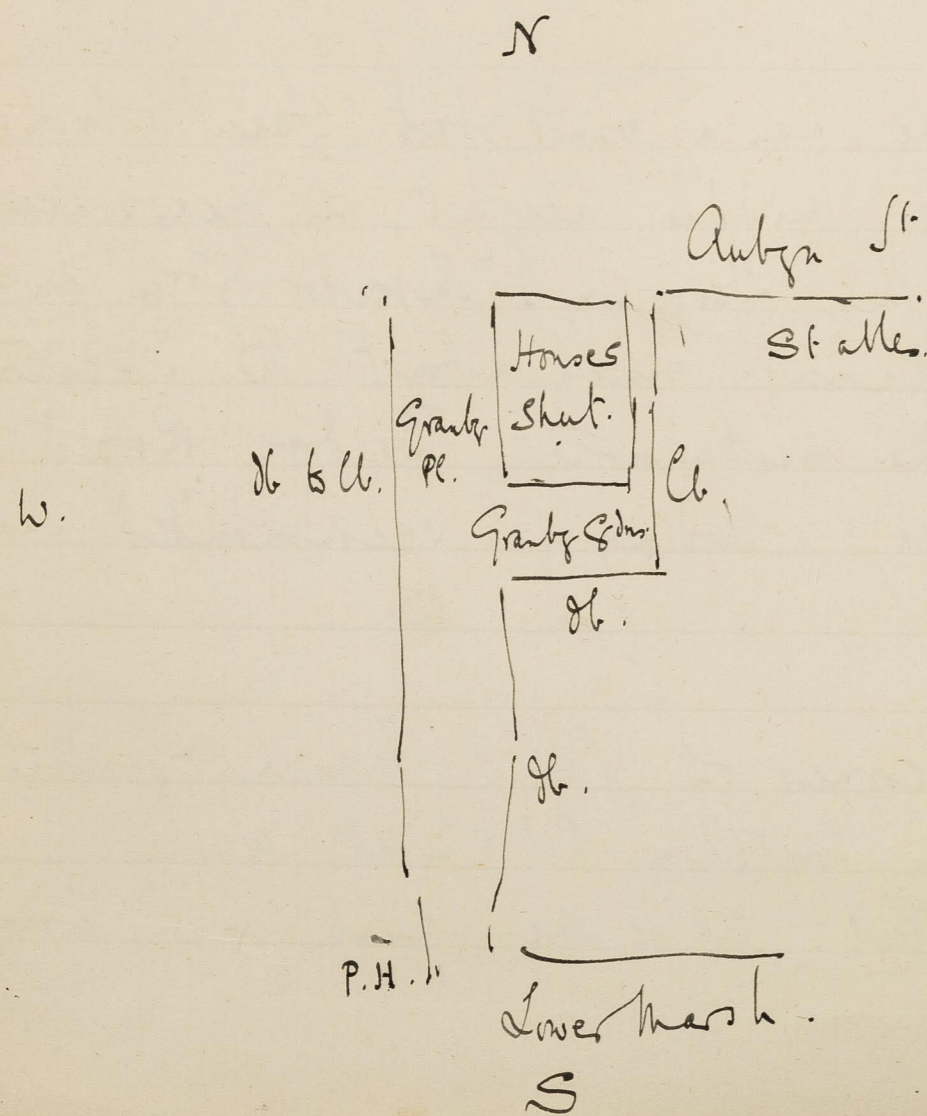

purple to pink : rent 7/6 to 9/ for 4 room & scullery.
not cold in map : N & E at c.

Holmes Terrace : 3rd houses on N side only : very
poor, many prostitutes living in the street : 'work the
strand & Waterloo Rd.' : all doors open : db in
map purple : west of Chatterley Place Holmes Ter
is 2ct : poor but respectable : cotes burrows :
the S side is down & the City & Waterloo Electric
rly works take up the west end : N & W
along c.

Aubin St : mixed : some fairly comfortable : many
railway porters : 'rly porters are known for the
amount they drink, earnings not occasional
but varying largely in amount from day to day'.
purple all through rather than pk & purple
of map : the W end is largely stables &
a break has been made in the centre leading
to Lancelot St. : out of the Street is c.

Granby Place : windows very bad, mess, fowls,
built 1851 : the west side is coming down for
railway extension : woman with baby dirty bar-
-armed, bar headed, pays 4/ for one room
it is

N

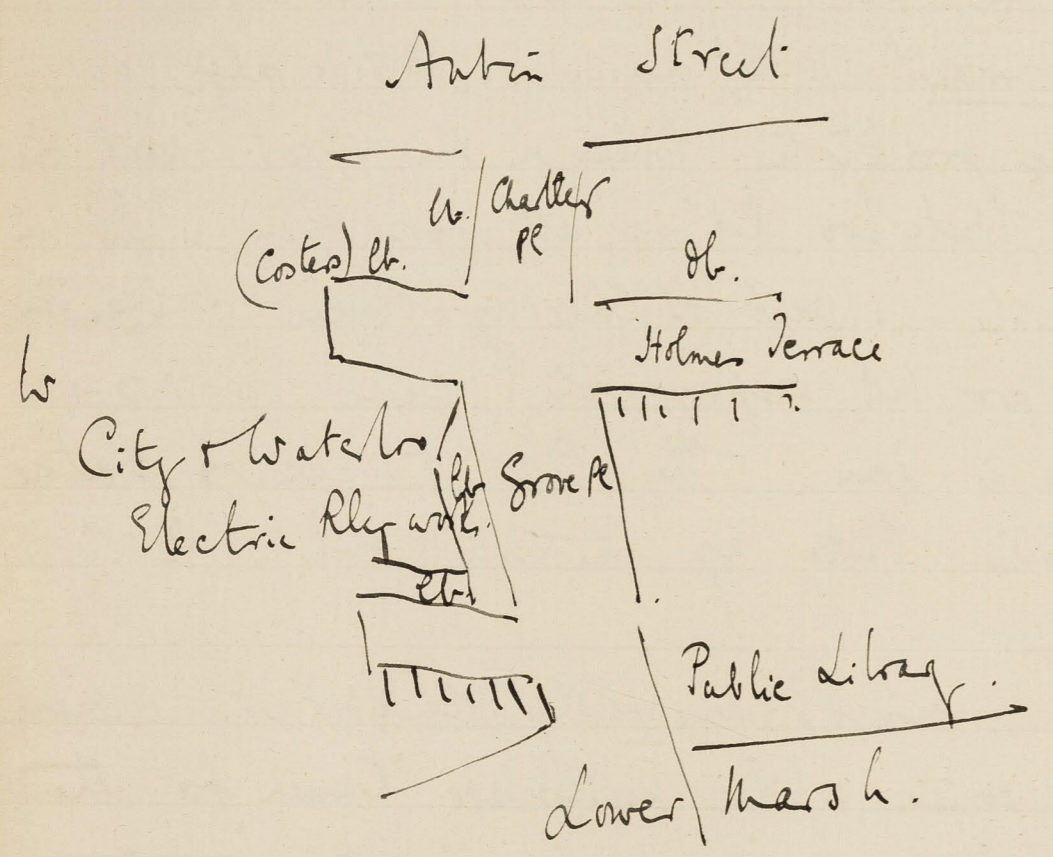

S

Streets off the W side of Waterloo Rd.

is the St. in map the W into St.
Granby Place : NE coming down, one house still occupied : W side & S.E. poor messy, laborer windows look rough but Saltmarsh said they were no trouble to the police : St to St. in map purple.
 E along Aubyn St. : S into St.
Launcelot St. : mixed : 20th : many poor : E end taken up by Rly electric works : par to St. : in map purple : S into Lower Marsh : E : N up St.
Chatterley Place & Grove Place : light blue : see map on page facing : Public library takes up E side S of Holmes Terrace : well appointed as seen through windows but very few using it. (hour 11.30) : E along Lower Marsh & up Waterloo Rd. under the railway bridge : W along St.
Vine St. : pk to purple : in map purple : rly men. this & the following streets are all pk to purple : out of the S side is St.
Robert St. : pk as map : rly foremen & firemen : v few living : N : E along.

Francis

Anne St.

Streets between Belvedere Rd & York Road.

Francis St. : 2 1/2 st : fairly comfortable : pk as map : N

+ W along.

Francis St. : like it PK as map

Anne St. : pk

all these streets are alike & pk to people in character : 6 roomed houses, letting at 12/ or 14/- per week : tablet : streets themselves badly kept & want mending : N ap Waterloo turning west at the York Public House - 'Poverty Junction' & out at Elbow corner. the corner where the former music hall artists loaf in hope of a job : York Road itself is full of variety agents : 'the demand for 'pros' increases every year.' N to York Road. W or N up c.

Tenison St. : 3 1/2 st : respectable : very few poor tenants apartments : musical profession : pk as map : E from

Howley Place : 2 st on W : 5 st on E ie the backs of the houses which face on the much higher level of the Waterloo Rd the two bottom stories used as cellars & stores etc at NE end which they are lived in : messy : people as map : Welton Belvedere Rd of 'don'

Streets between Belvedere Road
& York Road.

Belvedere crescent - pur

down Lutton St. pk as map : 2 along
Howley St. : 2st : narrow : no through fare for vehicles
pk as map : conf : quiet : N to C.
Belvedere Rd. : mixed street : N side all factories
shaves ; Brewery with foreman's houses attached :
South side many poor but many fairly comfortable :
purple to pk in map pk : W & S down C.
Belvedere Crescent. : rather better $\frac{E}{2}$ than $\frac{W}{2}$: 3rd 2st :
pur to pk : in map pk : S down C.
Vine Street. : 2i & 3i : pk as map : out of the SE side
to C.
Manners St. : 2i : flush with pavement : narrow :
no through fare for vehicles : pk as map.
S the W along York Rd rN into
Princes Buildings : 2st of houses : flagged east crannies
with children . clean . well dressed & fed : 4 rooms
for 9/ & 9/6' : only 9 ft between the house fronts
purple as map : W along York Rd rN up
Chicheley St. : 3st : (called in map Edward St) : not
so many houses lived in on E side as formerly :
mixed : purple as map : N W along Belvedere
Rd : out of its S side to C.

Cox's

Cox's Buildings - lb

Out of the Belvedere Rd.

prostitutes

Cox's Buildings: 3rd: children well fed & dressed: cats crowding round cats meat men: ~~two~~ 3 sticks of meat taken in at one house: 2nd a stick: put to U.: houses are on both sides ^{cross} of the court & come over the arch under which the court is entered: map shows houses on S only: E along Belvedere Rd. & at c.

College Street: mixed: two houses on the W side given up to prostitutes: Saltmarsh called them prostitutes 'homes' & explained himself to mean that only some houses w^d board prostitutes: & those that did so were called 'homes' by the police: 'they must live somewhere & don't bring men home to them: those who work the same road like to live together.' purple as map: I into the York Road & W: the

York Road: variety agents: warehouses: hotels: prostitutes: many hotels little else than brothels: 'girls live there & bring men home.' some servants: pk^d as map: I down as

Addington St.: pk^d as map: 3rd: out of the W ^{side}

Addington Crescent: flagged court: clean: conf:

pk

PK : NB that there are one or 2 houses lived in on the E side
S of the B! school as well as the turning N of it:

S + ~~E~~ : + N up cs

Gork St. : old fashioned : small 2st cott with
front gardens : purple as map : at the back
on the W side is cs

Sapphire Place : 2st : 5 rooms + scullery ^{for}
cs : in the rather most houses : the rent
7/6 to 9/- : houses on E side only ~~cs~~ at N side
of N end : purple as map : E along Gork Rd
N : turning E at Bazon St : S down cs

Commercial Buildings : is now a cement passage
clean : some living : lb at NW end goes
E into cs

Bazon St : late Bond St : 2 basement : flush
with pavement : rough mixture : many
prostitutes : par to lb : in map purple : E along

Cage Place : late cottage Place : 2st : was cs hanging
across : some houses very poor : children ^{fairly} clean
+ well dressed : lb to lb : in map lb : rent
'4 rooms 7/6' for new tenants 5/6 for old!
S + E along cs

Bowl

Streets between Commercial Rd
Stamford St.

Bazon Street - pur b⁴

Bond Place - lb.

Courts out of Doon St.

Milan Place - lb

Bond Place : very poor : 2st : children ragged, dirty
boots bad : pink & black toes shewing thro'
boots : mass of paper : cellars with open
door full of mess, pickings from the dust-
yard in Commercial Rd where most of the
women work : windows patched & broken :
bare ratty rooms seen through open
doors : washing day, washing being done
in a tub out side front doors : redraining
to houses at E end : rents 2 room 5/6, 3
4 rooms 7/6 : it is a flagged court : Db is
map. : N. & along Doon St. is

Doon St. : mixed : many poor : people as map : out
of South side is is

Milan Place : 8 cottages, cap in centre to
supply houses, defective water running to waste
by gallons [this is a common sight in the S
London courts seen hitherto] looks quiet &
clean, great array of flowers under wire
netting at one house : but Saltmarsh said
it was noted for family rows : fathers fight
their sons of a Saturday night : bird cages :
not

very poor: two very dirty well fed children seen: 2+3 rooms
 for 6/6: ~~op~~ lb both: in map db: opposite
 on the N side of Dorn St is es
Elizabeth Place: 2st: two rooms & wa house
 5/6: geraniums: lb as map: E to Cornwall
 Road, N, on the W side is es
Henry Place: four, ~~two~~ ~~rooms~~, two storied cottage
 2+5/6: 4 rooms of: db both: in map lb: opp
 on E side of Cornwall Rd is es
Druce's Place: two, two storied houses: one db the other
 lb: in map pk: on the W side of Cornwall Rd
 South of Dorn St is es
Perry's Place: houses on E & W sides: ch: dirty well fed, ^{but both}
 db both: in map lb: into the es
Cornwall Road: 3st: many poor rough at this
 North end: 'last Saturday ^{in one of these houses} a woman threw a
 lighted lamp at her husband & both were
 burnt to death': lb to par: in map purple.

General Remarks.
 The demolitions in the neighborhood of
 Lower Marsh owing to Railway extension
 (LMSR)

Courts out of the West of the
 Cornwall Road.

Druce's Place - lb

Perry's Place - db

the Waterloo City electric Rly engine station;
 the fairly comfortable round Waterloo Station,
 prostitutes & brothels in the Gork Road, &
 the very poor rough off the NE corner of the
 Waterloo Road — are the features of this
 round. Railway disturbance has only displaced
 some 'people' & not much of that. Otherwise
 the district is much as it was 10 years ago.
 Prostitutes crowd round Waterloo as they
 do round St. Pancras & King's Cross, & the
 Gork road has much the same reputation
 as the Custon Rd.
 Rents ran between 2/ & 3/ per room.

District covered.

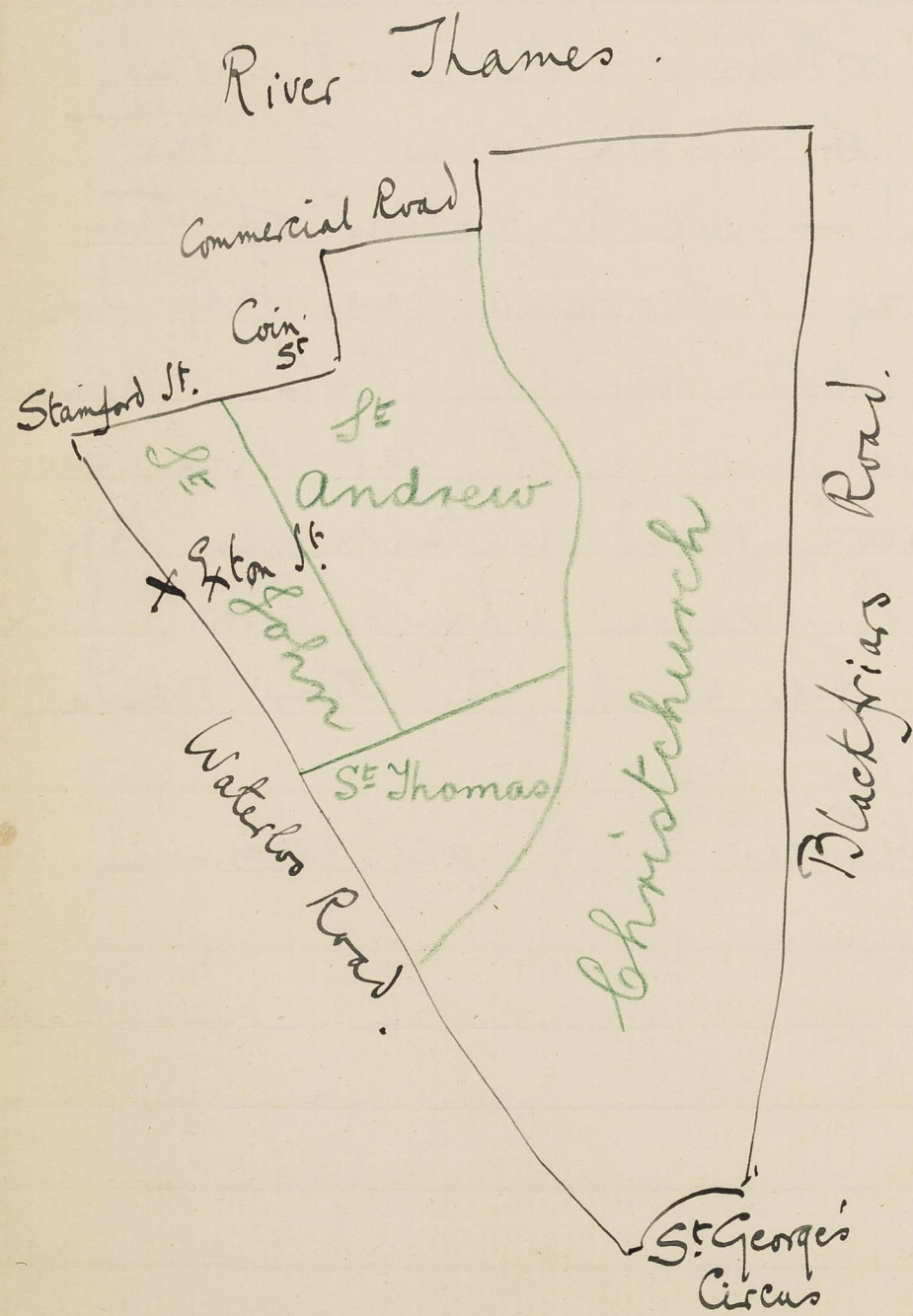

May 10th & 2nd

Dist. 31.

Police

31
10

G. H. S.

47

With Sergeant P.S. Waters round district bounded on the North by Stamford St., Coin St., & the River Thames, on the East by the Blackfriars Road, on the South by St. George's Circus & on the West by the Waterloo Road: being part of the parishes of St. Andrew, St. John, St. Thomas and Christchurch.

Starting at the corner of Exton St. & the Waterloo Road: E along co

Exton St.: 3rd set: 2 or 3 families to a house: p.R. as map: Map co

Secker St.: 3rd set: rather poorer: St. Patrick's Catholic Schools on S.E. side: p.R. to par: in map p.R. N & W at co

Cornwall Place: flagged, fairly clean court, front gardens now cemented over: 'but they used to be fine some years ago': used to be Irish but fewer of them now: windows & curtains fairly clean, doors open: a fairly well furnished room to

Poor courts of the Cornwall Road.
South of Stamford Street.

Danger of fire.

Salutation Place - lb

Ground landlord G.M.

to be seen inside : many old tenants : since 18 or 20
years : waterside labourers : the extreme west
end is the poorest : at the back of the N side
is a large woodyard with piles of wood stacked
alongside of the chimneys, nearly overlapping.
There has never been a fire but it is hard
to imagine anything that looks more danger-
ous. rents 6s for 2 rooms, no copper, kettle
has to be boiled & washing done in tub in
front yard : W.Cs in front : lb : leave that
W end : in map all is lb : N part.
Cornwall new : a woodyard : no one living : the
thoroughfare into Waterloo Rd. has been closed.
on the E side of Cornwall Road is
Salutation Place : 3rd houses : rents for 3 rooms
7s, 7/6, & 8s : no wash house nor copper :
W.Cs in black wooden sheds in front : houses on
N side only : "he should give us coppers, it
lays us all up with bronchitis being without
them." G.M. says that the Prince of Wales is
landlord : at the E end Salutation place
turns abruptly southward becomes two
streets

storied & much poorer: 2 end not shown in map
St: W end, St in map, to lb: cooler street
lawyer, old inhabitants: South of Salutation R
mt of Cornwall Rd is on

Peer's booperage - lb

Peer's Cooperage: 3st: poor: flowers in windows
cooler: lb: in map St: Dr into Stanford St

Σ then N up ^{Co}
Corn St. (late Princes St): 3 1/2 st: clean: comfortable: some footi.

tiles: pr as map: 2 along Commercial Rd: S Dun.

Duke St. ~~late~~: 3st: old fashioned: small panes
to occasional small shops: purple as map: E & S

into Cory Square: late Princes Square: 3 storied houses:
court in course of being well laid with cement:
children very dirty but well fed: poor & very poor
& a few fairly comfortable: all doors open, some
bread about: a few Irish: west side poorer than
the East: five roomed houses let at 10/-: all
the East side at this price: small glass bottle
factory mt of the Eside: old tenants: one had
been 20 years in the court & another boy of
about 16 had ~~seen~~ lived at various times with his
family in every one of the various houses in the
Court

Cory Square

Broad Wall

Paris Garden Dwellings - db

Streets & courts between
Upper Ground St & Stamford St.

Boddy's Bridge S. court lb

Called Upper Ground Place.

Bennett Street - lb & db

The houses at the NE end of Bennett's
are smaller, poorer, sh^d be db:

court : db as map. ↻ E & S down ↻

Broad Walk. : 3rd Buildings called 'Paris
Garden Dwellings' on the W side, rough poor &
very poor, lb to db : the 2nd houses on the E
side are in good repair, also poor : lb as map
& along Old Barge House, warehouses on S side :
S down ↻

Hatfield St. : working class : pk as map E &
S down ↻

Boddy's Bridge : E side is ^{or school?} warehouse wall : lb in
map : very poor on W side : db to lb : in map lb.
The southern court is more respectable (in
map purple) E side not so good as west,
rather lb than purple : one ^{elder} woman who
has been there byears pays 14/- for her house
→ of 6 rooms & wash house : 3 floors : she lets
off at 6/- per floor or 4/- for a single room.
E & S down ↻

Bennett St. : 3rd ^{old. Built for a servant keeping class} on E side : poor. lb : in
map pink : Cook's the Draper in S.
Paul's Church yard has the whole of the west
side as a residence for his employees. pk
as map

Kings Arms Court - black

Kings Arms Court.

Stamford St.

Prostitutes & Brothels.

map : E & South down c.

Kings Arms Court. : 12 houses, 3 st : 6 on E & W side, ropes across for hanging clothes: windows broken & patched: lowest class of prostitutes & thieves: one barefoot child: rough women with hair in metal curlers: men with faces of criminal type at the windows: rows on Saturday nights: children boys & girls playing tip cat, dirty ragged, but all well fed & of good colour: 'like Joiner Street': black in map 16: S down Blackfriars Road & W along c.

Stamford St. : 3 1/2 st + alle : 'great many prostitutes living here: hotels are places of accommodation: some are little else than brothels: girls live in them, walk out & bring men home to them: there have not been many foreign prostitutes since the passing of the 'act against bullies'. The most disreputable hotels are west of the Waterloo Road but there are some almost as bad E of it: pk as map: but pk barred as map W of Cornwall Road where there are a greater proportion of sewer ^{keep}

Keeping Hotels : W + South Cornwall Rd : 2 at
Palmer St. : N side factories : S side are back garden
of the houses in Whittlesa St : S Down E
Theed St. : railwaymen. pk as map : W along.
Whittlesa St. late Richard St. 2st : clean : slugs
pk as map : W across Cornwall Rd. along
Alaska St. : W end blocked by operations for
widening railway bridge. 2st : pk to purple
in map pk : S Down Cornwall Rd. W along is
Sandell Rd. : houses on S only : pk not col! in
map : W into Waterloo Rd : Spent a beer
store which used to be a Wesleyan chapel : 2aly.
Morpeth Place : 2st : 4 rooms + washhouse, let for
10/- : let off rooms at 4/- each : said one man
windows bad : ch. kates : pk as map : 3 + 2 at
Peartree St. : 3 + 2st : small shops : sweep etc : purple in
map pink : Map Cornwall Rd. on the W side is
Hammond Place. 5 houses : quiet poor : one house
at the W end is double fronted : 4 rooms upstairs let
at 6/6 : 3 rooms down at 6/9 : the other houses
are two-roomed let at 6/6 'you pay a little'
more to have the place to yourself' said one man

ll

Sandell Street - pk

Peartree Street - purple

Hammond Place - ll

Courts out of the N side of
the Cornwall Road.

N

Rouphell St - SE end - lb

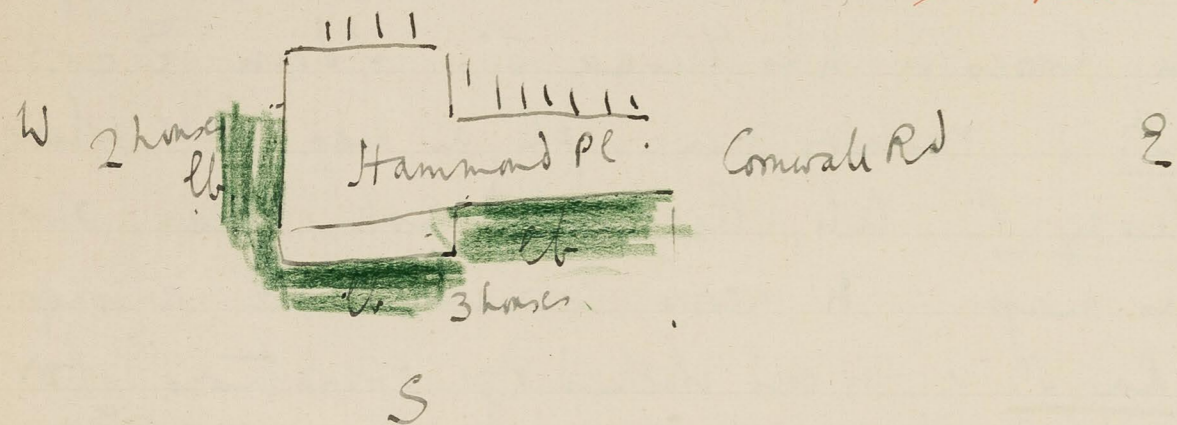

Streets W of Broad Wall.

Corn Street SW end - lb

lb to lb : in map lb. : N up Cornwall Rd E along c.

Rouphell St : quiet, comfortable, like Whittlesea St &

Theed St except at the SE end which is marked poor & should be lb : there are no houses in

the court at the back wh: only leads to the backs of the Broad Street houses : N up c.

Broad Wall. : poor : 3, 2: st : some old brick roofed wood-sided houses : lb as map : the

block of lb which was common lodging houses at the SE end is now all warehouses : the

rest lb as map : W & South down c.

Duke Street. : some small shops mixed with poor &

very poor : lb : in map purple : the main entrance to the Peabody Dwellings is here : many poor

purple to pl in map pl : W along c.

Aguias St. : 2: st : flush with pavement : quiet : purple as

map : off the N side is a small court of two houses called

Thomas' Cottages. : catered down steps : 2 r in each let

for 5/6 a week : W into Corn St. c.

Corn St. : ^{late Prince St} very poor at SW end : the rest is pl as map : front

of the NE side is c.

Princes New. : cabyard : carts : etc : only one tenanted

in

Streets between the Railway
& New Cut.

Ethelm St. E of Windmill St. - lb

in map purple: now not worth marking: but it is either pt or lb.
W along Stamford St. S. down Cornwall Rd. E along
Brad St. houses at E end only: those (8) on
S side to come down for the Railway: notices
to quit when wanted being served: one woman
on taking her said well I shant quit till they
come to turn us out: poor, scavengers & ^{gutters} labourers:
lb as map but less of it on S side: S down
Eaton St. & W along c.

Wootton St.: N side (in map purple with two courts
lb & lb off it) down for slwy extension: S
side: mixed poor & comfortable: 2st: many
windows broken: purple as map: out of
the SW end is c.

Wootton Court.: 18, 2st house: flagged passage: one
room up & one down small back yard: very
poor, curtains dirty windows bad: ^{the map} two
landlords & one landlady to this block: the
landlady lives in one of the houses herself:
rent 6/- & 7/- for two rooms & kitchen: 7/-
for new tenants. E into Windmill St. & E on

along Ethelm St.: poorer E than W of Windmill St.

Little Windmill Street.

Little Windmill Street - db

Victoria Place. N

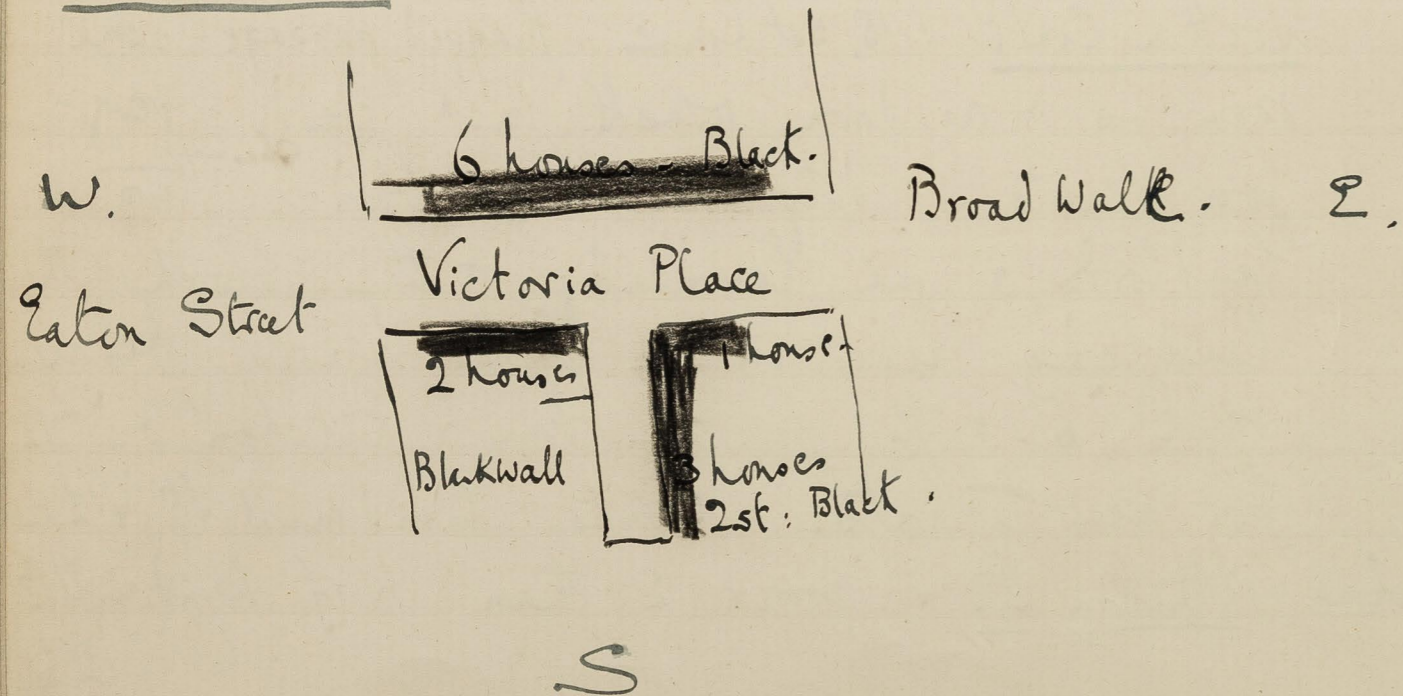

2 1/2 ct: two or three very poor at extreme NW: purple as map W of Windmill St: lb. E of it: the E corner of Windmill St: also lb: it looks as though ~~the poor of the~~ the N side of Wootton St had come in here: S down c.

Eaton St: lb. both: in map db: west along.

Little Windmill St.: 5 st Waldeck Buildings on the N side, pl as map: stables on S side not lived in (lb in map) exc a few houses very poor at SW end, these shd be db: the db; cart on the W side of Windmill St: is closed & seems to have moved across the road. Waldeck Bldgs are rather better than the Peabody's. N & W along c.

St Andrews Place: 12 houses, 2nd: on S side only: clean flagged passage: very poor: dust yard scavengers: young wives: dirty children but all enough to eat, ragged: houses let for 5/9 2r & a very small yard behind: E along the c. S down Eaton St. & E at c.

Victoria Place. 6 houses on N side: 3 on south & 3 on the east side of turning south out of it

it : bare passage, flagged; fretful ⁱⁿ dirty children, hair
 matted, hatless, dirty faces : women ^{rough} ^{broken} ^{stuffed} ^{rough} ^{bar}
 armed, all doors open : half mitted loaves stand
 at corners : bare passages seen through open doors.
 children & girls throwing head at one another.
 plaster peeling off the house walls : in habitant
 thieves & prostitutes : there seemed to be one
 respectable family at the West house N side.
 'like Kings Arms Court & Joiner Street' : black
 as map but less of it : there are no houses
 on the W side of the cal de sac which runs
 South out of the Place : Map Broad Wall, out of which
 is Sidwell Place : 12 houses : on N, S & W sides : newly cement
 paved : all doors open, poor, women with sack aporns
 houses 2 storied, four roomed letting at 10/6 &
 1/- for the whole house; when sublet they
 fetch 4/- for upstairs front : 3/6 for downstairs
 front : back rooms 3/6 each : there is to
 each a kitchen & copper. ^{the map} It part is
Nitre Place : a private yard : not ^{houses} ^{living}
 in map lb. It up is
Hatfield St. : 2 1/2 & 3 1/2 st : mixed : N better than S :
 as of health

Courts off S.W end of
Broad Wall.

asphalt paved : well kept road : some poor : par to
 pk in map pk : ~~to~~ along Stamford St : S down c.
 Bennett St : seems busy the provision merchants
 warehouses take up all E side (in map pk) :
 on the W is a public house some dwelling houses
 & Cooks (the hat makers) offices pk as map.
 W along c.

Stamford St : clothing ho on the S side between
 Bennett & Brunswick streets purple rather
 than pk of map : S down c.

Brunswick St : mixed, asphalted, clean, birdcage
 at windows. purple as map : E into c.

Brunswick Place : 14, 2nd houses : clean flagged
 passage : poor : lb to par : in map pk ~~is~~ along

Collingwood St : old fashioned 2nd wooden houses with
 some windows & red tiled roofs on S side : pk as
 map but it shd be purple where it runs
 N & S, many poor, instead of pk of map : off
 the W side of Brunswick St E c.

Brunswick Court : 2nd : very poor : see
 page opposite for colouring : in map it is purple
 & lb : the houses at the N E rather less
 poor

N

Stamford St - db & pk

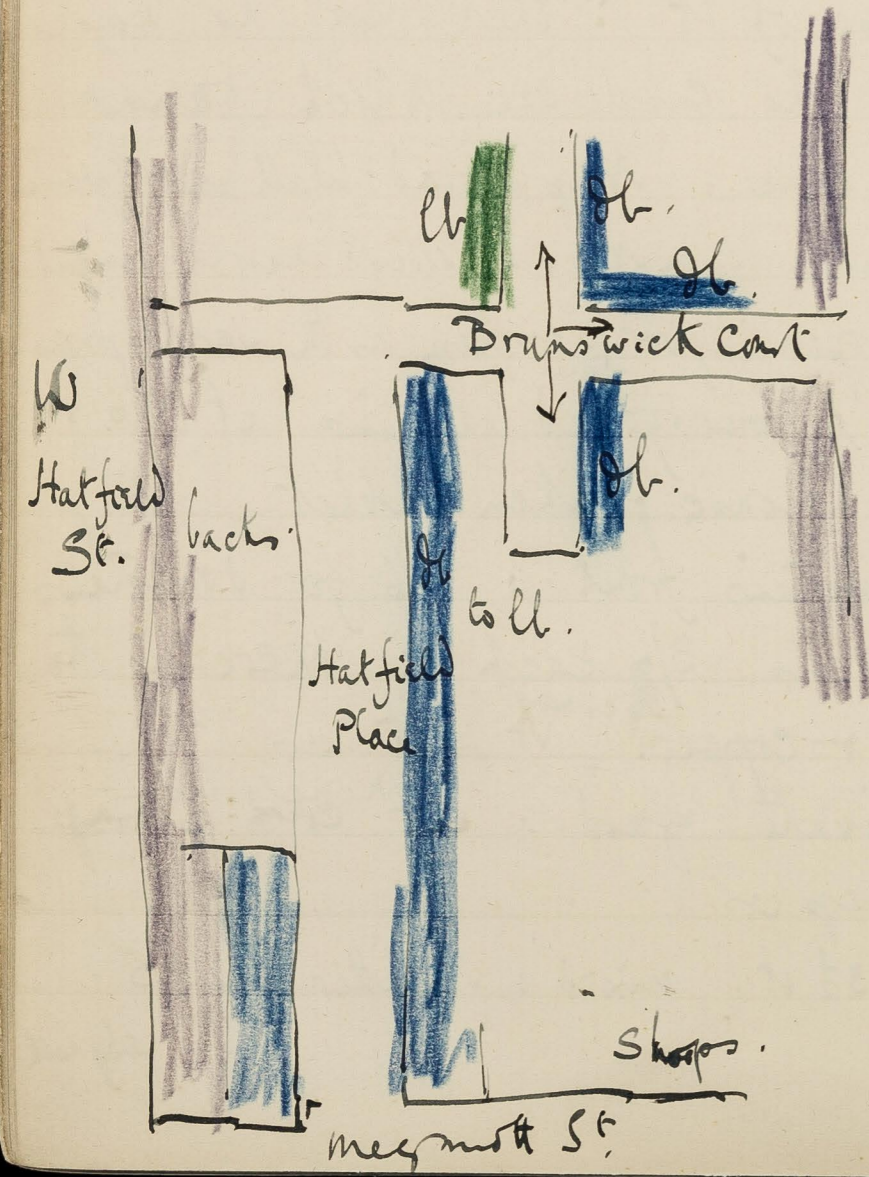

Brunswick Place - lb
Brunswick Street

Collingwood Street - pur

Brunswick Court - lb & db

S

Between the Railway &
Great Charlotte St.

Hatfield Place - db

Runninghorse Yard - lb

Jane Street - purple

poor than the rest : 2st : db : S down c.
Hatfield Place. which is a flagged passage :
 19 2st houses on the E side, 5 at the S.W.
 side : lat less children, most doors open, a
 few fairly comfortable families remaining
 but they are the exceptions, the majority
 are poor + very poor : lb db in map per-
 -ple : 2 along.
Meymott St. : late Cross St. wood paved, narrow,
 shopping st. not very busy but much wheel
 traffic as it is the short cut from Blackfriars
 Road to Waterloo station. jrk as map : Ends
 Blackfriars road on the W side of Meymott St.
Running horse yard : only two still occupied at
 W end : 'used to be very rough when the houses
 on the South side were tenanted' : now they
 are stable lofts : said a fat man who
 had lived there 40 years. mark lb : all
 the db shown in the map has gone : W + S down.
Collingwood St. : W along c.
Jane St. : 2st : S side not so good as north :
 street up for cement paving : jrk to pk : in
 map

Isabella Street - pur.

Streets between the New Cut
St Georges Circus.

Gray Street - pur & lb. b?

Short, Ufford, Mitre & Caffyn Streets - lb

pink : S down Broad Wall & E at c.

Isabella St 2st : N side down for stuy extension:

many poor : purple in map pk : out of the S side is

Norfolk St : 2st : pur lyk in map purple : Elwood

hat & helmet factory is at the S.E. corner of : S into

Great Charlotte St : broad : shops on N side :

large common lodging house on the S side

Great Surrey Chambers : 5 1/2 st : Separate rooms

8d a night or 3/- a week : Good accommodation 6d a

night or 2/6 a week : pk N : purple S : as map

St Ann Marlboro St : 2 along c.

John Street West 2 st : house on S side : pur as map

N up c.

Barrows mews : a few living above stables on

NE, SE & SW : in map lb but in the wrong

places : W to c.

Gray St 2st : many poor : pur to lb in map lb

N up c.

Short St : out of whose W side run

Ufford St late Queen St

Mitre St

Caffyn St late New St

} all 2st : poorer than they used to be : a few fairly comfortable remaining but the majority

between Webber St &
Waterloo Road.

Webber St - all pur

Asa Place - db

majority poor & very poor: Caffyn St. is the poorest:
map marks afford White St purple & Caffyn St db.
now there is more of a dead level of lb. ~~to~~
a boy is a fit in Caffyn St with the whole neighbour.
- look out of window & in the street to look at
him: W to C.

- Webber Street: poor: the best parts are the small
shops south of the 'Victoria' at the NW end & again
between Webber Row & Basin Place (both sides of street)
these might remain pink: all the rest is lb & purple.
The Marshalls Buildings out of the E side N of
Valentine Place distinctly lb: in map the
whole is pk: out of the W side N of Gray St.

- Asa Place: 6 houses: small court but 12
children playing in it: very poor & very rough:
childrens clothes all holes: there is a copper
in the court common to all the houses: 2 rooms
57 & 56: db: not shown in map. W along

- Gray Street: common lodging house on S side beds
40 or 60: but not near so bad as it used to
be: some prostitutes but majority have been
cleared out: lb & db in map db: 5
down

Between Webber Street
& Waterloo Road.

Webber Row - lb

Waterloo Rd & E at c.

Bacon's Place. 2st: very poor cottages living here
lb lb: in map lb on N side only: E along

Valentine Place: Pascall's sweet factory takes
up a large part of the N side E end: lb as
map. S down c.

Angel Place: passage, 2st houses on either side:
labourer, 'like Coffey, Nitro & Afford Streets':
not rough: lb as map: into

Valentine Row. 2st: old inhab. Lants: rents
9/- for 4 rooms & Kitchen: single rooms let
off for 3/6 + 4/-: W into c.

Webber Row: north side ^{down} except a few houses
'They propose building model dwellings here,
the south side is poor: lb not purple: out
of the SE end is c.

Williams Place: poor two stined cottages shored
up to prevent falling in: children clean well
fed: stable yard at S end: one woman who
had been there 2 years pays 4/6 for 2 rooms
& wash house: ^{as map} west of it out of Webber Row

Bennetts yard: two 2st: houses: lb to purple
not

not shown in map : the st shown in map now disappears
 it is merely a rambling ramshackle stable
 yard with some living over. E into
Blackfriars Road & south on the E side
 are Peabody dwellings. Blackfriars square
 large prison like buildings, asphalt square
 in centre, a fair open space planted
 with trees, eagerly tenanted : some poor
 but as a whole pink as map.

General Remarks.

The poorest places in the wedge between
 the Thames on the North, Blackfriars Rd
 on the E & Waterloo Rd on the West are -
 Bond Place out of Bazon St.
 Perry's Place ——— Cornwall Rd
 Cornvale Place ———
 Salutation Place ———
 Cory Square out of Commercial Rd.
 Regents Court — Ground Street.
 Brunswick Court out of Brunswick St.
 Hatfield Place Meggott St

The poor spots in the wedge.

Movement from lowest upward
lightest downwards.

Wootton Court out of Wootton Street.
St. Andrews Place ——— Windmill St.
Sidwell Place ——— Broad Wall.
Little Windmill St SW end.
Asa Place out of Webber St.
Barons Place ———
Williams Place ——— Webber Row :

All these are dark blue or between dark & light blue : two of them are black ie Regents Court & Victoria Place : Victoria place was black 10 years ago & is still black Regents Court now becomes black & was dark blue - as a whole there has been no increase of the dark blue in this district but at the same time no decrease. But there has been a large increase in the amount of light blue & a marked decrease in the amount of pink. The tone of the whole is to day more of a uniform light blue ^{though} light blue dotted with patches of dark blue. Railway clearances & increased facilities have

the dark blue
 Driven out & carried off the pink : the dark
 blue has sought refuge in the ~~secret~~ ^{street} ~~houses~~
 nearest to those from which they were driven
 while the pink has ~~secreted~~ ^{found} house room further
 afield. The district therefore is getting poorer.
 It is probable also that the streets a ~~marked~~
 this year show ~~as little~~ their minimum of poverty
 owing to the goodness of the times & trade
 & the mildness of the winter.
 Except in the few streets North of Stamford
 Street the bulk of the inhabitants both
 work & sleep in the district. In this respect
 the place differs from most of the districts
 already seen in North ~~London~~ ^{London} of the Thames.
 The inhabitants make one vast poor family whose
 lives are well known to one another. There
 is ~~scarce~~ more street life, ^{than even in the East} more children in the
 street & more women gossiping at the doors.
 The New Cut & Lambeth Lower Marsh is
 the common meeting place & market street:
 always busy, though busiest on Fridays,
 Saturdays nights & Sunday mornings:
 The

Life.

The prices as I passed were 4^d for a 4 lb loaf:
 Meat - scraps from 2^d to 3¹/₂ lb.
 pork chops (first rate) 6¹/₂ each.
 1/2ⁿ cooked chickens 8^d & 9^d. (not appetizing
 to look at). Sheep heads uncooked 5^d each
 Best eggs. 3 for 2¹/₂^d
 Eggs 'special line' 24 for 1/-
 4 ducks eggs 3^d.
 Whole skinned rabbit 6¹/₂^d
 3 bunches of radishes 1^d
 lemons 3 a penny.

Good cucumbers in the shops 2^d & 4^d & the
 same in appearance on the barrows 1^d & 1¹/₂^d
 The largest crowd was round a fish barrow
 where cod or whiting palkock & plaice were
 being sold, the buyers all women, no excite-
 -ment, dutch auction; each fish was
 cut in half & skewer; the seller fixed
 the price & lowered it until it was bought.
 most of it went at the price he first
 named. a large plaice was to be bought for
 4^d: cods head & perhaps 12 lbs of meat cut
 of

Prices in Lower Marsh.

with it for $3\frac{1}{2}^d$: the rest of the fish (4 or 5 lbs.
 - at a guess -) went for 4^d : a whole fish for
 6^d : only once had he to lower his outset price
 a plaice - fair size. offered for $3\frac{1}{2}^d$ found no
 buyer until $2\frac{1}{2}^d$ was reached. The flesh of all
 the fish was white & looked fairly fresh.
 Rump steaks - good. ran from 9^d to 11^d in the
 shops & mutton chops 8^d & 9^d .
 The cotes barrows are on the N side only - by arrange-
 ment with the Vestry.

Besides fish & fruit there are barrows of flowers,
 fuchsias, geraniums & small bedding plants
 in wooden boxes: barrows of old keys, iron-
 work; haberdashery etc: but the glory
 of the Lower Marsh is by night, it is
 sherry & fruit by day.

District covered.

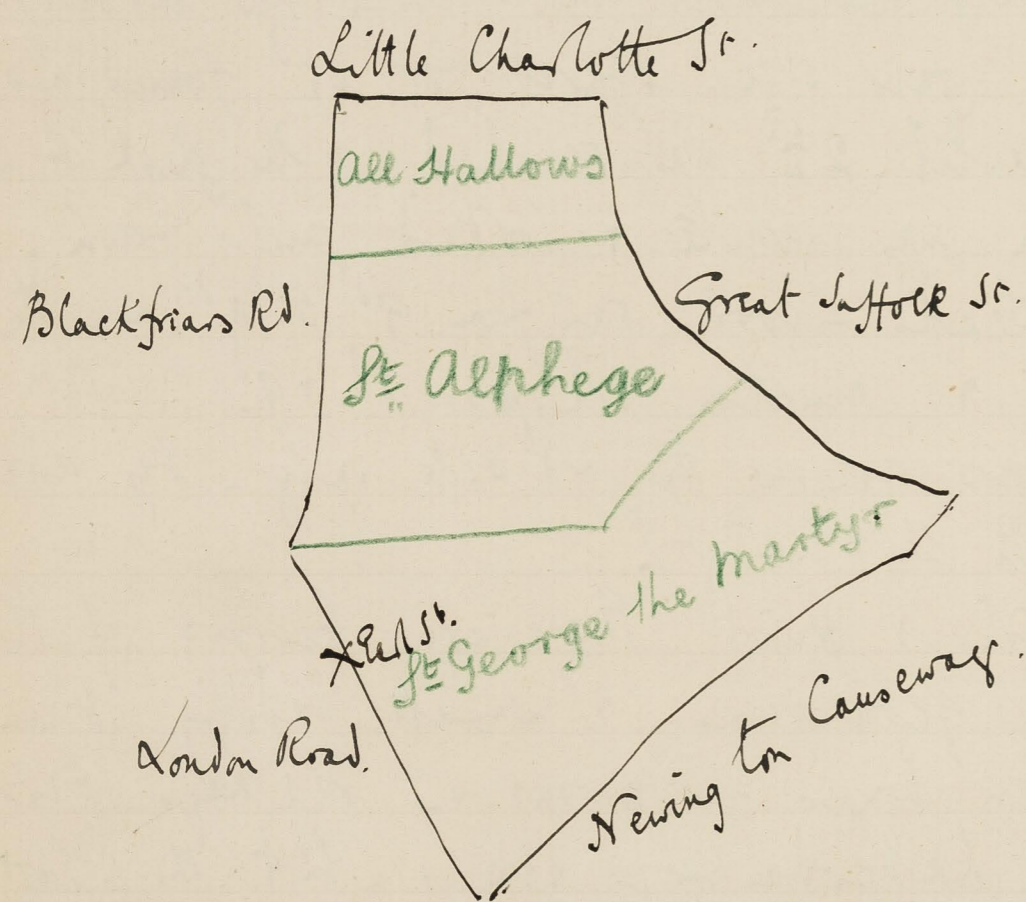

Streets between London Rd & Borough Road.

Dantzic St. - N of East St. - dt

May 11th & 12th

Dist 31 ^{Police} 31 / 4 G.H.S.

With Sergeant F. J. O'Sell of the M Police Division round District bounded on the North by Little Charlotte Street, on the East by Great Suffolk St & Newington Causeway: & on the West by London Road & Blackfriars Road: being part of the parishes of All Hallows, S. Alphage, and St. George the Martyr.

Starting at the corner of East St & London St: & along East Street: 2st: poor, quiet, careful: many rag pickers at Joseph's great warehouse: lb to par: in rag purple & lb: map as Mansfield St: a few 2st, broomed houses on west side only: letting at 14/- a week: purple as map: Hov's large printing machine works take up the whole of the E side: E & S side Kell ~~George St~~ St: late market St: Houses at NE & SW only: the rest on the W side are down & the East closed: no good doing up property of

Streets between East St & Borough Road.

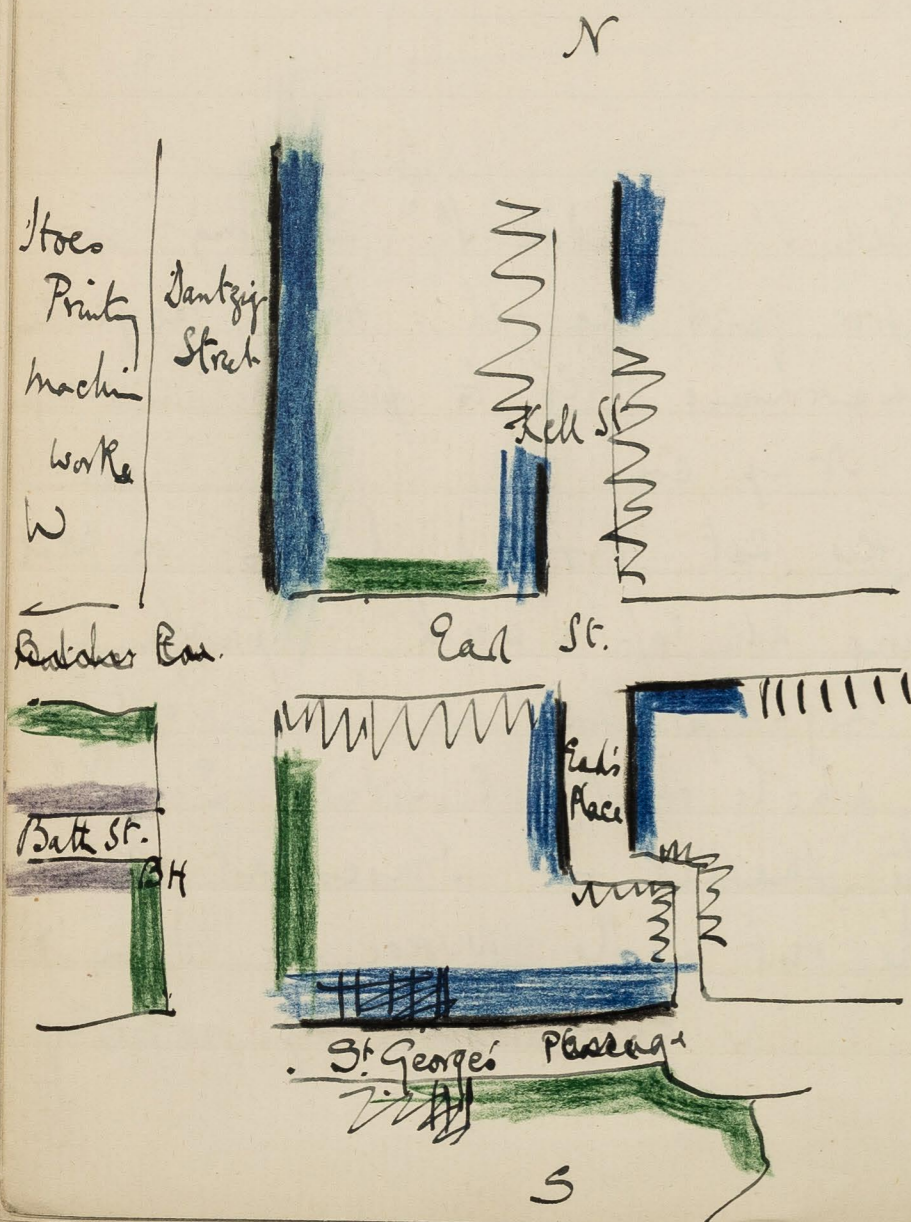

Carl's Place - db b^o
 S

S. George's Place - db b^o

of this kind, owners find it better worth their while to pull the whole thing down & rebuild for a different class: a drunken & disorderly class here, ~~exceeding~~ windows very bad; some ex-convicts: db to lb based - as map but less of it: W & R up on Dantzig late market St: houses on E only: Hoes printing machine works on W: Joints: like Kell St 2st: windows & curtains bad: all doors open: a class that has money esp for drink & amusement but nothing for their homes: db to lb based: in map lb: it wd seem as though the inhabitants of demolished Kell St had turned in here: E & S down Kell St across East Street out of the south side is on Carl's Place: 6, 2st houses: children, dirty, well-fed, fairly clothed: 5/6 for 2 rooms: women very rough: 'very poor & very bad': db to lb black: in map lb to db: 3 to St. George's Place: 2st: well as-phaltered: one fairly comfortable house: the rest very poor: db to lb (see plan opposite) - in map lb: W across Dantzig Street & along c.

Butcher?

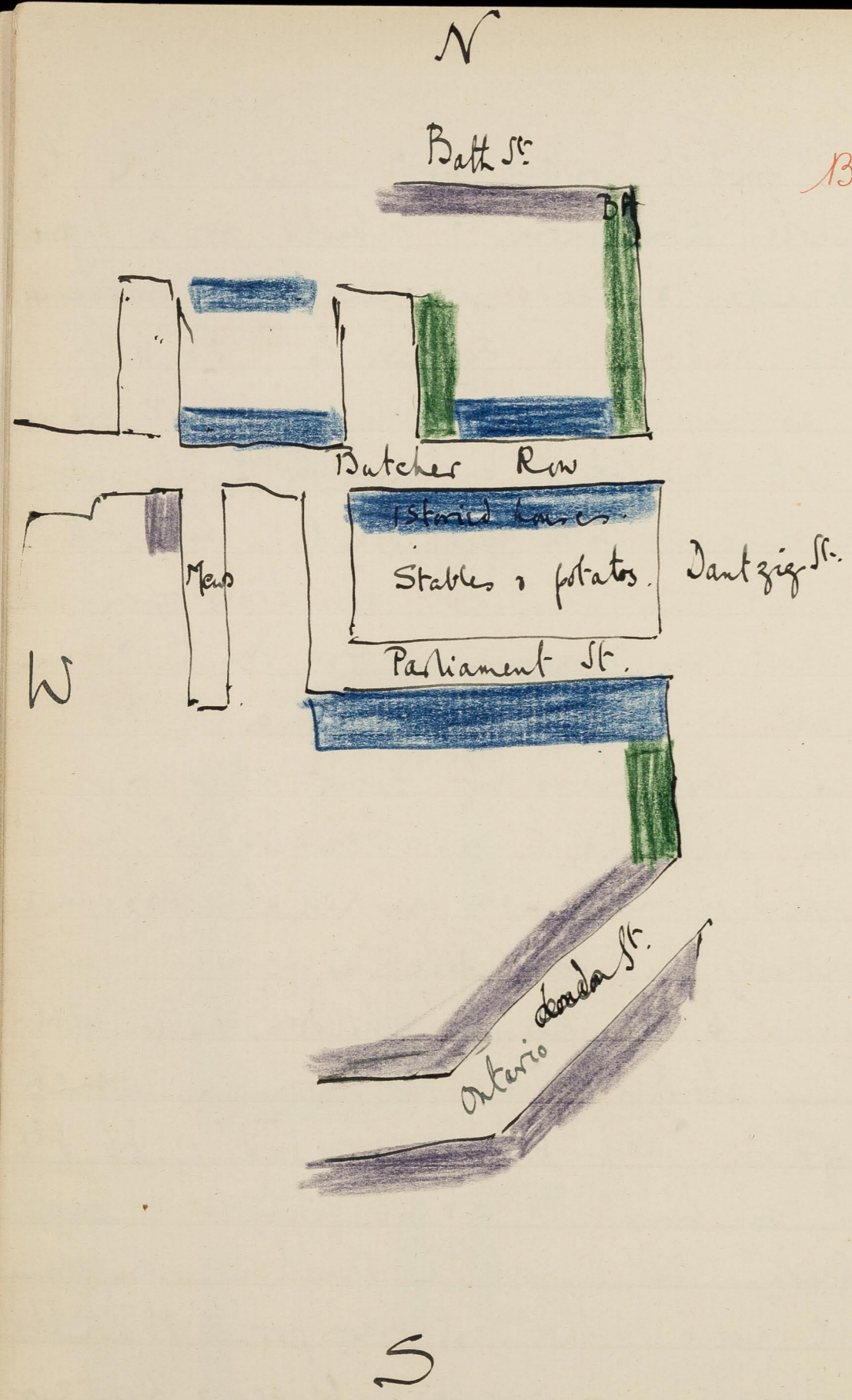

Butcher Row - lbb?

Butcher Row: ^{alley} passage: small one-story houses on the south side which were the booths of a busy market: the market consists now of stables & a few orange & potato merchants. The houses on the N side are poor rough, some stoned, windows broken patched, all doors open, ice cream vendors, children dirty & ragged, some eyes but well fed: coster barrows in evidence: Db to lb in map lb: the cul de sac turning N looks less poor, lb: the block opposite the news also less poor lb to Db & behind this are a few 'back cottages' apparently tenanted - Db: the news has only one family living over at the SE: all the tenants here are rough poor, plenty of money at times & none at others: women sitting about on doorsteps: a few thieves & prostitutes, or betting roughs: men who regularly snatch ^{the telegraph} those who come with their ships after a race to be paid; they are in league with the smaller bookmakers: perhaps the coloring of the whole shd be lb to S along W

Parliament Street - lb b²

Streets off E side of London Rd.

Skipton Street - purple

W end of the market & E along Parliament St. : 3rd : same class as Butcher Row.
Odb or Db :

The market has gone to the E side of London Rd which every day of the week is lined with barrows : SW down Ontario St.

Ontario St. late London St. : 3rd 2nd : 'rather better than East St. nearly on a par with Mansfield St. skirt & tailoring homeworkers : some evident effort at cleanliness in the matter of windows & curtains, rather poorer W than E of Saint Jig St. bread & potato parings in the street : purple Odb : in map purple : S & N up St. Newington Causeway

Skipton St. late York St. : 'like Ontario St. : tenement houses above shops : built to be a shopping street but is a business failure : shops of struggling class, barely make ends meet : purple in map pk.

London Rd. : very busy : the market part of the street stretches from Newington Causeway to a little N of Ontario St. : many Jews for the lane sell here with 'women's finery' : trams, omnibuses

& cabs crowd in here from Waterloo Rd: Black friars road & Westminster Bridge road: the neck of a bottle - E along c

Bath St: poor at NW end: rents 12/ to 14/: 2st. Peculiar Peoples chapel on S side: 'not much favoured, 12 to 15 on Sunday morning': most doors open: purple both: in map purple: N & E along East St to c

Lancaster St: broad: formerly a tram route, now discontinued, lines remain, pk as map: S & E

Southwark Bridge Road: hardly a servant: pk in map pktd: out of the W side is E c

Stanhope Place: on S side only: purple in map pk: N & W to c

Borough Road: The North side is red in map but now v few shop keepers live over &

The shops are of a poor class: pk rather than red: the S lb of map: W of Warwick St is now down & a new public library

is in its place: the Street immediately W of the library is called c

Library St: late New Street: 2st: quiet poor

Southwark Bridge Road - pk.

Borough Road - pk

Borough Road.

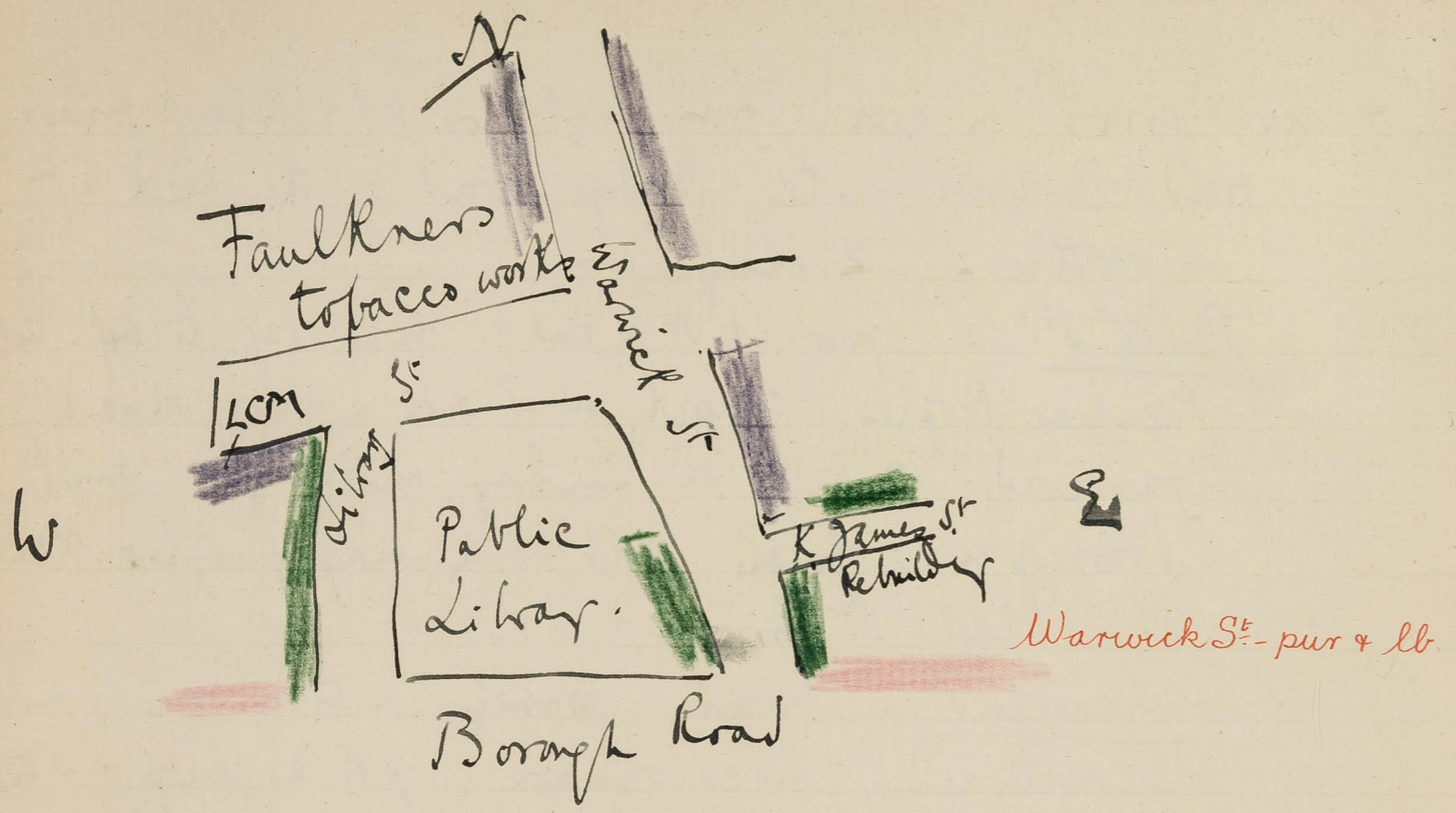

King James St.

tobacco: pub library takes up the E side: lb in map pink: round the corner at N & S lives a London City missionary: on the N side are new buildings of Faulkner tobacco works (pk in map) is a large public house trade in cheap tobacco, cigars & cigarettes: employ 400 to 500. S down c.

Warwick St: 3 st on E side nr of King James St. far to lb: but lb on both side S of K.J. St + 2st: in map pk: E along c.

King James Street: late James St: houses on N side only, until east of minor place: rebuilding at SE end: St. Alphrags on S side: Father Edwards: 'the cotter person': women flock to him: windows of street bad, broad & messy. Bow market pater & cotters: lb as map. at S.E. end is c.

Minor Place. - in map Nina place - 3st tenement houses. 7 rooms to a house: 2 rooms 6/-: great mess of paper: chr. dirt: lb to pub: in map lb:

Out of the N side of King James St starting at the East end run:

upper

Upper Green Street - db

Bean Street - db

Streets between Fried St & King James St

Tupman Place - lb

poor & vicious -

Flint Street - db

Gun St lb & db b^a

- Upper Green St. : asphalted passage : wash across :
2st : very poor : db db : in map lb : W & S down

- Bean St. : 2st : cement paved : every door open : wash across : noisy rough class : 'do a good deal of singing before they go to bed' : children well fed & a little cleaner than in the other Streets, but houses poorer : less furniture to be seen through the doors. db : in map lb : W & S up is

- Tupman Place : late Francis Place : labourers : poor : mess : doors open : lb db : in map purple W & S down is

- Flint St. : has only a few very poor houses of its own at the NW end : the lower blocks are the backs of the Gun Street dwellings : db at NW not shown in map. : W & S down is

- Gun Street : the southern half of the road up for rebuilding : the N half has been up & very badly relaid : loose stones & brickbats lying about : the dwellings on either side at the South end are very rough : crowds of children, girls & women, hooligan boys loafing about N of the dwellings are County Council Dirty

Class

Poor street between Free St
King James' St

Little Surrey Street - db b^d

101
Clendon Bldg. etc : 3st : less poor but poor : lb : gun street
should be lb & db & the whole sh^d have a line
of black : W & S up c.

Miniver St : late Matam St : road up : strong smell of gas :
Lee Swellings : gun St : steps run through at S.E.
children very dirty & inhabitants very poor looking.
lb db : in map lb : W & S down.

Leicester St : 3 & 2st : 15/- for 3st houses : mixture of
factory lab. mechanics & city workmen :
many poor : St. Alphage's Mission at N.E. : people
as map : W & S up c.

Little Surrey St : 2st : very poor : nearly every door open :
heavy bloated faced women : middle aged & old not
young mothers : bird cages at windows : houses in
fair outward repair : fearful mess of bread meat
paper & sacking in the street : 'Same class
as Joiner St' : gas lamps from wall brackets :
children soot-eyed, hatless, some clean : many
cats : organ playing but only one child dancing
db db rather than lb db of map : ~~at~~ along

Trice Place : houses & side only : db as map : W & S down.

Warwick St : 3st : narrow dark street : tenements :
family

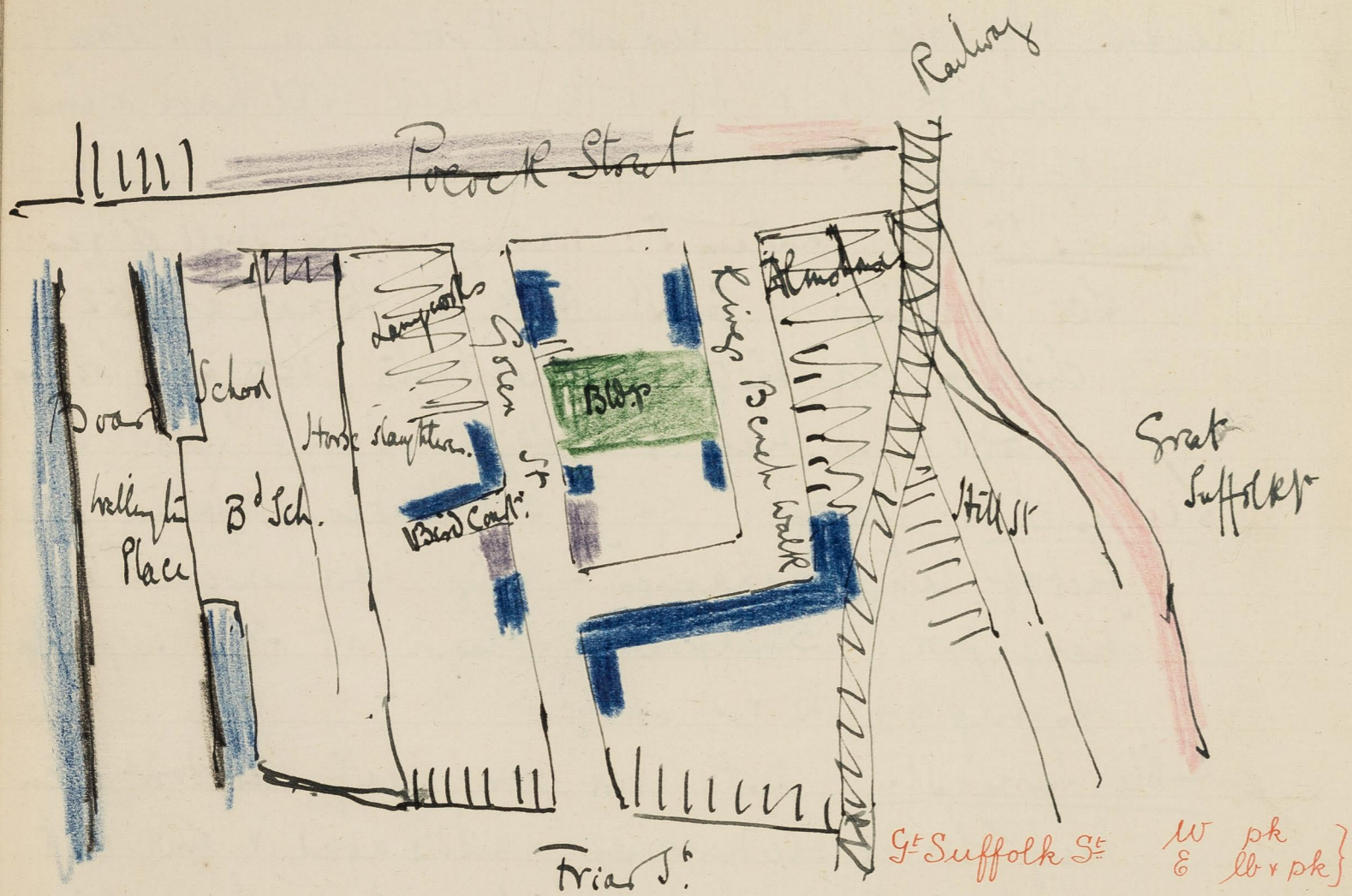

family to each floor: many builders labourers: small
 tanning off w side rather poorer: local paper, mess,
 make the street purple & the tanning lb: all
 in map is pink: N to S

- Friar St: The Hope Mission Hall has take place
 of lb cont shown in map on NE side: Wick
 rotary type machine factory on N side: only
 a few new living on N side: N side bet Green St
 & Board School down: S side are shops with
 poor living over: purple on map but less of
 it: W & N up S

- Great Suffolk St: E side poor: fairly comf on W: old
 shd be pk & lb: in map purple: W & S down

- Hill St: Drapers almshouses still remain, but
 Rowland Hills Alms are now Paswell
 Coopersage: the lb, on S of map is now down
 W & South down S

- Belvidere Bldg: houses on W end: purple
 as map 31 32 st: factories on E: N up

Green St: (see opposite page): some dark blue
 remains: but there are some fairly com-
 -fortable on either side & north of Kings
 Bench

Green St - Buildings purple

Between Little Charlotte St
& Fried St.

Kings Bench Walk - Bldgs purple

Wellington Place - lb b²

Surrey Row - lb

Bench Walk : & wedged close by some poor : on the
E side are Menow & Ripley Buildings : LCC
red brick which run through to Kings Bench
& most of them there are some poor : on the
west side all the courts are down & replaced
by Saloburg's lamp works & Harrison &
Baker's horse slaughtering estab (the same
people have a larger place in Belle Isle) :

Bird Court : remains : to N side : cart board
box homework : lb : & along E

Kings Bench Walk : used to be a nest of crimi-
nals : now few remain : but the old houses are
still very poor : lb : lb where the LCC Bldgs come
through from Green St : (see plan p 103) : in map
lb b¹ : NW along

Pocock St : E end N side is ft : but some poor in
the street : purple as a whole as map : W of Dun

Wellington Place : 2nd : poor : criminal : tops of
cart board hat boxes drying at the windows : ch
well fed : lb to lb : perhaps lb b¹ in map lb :

N of Blackfriars Rd & E at C

Surrey Row : better than it used to be : very poor only
at

Nelson Square

Nelson Square - pk b²

at the NE & NW: some pk on the S side: many printing office labourers: lb: in map lb: (Leave lb at NE & NW): & take off the rd from the S side. out of the NE end is

Caran Terrace: 9 houses: 2 st: 5/- for 2 rooms: no wash house: lb b² in map lb. Map St Suffolk St: common lodging house & public houses on W side - purple b² in map lb. W along c^s

Charlotte St: 3 or 4 st: old fashioned houses: shops with small window panes: asphalt pavement. Lincoln Bennetts hat factory on S side by Nelson Square: 'less hat business done now in London, fewer top hats worn; purple b² in map purple. I am Blackfriars R & East

Nelson Square: old fashioned, balconied, 4² & 5² & 6² houses: good trees but barely kept square: women's University Settlement on the South side & one good private house on the North: but many let in tenements: & servants only occasional: pk b² in map red. Out at the NE corner by Lincoln Bennetts factory

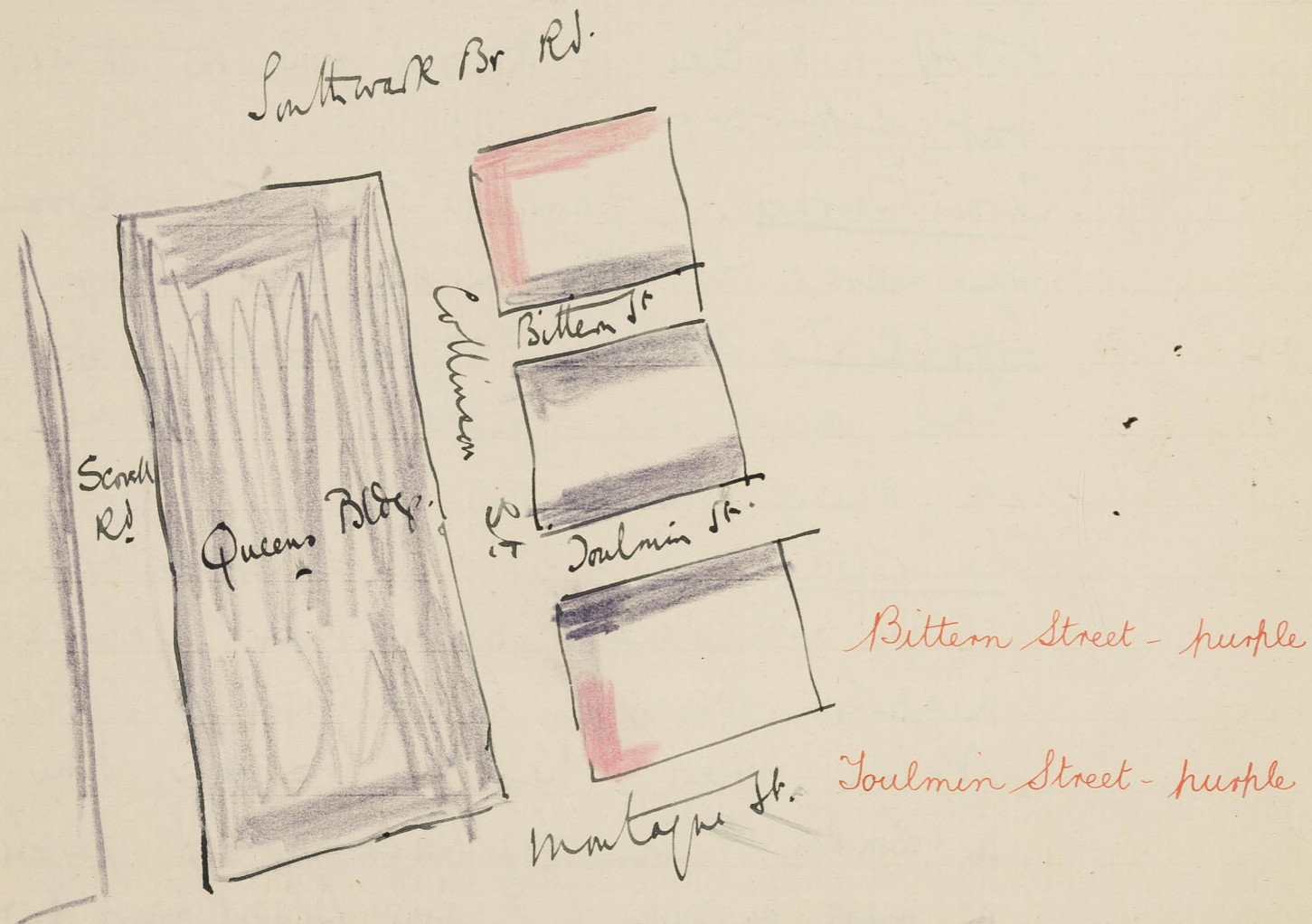

E along Charlotte St. S down 8th Suffolk St. W at Southwark Bridge Road : S down

Collinson St. 6 st : Queen's Buildings on the E side : 'rough, respectable poor,' 'don't get looked up like Bean & Miniver Streets : with a

Deback blocks few exceptions the tenants work for their are less good living : several police : rents : 4r for 1st fl. 6r to 9r : 3r : 6r 7/6 : 2r, 5/6 : 1 shd be th.

The greater number in 3 roomed holdings : people as map : out of the E side an. Bittern St. : out of the E side : is mixed : purple in map pk. & south of it.

Joulmin St. : also mixed : purple : in map pk. the NE & SE ends of Collinson St. are rather better than the rest & might remain pk as map : S & W along.

Montague St. : none living : back entrances to the Police court & to two public houses on either side of it. It up.

Scovell St. : great mess in street : high forbidding 6 storied Queen's Buildings on either side - purple as map.

General

The Worst spots in the Division

109
General Remarks: The block of streets ^{on either side of Friar St} between
Pocock St on the N, the railway on the E,
Borough Road on the S & Blackfriars Rd
on the W, have the reputation of being as
poor, & as rough as any place in the
Division: they only just yield premier
place to the courts ^{between} High St Borough
& Red cross St in that they are not quite
so vicious & there is no single place quite
so bad as Red cross Place: O'dell spoke
of these two & a block off the East
side of Great Dover Street as being
as bad as any ^{district} ~~place~~ in London.
Drunk & disorderly cases, juvenile thieves,
^{can diggers} ~~gangs~~ ⁱⁿ prostitution & a rare coarse roughs
& a few prostitutes come from the
Friar Street area: the courts between
Redcross St & Borough High St have
all these & a good proportion of pances
& prostitutes of the lowest class as well.
O'dell is a fat man, very fat, he is not now
in active ^{outdoor} duty but is employed in the
clerk

Crime.

Emigration.

111
clerk's office. He is intelligent & knows a good deal more about the different parts of the division in their criminal aspects, than most of the policemen who have been round with me. All charges - from every quarter pass through his hands every day.

Juvenile throwing & betting he spoke of as the most serious increases on the charge sheet. Drunkenness does not decrease, but vagrancy does: the population is easier to deal with from a police point of view than it used to be.

The departure of the fairly comfortable from the district, he also said was most marked ~~at each~~ ^{at each} the displacement of the very poor by demolition for new warehouses & railway extension ~~also take their places~~ the very poor ^{comp} get in as close as they can to their old haunts & in many cases replace the fairly comfortable. ~~In consequence~~. The net result is that the very poor are slightly better off than before but the

Betting.

113
District as a whole loses, because every year
the proportion of the very poor to the
fairly comfortable becomes larger.
Betting the police try to stop but fail:
Cately their efforts have had a check:
at the N end of Wellington Place is a
beer house where money is paid over by
the bookies' agents to those who have
won: on this ground the police ran the
offenders in but the magistrates held that
although betting was illegal the mere
receiving of money from bets already
made was not so.

District covered.

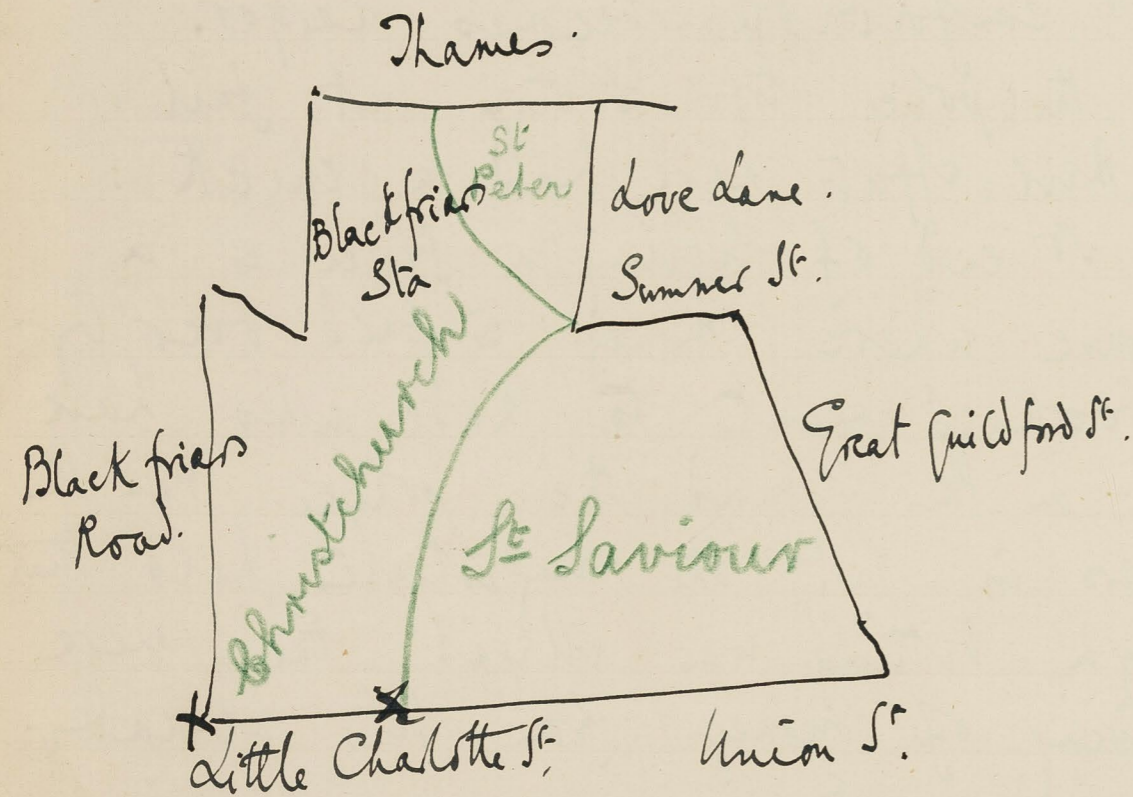

Scoresby Street - purple

May 13th 1854

Dist 31

Police

31
10

J.H.S

With H. Barton. road district bounded on the North by the Thames: on the East by Dove Lane, Summer St. & Great Guildford St. on the South; by Union St. & Charlotte St. & on the West by Blackfriars Rd & Blackfriars station: being part of the parishes of St. Peter, Christchurch & St. Saviour.

Starting at the corner of Charlotte St. (late Little Charlotte St.) & Blackfriars Road c.
Charlotte St.: purple as map: at NE end the Parry Chapel is now a factory of garden implements: up Blackfriars Rd NE at Scoresby St. late York St.: 3rd: working class: printers, harness makers: whole house taken as a tablet: 3rd, 7th: S side is railway arches per table in map lb: E & S lane
Gambia late William St.: factory SE (in place)

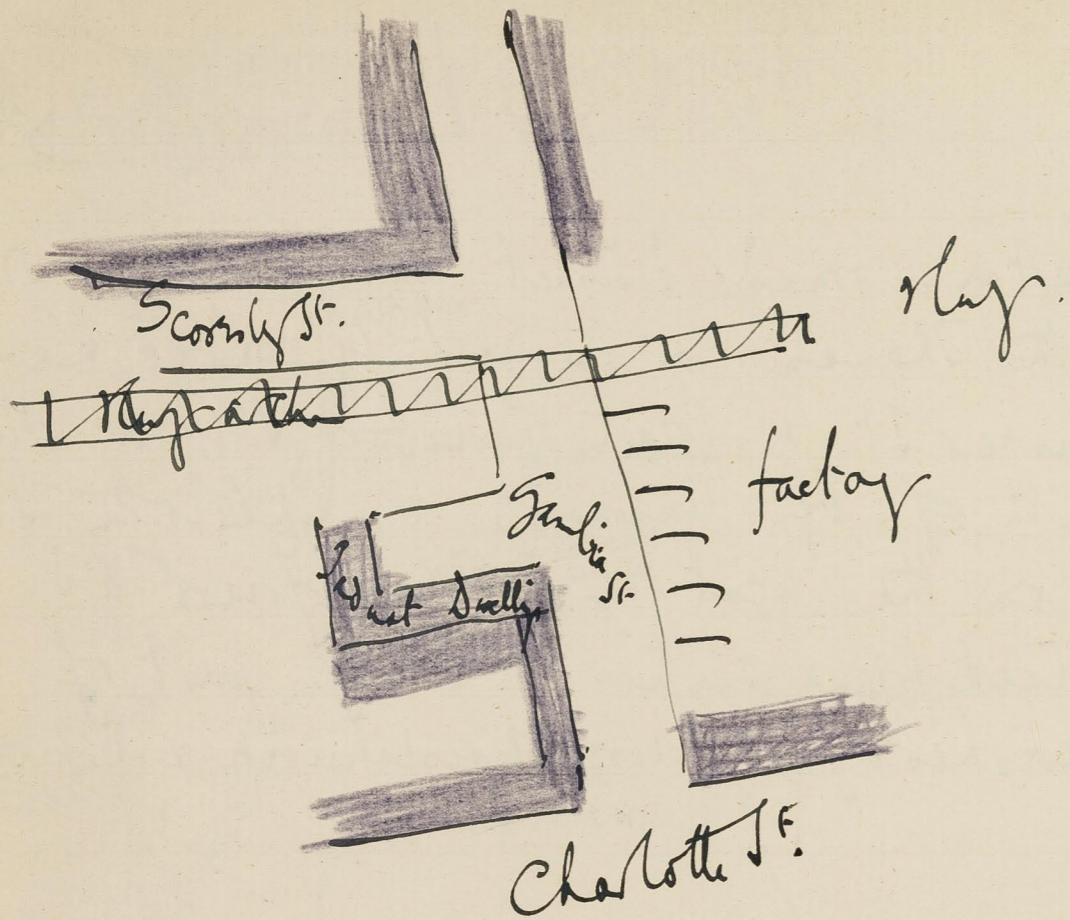

Edward St. E of Railway Arch - lb

place of lb on map : Industrial Dwellings SW.
 built 1880 : 3st : children fairly dressed : put
 to lb : in map purple : w along
 St George St. : a photo : 3st : like Scornby St. : Gilbert's
 lodging houses at SW end : beds 6! a night : 2/6
 a week : regular tenants : bed cases at house
 windows : put by k in map purple : there
 shd. be houses also at the E end N side
 - just west of the railway not shown in map
 E. N up

Bear Lane : mixed : Armstrong Whitworth ^{ordnance} factory
 at SE : Isles Artesian well work on W side.
 Christchurch parochial school now in place
 of Herley Square. (lb in map) : north of the school
 Bear Lane is called Herley Terrace : & this might
 be purple : in map lb : w along.

Edward Street : 2st : poor houses E of railway : lb in
 map purple : west of May is purple as map :
 on the S side are the 5st. Ponsoby Buildings
 mixed class, hatters, casmen, printers : they
 run through to Charles St. : S & along.

Charles St. : 3st on S : 5st Ponsoby Bldgs on N : put by k

Between Blackfriars Road &
Gravel Lane

Paved Place - db

in map pk : 2 into c.

Chance St. : late Robert St. : Albert Institute &
free library takes up the C side : St & Walney

Burrell St. : on the S side are Edwards Almshouse
founded 1753 : rebuilt 1891 : where Burrell St. turns
north to Southwark Bridge road one up over house on
the E side : child with dirty head thrust through
broken pane of window : lb : S down Beale

& Eat Prices St. : old faded narrow : improving with a
different class of house at E end S side : lb to
par : in map par : mechanics & lower men
at E end : S down Gravel Lane : out of W side

Paved Place : 2st : all doors open : one bare foot :
rags : faces fairly clean : '3r for op.' : no wash
house but yard behind : windows bad : women
with sack aprons : not vicious of school
board case : mostly one family has house
db & lb in map lb : out of ~~the~~ E side of
Gravel Lane is c.

Fanham Place : 9 houses, 2st on N side : Side
monopolised by Messers' yard for
steel building joints : lb on S side gas : St

Great Guildford Street - pk

Disappearance of db lb in America St
& Keppel St.

Summer Street - pur

N B: the lb carts & ^{W Scheeds} ~~Cartons~~ of
Summer St (S.W end) are down,
not yet replaced.

- Lavington St: all offices & warehouses: the lb
cart goes (called Dyer's Buildings). E & S down
River St: Baths & washhouses at NE: a map
E to C
- Great Guildford St: only 3 houses remain on the E side
N of Keppel St: small shops - pk: & a few on W
also pk in map purple: on the W side is the
Grove Mission - the rest is factories: out of
the E side is C
- Keppel St: in map lb: now a paved passage
between factories: S of it is C
- America St: in map db: now factories on N side
& railway extension on S: rest of the block up
to Guildford St is C
- Canoe St: late Essex St: lb on N side is pur
Map of Guildford St: fairly conf. houses on
NW - pk as map: W along is C
- Summer St: small shops: some poor over: old
fashioned: pk to pur: in map pk: S down
Canoe St: late Essex St: Buildings lb to
pur: at NW: in map lb: E along is C
- Colin's Place ^{late} Pleasant Row: no houses, great mess at E end,
bread

Small colony of poor between
Summer St & South West St.

grad. rags bones, etc; where it turns N it is called
Wagstaff Buildings: old wooden set houses: nearly
all closed on W side: narrow passage between houses:
box maker: '6/6 for 3 r o wash house': lb both in
map lb: W along Collier Place: S & E along
Zoar St: 2st: clean: houses tidy: 4 1/2 ft of
cement up the outside walls from the ground:
evidently carefully looked after: many poor:
lb to par: in map lb: one woman pays 8/- for
4 r wash house: another who has been 15 in
her house & 20 yrs in the street: 7/6 for 4 rooms
out of the S side is in

Hopetown Place: 22 houses: clean windows: flowers:
many doors shut: 2st: '8/- for 4 r o wash house':
lb to par: in map lb: W of Convent St Zoar St
is poorer: 5st Bldgs on S side (lb as map):
children dirty, noisier, more bread lying about,
well asphalted: at NW end, much poor, gas
workers: lb & lb as map: S down

Canvey St: like Zoar St: lb in map par: when
it turns W, more roof, par as map: N &
E along Cashe's Grounds: very poor parts of Zoar St: lb
as

Holland St.

broad - asphalt - *Ridley Place - pk*
cricket being played across it by
lads of 16-18.

Knights Court - purple

Hoptons Almshouses

It as map: *Howards Boxworks*, on N side, large: N.E.
Summer St. N along. *Holland St.* c.

Holland St.: old mixture of old sloping tiled roofed
houses & modern: a few lived in by foremen
& poorish at N.E.: purple as map: out of E side

^{to}
Ridley Place
~~Knights Court~~: 2 to on N side only: leading to
the 'Bottle Exchange'. par top R in map lb: W
& S along *Holland St.* Epps large cocoa cocoa
factory: are careful about the girls they employ
on S side: out of the E side is c.

Knights Court: 2 st: clean, quiet paved houses
on N & S side: par top R: in map lb:
The medical mission at the SW end is an
old house with wrought iron railings: S of
Knights Court are.

Hoptons Almshouses: pretty: old: rather ill
kept grass.

District covered.

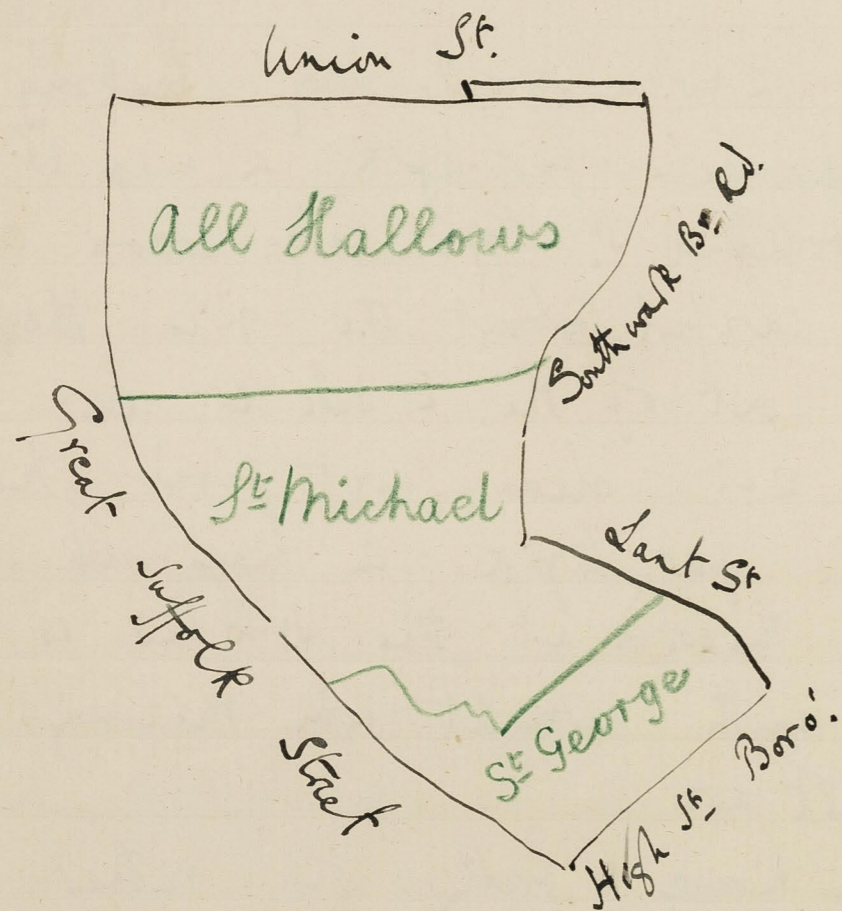

Damon Place (SW Union St.)
lb

Risboro' St N of Orange St - lb

Orange St - lb & fur.
red at N6

May 16:

Dist 31 ^{Police} 31 / 3 S.H. 1

With St Barton round district bounded on the N by Union St, on the E by Southwark Bridge Road, East St & High St Boro, & on the West by Great Suffolk St, being part of the parishes of All Hallows, St Michael & St George.

Starting at the corner of Union St & Great Suffolk Street: E along Union St out of the S side is c/s

Damon Place: clean, tidy, 2/2nd lanes on E side of lb in map db: S down

Risborough St: 2nd: some poor: others first class: poorer S of Orange St than N of it, lb in map db: on E side only: S to c/s

Orange St: factories on N side: db goes: 3rd: old inhabitants, cobble paved, clean street, lighter. -- men waterside labourers, no trouble to the police: lb in map db: East of ^{Agent St} ~~Risborough St~~ on the south side are, very pretty Miss Hill-like cott.

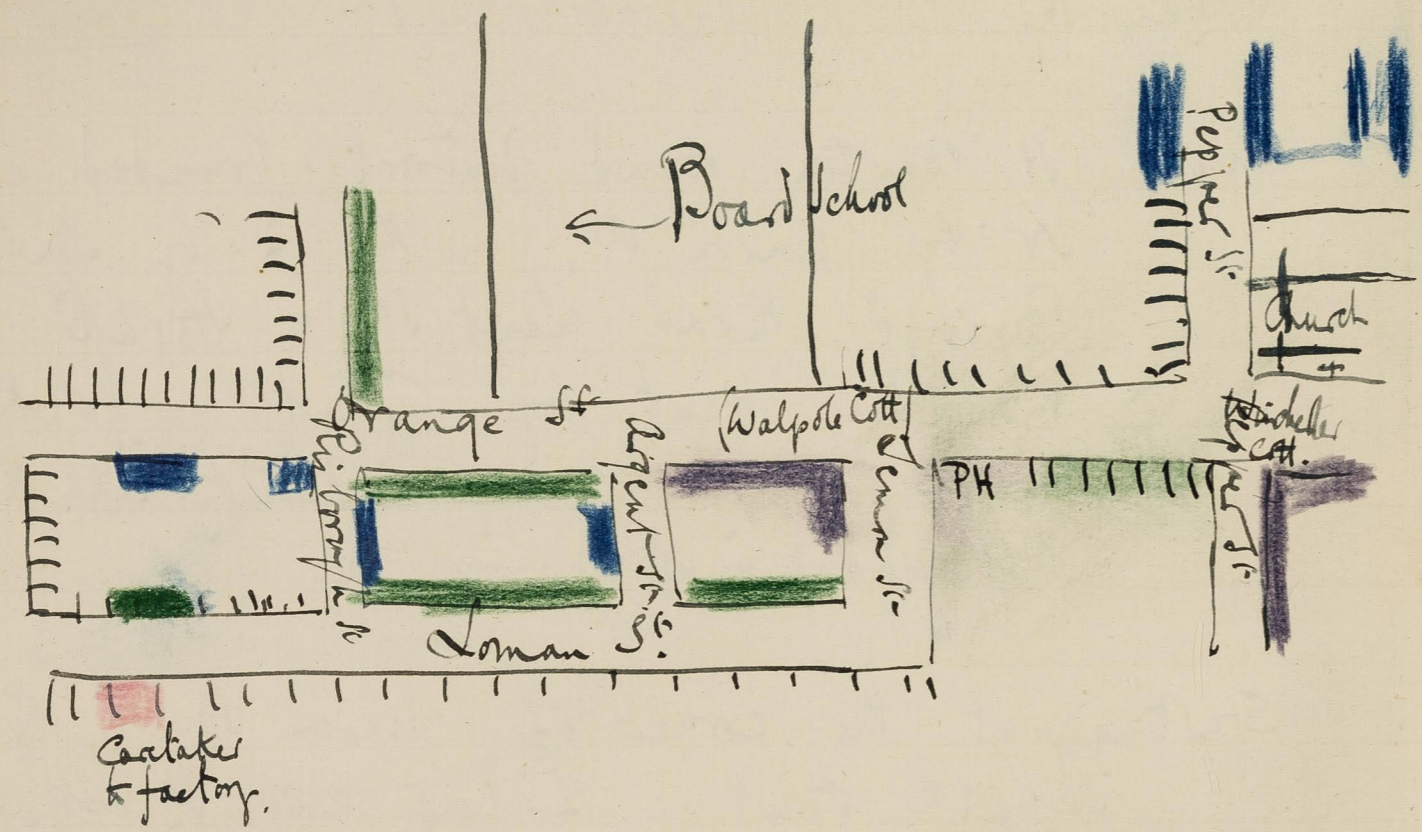

Lowman St - lb

(Walpole Cottages)
 cottages, with green wooden doors, red tiles: these run
 to the corner of Lemon St: E of Lemon St are others
 in different style called Winchester Cottages:
 at the E end on S side are 4 st. Winchester
 Buildings poor: lb 606: not criminal:
 in map lb 606: mark the cottages pur-
 ple & the Buildings lb 606:
 many spring flowers in the cottage windows,
 cowslips, bluebells etc: S down
 Argent St: which is the road E of Risborough St: at
 of the S side of Orange St: 2 very poor houses
 on W side only: lb as map: S to
 Lowman St: 2st: gen lab & carmen: clean:
 for 6 rooms house: ~~an~~ old wooden house still
 standing but wanted at the West side ^{+ 3 2st houses partially} lb 606: in
 map lb: #2 along Orange St: S down Southwark
 Bridge Rd, past the headquarters of the Metro-
 politan Fire Brigade: on the W side of S.B.R. South
 of the Fire Station is
 Goldsmith's Place: 14, 2st house: very poor: some
 houses with fair furniture: cost rather not very
 mesog: dirty ch.: 6/ for 2r small yard: lb
 as

Victoria Place - SE Union St - pur.

Golden Place - db
All Hallows ③

Sant Place (W. end only) db

map : N to Union St then W : out of the S side is
Townshend yard. Houses on E, N & S. : poor : map : quiet
clean : houses done up out waddy : 'I think they
ought to do 'em up inside now' said a woman who
pays 8/6 for 4 rooms & yard on the S side :
houses on N side 2r for 5/6 ^{less map} W : South Jan

Victoria Place : entered through iron gates :
All hallows mission at S end : E side better
than W : quiet : '1/6 for 4 rooms & yard & wash-
house' : two houses in a passage on E side :
E side is pt loop : W is lb : mark the white
people : in map lb. : W & S down c.

Pippin St : very poor : houses on both sides.
db : as map box : E along c.

Golden Place : R. Church on S side : the place
turns abrupt N : 6 houses : narrow : dark :
'4/6 & 5/6 for 2r'. 'mere cupboards' db : in
map lb. E to Southwark Br. Rd : S past Gold-
smith's place, W at c.

Sant Place : cement paved cart : with zinc
Just bin. doors open : potatoes, parings, basins
plates etc, on the tables, windows cracked.
houses

'2r .5/ 15/6'

The Grotto district.

→ houses with fair amount of furniture but very poor: houses on N & S sides of E end but only on N side of West-end: no communication with Kings or Queens Court. ob 6/6: in map to 6/6: out of N side is Grotto Place: 2st: v poor: like Sant Pl: enters barrow: ob as map: N of it is Lower Grotto Place: the worst of the lot in appearance: it is a continuation of but is walled off from Goldsmiths Place: 5/6 for 2 rooms, no washhouse but a yard behind!

This bit is known as 'the Grottos': many children: all well fed but dirty & with sores on faces: clothes ragged, too large & too small, windows broken & patched: there may be a few thieves & prostitutes but Barton does not know them as such: they make their appearance in the police court for drunks & assaults: many carmen: ob. 5 down as

Sturge St. 2 or 3 storied: 4th washhouse 10/-: head about: it looks very poor: but Barton says that it is much better than the Grottos. ob 6

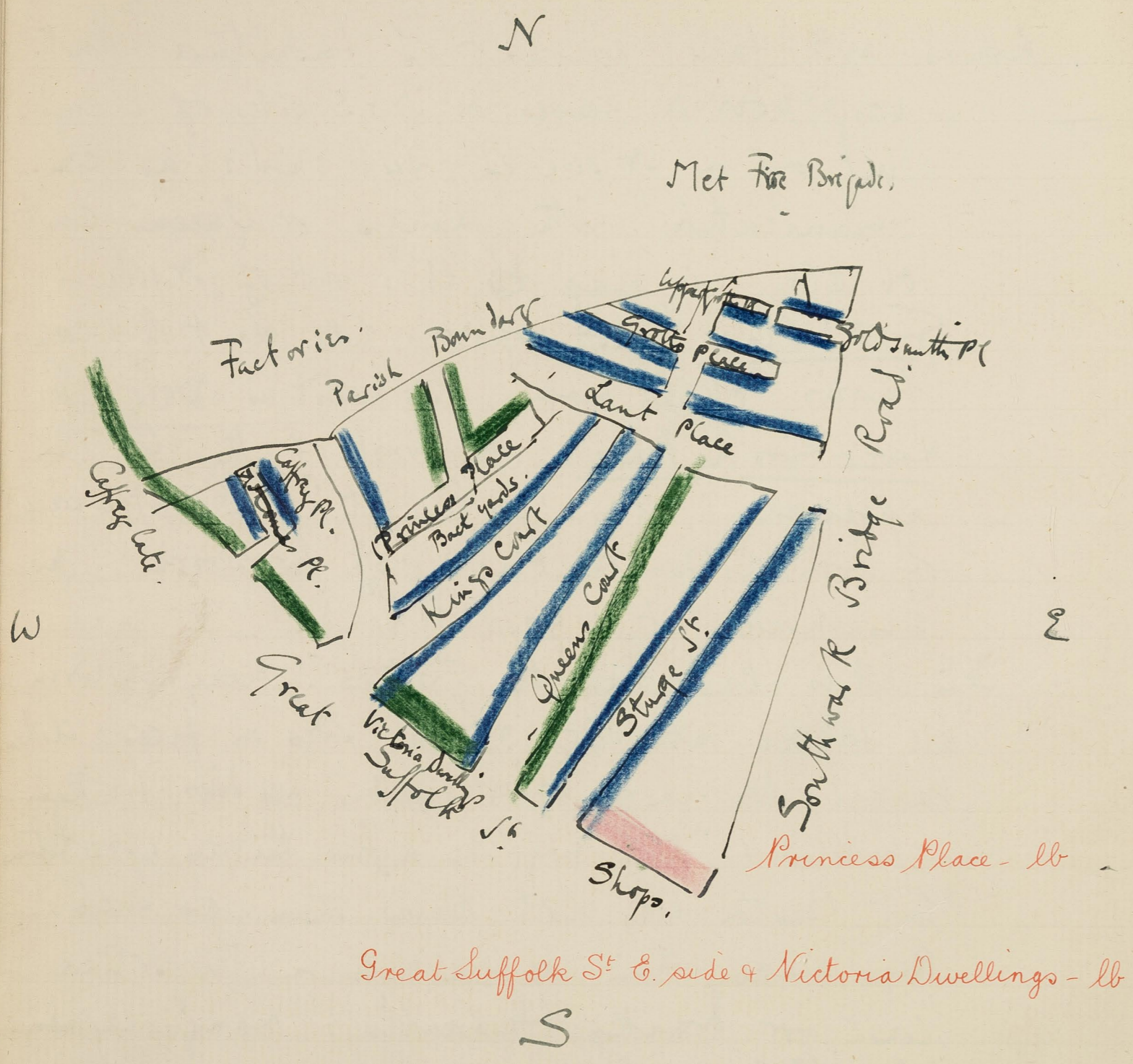

Great Suffolk St E. side & Victoria Dwellings - lb

lb lb : in map lb : W & N up c.
 - Queen's Court: cement paved: 1 & 2 stories: rather better on the E side than the W: children clean but plenty of lb: lb lb : in map lb : W & N up c. 24 for 5/-
 - Kings Court: all restored: all chs well fed, out of 20 playing in the street - ages from 6 months to 14 years - about 1/2 with clean, 5 with dirty & 5 with very dirty faces - clothes sufficient: lb : in map lb : at the SE end are the Victoria Dwellings - lb : in map purple: Boston said that these courts are poorer but not criminal like the streets off Friar Street: out of the SW end is Princess Place with courts running out of the W side: the southern court is the poorest: rough looking: windows broken: bird cages at windows: flowers: Southern court is lb ^{asffmap} rather than lb: the rest lb ^{in map purple}: 15 ft W & N etc.
Caffrey Place - late Thomas Place.: 10 houses: 15 ft frontage each: 2st: 6/- for 2 r wash base cement paved clean: lb lb : in map lb & uncol

South down c.

Great Suffolk Street: East side much poorer than West: pk to par on W: lb on E: in map both are purple: east of Sturge street shops begin: pk: trap c.

Little Suffolk St.: houses on E side only: Cable Collages - (Miss Hill?) gables red tiles, 2st: par to lb: poorer 2 & 3st houses north of them: strong smell of cough lozenges: Rowland paragonic is made in a factory on the E side. par & lb as map: E along East St: S down

- Bittern St.: late William St: 2st: bread, paper, bones etc: 'drunks & assaults': lb in map purple out of the E side is c.

- Rodney St.: 2st: lb to db: sores: lb in map purple: there is no lb east of the Board School: S down.

- Toulmin St.: lb: in map purple: W along

- East St.: W end poorer than E: lb as map: Map c. at W end are Brigade Bldgs: par to lb: in map purple

Lombard St.: very low mixed class lodging houses on E side: low men women: hold about 40:

Bittern St. E of St. Suffolk St. - lb

Rodney Street - db

Toulmin St. E of St. Suffolk St. - lb

Brigade Buildings - pk

Mint St.

Mint Street @ SB. - red

Nicarage.

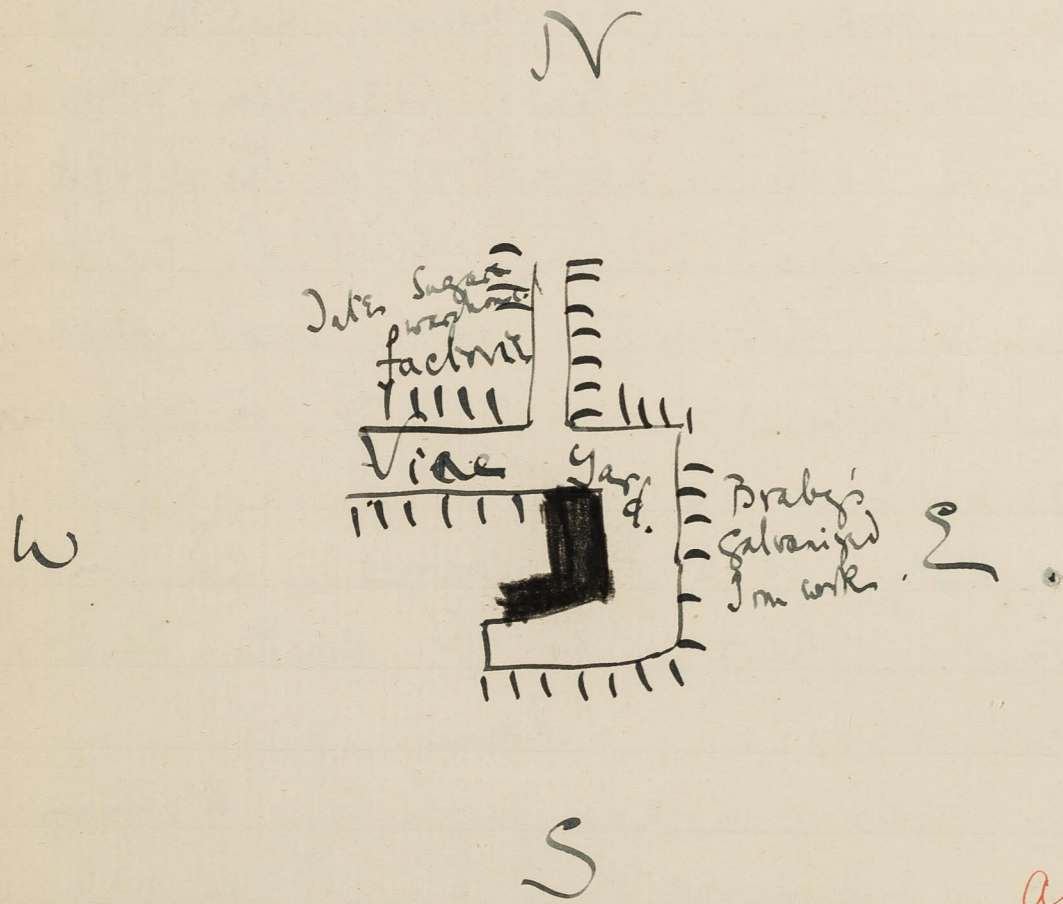

Aster Place - purple

the Evelina Hospital extended across the block on the W side: block on E remains: the block continues round into Mint St.: where ^{houses} ~~the~~ houses look more respectable ^{they appear on lodging} but have the windows trimmed with the same red curtains as the lodging house in Lombard St.: E of these is a mission club room with (St. Michael's Mission house & Club) with a curate or caretaker living over: further E are on the S side the Douglas Bldg: & Macomber on the N: are not so good as Brigade Bldg: police (about ref. mechanics, warehouses: pR to par: in map pR. 3 down.

Narrow St.: factories on E: Bldg on W: ~~to~~ E along Vine yard: houses at E end only (see plan). 2nd: lowest class of prostitute floater: men brought home: black as map but less of it Sacros Sant St.: down

Aster Place: late Ann's Pl: 2nd: par till in map to: E along Sant St: factories on either side & into the Borough Street S: out of the W side are

41. 89'

Nelson

Transference of poverty.

Rents.

Vine yard.

Nelson Place. flagged coast, 8 houses, women rough, dr-deer
widows bad, window boxes - scavengers - 'drunks' - lb to
lb in map lb : Soft it is in
Star yard. : shaming forge : stable rats : lb as map.

General Remarks.

In this round there is more poverty in the
Grotto area & in Bittern, Tolmin & Rodney
streets off Cant St. but there is considerably
less in Orange St & the streets off it : the
S end of Cant St which was formerly db'd
has now a church & rectory at on the or side
& Winchester cottages on the S : the only
rough bit remaining there are Winchester Bldgs
at the S.E end of Cant St.

The poor class are carmen, waterside labourers
Rents vary from 4/6 to 6/6 per week for
two rooms & a yard or wall house : old
tenants paying rather less than new.
The worst spot is vine yard happily only a few
houses, difficult of approach & a dangerous
place at night.

District covered.

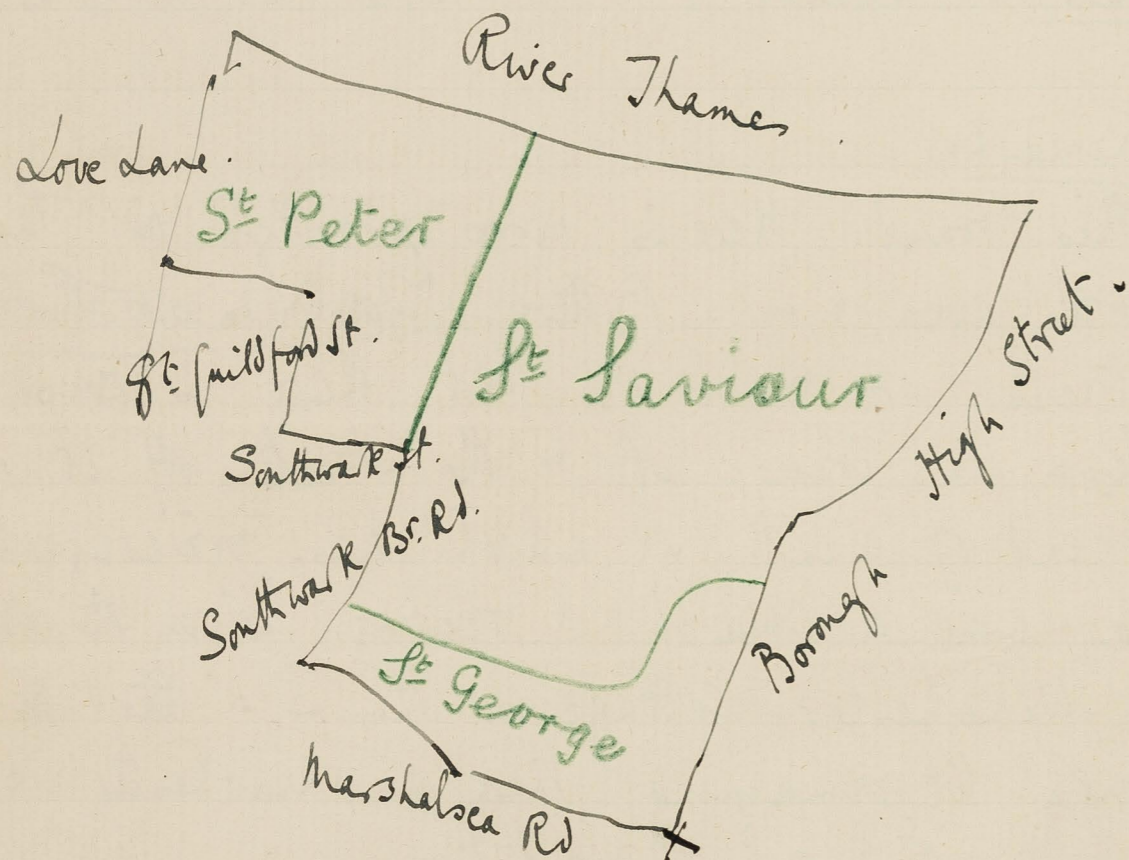

May 17th

Police 31 / 1
Dist 31

J.H.D.

with H. Boston round district bounded on the north by the River Thames, on the east by Borough High St: on the south by Marshalsea Rd on the west by Southwark Bridge Rd, Southwark St, St. Guildford St & Love Lane: being part of the parishes of St. Peter, St. Saviour and St. George.

Starting at the corner of the Marshalsea Rd & the Borough High St: W along Marshalsea Rd c. Marshalsea Rd: Lodging house on N side & of Harrow St. rough. do to black: in map black. N up Harrow Street: very poor & rough, criminal: est well asphalted: at the corner of Birdcase alley are Furnace lodgings for ~~men~~ women only: west of Harrow Street on the North side is another common lodging house: with a stair coming from the vicars

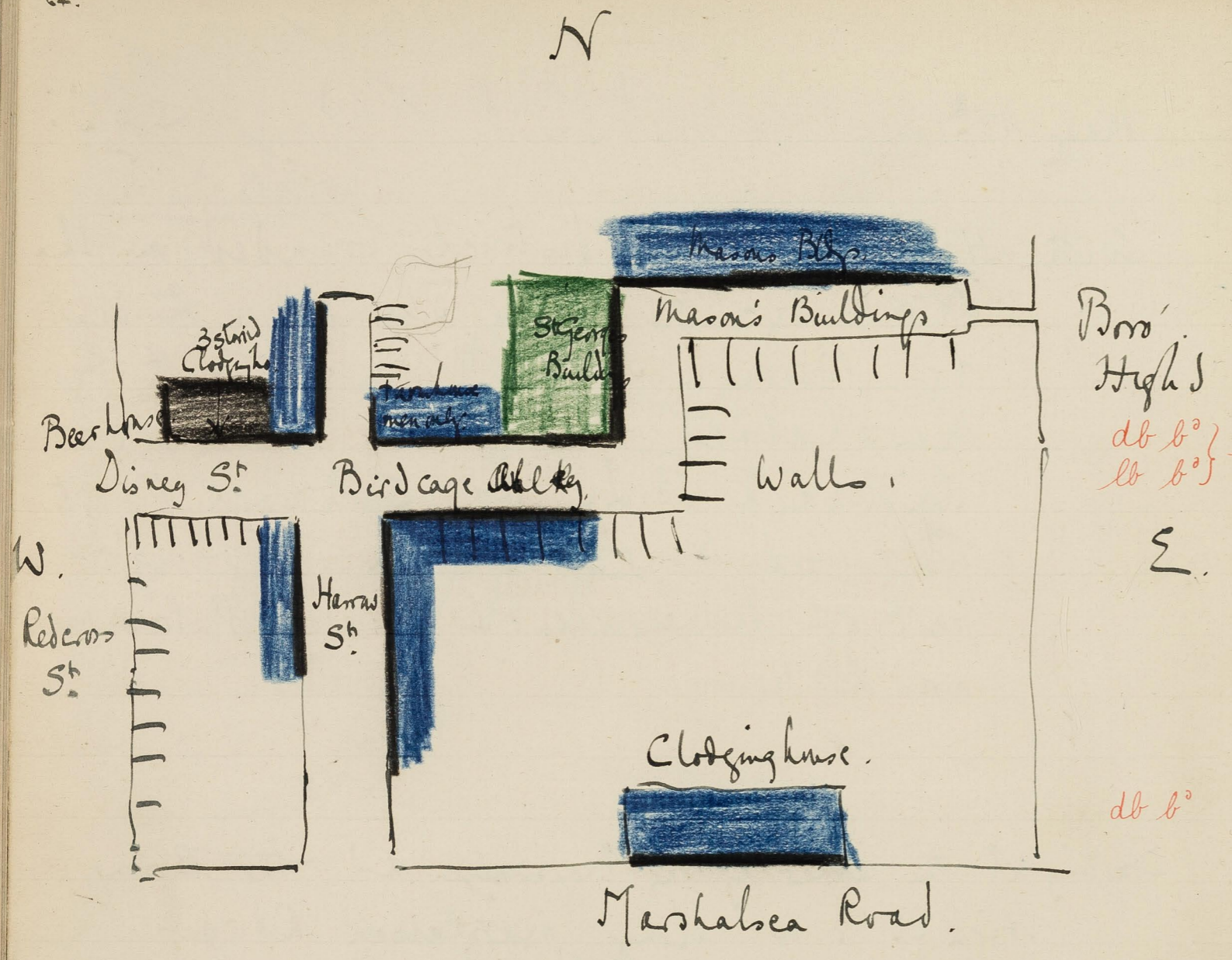

that reminded me of Meland Hall: broad mess
 in street: one woman in the end door
 continuation of Harrow street pass'g for
 3 rooms & wash house: quite enough for three
 poky holes: ~~to~~ along
 Birdcage alley: with Farmhouse & Lodging house
 St George's buildings on N side & two or 3
 2nd houses on S. ~~off~~ St George's Bldgs.
 looks better than the rest - better class of
 wash hanging out today - but Boston
 gave the whole place the same character -
 along Mason's Bldgs: v. poor: houses on N only.
 The exit into Borough High St is down passage
 under house not a yard wide.
 The whole of this bit might be black: the
 inhabitants of the houses & Lodging houses
 are prostitutes & pances & thieves: those
 in St George's Bldgs are waterside labourers
 & market porters: (no gatter merchants).
 youths & middle aged men of the lowest
 casual class loafing: underground men:
 women slouching with dragged skirts,
 hatters

Courts out of the west side of the Borough High St.

Falcon Court - black

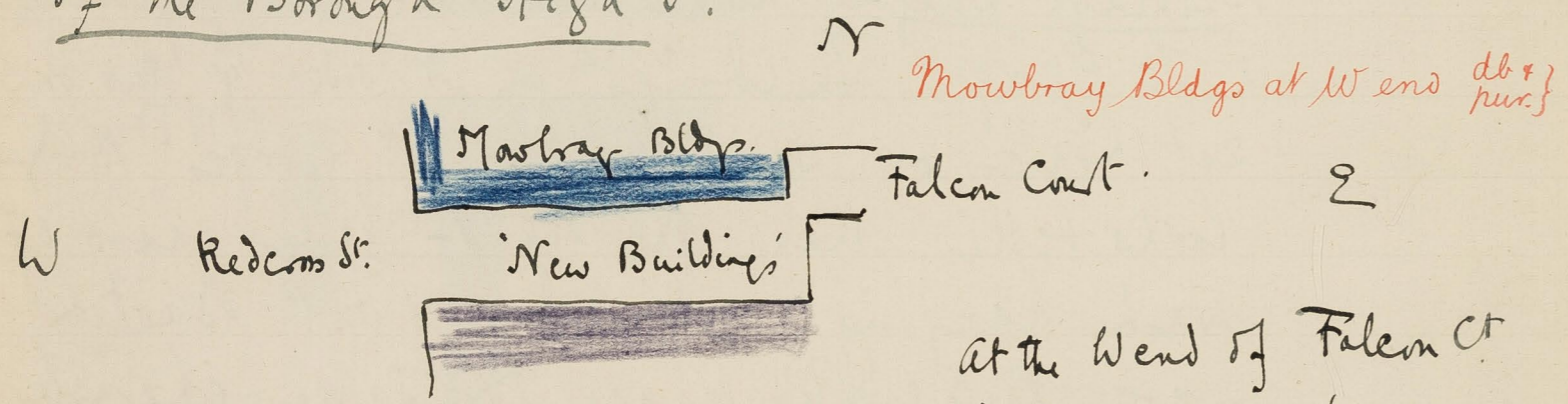

at the West end of Falcon Ct is 'New Buildings' 7 set houses on S. Mowbray Bldgs on N: pur + db.

Brents Court S side lb

Roman Catholic School at West end

Eves Court - db

but hidden under long shawls: a deformed boy with naked half formed leg turned in the wrong direction, made up the scene. Mr Walney Falcon Court: houses both sides, old-fashioned, red-tiled, small paned windows. Buildings at West side: women's common lodging houses on N side; at the Borough St end there is a public house at the South side & a pawn-brokers at the N: Rieves, prostitutes, bullocks, prostitutes standing at the Boro' St end, spiders to catch flies, women sitting on door steps; Bolton said it was bad but not so bad as Red-cross place. An awkward place for a stranger at night. Black - rather than lb of map: Map Borough High St & west at c.

Brents Court. 3st on N: 2 1/2 on S: South side better than the N: '7/6 for 3 rooms & walk down stairs': attention paid to flowers: Virginia creepers in window boxes: fine hydrangea in another window ledge: N side db: South lb: in map both are db: N & W along Loes Place. late Adams Place: 2+attic + 2 1/2+attic (palinged)

Redcross Place.

Redcross Place - Stanhope & Mowbray

Bldgs: - db (behind)

W side S of Glenhorn St db b²

March 18th 1902.

Went by appointment to see Supt. Walters now in charge of the M police division to ask what had become of the ^{withheld by the} courts in the Ross' High St (off W side) demolished since my going ~~in~~ the district. The courts from Union St to Marshalsea Road are now down leaving the western line of demolition running down the back of Stanhope & Mowbray Buildings. Nothing so far has been put in their place except a cement playground that now takes the place of S. George's alley & is bounded at its west end by S. George's buildings. This playground is called 'Little Dorrit's recreation ground'. The whole has been cleared under the LCC Falem Court Scheme. The playground is surrounded by high walls, has no seats & for ornament there is one gas lamp in the centre

palinged fronts on N side: poor & very poor: a few respectable with brass paraffin lamps as ornaments in the window: db b² in map lb. Nap High St West
Redcross place: 3 + 2 storied on the N side: 3 storied on the South: Notorious women's lodging house at the N.E. end: & to its owner belongs 4 houses on the South side of the place: hardly a whole pane of ~~window~~ glass in any window of houses on S side: A ~~stair~~ of stables (one storied: some living there) runs down the centre (db in map): tenanted by one scabcrow horse: stable yard used as a dumping ground for horse refuse & full of manure, head, bones, rotting oranges, brickbats: 'stabling to let' on a notice: 3 women sitting on doorstep at ~~the~~ ^E end: one suckling a child, bare breast, no attempt to cover herself as I passed: all of lowest type, the other two huddling under shawl: women decoys at entrance to High Street: Barton was nervous at my going down here alone saying the chances were in favour of

X

P.S. This danger overrated: have been
down twice since alone at night
between 11 & 12. P.M. (G.H.D)

(cont from p 148)

centre & a small drinking fountain. It is essentially a playground
for rough children, no seats because of the encouragement to loafers
nor any caretaker. I have only been there during school hours
when very few children were about.

The old inhabitants have all moved into to the nearest streets
possible. The women into Leo's common lodging houses at
the NE end of Whitecross St, in Horrow St in Marshalsea Rd
& in Lombard St. They are Irish cockneys, their bullocks are es-
pecially in men's lodging houses. The charges of such prostitutes
Magpole Alley are 4 or 6. Sometimes only a pot of beer.

The others have for the most part gone to the Trias St area esp
to Little Surrey St Warwick St & Sun St: a few also East to
Newmaid Court to Trinity Buildings on the South Side, these
Bldgs. (lb in map) & Chapel Court on the S side (people barred) might
both be 18thth now. The demolition has only caused greater
crowding near by. Sergeant Bowles does not think any
have moved out, only that more live in one room instead
of

brickbats or slops upon my head: many
will faces at the windows but nothing
happened: rough children & lads of 14 or 15
holes, ill clothed, dirty, well fed playing
at wood chopping with a hatchet at hand:
'any man at all the worse for drink has a
bad chance if he ever gets in here at
night: he is sure to be robbed of everything
& is lucky to get out of the place without
bodily injury: an obvious improvement
w'd be to sweep away the stable & foul
stableyard. Mackerel being cried at
1/2! each. 'Police dont go down here un-
less they have to & never singly.' Magpole Alley. entered through passage under
houses from the High St. 3 or 2 stories: some
very poor: one middleaged woman pulling
fur at her open window: air full of
fluff & herself covered with it, spoke in
shaky husky voice: 'must do it to live
you know'. fair amount of furniture in
the houses: one with brass time piece under
glass

cont fr. p 152:

of two. Rents have risen, crowding is greater. Common lodging houses are worse. Levy has been convicted & fined for using one of his houses as a brothel: he was found to have double the number of his licensed beds: still the LCC let him be. Capt Bowles does not want the police to have again the right of inspection of these houses but he does think it used to be better done in old days by the St. Margarets Court by the police than nowadays by the LCC.

Children drink. 'Beg pardon sir, I don't know what you think sir, but that was a rotten law, sir, that prevented children fetching their parents beer.' The effects seen clearly in the Boos: women go & remain, drink in company, more drunk & more drunkenness, spreading to young factory girls. 'Not a doubt about it' said Bowles.

Women home leaders, a feature in the poor street migration. Those born here would rather live here anyhow than seek better quarters in another district.

Street improvements: Boos High St. is to be run down behind St. George's Church into Long Lane & the corner of St. Dover St. & Long Lane to be also widened.

Capt Bowles is a young man about 30, smartly dressed, in this Division 4 years. fair mountebank, came here from Westminster.

glass shade: elaborate wooden carving over one door
lintel: windows bad: sewing machines at work: lb to
lb: in map lb. rents 3/6 for 2 rooms: 6/6 to 8/3
for 3r. no washhouse but backyard: wash hanging
across the yard out of the front: more poor than
bad. N up High St. W at c.
maid stone Bldg.: only washhouses: uncol. as map.
N & W at c.

St. Margarets Court.: 3r 2st: mixed poor: a few
fairly comfortable: a little village by itself:
small paneled windows & shops of its own: brave
show of flowers in boxes at west end: the tuning
N out of it is rather poorer than the rest!
it is a flagged passage. ^{the map} rent. 3 room for
7/6 no yard! West into c.

Redcross Street: poor at N end: lb as map:
out of the 2 side is

Wood's yard. 4 houses on N end: overhanging
wooden tops, red tiled roofs, lb as map but
less of it: stables at E end: South down

Redcross St.: South of Union St. on the E side
are first some poor houses lb as map: then
come

Red cross St.

come blocks of Metropolitan Industrial Sewing
 Company. houses: the two northern block
 called Stanhope Bldg: the two southern - New-
 -way Buildings: the front blocks are better
 in both cases than those behind: out in
 the front blocks. ~~Stanhope~~ ^{Stanhope} Bldg. single room
 3/- . 2r. 4/6 r 5/6 : 3r 7/1 r 7/6 :
 Newway Buildings: single. 3/- . 3/3 r 3/6 .
 2 rooms . 4/6 - 4/9 . 5/4 5/6 .
 3 rooms . 7/3 . (taken from notice board)
 This place is the dividing line between Stanhope
 & Newway Bldg: the windows of the back
 blocks are very bad: many thieves but not
 many prostitutes in them: they are 5 store
 high: dingy: bad meat & mess in the
 street: mark fronts lb: backs db:
 or dbd: in map both are lb:
 Opposite on the west side of Red cross St. is
 Red cross gardens: carefully laid out: pond: music
 bridge: mosaics let into wall on N side:
 flank on N & South by walls of high hop
 warehouses: galley with covered flagpole
 under

under running along S side : band stand : several but not very many old people sitting about on the benches & a few children : Cottages on W side & Redcross hall - the cottages are well tenanted & quiet : the S.E. end of Redcross St south of Falcon Court are small shops - gen shop two small dairies - barber etc - not known to the police as receivers - purple in map lb : South of Birdcage alley - is all factories in map black : on the W side South of ^{Glenhorn} street is very poor : might be db. in map lb.

W almy es
 Quilp St. : ^(late Queen St) 5th Bldgs on the S on S side : pk to purple in map pk : N up es
 Dorrit St. : common lodging house at SW, 4^d 16^d, black : very poor on E : might all be db barred : N + W almy.
 Glenhorn St. late Peter St. : 2st : quiet : 'Gospel light house' at no. 19 on N side. lb as map : W
 Whitecross St. : 2st : clean well asphalted : white cross cottages & Red cross Hall on E side : pk : in map purple : quiet poor on W side : lb : in map

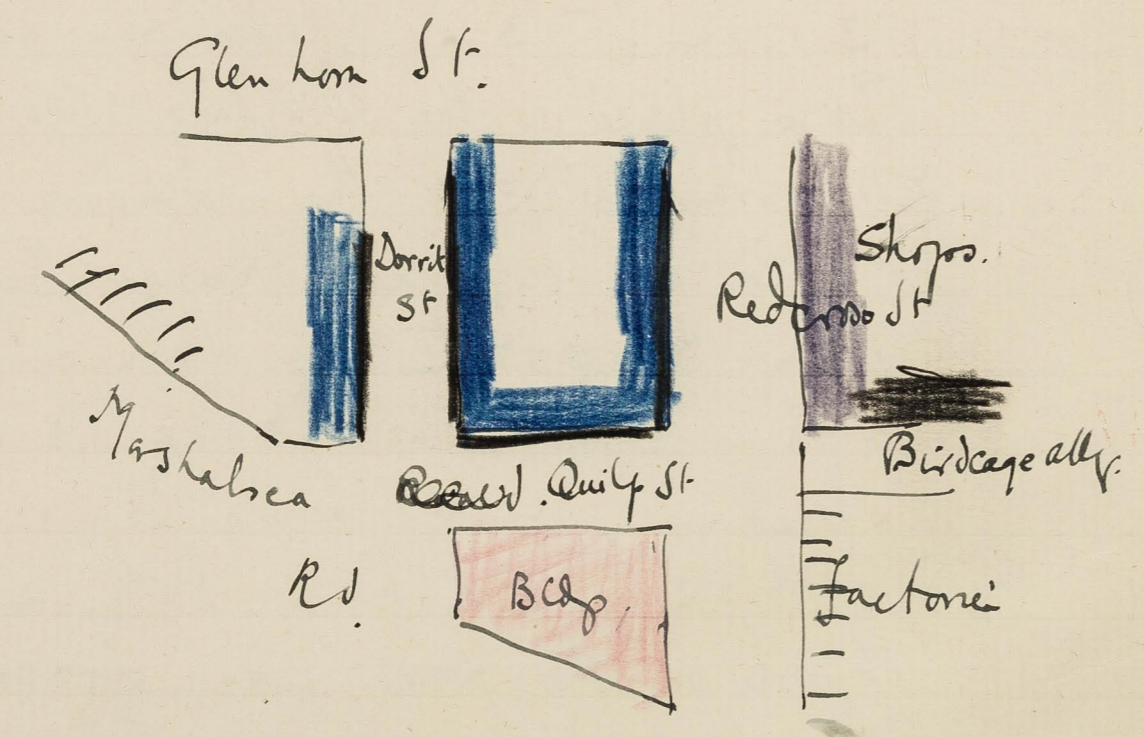

Whitecross St. lb & pk

The black spots shown on map on NE side of Marshalsea Rd. did go: they are mistakes in transference from the big map.

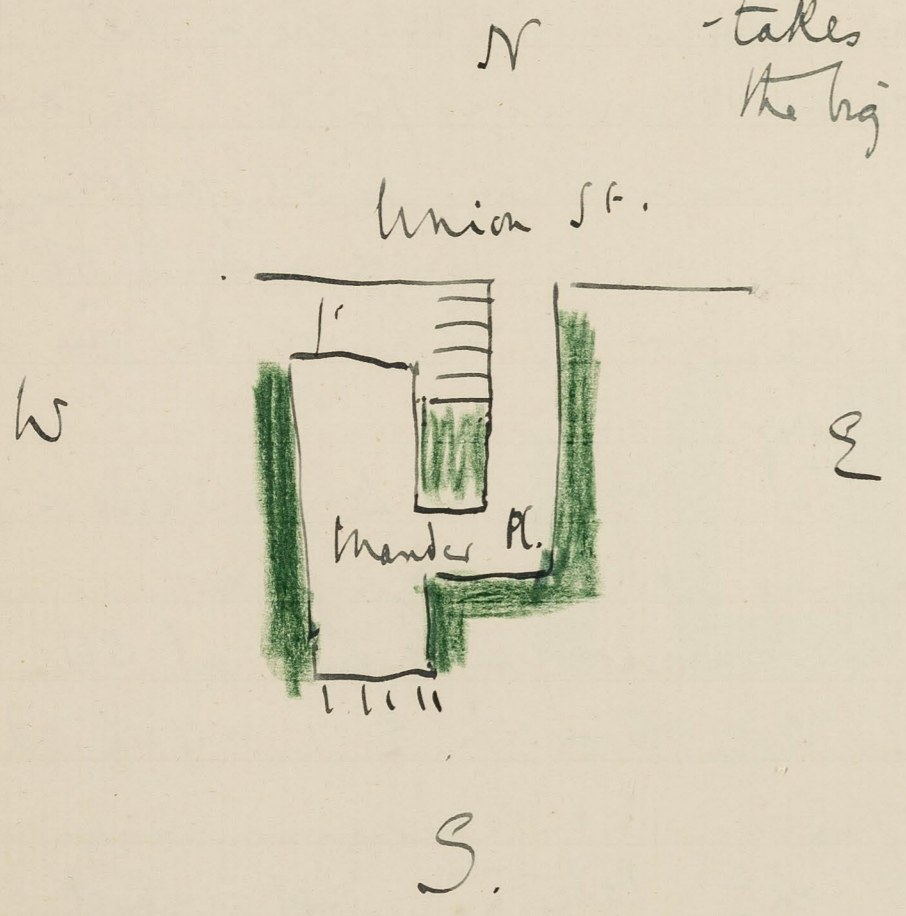

map purple: factories both sides above Henry Place: a common lodging house for men at the NE corner (40000 beds): map.

Marshalsea Rd.: Buildings on W side, pk to par in map pk: houses on E: pk to in map pk: occasional servants: E along Union St. map

Worcester St.: one lb house remains on SW: a Re church takes the place of lb on E side: the Chocolate Menier works replace the red at the N end: ~~South~~ W along

Southwark St.: Southwark Square out of the E side is covered by Messrs steel joint works. pk of map goes - S into Union St.: E: on E side is.

Mander Place: late James place: E One woman pays 7/- for 3 rooms: and another 7/- for 2 rooms & copper but no yard or wash house. The second woman has been here years & said if a week was added to the rent when the cop joer was put in 6 months ago. "The houses swarmed with black beetles & bugs." "rabbit hutches."

Old Inn Yard off the East side
of Borough High St.

Spur Inn Yard - lb

along Unwin St. shops - pk as map. : 2 across
Borough High St. to Newcomen St.
Newcomen St.: cobbles: 3rd: shops: narrow at W end.
pk by H in map ptd: map
Borough High St.: out of the East side going N
from Newcomen St. are
Mags Head Yd.: only one living at NW end: not
with marking: in map purple: the rest is
SWR. goods yard: N to is
Spur Inn Yard.: some living in 3rd houses on
S side only: poor: lb in map purple: on
N side 2 st. wooden topped store houses full of
hans & magazine tubs: 2 of the dwellg
houses are more stores^{old} with long over
hanging roofs as shelter for carts loading
& unloading: also stables: N to is
3 Runns Court.: one living: N to is
Queen's Head Yard.: remains of old Inn with
balconies, balustrading on N side, has been
offices, now untenanted & falling to pieces.
one house living in on N: and one old
double fronted, wooden, red tiled, dormer
window

- windowed house on S side : both pk : as map:
 leading to extension of Guss's hospital. N to
George yard : on South side the old inn
 remains : an old family hotel : small leaded
 diamond window panes : balustraded balconies : old
 four posted bed seen through upper window :
 not so large as formerly ~~but~~ since its E
 half is given up to Railway ~~purpose~~ office :
 G.N.R. goods yard at E end : There
 is as to a N as shown in map : N to
Old White Hart Inn yard : leads round to
King's Head yard : mostly hop factories :
 Down Surgical Instrument factory -
 wood paved : W across Boro High St to
Three Crown Square : if one house holed in at
 N W end : potato salesmen : full of potatoes
 carrying sacks & small carts : all pk
 in map : there is a passage through to the
 Boro market at the N E end : N or E
 along is

St. Thomas St. : not as map : N & E up.
Denman St. : not yet built up : W along
 clay

mill

N

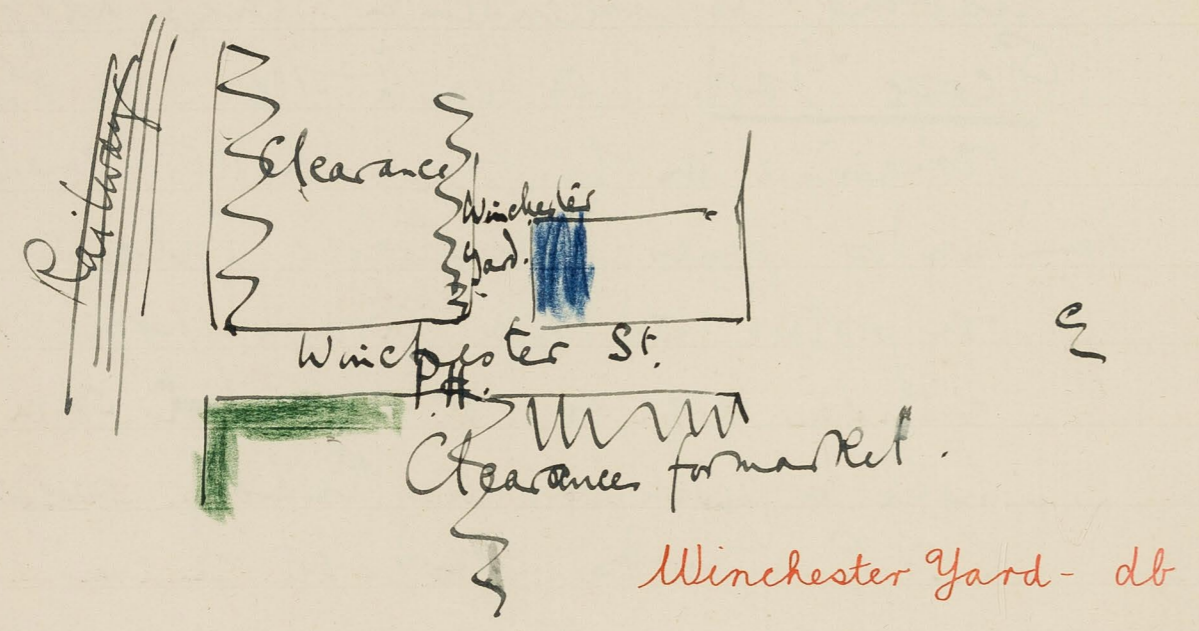

Park St. N. side pk & lb
 Redcross St. N of Southwark St. - pur

Castle St.

Relay Approach. shops: rd as map: into Today
 St.: W under London Bridge into Temple
 Close: high ware houses: S down
 Church Street: W along
Winchester St.: clearances for extension of the
 market: some ^{pink} of map goes: poor W of
 public house: lb as map: N up is
Winchester yard: two up poor houses on E side: db: in
 map lb: N of them is open space on W & ^{four} houses
 on N: W & N up.
^{Stores}Short St.: all houses on E side cleared: lb of map
 goes: S down is
Counter St.: market shops on S: pk as map: W
 along is
Park St.: shops, eating places: poor on N side:
 pur to pk: in map pk: S down is
Redcross St.: fair class Buildings on W: & small
 shops on E: Bldgs. pk to pur: in map lb:
 E side lb as map: W along is
Castle St.: 3 st pk as map: on the N side
 are Bldgs belonging to Barclay's Brew.
 with cellars underneath them: a

Southwark Bridge Rd

Park Place - lb

Bridge Place - purple

out of S side of Summer St. is
a large block of Peabody's
pk to par in map pink:

Emerson St.

a strong smell of beer & cellars everywhere: beh
the Building is a well cement paved yard
west of them out of the N side is c.

Park Place: 6, 2st cottages, 2 rooms in each,
5/3, 'no conveniences', rent lb to par: in map
purple: N up: ~~Southwark Bridge Road~~

Southwark Bridge Road: Jays large hat factory
on W side, some decent houses on E, reds
map: out of the E side is c.

Bridge Place: 8 houses: 3st: par to lb: in map
lb: leads to the extension of the
Brewery, now building: W along

Summer St: then N or W at c.

Emerson Place: 12 houses, 2st: quiet, poor:
4 rooms 10/6: children clean, well fed, fairly
dressed: par to lb: in map lb: E: N up.

Emerson St: houses on W only: pk to par: in
map pk: out of the NW is c.

Lizette Place: 2 houses: 0/6 for 3 rooms &
wash house, water from tap in the
court, pk to par, not shown in map
South to Park St & E: out of the N side
is

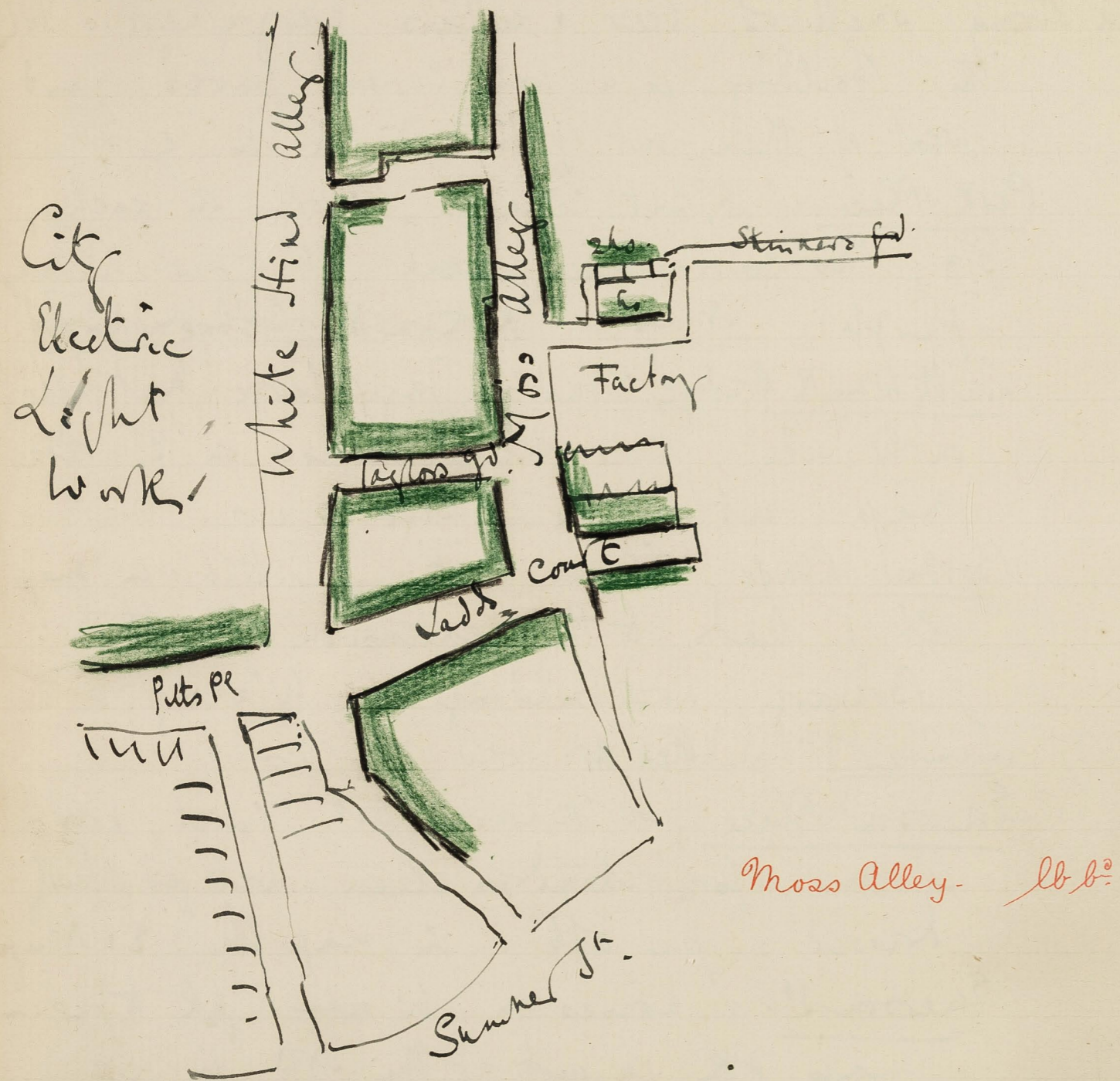

Bear Gardens: 2, 3 st: bear house on W, block of Buildings on E: lb a map: the passage continues N to the river between factory walls: very muddy will kept: E of it is

Rose Alley: only backs of Bear Gardens Dwellings on E side: opposite out of S side of Park St is

Hamors Court: one double fronted house: pk to pas: not shown in map: ~~to~~ E along

Park St: on N side is a block of ^{65th} Dwellings purple as map & on South side respectable houses (Barclay's foremen probably pk as map: W along Park St & Summer St. & N into.

Moss Alley: attendant courts: 2 storied: marked lb & black in map: a little village by itself: men employed in Phoenix gas works: ~~to~~ waterside: not so bad as it used to be: the West side of White Hind alley is monopolized by the City Electric light works. Some thieves, snatchers, vandraggers; not many

many Irish: women in Epps Cocoa works etc:
lb barred rather than St. & black of map.
Bastin w'd a deal rather walk here at night
than in Reeves Place:

This road finishes District 31.

General Remarks.

There is in this round a set of courts & small
streets which for ^{number} viciousness & poverty & ~~+~~
crowding is unrivalled in anything I have
hitherto seen in London: together with
the Friar St. area adjoining, they make
probably the most serious blot on
the map for all London. (excepting only the Tabard
St area)

X

The boundaries of this area are -
on the North Union Street.
on the East High Street Borough.
on the South Borough Road & ~~Walker~~
on the West Blackfriars Road.

This is a district which has gained little
from demolitions within its own borders
(such

The poorest & most vicious district
in London.

Betterment

more than counterbalanced by

Worsenment.

^{though} ~~seen~~ the courts off Kings Bench walk &
 Green Street are gone, & has suffered ap-
 -preciably from demolition in other districts
~~without~~ etc to Kings Bench walk &
 Green St are better than they were because
 much has been demolished & some rebuilt
 Orange St & Roman St are better for the
 same reasons. The block on the W side
 of Lombard St & the S.E. end of Redcross
 St & the N side of Vine yard have been
 displaced by the building of factories &
 hospital (Exelina hosp in Lombard St):
 But all this betterment is more than counter-
 balanced by the worsenment in the street
 between Friar St & Borough Road & Redcross
 St & Borough High St.
 The only street that, with the same building,
 has nevertheless improved in tenancy
 is Surrey Row (S of Nelson Square).
 The new colouring of the map suggests that
 the old tenants of Kings Bench walk etc
 are still with, though dispossessed, have
 got

get found house room close to their own haunts &
 that others displaced by Railway ex-
 -tension are in the courts off the N side
 of Union St & the E side of Great Guild-
 -ford St, together with former tenants of
 Duke St & Tower St & Gray St. (bet Blackfriars
 road & West B. Rd), just outside the area,
 have found their way in. They ^{inhabitants} are all
 South Londoners. None have come from the
 north side of the Thames. They are the
 dregs of the population & not scum that
 has floated off from distant places &
 infected new areas as in Notting Dale.
 The worst spot on the subd police Division
 is Red cross Place & Falcon court runs
 it close. As in Notting Dale the worst
 specimens are found in the common lodg-
 houses: they are prostitutes & bullies.
 About half the prostitutes are Irish
 women & their gains are made far more
 by robbery than by prostitution. Their
 favorite haunts are Borough High St

Red cross Place

Prostitution

Southwark & the City

Clapham Common. Bullies live on their earnings. They are English or Irish cockneys, not foreigners. The foreign bully has nearly deserted London since the law of last October & foreign women come no further south than Stamford Street. The police have tried to run in the English bullies from the High St costs, but had a failure & are fearful of trying again. The man they charged was notorious as a ponce but was able to prove that he had earned some money by himself & therefore the charge fell to the ground.

Number 1 Redcross Place is a common lodging house for women, & every woman there is a prostitute.

The Superintendent said that out of all the cases at the South London Police Court, more than half came from this area, last year there were over 4000 charges from this block of streets.

The same change is going on in Southwark that

that in years past took place in the City.

As site values rise, those who can most afford to pay for them leave, i.e. the rich leave first. After them go the fairly comfortable & last of all the poor & very poor. Hence those who properly can the least afford to pay high rents are the last to leave - The rich were the first of the residents to leave the City, the poor have only just left. In Southwark the rich have ^{already} left; the fairly comfortable are leaving, the poor & the very poor remain, & will remain until they are evicted.

June 7th

Dist 31.

Miscell
31
12

181
G. H. J.

Conversation at the Women's University Settlement
45 Nelson Square S.E. with Miss Sewell, Miss
Gow, Miss Sheepshanks & Miss Kelly who are
all active workers in the District.

Miss Gow & Miss Sewell are both ladies of a cer-
tain age, Miss Sheepshanks about 26 & Miss
Kelly just below a certain age. Miss Sewell
knows the district since 1890, she is head of
the settlement & capable, plain, rather tall
but with a pleasant voice & anxious to do all
she can to help; dressed in shirt, collar & tie but
not too masculine. Miss Gow has been 8 years in
the neighbourhood; she is kindly & rather sentimental.
Miss Sheepshanks also shirt, collar & tie; has worked
four years, pious, rather pretty, evidently
strong C.O.S. views; Miss Kelly inclined to generalise
& now & again rebuffed by Miss Sewell for speaking
from theory instead of from experience.

Miss Gow's special area is bounded on the N, by
Goose

Miss Sewell & others.

Gray St

vid. p. 73. of this notebook.

vid. p. 75

Gray St on the E by Blackfriars Road, & on the West by Waterloo Rd.

Gray St. is worse the west than the E end. The west end is so bad that we cannot go there at all; if a special enquiry must be made then someone is specially chosen, but no girl could be sent there. It is however better than it was.

In the better end of it are lightermen, labourers, cobblers, newagents, cellermen; wages of head of family ran from 15/- to 25/- per week. They vary from two to 5 families per house. Great pressure for room. Tendency to divide two room holdings into single room. Some let out in tenements (ie to each house there is a resident landlady).

Valentin Place. poor, quiet, no change, not many displaced by the extension of Pascalls sweet factory. Those turned out will naturally seek a place as near as possible to old home. Angel Place is as poor but more respectable than Valentin place. One family to a house.

Webber Row. most houses are down, used to be very

no/pebbles

respectable. William Place at the SE end is poor but not vicious.

Peabody Buildings Blackfriars Road. very respectable they are so particular about punctual payment of rent. No difference in the blocks facing the main street & those standing back - Let in tenants of 1, 2 & 3 rooms. Many poor widows & a number of people whose earnings are under 20s. per week.

Webber St.: St of Gray St is mixed: some fairly comfortable. but others very bad. Marshall's Bldgs at the SE. end are fairly respectable (They look poor. (H.D.) all ~~rooms~~ holdings 8/6 for two rooms & scullery, no roof to wash or dry on, nor washhouse. inhabitants (from report book) better, cutler, french polish, employee at Pascalls, of no occupation, printer, electric light man (at 25s) Some poor.

At the corner of Webber Row & Waterloo St are Young's Buildings. slight & more expensive & therefore better class in them

Quinn's Buildings: off N side of SE end of Webber Row: are poorer, low class - now managed by

Webber St.

not p. 73

a Miss Gee who also manages the Popken St. (Johanna)
Quinn's Buildings: great pressure for rooms -
Miss Sheepshanks.

Spoke about the area lying between Friar St. & Borough
Road. This divides the houses with the Redcross
St. Courts for the greatest poverty & vice in
Southwark.

The church is directly responsible for the perpetuation
of this area. Father Golden who was a man
without education but clever, risen from the ranks,
began it, & it was continued by Father Calcott
who has just resigned. They founded a sect of
sisters who abetted them. Miss Sheepshanks was
indignant at the way in which they promised to
do things & never did them, promised to look after
a sick woman & went once & then not again,
gave help insufficiently etc. They are excessively
high Church; so much so that the Noncons
were alarmed that the people were being led
away to Rome. Then a City Missionary was
sent to counteract their influence & a system
of competitive bribery began: * the result now
is

The Carter's parish.

Competitive Church work.

Gun St.

vid p 99

that a greater number of diseased & feeble minded children are now sent to the special school from this area than from any other. Miss Sewell hesitated to say that it was the direct consequence of the idle system, but she thought there might be some connection between the two.

Gun Street Buildings at the S end of Gun St. are the worst spot in the area - rough low class of ^{quarters} ~~cottages~~ ^{cottages}; the LCC Buildings have rather a better class in them because rents are more strictly exacted: these are not good Bldgs because they have no back yard. The octroy affects all these streets & they will probably remain in the state in which you saw them.

Rent in Gun St. are of 1/6 for two rooms: in one case they have 10 persons in two rooms: but it is useless to report any except very extreme cases of overcrowding. The medical officer told us that he should take no notice of any but extreme cases.

King James St. : rough & poor.
Minors St. : thoroughly low class

Continued on p 211

District covered.

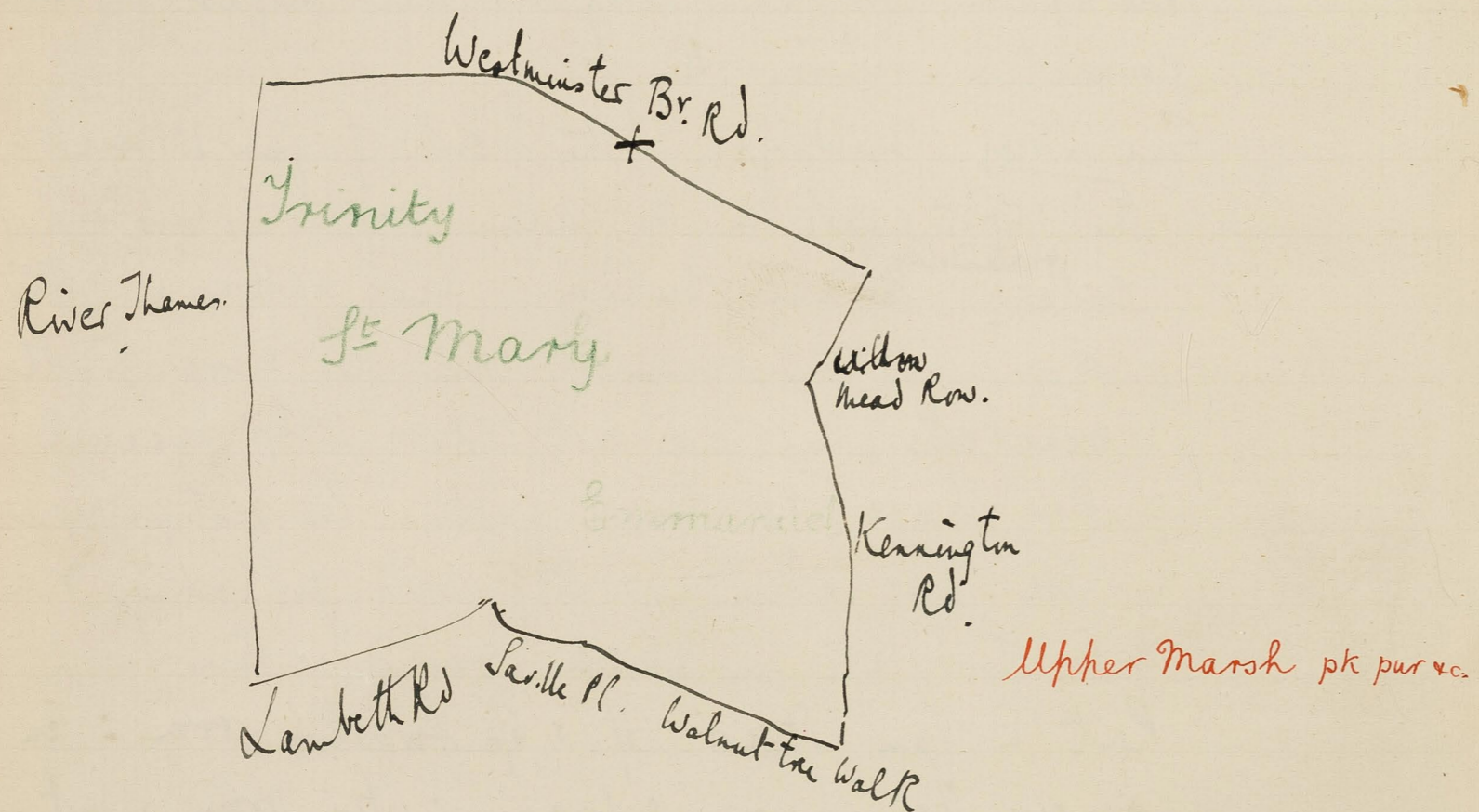

Finck Street purple

Monday - June 5th

Dist 34

Dist 34

191

J.H.D.

With Reserve Inspector A. Green round district bounded on the North by Westminster Bridge Road, on the East by Head Row & Kennington Road, on the South by Walnut tree Walk, Saville Place & Lambeth Road & on the West by River Thames: being part of the ~~districts~~ parishes of Trinity & St Mary.

Starting at the corner of Upper Marsh & West Br Road.

South, down

Upper Marsh. : narrow, cobbles, stage entrance to the Canterbury on S side, Field's Soap works on S side: some very poor houses on N side, South of Maxwell place: purple & db: in map pink: the pk on either side South of Stangali St: remains. May c.

Finck St: dist: paved passage: mixed: many poor: children dirty: one bar foot: far tall: in map pks: at the NE end are two very poor db house: South along.

Bon

Boniface St - lb

Demolition of lb between
West. B. Rd & Stangate St.

S.E.R. Buildings.

Boniface St: factory N side: then poor. rather better at
S.E: lb: in map purple: Salong es

Maxwell Terrace: 22 st + attic: flagged passage: poorer than
Fink St: doors open. barefoot boy: mess of bread &
paper: rough women: lb as map: west of it

Heathfield Place: is down & Shrub Place has only two
houses left at S.E end. 'an woman pays 9/- for
4 room & a kitchen' & complained at the demolition
of Heathfield place & of the building up of
Russell Bldg by the S.E.R. they do it to
take in those they have turned out, but they
don't want us in, & though they give ^{us} the first
choice of coming they are ~~are~~ ^{us} turned out again
the moment ~~they~~ ^{we} are in arrears with ~~their~~ ^{our}
rent'. W along Boniface St: on the N side are

Russell Buildings: built by the South Eastern Rly
to compensate those who were disturbed in
Bermadsey: now largely tenanted by
police & their own men: so poor: 9/- for
3 rooms: jk: in place of lb of map:
Salong es

Frederick St: at N.W end is a forest of dwellings

but next to them going E is very poor. No map: No E along.

Lambeth Palace Rd.: shops: no rents on S side
pR not cold in map: the N side are
new red brick flats with some servant
pR not cold in map: these flats
cover the old site of Astley Theatre.
S & D m c.

Stangate St.: 2. 2nd: pR to pR: mechanics work
over the other side of the river. pR to pR in
map pR. S & E Jan. c.

Crozier St.: 2nd st on N side: 3rd S: pR to pR: in
map pR. S down c.

Little Paris St.: 2nd st: north side poorer than south.
ladies collecting rents: pR to pR: in map pR:
N up. c.

Paris St.: 3rd st: some poor: pR to pR: in map pR
E along c.

Labarge Lake Mary St.: 2nd st: pR as map S Jan
Crozier St to c.

Royal St.: 3rd st w which are markedly better
than the 2, 3 & 3rd st. old houses on E:
either

Lambeth Palace Road E end pk + pkb:

Stangate St.

Little Paris Street - purple

Royal Street N. side purple

Class of tenants.

Carlisle Street } E side pk }
 } W - pur }

Hercules Road - pk

pk 9 pur : or pur & lb : in map pk.
The inhabitants of this block of street is bet
West Br. Rd. & SWR, Paris St & the
Lambeth Palace Rd. is working class : fairly
comfortable except for the tenants of Maxwell
Terrace, Fink St, Frederick St & Upper Marsh :
most work away N of River : in the New
SE Buildings are policemen from the A or
Whitehall, & or Lambeth divisions : very
few irish, no prostitutes : S down is

Carlisle St. : comfortable on E : poor & very poor on
West : but improves a W south of a block
of model dwellings : pk on E : in old
map & for pur bld on W. Map is

Park Place : 2 st : mixed : pur to pk in map :
at the SE end is a tunnel by the railway
arches, ^{20th} with small gardens in front lb :
map purple : E into is

Hercules Rd. : wood paved : old fashioned houses :
E side better than W : no scull : pk rather
than pt of map : out of the W side are is

Homes St. : two houses on E side : less purple than
map

the railway arches have to be so widened here as to take of a large bit of the ends of these streets. N. w along c.

Allen St. : 2nd : par to pk : in map pk : N. W
Newham Terrace . 2¹/₂ st : mixed : mechanics : betting men : prostitutes : pk to par : in map pk : Sta
Kennington Rd + trap c.

Mead Row : comfortable : house stands back off
S E end : houses on E only : pk as map : W along c.

North St. : mixed : par as map : out of the S W end, is is

North Place : 3 houses : lb both sides : in map on for E & South Jan :

Crow Place : 6 houses : 2nd : 5/- for 2 room + tap in court : very poor but decent : lb both. in map lb : S into Colwyn St, west of the public house with houses on W only

Wylie Place . late William Pl : 3 ho : 2nd : lb both. in map purple : E along Colwyn St, E of Crow Place is

Abbey

Allen Street - purple
Newham Terrace - purple

Poor Courts between North St & Colwyn St

Brow Place - db

Wylie Place - lb

2 on a line with Pennell Place is
South Place : 4. 2st ho : poor mgh :
doors open : well fed chr.

Abbey Place : it is a continuation 2 of Crow Pl &
separated from it by a house which turns the
corner. W.C. in front : flower : '2r. 5f. & 5/6' W.
as map : it is separated by W.C. on the
2 side from E.

Pennell Place. 5 houses, in flagged court like preceding
poor. lb to sb. : in map lb. N up es
North Pl. : red brick model house on E. pk. ^{pk.}
as map : into es

North St. : 3st : chr. well fed & dressed : many
poor. par. : as map : S. W. along.

Colwyn St. : late South St. : poor, mgh, lat.
doors open, messy street, improves at
SW end, lb to par. in map par. : W. E.

Hercules Rd. : on the E side S of ~~South~~ ^{Colwyn} St. an
Orient Buildings. 5st. well tenanted,
ugly, ndr. pk in map pk. S of the
is is

Sidford Gate Buses Pl. : quiet, retired, 2st mixed
cottages, very pretty with trees & well kept
gardens, all conf exc one home at E end.
pk as map : E along the

Jan

Lambeth Road - pk b²

China Walk District.

China Walk - nur. & lb

Lambeth Rd. houses tenanted by two or 3 fam.
very few rents: jobd: in map red: I saw
China Walk. built 1776: Irish labourers & some
free character living over the shops: see
in map pk: it is poorer S of Lambeth
walk. & lb rather than purple of map: out
of the W side going south is c.

Karl Place.: houses look very poor but clean
& chr clean well fed & dressed: kitchens
down & living & upstairs, ho on E side only:
many windows broken & patched: '6/- for 2r,
kitchen' lb bdb. in map lb: S of it is

St Albans Bldg.: 2st: poor dirt well fed chr:
flagged passage, look a bit rougher than
Karl place: '5/- for 2r & kitchen' lb bdb:
in map lb. out of the E side of China
walk is c.

China Square.: poor, houses newish, '3r & w for
8/- & 8/6: lb as map

This 'China' area is rough: inhabs chiefly colers
& Irish labourers: no prostitutes: a few thieves:
many drunks: both men & women: N &
W

Canterbury Place - purple

Saville Place - purple

Lambeth Walk N of Walnut Tree Walk - pur.

St. Albans Street

Richmond Street - purple

W along Canterbury Place. 3st: a few police many poor: par bpk: in map pk: S down
Saville Place: par ^{spk} in map pk: E along.
Lambeth Walk: many poor shops with poor over, wood paved, par in map pk. S down China walk to St Albans St out of it. S.E. end is c.

Walnut tree Place: 2st: well cement paved. better than the Chinese; 5f for 2r to an old tenant: no copper nor kitchen. W to par: in map par. W along.

St Albans St: 2st: broadish 1", 29 ft from wall to wall, china pots in windows: mess. of paper in street: pk as map: S E along.

Richmond St: 2st: messy: par in map pk: W into c.

Walnut tree Walk: old houses S of Board School: E side better than W: long garden behind: some converted into builders yards: others to be built over: S of the Bd Sch is a large block of dwellings par bpk: in map pk.

Walnut tree Walk.

S. Olaves Gardens - lb

Walnut Tree Walk - purple

Kennington Road - pk b²

entered through passage under them is
S^o Olaves Gardens - 12. 2st houses, look poor,
policeman coming out of one, brickbats from
demolished walls in front: purple ^{not} map
Walnut tree walk is also mixed, has been a
brothel on W side: on E side bet Richd
St. Alban's S^o is a poor court, of 2 double
fronted houses in which a decaying four
wheel cab was standing, lb: I mark
the whole for instead of pk of map

It was
Kennington Rd.: apt general: front gardens:
very few servants: pk^d in map red: I
like it is c.

Lambeth Road. only rather less respectable:
prostitutes & music hall agent: used
to be a brothel or two: pk^d in map
red.

General Remarks.

A good deal of light blue has disappeared
from the courts between Westminster B^o Rd

Displacement

Poor Spots.

Irish.

West, Br Rd & Stangate St, & also between the Hercules Rd & the Railway. This has been owing to demolition for the sake of railway extension, fact of extension (Field's factory & Upper Marsh) & has not been followed by rebuilding ^{of homes} except in the case of the courts off Stangate St. here the SER put up the Russell Bldg, avowedly to accommodate those whom they had turned out in Bermondsey. But Bermondsey w^hot or c^d not come to Lambeth & their place has been taken by railway men & police of the A. (Whitehall). & (Strand) & L (Lambeth) divisions.

The other poor spots are the courts off Colwyn St, rather poorer now than 10 years ago & the China Walk area ^{which is} much the same as 10 years ago. ~~Many of the~~ mechanics whose work is in the West End live between Westminster Bridge Rd & Lambeth Road, while unskilled workers live further south i.e. anywhere between Lambeth Road & Upper Kennington Lane.

The only rough spot is the China Walk area & here as always is the Irish cockney.

Frias St. area

Surrey Row.

cont from p 109.

Tupman Place : wretched but not quite so bad as Miniver St.

Bean St. - very poor : home cheap sweet-meat.

Upper Green St. makers.

Little Surrey Street 1 room 4/- : use of man wife & two

children in one room - paper bag makers. casuals.

Frias Place at N end, bad & crowded.

Warwick St. with Warwick Square on the west side.

bad, poor, vicious, worse than it was.

rent 15/- for whole house, case lets off ~~at~~

11/6 - thieves -

N of Friar St. is

Wellington Place. like Jun St.

Surrey Row : improved on S side except in center -

but still very bad at NE & NW ends. much

drunkenness. Sleep of Nelson Square destroyed

by shouts at night, screams of help,

murder, cries of children etc especially during

hot weather of last few days when tempers

are shot & overcrowding becomes unbearable.

Some live in the cellars in Surrey Row.

Off the E side of Great Suffolk St. are

Orange St & Loman St. : much of Loman St

Orange & Roman Sts.

Courts between Red Cross St
& Borough High St.

vid p 155.

belongs to Miss Hill, To Lady Selborne belong Winchester Cottages in Orange St. & to Miss Hill Walpole Cottages also in Orange St. in consequence great improvement here (in map D6 & D6b). The roughest bit remaining are Winchester Buildings at the S.E. end.

Of the Grotto District they did not know much but what they knew of it was in its favour: 'very respectable, only very poor.'

As to the courts between Borough High St. & Redcross St. Miss Sewell said they were too bad to work in. 'They are only different shades of Black'. St. Georges Buildings in Mason's Court are now under the charge of a Miss Boyd & are better than they were but it is a bad quarter.

Stanhope Buildings & Mowbray Buildings in Redcross St. are managed by Miss Hill. The front blocks are better than the back. 'Miss Hill has tried to prevent the low class from leaving them'. Mowbray Bldgs are worse than Stanhope Bldgs. Miss Sewell says that

St. Margarets Ct.

old p 153.

Zoar St.

Streets off Webber St.

these buildings are so badly planned that they never can be well managed. The dark staircases harbor ruffians at night. Miss Sheepshanks said they were so dark that even by day you could not see the numbers on the doors.

St. Margarets Court. out of Bowi Lane St. No of Union St. always reputed a bad quarter & we expect had cases from it on the COS. though it did not look more than the U of map when I saw it (good)

Zoar St. : E end of Hope town Place belong to a Miss Johnson ^(Cleared for Dept. Comm) who is in the vestry & is carefully looked after: the west end is much poorer & rougher.

If Moss Alley they knew & nothing.

Miss Kelley.

spoke of Mitre, Lifford & Caffyn Streets off the N side of Webber St.

Caffyn St (late News St) is the worst - morally bad with a low class of tenant. Lifford St late Queen St comes next while Mitre St is the best. The two last have a number of respectable tenants.

Drink.

Children & drink.

Attractiveness of Public Houses.

General Questions -

Drinking does not decrease. Perhaps Drunkenness does a little but you can still see women in sunny rooms with a pot of beer beside them sitting on the doorsteps. No shame felt here at entering a public house.

Miss Sewell has only once seen a child the worse for drink & that was for drink that had been given to it by its parents. She has often seen them sip, especially in hot weather but children do not care for the taste of beer. They much prefer sweets. Miss Sewell herself is rather glad than otherwise when she sees that the beer is sent for & the woman does not go herself. The attractiveness of the public house to the child is not in the inside but in the outside. The lights are bright, the pavement is carefully mended & smoother for marbles & other games, organs & niggers come to play using these, at night there is the sight of the drunken men being chucked out or trying to get home, sometimes he is hauled off

Children & sweets.

Irish.

Women's work.

off by the police man. Miss I has seen children act over the whole scene is drunken man, chucker out, police man etc.

The best proof that children don't care for drink is that they spend their money on sweets in preference. Some say that the act of sucking induces a craving in the palate which afterwards is satisfied by drink. Miss Sewell says this may be true. In any case she is sure that more harm is done to children by sweets than by beer. Once she made a special enquiry & learnt that the amount spent on sweets varies between 8^d & 1/6 per child per week. The small sweet makers of Bean St are those that poison the children by mixing plaster of Paris & poisonous coloring matter with the sugar.

There are many Irish & many mixed marriages but there is ~~not~~ regular Irish quarters in South work.

The lowest class of woman who works shells fees in the market: above them are boxmakers

Girls go out to work as soon as they leave school: for the first year or two they work inter mittent ly but afterward settle into regular factory work.

As to model Dwellings, the worst are those with dark staircases & without gates. They are made sleeping places by the lowest class. She has a confidential report on the condition of some staircases at night which she wd be glad to show if it wd be of any use.

Gambling & betting increase. Enormous interest taken in the Derby ^(Castellane) - Some of the feeble minded & invalid children would work in Derby Day. They insisted on being taken to the Elephant to see the crowd.

Money lending is common among women who are wives & not widows.

? among

Very glad to give any further help or to make particular enquiries.

Gambling.

Money lending.

District covered.

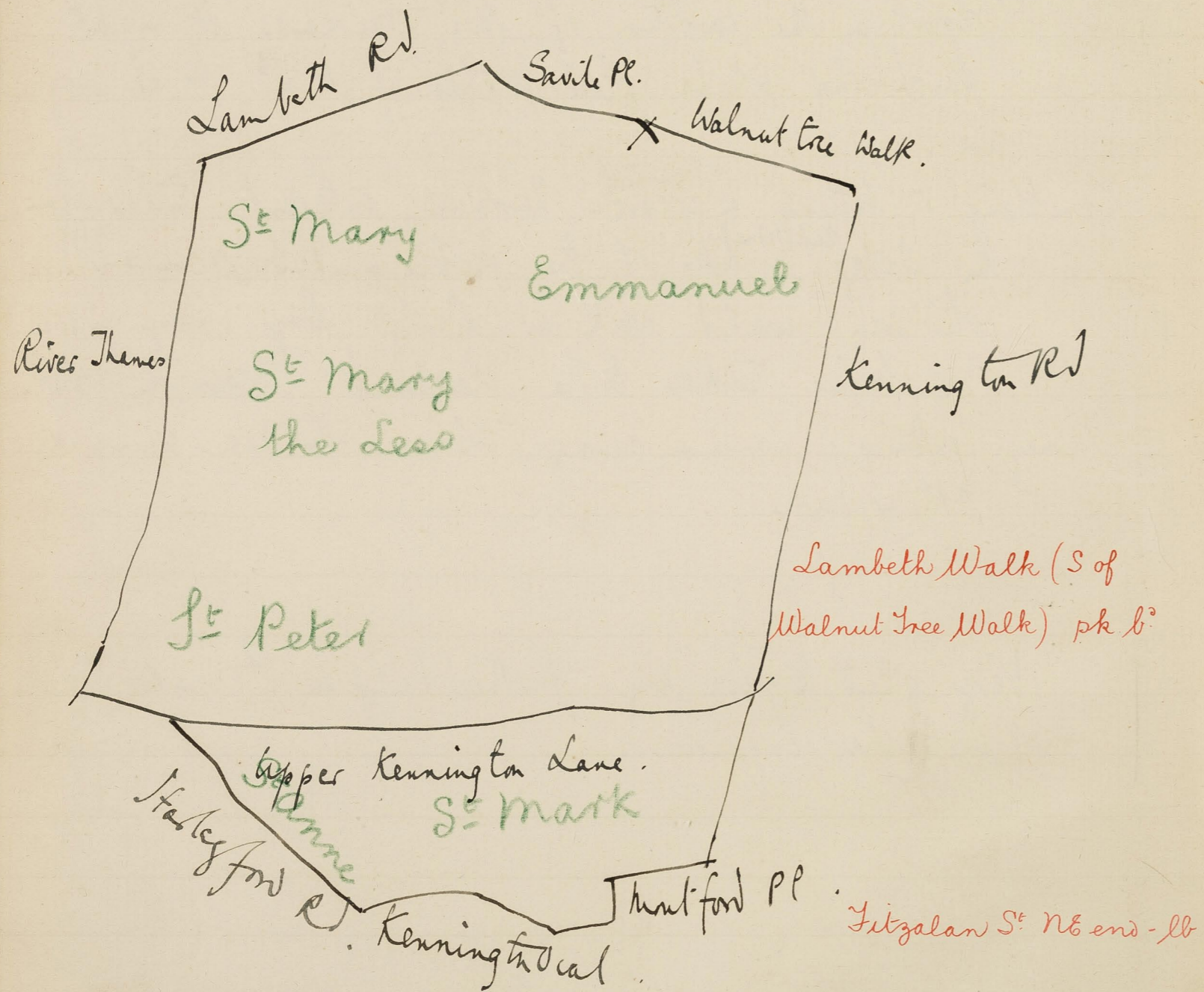

June 5th 8th 19th

Dist 34 ³⁴/₂ G.H.D.

With Sergeant E Sales round district bounded on the North by Lambeth Road, Lamb Place, & Walnut tree Walk, on the East by the Kennington Lane on the South by Upper Kennington Lane & on the West by The River Thames - being part of the parishes of St. Mary, Emmanuel St. Mary the Less, St. Peter, St. Anne & St. Mark

Starting at the corner of Lambeth Walk & Walnut tree walk: S down.

Lambeth Walk: market street - Thursday early closing, about half the shops & half the costers close, wood paved, narrow way, very few keep servants, poor & of. Walnut tree walk - par & p.k.t.d. instead of p.k.t.d. road of map. E along is Fitzalan St. date house St. 3st: West end. poorer than E: very poor women standing about E end, & one poor house at the W corner of Good place at NW end:

Complete

Streets + courts between Fitzalan St
& Colhard St.

Distin Street - lb

Gandulph Street - lb

Saunders Place - db

compositors, cabmen, police, Daultons men, waiters, postmen
par lb : in map par : out of NW is ↘
Goads Place. 4 2st houses on either side: all
doors open, poor cotes flying in the walk
women bareheaded rough : six bare footed
girls & boys in this court alone : drunko:
houses let out by rooms at 2/6 & 3/- per
room : db as map. 2 & 3 along ↘
Distin St. late William St. 2st: bread, paper
litter, much mess, houses on E side south
of Colhard St lb. in map purple & unmarked
W. along Colhard St. ↘ up ↘
Gandulph St. late John St : 2st: E side rather
better than W & South end than North :
Carmen & labourers : poor : 'women in public
houses all day' : lb in map par : W & S
down ↘
Saunders St. 2st: cotes : poor : 'veg drunken' : great
mess in street. lb as map : off the NE end is
Saunders Place. 4, 2st houses, veg poor but
fair furniture inside : let into the house wall
is a stone engraved: 'Depend on Providence.'
Res.

Res 1823: Rent for 2 rooms & back yard 5/15/6.
It is not shown in map: opposite on the W side of Saunders St is c.

Graves Place. more space than in Saunders place but worse homes, fearful mess, 3, 2nd houses: 4 rooms gr no wash house: It is on map: at SE end of Saunders St is another Saunders Place, one very poor house. It is not shown in map. 3 into Collier St 2 on the N side is

Manning's Place: quiet, tidier, poor, 6 houses: It is not shown in map: W along c Collier St. East St. It is from Randolph St East wards: rather better east wards: in map it is purple: It is on map c

Topaz St: 2nd: very poor: 'women fight like tigers': drunkards: pilfering class but not criminal, bird cages at windows; windows broken & patched: It is on map c. out of the NE end is c

Thrift Place: 5 two storied houses: three women who had each been there 5 years said

Mannings Place - lb

Topaz St

Fountain Gardens.

Paradise Street - lb

Juxon Street - lb & pk

said they pay 5/- for 2 r + little yard. no change in rent during this tenancy. Jb lb. in map lb. W along Fitzgerald St. South Jan Lambeth Walk. Eat c.

Fountain Gardens. houses on N r S: too much colour on map: mostly police living there but not a very pleasant place to live in because of the awkwardness of getting home at night. so many drunken men about. 14. 2 st houses: decent well kept front garden pk. as map. I Jan Lambeth Walk, the dark blue courts shown on map on the E side N of Holland Street are shut & derelict: W along c.

Paradise St.: great mess: 2 ect on S: 3 on N: South side better than N: lb: in map purple Map Lambeth Walk, W along c.

Juxon St.: late mill St: only a few houses lived in: electrical cab company works on the S side with a pk house W of it the other houses (a few) are lb: in map purple. N up c.

Berkely

Old Paradise St.

Old Paradise Street - lb & pk

Berkeley St. : 2nd : broad road : Prices candlework,

crepes over houses : far WPK : in map far
W along South Place, I don't see

Sail St. : railways arches used as stables on W :

3rd & 2 : cabdrivers, engineers, many poor,
purple as map : W into c.

Pratt St. : 3rd : old fashioned : 2 houses keep
servants : some poor : pk as map : I into

Old Paradise St. : W of New Bridge, are very
poor : but improves at SW : & on N, W of church-
-curate house : on S side is the "Lambeth
School of Arms" : a place for boxing
matches : rough. notice of match between
'Bill Grimes' & 'Bill Dobbs' : some thieves
in this street : no prostitutes ; lb & pk
in place of purple of map : out of the
NW end is c.

Pearson's Place : very respectable : old residents

'Doulton's moulders' - over one door-way
is an elaborate Virgin & Child after
Della Robbia : blue back ground, wreath
of coloured leaves & fruits surrounding
it

High St Lambeth

Bunyan's Place - lb

Norfolk Row - lb

Norfolk Place - lb

legend underneath 'He died that we might be forgiven. He died to make us good: many poor also: the west side is called Storrands Cottages: purple as map: 7. lb.

Map c.
High St: mixed: Doullin foremen & many poor: some small shops: purple in map: purple: but along c.

Ferry St: nearly all Doullin: only one ^{lb} house remains on the N side in what was Bunyan's Place - purple in map: stacks of earthenware drain pipes being taken on to carts as we passed: furnaces on S side.

along Old Paradise St & N side is Norfolk Row: 2nd: houses on W side w/ flagged passage: many children, cricket with centre lamp post as wicket: Doullin men: lb in map purple: N into Lambeth Road: SW on the S side is c.

Norfolk Place: all houses belong to Doullin & inhabited by their men: very poor: 5/- for 2r, copper & small back yard, from a 12 months

Courts off Lollard Street

Little East Place - lb

Tinman Court - db

Globe Court - lb

month's tenant : very poor & rough : db lb : in map purple : W & S down High St. # 2 along Old Paradise St & Lollard St at whose N E end is c.

Little East Place. 5 storied Buildings with balcon running round outside : on E side only : no mechanics : but poor & cabmen : great place for pitch & toss : brick round door posts worn shiny & greasy : lb in map purple : out of the S side of Lollard St W of the Bd School is a passage leading to Wake St not shown on map called c.

Tinman Court (late Court Court) : 2st : low & rough : sore eyed children : dragged women : 2 rooms 4/6, no washhouse : west side rather better than the E : db : Suits c.

Wake St. : 2st : all cotes : rows of barrows : great mess of paper etc : doors open : windows broken : women hatless : children well fed sore eyes : lb db : in map lb : leading from Wake St to Ethelred St is c.

Globe Ct. : 2st : flagged passage : poor : 5/6 for 2r
Wch

Stones Buildings - purple

The Parade

Doris Street S of Ethelred St - pk

Burrup Place purple

washhouse : lb bld. : not cold in map. E along
Ethelred St. on the N side just south of B. Sch
is co.

Stones Bldgs : 10 houses : cement pd : pas to pk :
in map pk. W along co

Ethelred St. : 2, 3 st : some v poor on N side
but mixed : purple as map : W across Lambeth
Walk to co

The Parade : broad, open, clean, well paved.
mixed class : pas as map : but lb where the
news begin. E along Ethelred St. out of
the S side is Lambeth news. of lb of
map, none there now : E to co

Tracey St. : 3 st : tall, high, houses flush with
pavement, quiet, children clean, quiet, machine
minders : pas as map : S down co

Hotspur St. : like Tracey St. pas as map : W to
Doris St. : South of Ethelred St. Doris is pk rather
than purple of map : pk & pas : in map
all pas : out of the E side of ~~Ethelred St.~~
opposite Hotspur St. is

Burrup Place : poor quiet, lb to pas : not shown
in

8½ B, Ethelred St - lb

Princes Road - purple

Between Ethelred St & Princes Road.

Stamish St purple

in map: 2 along Ethelred St out of its W side
is a court called 8½ B, Ethelred St: poor
quiet, one woman pays 8/6 for 3 rooms up, large
Kitchen down + washhouse - all to her self,
5 children making 6 with herself. lb: not
cold in map. ^W along 

Princes Road: mixed: 2 + 3 st: poor west
of the work house: par to pk: in map pk:
N up c/s

Goda St: 2st: poor: par to lb: in map par: W
S down c/s

Hutton Rd: 2st: better: doors shut, clean, pk to
par: in map par: out of the west side
by the Chapel is c/s

Grays Place: practically a continuation north
wards of Over Place but walled off from
it: quiet: flowers: 9/- for 4 r + washhouse,
has been there 16 years during which time
the rent has remained the same: pk to
par: in map par: W along Ethelred
St, across Lambeth Walk to c/s

Stamish St: 2 + 3 st: par to pk: in map pk: out of

Selden Mews - lb

Newport St. N. of Hamish Street - purple

Between Ethelred St & Princes Rd.

Broad Street W of Railway - lb

of the S side is in

Selden Mews: some poor dotted about: large
backmews at NW: volumes of smoke
from the windows, unpleasant smell, lb -
not cold in map: W to E

Newport St.: poorer N than S of Hamish
St. 2¹/₂ & 3¹/₂ st: lb & par: in map par.
stables under ring arches on W side.

E & N up Lambeth Walk & E along is
Bolwell St. 2¹/₂ st: mechanics working over
the water: pk as map: like it as is

Wood St.: pk as map

Ward St.: _____ 2¹/₂ st: built 1839.

E along Princes Rd N up is

Over Place: 22, 2¹/₂ st houses, flagged passage,
poor mixed: small fronts: par as map.

W along Broad, out of the S side is

Wilder's Cottages: 4, 2¹/₂ st: on W side only
lb: not shown in map '5¹/₂ for 2 r ^{back} ~~side~~
yard: no washhouse!

Broad St.: itself is poor, old h, small shops,
3¹/₂ st, 1776, lb to par: in map par: W

Shanklin Court - lb

Granby's Bldgs. Vauxhall Walk.

Granby's Bldgs E & W sides nur & lb

Gunner's Cottages - lb

S down Shanklin Court: late dilap. Place &

Gardener's Cottages: quiet, old fash. poor.

Dultons men. lb to par: in map pK:

W to Vauxhall Walk & N up c.

Granby's Buildings: new 2 story & attic

flats on E side, rough, poor, let out in

tenements, drunks: lb to lb on E & the

same in Vauxhall Walk, in map lb. lb.

on the west side of Granby's Buildings

are old red tiled well kept houses,

one woman had been 33 yrs in the same

house, another 40, & pay 6/ & 7/ for

5 rooms: one said her husband's family

had lived in the same house for well

over 100 years. date on houses 1769.

pK: in map lb.

W along Broad St. out of the South

side west of the railway are c.

Gunner's Cottages: entered through swing

wooden door: lb to lb, 4, 2nd cottages,

used to be tenanted by notorious dogstealer,

on his death 50 dogs were found on

ceiling

Whitgift St.

Salamanca Street & Court - lb

concealed in the yard - not shown map.

Map High St. & along c.

Whitgift St. : 2nd : messy : unswept,
poor, drunks, Saulters men : ^{lb as map} out of the
N side is c.

Cotford Place : 1st on E : 2nd on W : poor : lb
as map : East of it is c.

Ads Place : on W side ~~of~~, 1st : 4 storied
buildings on the East side : poor. lb
as map but more of it on account of
the Buildings : there is now an open
space between the Rly & the Buildings
none lives on the E side of the
Lambeth Burial ground (now a recrea-
-tion ground) in map purple : W into

High St. : mixed : many poor : some fore-
-men : poor talk : in map purple : E along
Road St. & I don't c.

Salamanca Street Court : rough poor
Irish : children well fed, dirty, ill-
-dressed, lb 6d : in map lb. St.
Randall Road : 5 storied Albert Buildings

(continued in Police Book 13. T) m

