

If found, please
return to
Charles Booth
9 Adelphi Terrace
Strand.

Book 13. I
Police. B(354)
Districts - 2. 3. 4

COLL U

B

354

[i]

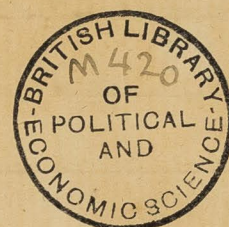

Name	Address	District	Parish	Page
Wamper	Police C. I.	4	Parish of St. Albans Holborn.	1
Turner	R. of the E. Holborn Police Division of the Grays Inn Sub-division	2	Part of Holy Trinity Grays Inn & St. John the Evangelist	15
Turner	R. " " "	2	St. George Bloomsbury, St. George the Martyr Holy Trinity Grays Inn P ^o	24
Turner	R. " " "	4	St. Pancras, Holy Cross, St. James Grays Inn P ^o	43
Turner	R. " " "	4	St. Peter's Regent St. & St. Bartholomew's Grays Inn P ^o	53
Turner	R. " " "	2	Christchurch Woburn Square.	63
Turner	R. " " "	2 & 3	St. Pancras.	69
Sait	E. " " "	2	Holy Trinity Lucan & St. Andrew.	85
Sait	E. " " "	2	St. Giles, St. George Bloomsbury, & Holy Trinity	95
Sait	E. " " "	2	St. Giles, St. John the Evangelist	105
Sait	E. " " "	2	Holy Trinity, St. Clement Wares	117
John Wadesley, Inspector	of the E or F. Division at the Police Station		Interview with	135
Worri	Police C. G.	2	Part of the Parishes of St. John the Evangelist & St. Paul	141
Worri	E. " " "	2	St. Paul & St. Martin.	155
Worri	E. " " "	2	St. Martin, St. Michael, St. Clement (detached), St. Mary, & St. Mary Abchurch.	164
Gunn	Albert of the C. Police Division [the S. sub-division]	2	St. Martin	174
Gunn	A. " " "	2	St. Giles	189
Gunn	A. " " "	3	St. James Piccadilly	201
Gunn	A. " " "	3	St. Anne Soho	213
Gunn	A. " " "	3	St. Luke & St. Peter	229
Gunn	A. " " "	3	St. John the Baptist, St. Luke, St. James, & St. Thomas	243

District covered.

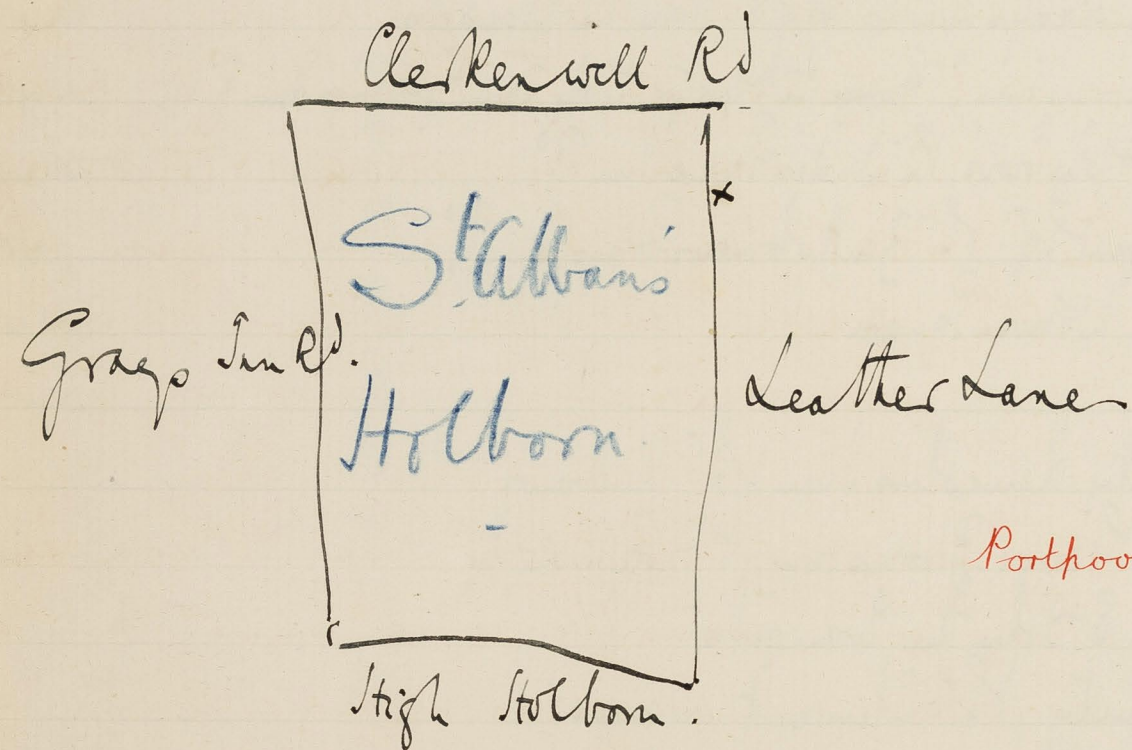

Portpool Lane - db

Half Moon Court - db

Courts off Portpool Lane.

July 11. 98.

Dist N.

1
G.H.D.

Walk with Police Constable J. Sampier round District bounded on the North by the Clerkenwell Road, on the East by Leather Lane, on the South by High Holborn & on the West by the Grays Inn Road being the whole of the Parish of St Albans Holborn.

Starting at the corner of Portpool Lane & Leather Lane. Ppl. Lane - asphaltic paved. 4 st. all wood houses exc about 6 houses on S side, in the center, inhabited by costers - windows dirty & broken. db. rather than purple of map. Half Moon Court - 3 st. houses on W side only. at SW end is one house 3 st. with only 3 1/2 ft between its windows & a blank wall opposite - very rough though no thieves - children dirty - rats sp for 2 rooms. windows broken, dirt, bread lying about. No way through to Verulam St. though thieves get over wall & through houses into Verulam St. db

brown court - db

Thanksgiving Model Dwellings - purple

Portpool Lane.

Duncan's Buildings - lb

Leather Lane.

women as buyers

lb. not marked in map. East of it is Crown Ct now all down exc on 3 st ho on west side. lb. foundations being dug for new warehouses - very smelly. cotes burrows in waste space.

West of Half Moon Ct on S side of Portpool Lane are Thanksgiving Model Dwellings 3 1/2 st. wide in commemoration of the removal of the cholera - all for poor widows exc two - all poor rents 1/9 + 1/3 per room - character lb to purple rather than pk of map.

at the N side of the west end of Portpool Lane are Portpool Bldgs. 4 st. belonging to Reid's Brewery - occupied by draymen - pink as map. opposite on the south side are Duncan's Bldgs. - poor - noisy on saturday - some thieves - lb to db rather than pk of map.

East to Leather Lane. midday - many women - wives of well to do artisans + poor - quiet - especially found burrows selling odds ends of stuff + linen. looked as if they meant business but not buying until they saw the thing they wanted.

On the west side of the lane are Union Buildings

have

are ho on N side of Union Blk?

Union Buildings - db b?

Courts west of leather Lane

Dove Court - lb

Baldwin's Gardens. (see next page)

Baldwin's Place - db

Nerulam St db b?

Nerulam Street

Buildings at W end of - " - hush

This district looking poorer now (June 299) than a year ago - many dirty barefoot children. great mass of lead - Faded smell from houses - flower girls cotes, banners. rough Irish type of woman - Nerulam St. Baldwin's Place, + Half moon Court the worst. Duncans + St Albans Bldg hardly better than the row - (S.H. 2)

houses on south side + west end only. Very rough. 'like Half moon Court' but with many thieves added - no prostitutes - cotes - children very dirty + pale. no way into Nerulam St. character of the barri rather than db of map.

Dove Court south of above. four 3rd houses on N side only. great improvement here. lb rather than db of map. Leopard's Ct. leading from Baldwin's Gardens into Dove Ct. is all ^{factories} ~~factories~~ Baldwin's Gardens. near all factories - on N side. If it is Stole-in-the-Wall Ct. all factories - one barefoot child. leading to Baldwin's Place houses on N side only 3 1/2 st. very poor but quiet. doors open, dirty, messy, children ragged + dirty. N into Nerulam St. of which the East end is paved + called Providence Place. 2nd. built 1844. windows broken - Nerulam St itself is asphalt paved, very rough ^{thieves} windows bad. 3 houses on N side. ^{shuts} condemned close airless St - children pale - ^{db being rather the} db of map. At the west end ^{are} 'Buildings' - looking out on two asphalted Courts

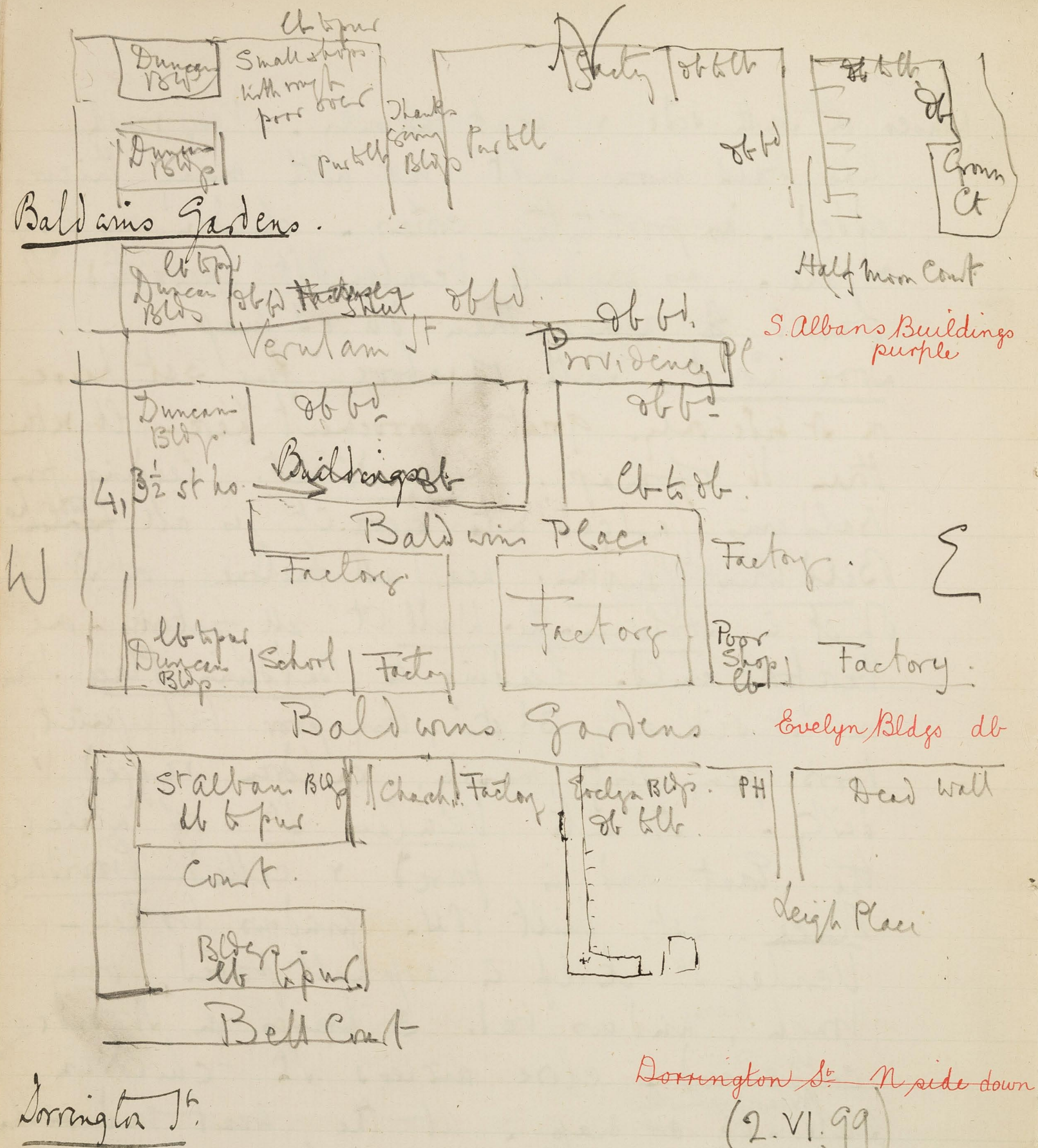

Courts - messy. lb to purple in character. in map pink.

I am Cray Inn Rd. to Baldwin Gardens - on the N side of the west end are Duncan's Bldg. on the south side St. Albans Bldg. 5st. inhabited by a poorish, quiet, labouring class. Some of whose earnings w^d run up to 30/- a week more probably 20/- to 25/-. Dark, messy, airless courts behind them, bread & paper lying about, refuse shot out side. instead of into the dust bins provided children pale but fairly well-dressed & clean. lb to purple rather than pk of map.

On the East side of the Church ^(St. Alban's) are Evelyn Buildings - very rough. much worse than those at the west end but not quite so bad as Verulam St. like the rough Bldg in Portford lane! said Lampsier - Thieves inhabit here - lb or lb, barred. rather than lb of map.

Corvidge Ct. ~~to the S side~~ ~~has~~ ~~no~~ ~~cases~~ - into leather lane. turning west at Dorington St. N side closed & coming down. used to be very rough. lb in map. There is a fountain now in the centre

Dorington St. N side down
(2.VI.99)
GHD

Brooks Market - E side pk & lb }
W side pk }

Brooks Market.

center with a few struggling plane trees round.
This was Brooks Market. On the E side are some
red brick County Council model dwellings
with a better class in them than the rest of
the market. pk instead of lb of map -
at the west end is a 4 st v attic red
brick house, called St. Martin's house belonging
to St. Alban's Church v divided into 3
one for postmen, one for servants, the other
being for the sisters working in connection
with the Church. On the South side are old
fashioned small paned windows to v lops - bid -
-cages outside windows higher up, inhabited
by coaters, some windows broken, lb to people
in map purple.

Greville St. leading out of the S side has
no houses - W to Brooke St. Flats on
W side - with shops under - pk barred as map.
St. Giles Xthian Mission on E side N of Greville
St. South of it is Prudential Office Bldg.
E along Greville St. 4 1/2 st. Pop. quiet. rather better
west than east - all Prudential Office on S side -
C. Liddys on N side. people

Encroaching Prudential ^{the}

N

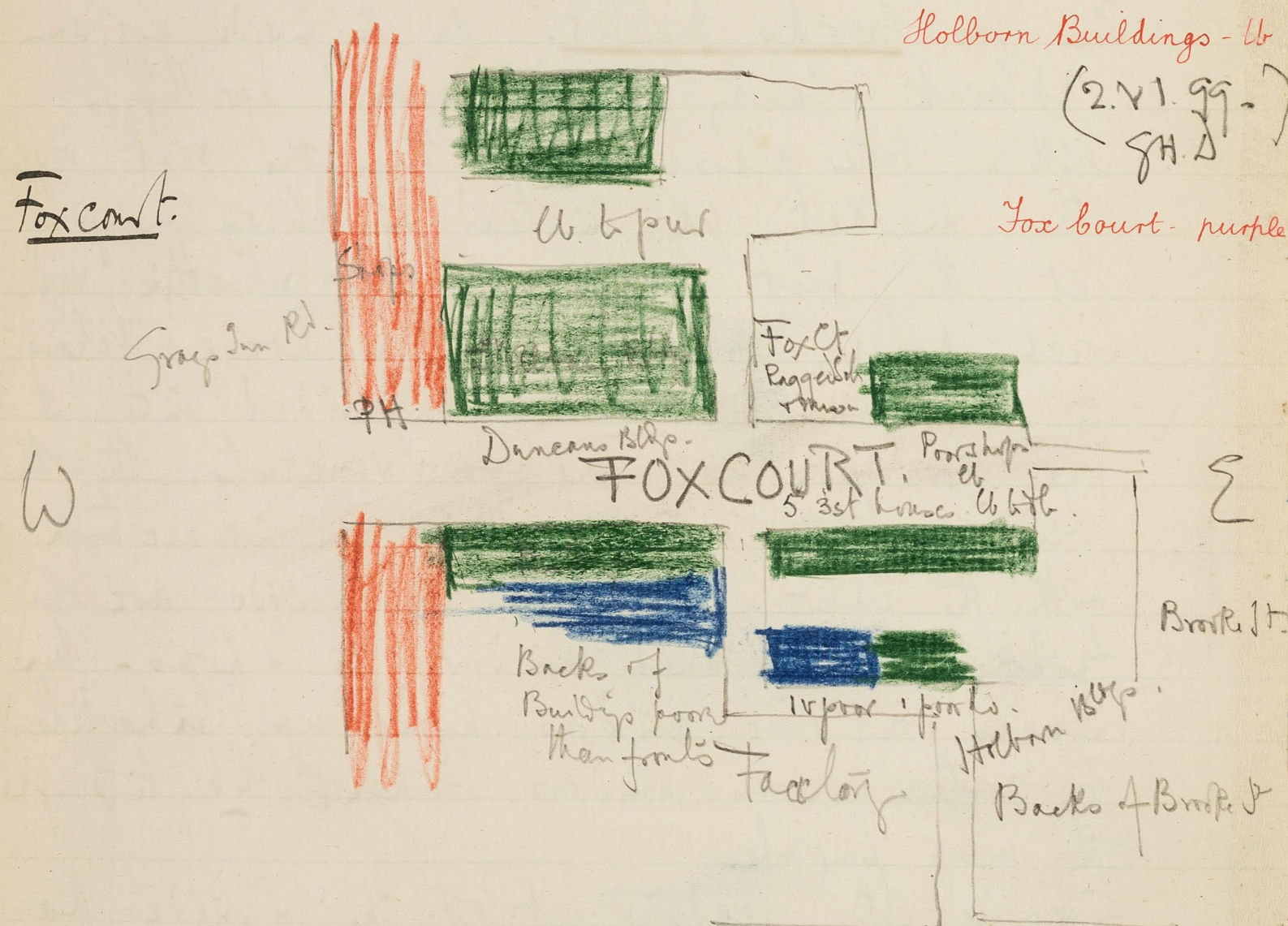

Roughest spots in the Subdiv.

Holborn

S

purple as map S to Holborn, then W. turning N up
 Holborn Bldgs. which has 2 ho. at its N end.
 3rd. quiet, poor, not coloured in map. lb. leading
 into Fox Court. used to be very rough. small
 shops, cotes barrows, quiet poor, poor looking
 children. Schools & mission on N side. lb as
 map. The east end leads through into Brook
 street. at the W end on N side are 4th.
 'Dwellings' character like the best of St. lb.
 N to Bell Court. St. Albans Buildings, 5th,
 on West side - same class as all the rest.
 Some poor, some fairly well off. purple rather
 than pink of map. Bell Ct. leads through
 White Hart Yard by two old wooden ho. - one lb
 & the other purple - poor quiet to Brooke St.

General Remarks.
 The roughest spots on the subdivision
 according to Sampson are. Verulam St.
 Postpool Lane, Half moon Court, Union
 Buildings & Leather Lane Bldgs. All
 worse than Bakers Row. & all rougher
 than

General Improvement in the Dist

any part of the Italian quarter - 'Italian thieves are not so violent as English thieves.'

'We have no trouble with the Italians unless some rowdy English go down into their quarter to make a noise; then there is trouble enough because knives are drawn.'

The working class as a whole are less rough in his opinion than they used to be.

There is a great improvement in the district lying between Frys Lane Rd & Leather Lane.

'12 years ago it was a den of thieves, & you could have found as many there as you can now in Hoxton.'

Police men are seldom maltreated in the subdivision ~~are~~ in Venulan Street.

Prices in the street. Beer 2d & 3d a qt. Coal 4s a cart. Some prostitutes live in these streets but none bring men home.

No. 75 Leather Lane - 'Home & Colonial Store' have no license so say the assistant tho' police ^{have} ~~do~~ then registered as possessors of one. perhaps they have but don't use it.

District covered.

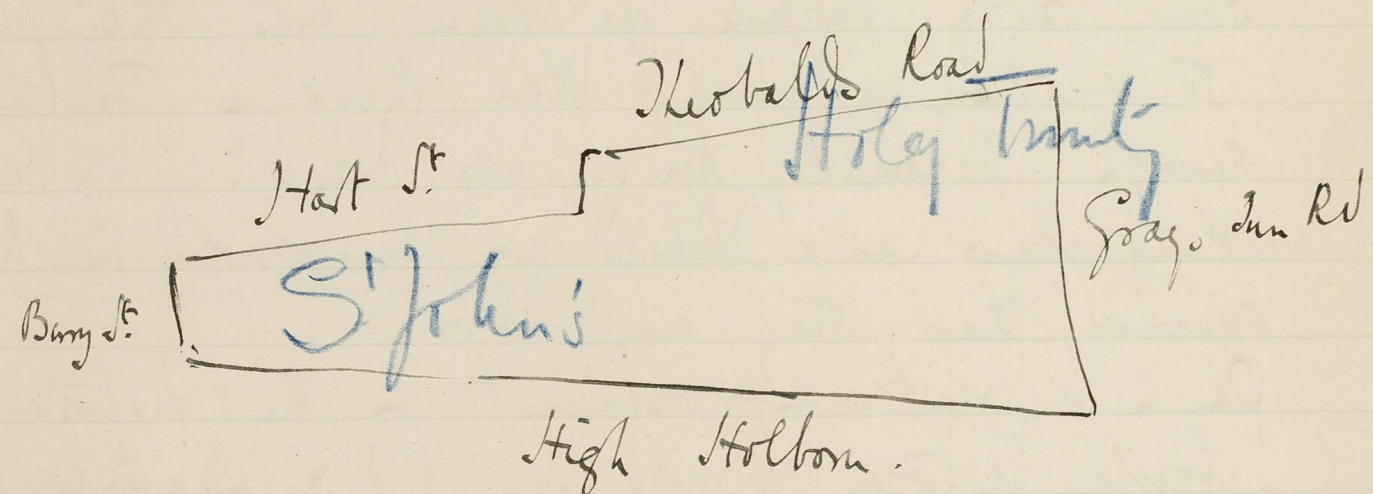

P.C. Robt. Turner.

Bishop's Head Ct.

July. 12. 98. Tuesday. **Dist 2** G.H.J.

Walk with police Constable Robert Turner of the E or Holborn police Division and of the Grays Inn Road Subdivision, round district bounded on the North by Hart Street & Theobalds Road, on the East by the Grays Inn Road, on the South by High Holborn & on the West by Bury Street, being part of the parishes of Holy Trinity Grays Inn Road & of St. John the Evangelist

Robt. Turner is a Scotch man - 12 years in the police force, of which 8 years have been spent in this division - 33 years of age - Small, close whiskers, plump good natured face - dark moustache - height about 5ft.6

South from the Subdivisional police station at the corner of Theobalds Rd. down Grays Inn Rd. at the S.W. corner is Bishop's Head Court

Bishop's Head Court - db

Irish.

Fulwood Rents

12 houses, 3 st, no backs, houses let by single rooms, 'generally a family in each'. place looks rough 'but is nothing to speak of'. 'principally the ladies who are rough' are Roman Catholics & 'may be Irish'. The women look distinctly Irish - 6 WCs with a flushing Cistern ^{over} at the N end - children pale & dirty - some windows bad - 'well they are only rough on Saturday & Monday nights'.

Hunter is a cautious speaker. He - in map. W along Holborn, N up Fulwood Rents - used to be very rough. db based in map.

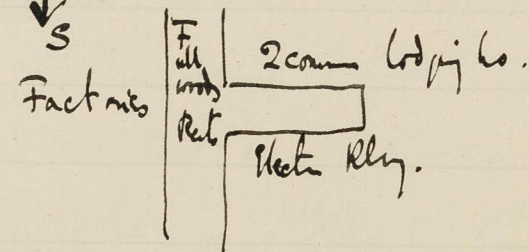
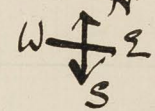

Now the best side is factories -

at the turning there are two common lodging houses on the N side which harbor a few thieves - The South side is taken up by the Central London Railway works - N up Warwick Ct one or two residents. The best offices & shops

N up Browlow St. First Avenue Hotel on E side

Jockey Fields.

Bedford Row.

Why not?

Hand Court - pk

Featherstone Bldg.

the rest is 3rd st. shops & offices. into Warwick Place. Hotel winter living etc two houses at S.E. end. purple as map. Map Jockey field. 2nd st stables - small cabovers living over their houses - fairly well-to-do - quiet - purple rather than lt of map.

W to Bedford Row. one or two residents - red. but houses principally occupied by house keepers who keep the offices & rooms for the solicitors who work there by day. (Why pink in map?)

At the W end of Warwick Place on the south side is Hand Ct. Small shops. no poor - working class. N.E. end rebuilding for chambers & offices - old picture & curio shops. purple to pink in map purple. West of it is Sand Lane St.

4th st. shops & working class - four storied house purple to pink in map purple. rents 9/- to 10/- for two rooms on first floor. 8/6 9/- on 2nd - 6/- & 7/- on third - said Hunter.

South down Featherstone Bldg. 4th st. factories & offices - some inhabited. old houses. jammed passages - pk as map. Into Holborn. W. then

Red Lion Square

Difference bet 'lodgings' & a common Lodging ho.

Old North Street - purple

Map Red Lion St. 3 & 4 st. old fashioned houses. shops. asphalt paved narrow. purple to p.k. in map purple. W along Red Lion Passage. 3 st. old print & book sellers. hideouts at upper window many going to & fro from Southampton St to Bedford Row - purple as map.

Map Red Lion Square. red tiled roofs. a few inhabited houses. rest are business premises. at N.E. corner of Leigh St are flats. p.k. as map. there is a common lodging house on the ~~N.W.~~ N.W. side of the square which is not registered because it takes a stipulated sum per week & does not put more than a given number in a room. This seems to be the difference between 'lodgings' & a common lodging house (?).

part Princeton St. 3 & 4 st. cobble paved. quiet purple as map. N to Sancti Conduict passage. 3 st. poorer. not so busy as the other passage. 'not a great deal of trouble'. lb as map.

W. part Old North St. no rough. 'like Leaveland St houses down at the S.W. end. University Tutorial College

Leigh St.

Leigh Street - lb

Eagle St.

Eagle St. - db

Kingsgate St.

Kingsgate Street NW end lb

Plummers Court - lb

College at S.E. purple rather than db of map.
 South down Leigh St. 4 st. many Jewish tailors
 working at home. doors open. some windows broken.
 no thieves or prostitutes - not much trouble
 police. apt to be noisy Saturdays & Mondays.
 'better than Eagle St.' lb. ^{to purple} instead of db of map.
 into Eagle St. courts - a brass St. since later
 Paterson - look the 'Central Hall' on the south
 side. There used to be boxing here before which
 brought a rough class to the street. bread & mess
 in the St. Street is better than Bishop's Head
 Court. lb to db. in map db lined.
Dean St. on the south side is all down. Rose
Alley & Eagle Court leading to Dean St. all
 factories - at SE end of Dean St. is one house
 still lodged in ~~area~~ though condemned. rough. db.
 W along Holborn. on N side is Plummers Ct. 4 houses
 2 1/2 st + att. quiet poor. lb. not coloured in map.
 N up Kingsgate St. 4 st. the top end is
 near orange St. on W side is noisy 'like Eagle
 St.' lb to db. in map purple. part Fisher St.
 4 st. 'a bit rough'. some windows broken but on the
 whole

Southampton St.

Children & drink

Brothels

prosecution of.

ask again.

whole not worse than ^{as map} Orange St. 3 + 4. working class, purple as map. into Southampton Row. 4 st. asphalt paved. keep servants. red as map. W to Southampton St. red as map. residents & offices. 3 1/2 st + allie. W up Bloombury Ct. pk as map. Part into Monarch Yard late Kings yard. now a station on Electric Rly. W along Silver St. pk - as map - so is Baxter late Market St. & Drake St. with the St. Georges mission on the E side.

General Remarks

Very rare indeed to see a child drunk before 15 or 16 years of age & then only in the coster class - said that he has never seen one drunk younger than this. There used to be 3 brothels in the subdivision; they were prosecuted & now shut; he knows of no others. He says brothels are proceeded against under old act where two ratepayers lay information & case is sent to Sessions. Imprisonment follows conviction at Sessions whereas if offenders could be tried under Summary jurisdiction act the police magistrates can give the option of a fine & costs are less. Victims would then be more ready to prosecute.

District covered.

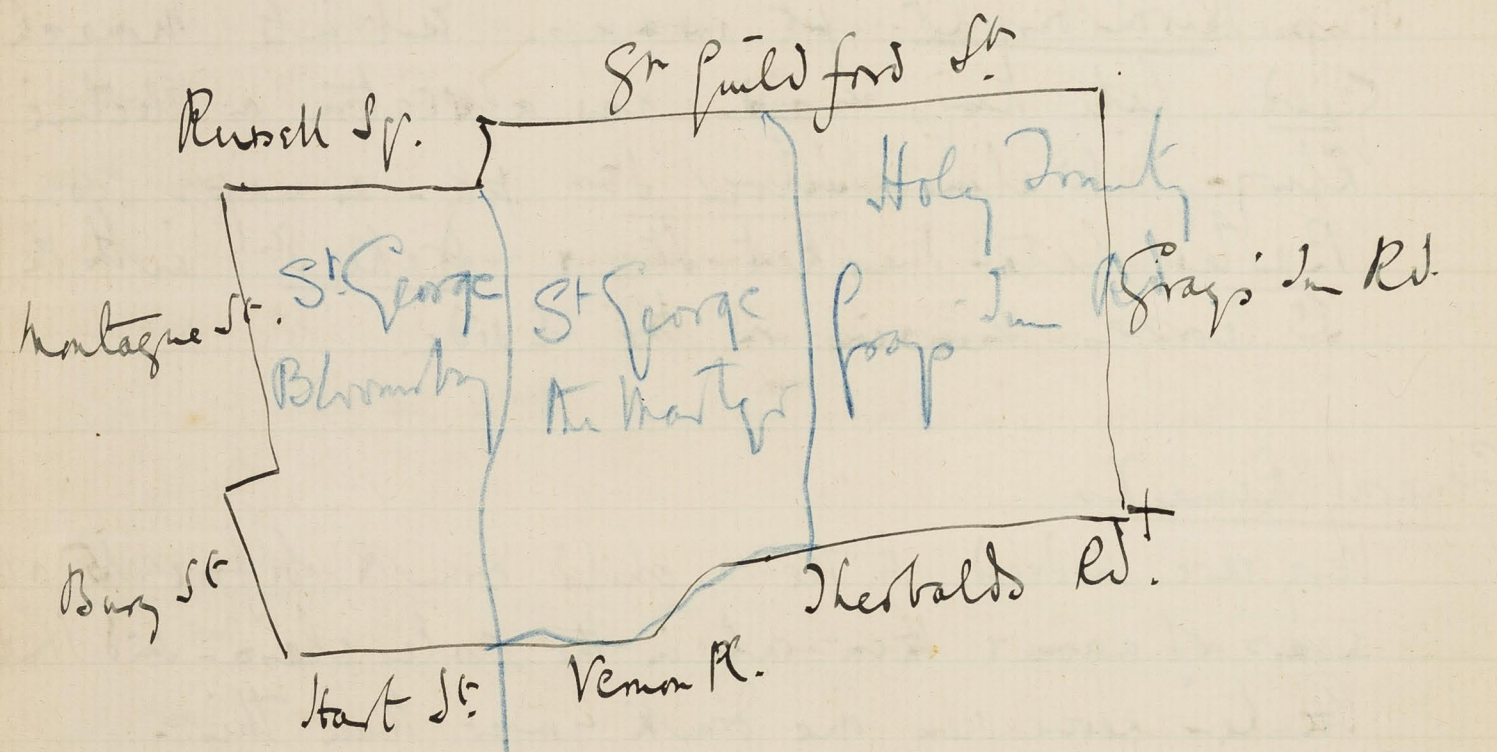

Kings Mews purple

Theobalds Road.

Should these streets be planked?
 (I suppose the break represents completion)

July 13th 1898.

Dist 2

CA(2)

J. H. W.

Walk with P.C. Robert Turner of the E Division round district bounded on the north by Russell Sq. Guildford St. on the east by the Gray's In Road, on the south by Hart St. Vernon Place & Theobalds Road; & on the west by Burg St. & Montague St. being part of the parishes of St. George's Bloombury, St. George the Martyr & Holy Trinity Gray's In Road.

Starting at the corner of Gray's In Road & Theobalds Road west, then N up Kings Mews. 2st. all belonging to Commission Stables well kept. but purple rather than pk of map. West along Theobalds Road - solicitors, architects, offices - one or two retail tram stops. N up John St. 42. Solons etc broad - wood paved. across Little Jones St. - Holborn Free library - all new property - ~~to~~ 2 along Henry St. cobbles - purple rather than pk west of Henry St. loose cobbles.

horse collar makers. Brownlow news running out of east end
 workshops stables. cabyard - a few living over - purple
 as map. W. across Doughty St. 3 or 4 ft. Boarding houses.
 red as map. W. to John's Place. late John's news.
 cab yard - some small ones - as map. to Doughty
news, stables cabmen rather living over. at
 N.W. end the rooms have lately been done up for a
 better class of tenant - cabyard - smart cabs -
 purple as map. I down Robert St. 3 1/2 st. narrow.
 doors shut. windows clean. working class - very respect-
 -ble. no prostitutes - 'The whole street wd rise &
 turn her out if it suspected me' - purple to pk
 in map pink. I down Cockpit yard. 2 st. news.
 purple as map - W to Great James St. 4 1/2 st.
 asphalt paved. Solors, agents. pk based rather
 than pk of map. W to Emerald St. the court
 marked lb. based black on the west side is
 all down with the exc of one db. house on the
 south side - Emerald St. itself is very rough,
 poor, dirt messy, playing children ragged pale,
 playing in mess heaps, criminal - db. or db
 based black rather than lb of map. The
 passage

Robert St.

Emerald St. db. b. 2

Emerald St.

rough

Richbell Place db

Lamb's Conduit St.

East St. W. of Harper St. purple

East St.

Harper News purp

Orde Hall St.

rats.

at the N. end leading W to Lamb's Conduit St. is called Richbell Pl (the name given in the big map to the court lower down on the W side now demolished) also rough poor. st. rather than lb of map. N through passage into Chapel St. N side better than S. as pk it purple. in map both pink. asphalt-paved. can be noisy at times. W to Lamb's Conduit St. shops. something like Red Lion St. 4 st. in map pk-barred. W along East St. 4 1/2 st. houses let out in tenements. quiet as far as Harper St. but noisy west of it. Bread in street. in one window a notice "front room to let on first floor 6/6." shd. be purple west of Harper St. in map all pink. Harper News on S side. cab. paper washes on W side. not more than 6 families living here like Doughty & Brown low news. purple rather than pk of map. on N ^{side in map} Orde Hall St. much better class living here than in East St. ie clerks, salesmen etc. rents 8/6 for 2 r scullery. 3 st. ugly houses - pk as map

Rough Ct w of New North St.

Gloucester St.

Queen Square

map. part Harper St. the ^{central office} ~~case~~ of the N.S.P.C.C. loc.
 pk as map. W to New North St. 4 st. poor
 noisy. working class. ~~It~~ rather than lb of map. Dunstable
 Ct. relate Bedford Ct. is on the west side
 about 12, 3 st houses. rough poor though with out
 the thieves of Verulam St. at the N. end the
 court narrow & the houses are 2 st. some
 flower sellers. old fashioned houses. character
 of inhabitants after the style of Emerald
St. windows broken, children dirty - a place
 to be seen on a Saturday, Sunday & Monday.
Boswell Court. at the N end. 2 st. shops poor.
 It rather than lb of map. N side all ^{to come} coming
 down. W to Devonshire St. 3 1/2 - old houses.
 asphaltic paved - purple as map W to
Gloucester St. 3 1/2. tattie - purple as map - Sage St.
 late Cross St running between Devonshire &
Gloucester St., are pk house on S side only.
 N to Queen Square. 4 1/2 st. hotel & hospitals
 all respectable. red as map. the Holborn
Provision Working Men's Club affiliated to
 the Club Union - still rough but not so bad
 as

Ormond St.

Southampton Row.

Bury St.

Galen Place purple

as it used to be.

East along Ormond St. ^{3 1/2 st.} - pk boxed as map - on the South side Ormond Yd. - a very large courtyard with cabworkshops & repairs. purple as map. Powis Place on the N side has hospitals on either side of it. pk'd as map

W. along Cosmo Place. shops - pk as map to Southampton Row. principally hotels on W side & shops on E. much done for rebuilding on E side. red as map. Southampton Row on the west side - 2nd - corner living over. does not look better than purple - in map pk.

W. along Bloomsbury Place. red as map to Bloomsbury Square. also red.

S. In Southampton St. Relief Yd. on the west side. stabling. pk as map.

Along Hat St. red as map. to Bury St. - red as map. Residential mansions - on the East side is Galen Place. late Pied Ball Yard inf 3 houses occupied. character purple to pk in map pink.

N up Montague St. 3 1/2 st. red as map.

Russell Square

Guildford Street

Guildford Street - red

on the E side are the Montague News, 18 months to run before the houses are out. cabs - being Supply Co. Stables - purple rather than pk of map. St to Russell Sq. $3\frac{1}{2}$ or $4\frac{1}{2}$ - red to yellow in map yellow - used to be many News living here & round about but they seem to be leaving, said James.

Berford Place, $4\frac{1}{2}$ - chiefly Boarding houses red as map. asphalt paved. Bollin Jordan are down & going to be rebuilt.

East along Guildford St, $4\frac{1}{2}$ - Boarding houses. used to have a bad reputation - There are still a few ladies of every virtue living here but the whole character of the street has improved of late years. Red rather than the pk based of map.

San Joane News, on the south side of Guildford St has 4 living houses on the East side - character purple to pink. in map purple.

E to Kambo's Conduit St with the Star Stables at the N.E. end. for the cabs & drivers # in the Star Newspaper's employment.

Long

Milman St.

Milman St. pk

Milman News pk

General Remarks.

Rough spots.

Long Yard. South of it 2nd cabyard. purple on map. E to Milman St. 4 1/2 storied houses. let as unfurnished tenements. a few but very few having servants. One the chief inhabitant. Not so good as Guildford Street. pk to pink toned. in map - pk based at the NW end. are Milman News. very neat. used to be a cabyard but now belongs to Buchanan the Whiskey Distiller & their regular coachmen live there. pk. rather than purple of map. E to Dayly St. red. like Guildford St.

General Remarks.

The two rough spots in this walk are Emerald St. & New North St. The former has improved in so far that there is less of it but what there is is db instead of lb of map. The same may be said of New North St. and the Court off the west side of it. but

Licenses.

Russell Sq. Dist

Betting

Police pensions

in New North St. there has been no betterment by reason of demolition.

In the better streets N of Newbald Rd. the tendency is for the houses to be used as offices & places of business rather than as dwellings. In Southampton Row. The Bedford Hotel. (Nos. 91-3). has a full public house license. It has no bar but strangers can go in & lunch & dinner be served with spirits. Because it has no bar open to the public it has been marked in the maps as a restaurant.

Russell Sq. District passed out of the hands of fashion to the Jews, who in turn are making way for boarding houses.

Jones mentioned a project which he believes the Duke of Bedford meant to enforce to turn the numberless messes wh. were belated to the houses, into gardens & add them to the backs of the houses & so make them more desirable residences.

The vice that Jones thinks is the increase, & greatly the increase is biting.

It takes 26 years for a policeman to get his full pension.

District covered.

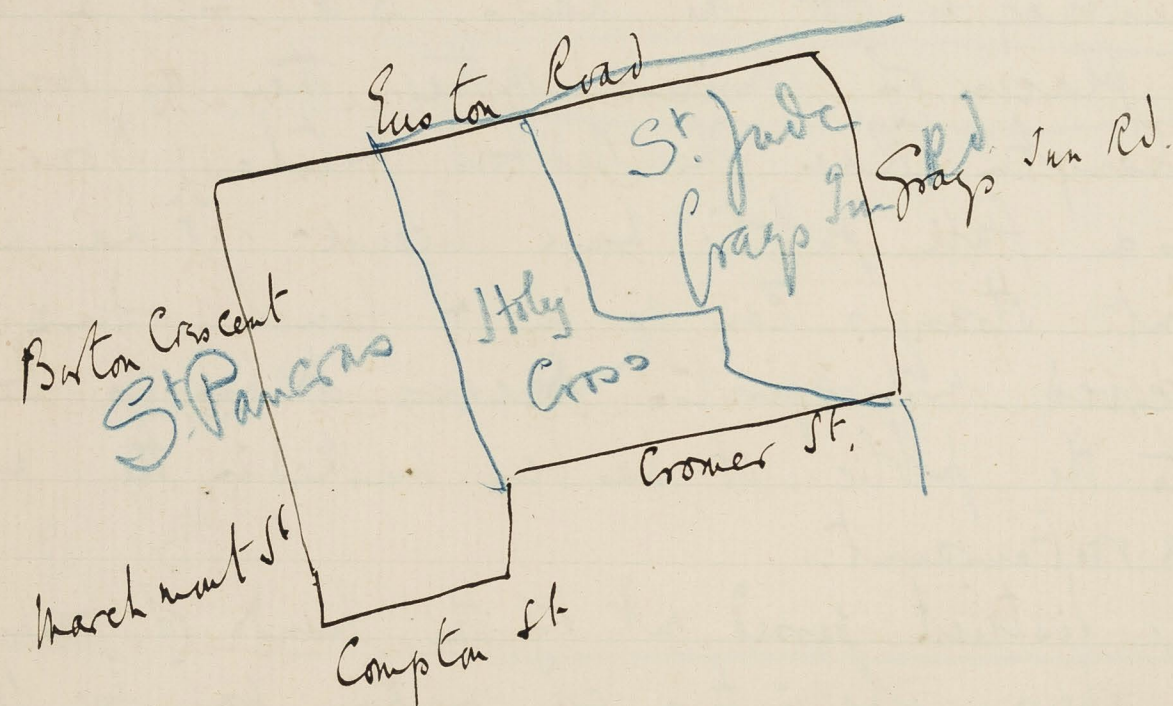
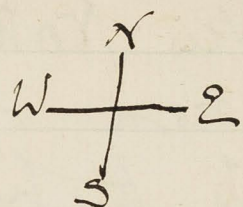

Compton & Hunter Places - db-b²

A Black spot. off Compton St.

July 15. 98.

District IV (M) (2) G.H.S.

Walk with PC. Robt. James round district bound.
ed on the North by Euston Road, on the East
by Grays Inn Road, on the South by
Cromer St & Compton St & on the West
by Marchmont street & Barton Crescent.
Being part of the parishes of St. Pancras
Holy Cross, & St. Jude's Grays Inn Road.

Starting at the corner of Compton Place St & Hunter
Pl. Compton St 4 inch. wood paved. mixed working
class & shops. pk a map. on the North side
are Compton Place & Hunter Place. both marked
black in map. Now all that is left are
the houses at the West end opposite the Police
Office. a few at the N. end & a few at the East
end on both sides of Compton Place (see map).
Irish - are barefoot - medical mission at the
W end. 3rd - exits both into Hunter St &
Compton St. - has been very bad - now less of it

it o observed instead of black. Light air & space
have done a little even for those who remain.
W to Marchmont St. the north portion is a
street market - very small one - shops - pk as
map. East along Leigh St. 42 st. cobbles -
mixed shops & residences - pk as map - N
up Sandwich St. not so good as foregoing.

2 small cabys
on E side

42 & 32 - mechanics & some police - windows
not very clean - are sometimes more families
on each floor - purple as map. to Staring St.
St. also purple 32 st. part Thames St.

22 st. two cabyards & a horse dealers yard -
purple as map - ^{don't} ~~part~~ Mableton Place 42 st.

known prostitutes living here. part Bibbings St.
less good E than west of Judd St. - as pk
to purple - as map. large liquorice factory on
the N side & carpenters on South.

N to the Easton Rd. - a great number of hotels
with gardens running down to the main road. of
very doubtful reputation. We cant tell whether
they are respectable couples or no. said Dunm.

S. then S. down Dunbridge St. 22 & 32 stairs
low

Which is Mableton St.?

Tonbridge St - S of Bidborough - db

Peace Cottages

rough.

Peace cottages db b^d

Brunswick Buildings - lb

Speedy Place - lb

Lucas Place - purple

a mess in the street. The west side of Tonbridge St S of Apple St is rough. Db. rather than purple of map. on the East side opposite, are Whitton Bldgs - built 1890 - 5st. East end Dwellings Co 6/6. 2r. police & postmen - purple as map. At the SW side are Peace Cottages - several known characters here. 2st. narrow - houses on both sides - 'a rabbit-warren'. 30 houses - Irish windows bad. bread & mess about. kids at window wash across passage. child-ven ragged & pale but not ill-fed looking. ragged school at South end. Db. based rather than lb of map. Of this place & the S. end of Tonbridge St Hunter spoke as 'a fine get away from the Lufta Road for thieves -

at SW end of Tonbridge St are 2 houses - called Brunswick Bldgs. quick lb. not coloured in map. W. along Cromer St on the N side is Speedy Place. 2st. poor. 23 ho. 2 room for 5/- & 6/-. lb to purple in map lb. Lucas Place on the S side of Cromer St. 2st. has many postmen & police. 9/- bid for 4r. creepers over

Improvement in a Black District

Whidborne St^e purple

Midhope St^e purple

Tankerton St^e purple

Laxham St^e purple

Argyle Place purple

Argyle St^e

brothels.

over them - purple ^{in map}. It up Whidborne. Late Bright
St^e 5th. Bldgs on either side - purple - in map
black. I don't know Midhope St^e. Charwood ^{St^e}
on the East side here. are slightly better than
the rest of the 8/6 to 10/6 for 2 rooms & scullery.
but purple - in map black. E to Tankerton
St^e - one or two of the old 2st houses remaining
at the south end - a great number of police
inhabit these buildings. It up Laxham St^e
messy. has Bldgs on the west side - to
Argyle Place. Late North place - on the north
side are the rooms of the Salvation Army
prison gate brigade - which has brought a
number of undesirable characters to this
quarter.

It up Tanbridge St^e to the Linton Road, on the
west side is a clearance where the Linton Theatre
of Varieties is to be built. E. then South
down Argyle St^e. Home for fallen women at
S.W. end. There have been a number of brothels in
this street, & there are still one or two here. I
shd not care to guarantee said Hunter. is
called

Disorderly houses.

Belgrave Street - pk b²

Chesterfield Street - pk b²

Derby Street - pk

General Remarks.

2 to Belgrave St. 3 1/2 st. apartments. pk based rather than rd of map. along Angle Square. 4 1/2 st. rd as map. N up Chesterfield St. pk based rather than rd. E to Liverpool St. 3 1/2. Some hotels. respectable & dis respectable. like Angle St & Chesterfield St. pk to pk based - in map pk. on the E side is Derby St. 3 1/2. 'like Angle St.' looks - pk based rather than rd of map. S to Manchester St. like Chesterfield St. 3 1/2 st. pk based - in map pink.

General remarks.

Two things to be noticed in this walk 1. the densities & building of the black area N of Corner St
2. the number of streets in the neighborhood of Angle Square containing disorderly houses - to supply a provincial demand arising by the GNR at Kings X & St. Pancras by the Midland. The majority of the hotels keeps as foreigners said struts.
? Shd these streets be marked with a line of black or no.

District covered.

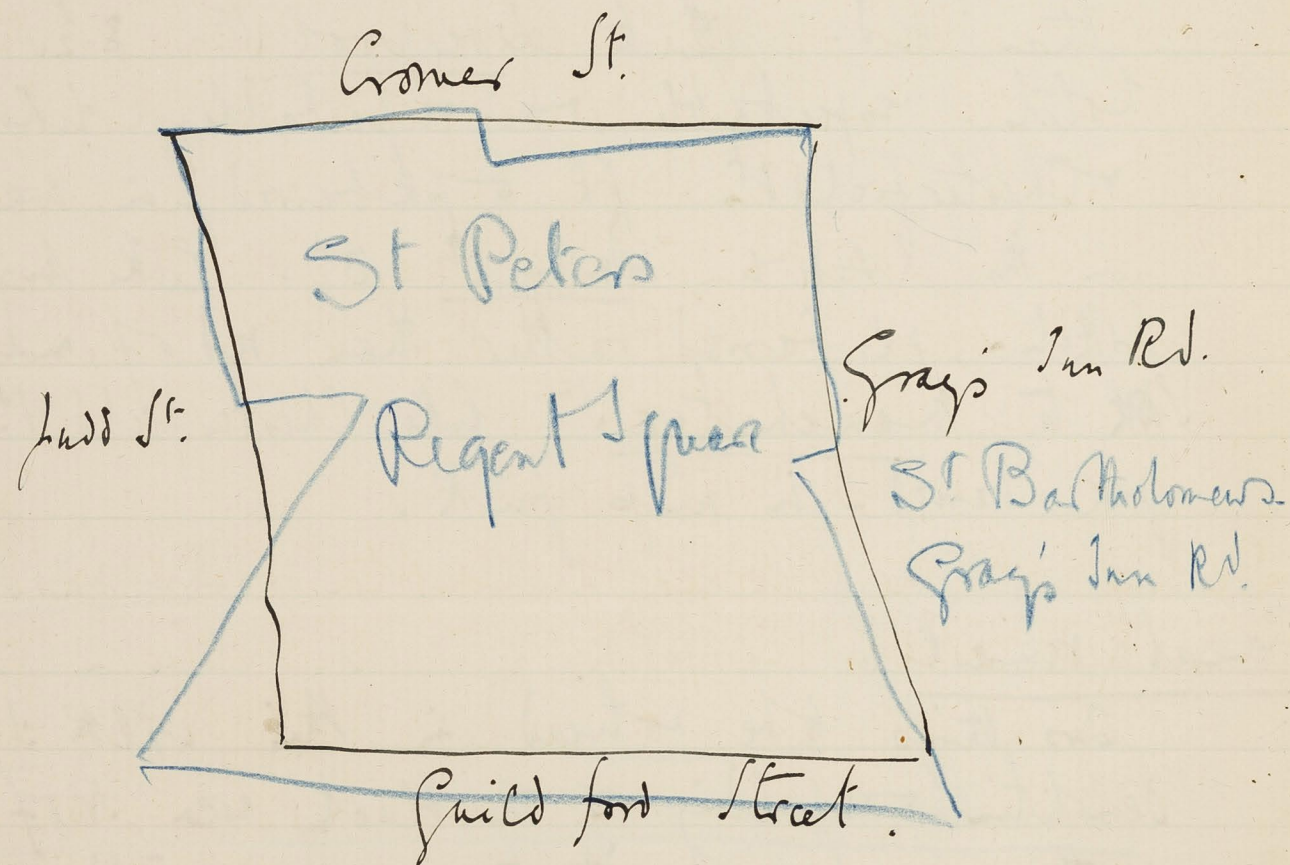

Harrison St.

NB the SE-side of Harrison St is in bad repair. It to be sold.

Monday July 18. 98.

District IV. G.H.D.

Walk with R. Robt. Turner round district bounded on the north by Cromer Street on the East by the Gray's Inn Road, on the South by Guildford St & on the west by Judd Street - being part of the parishes of St. Peter's Regent Square & St. Bartholomew Gray's Inn Road

Starting at the corner of Compton St & Judd St then East along Compton St 3 1/2 r attic - cobble paved pink as map. to Wakefield St 3 1/2. pk as map. on the W side are the Wakefield news. one or two small cabouner & small stables used by ships - The rooms overhead are let out to a poorer class - lb as map.

2 along Harrison St not so good as Compton St 3 1/2 st. cabyard on S side. some roughish houses near Seaford St. people ⁱⁿ it. is a mixed st. might be one or two prostitutes living in it - they drink & quarrel on both sides of the st.

Seaford St.

Derry St.

very rough.

map marks S side pt.

S down Seaford St. - houses on E side only. very high
 3 1/2 st. holey blinds, open doors, bird cages outside
 windows - like the rough bit in Harrison St.
 Some houses better than others - lb to purple
 in map purple - Sidmouth news on the E side
 cab yard - 2st. 'better than Seaford St.'
 purple as map. into Sidmouth St. 4 1/2 st.
 Some crowding in single rooms - mess, bread in
 st. mixed working class purple to lb. in map
 purple. S into Derry St. 3 1/2 st. very rough,
 cotes, Irish predominant - asphalt paved.
 vegetables, meat & bread lying about, all doors
 open, children dirty, ragged, 4 barefoot boys,
 one child with only a shirt. Hunter had been
 into one house after some watchstealers &
 found rooms low & dirty & a father & mother
 & 8 children in one room - Bricks thrown
 down on police from house tops - none living in
 the basement though a good many make a
 free night lodging of it. S barred as map.
 into Prospect Terrace. houses on N side only

Prospect Place.

Gray's Inn Road.

Mecklenburgh Street - pk b^d

Mews opp. Church - lb

Blunje's Yard - db

plenty of space since the S side has been cleared away
, barefoot, broad & great mess in St. Vicar proved
his right to the road as leading to the Bins,
ground in the law courts, as a result the
parish will not clean the road & hence its
filthy state - a disgrace - only a foot 8 long
on the North side - but three or 4 different
owners.

E to Gray's Inn Rd. turning west at Strathcote
Road. pk barred as map exc at SW end where
a small cabyard, owner living over, pk a map.
Great many lady medical student lodging
in the street. I saw Mecklenburgh St 4 1/2
st. apartments - not more than one general
servant kept - pk barred to red - in map red.

E to Gray's Inn Rd. on the west side opposite
Trinity church is a mews, poor, lb to purple
in map red. & further south on the E side
called 159^a Gray's Inn Rd. is a yard
'known locally as Blunje's yard' with two
houses lived in on its south side, though
db. not shown in map - a shaming forge also
here.

Gray's Inn R^d - Guildford to Sidmouth - pk b^d

Mecklenburgh Square.

Wolf's Yard - pk

Gronville St.

ill-fame

37

The west side of the Gray's Inn Road between Guildford St. & Sidmouth St. is not so good as Mecklenburgh square, no servants kept, pk barred rather than red of map.

W. along Guildford St. N up Doughty St. 3 1/2 or 4 1/2. pk barred road - in map red. Mecklenburgh news on the W side. Is a cab yard. A little better than Brownlow news - on N side only - purple rather than lb of map. N to Mecklenburgh square. ~~see~~ Boxes. red as map - principally one family to each house. 2 or 3 servants usual - sometimes 4 or 5.

W. along Guildford St. on N side is Caroline Place - boarding house & families - 4 1/2 rows - red. W. along Guildford St. on N side is Laundress Pl. 4 1/2 st. red.

W. along Guildford St. on the N side is Wolf's Yard. private property. belonging to a jobmaster. purple to pk. not coloured in map.

N up Gronville St. 4 1/2 - several houses of questionable morality here, pk barred rather than red of map. At the west end of Guildford St. is the news

The Colonnade.

Improvement.

Colonnade - purple

Guildford St - red

General Remarks.

news called the Colonnade. The N side is all down & already made into small gardens for the Bernard street houses (a passage of the DK of Bedford policy, mentioned before) on the S side are stalls & cabs. with stablemen living over. The new enormous Russell hotel backs on the west end of the Colonnade. Character th to purple. but it used to be a rabbit warren - in map dk barred. N to Bernard St. 4 1/2 st. asphalt. is like Guildford St. has gone up a degree of late years but red on map.

General Remarks.

The worst spot on this walk is without question Dany St & Prospect Place. The first & most obvious improvement here wd be to sweep the streets. The Colonnade as mentioned just above is down. The rest of the area is respectable with the exception of rather frequent hinting at the existence of disorderly houses.

District covered.

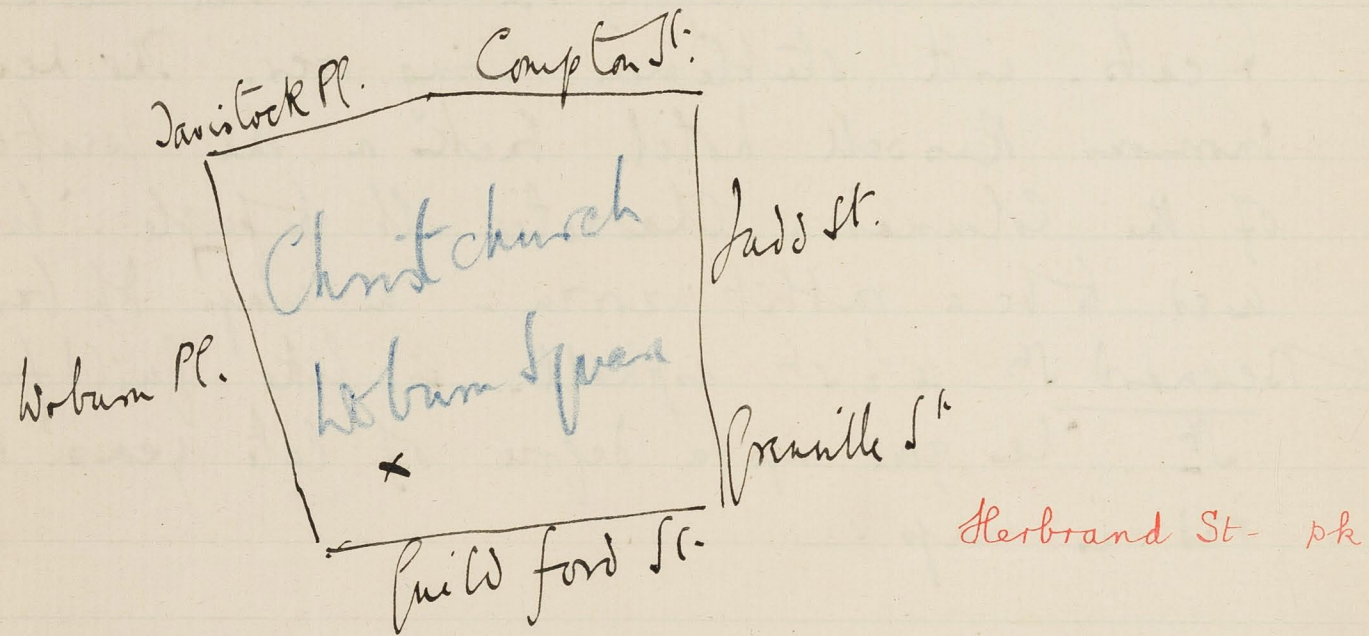

Bernard Mews pk
 Little Woburn St Peabody Dwellings purp.

Great Woburn Street pk

July 18. 1898

Dist 2 (1) (2) G.H.S

Walk with P.C. R. James round district bounded on the north by Davitock place & Compton St. on the east by Judd St. & Grenville St. on the south by Guildford St. & on the west by Woburn place: - being part of the parish of Christ Church Woburn Square.

Starting at the corner of Bernard St. & Little Woburn St. - Herbrand St. (late Little Guildford St.). Herbrand St. the west side is all down, belongs to Bedford St. & is to be rebuilt with broader roadway. The east side belongs to the 'Foundling' estate - purple in character. houses let out in floors. in maple. Bernard Mews on the E side 2st. is equally purple - N to Little Woburn St. which will in time be a continuation of Herbrand St. & called so. On the E side are Peabody's Bldgs. police & working class. 2r. 5p - 3r. 6/6 - one room for 3p per wk. purple rather than pk of map. S to Great Woburn St. asphalt paved. unfurnished floors

Kenton Street

Kenton Street - purple

4 convicts.

one or two houses amiss but much better than it used to be said Hunter. very few keep a servant. pk to pk based rather than rd of map. E to Merchant St 45th pk as map. like great Coran St shops N of St. C St but let out in floors of it, working class, clerks, tailors etc. E to Kenton St 4 st. mixed working class - "very like the lower end of Merchant St tho' it does not look so good. on the Foundling estate a few small shops. purple rather than lb of map. S of St. Coran St it is also mixed working class. windows, unbroken, clean, most doors shut purple. Calson Yard at the S end is stable, 2 st, new, purple - cabs. E along Stavel St 4 1/2 st. like Kenton St purple as map, on the S side of it is Hunter news, cab yard, with stablemen over. ll. in map pink.

General Remarks.

as to the treatment of ex convicts. Hunter said that the Detectives were the only member

members of the force who really knew them by sight & by name. If any information was given into the outside world it was they & not the police constable who was to blame. The ordinary R may happen to be in the station when a ticket of leave man reports himself but it is quite a chance whether he is or no.

District covered.

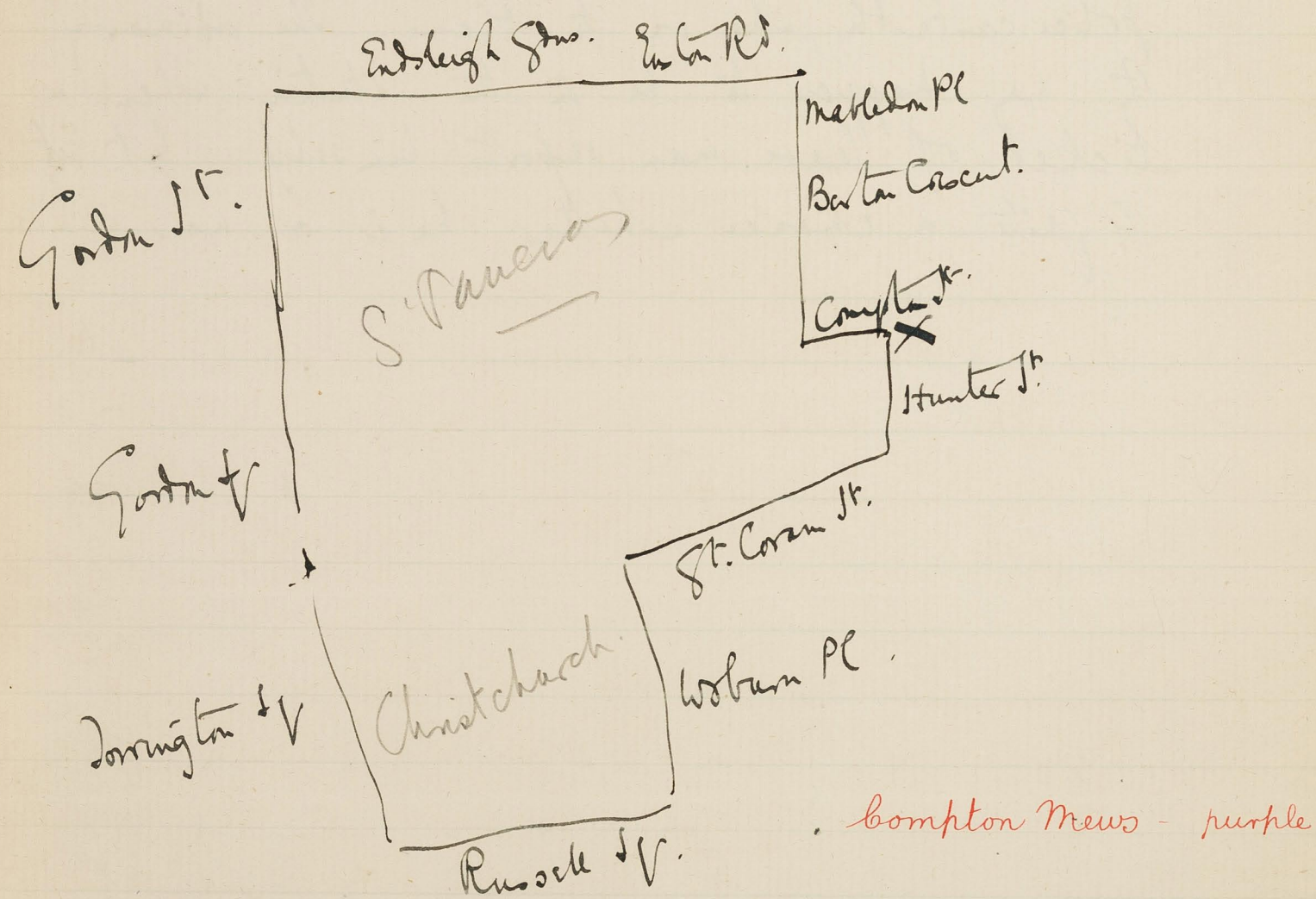

July 19.

Dists 2 & 3

G.H.D.

Walk with PC. R. Turner round district bounded on the North by Emsleigh Gardens and the Euston Road - on the East by Mabledon Place, Barton Crescent, Hunter St., Great Corn St & Woburn Place: on the South by Russell Square & on the West by Jorington Square, & Gordon Square & street - being part of the parishes of St. Pancras & Christchurch.

Starting at the corner of Compton St and Hunter St, then W. on the South side are Compton Mews, a cab yard, purple rather than the pink of the map. forges & repair shops in the yards - W to Hunter St used to be many houses here of questionable character, now only 2 or 3 are suspected, a few but not many keep servants - pink as map. & along Handel St. purple as map on S

Regent Buildings pink

Woburn Mews - lb

Russell Square District

S side. Some questionable houses. On the N side at the corner of Wakefield St. is a School of Medicine. out of the S end of Wakefield St. are Handel Mews. cabs lb. & Regents Bldg rather better cabs. purple.

W along St. Coan St. to Woburn Place. well-ltd. boarding houses. red as map. Woburn Mews. on the W side is a cab yard. 2st - poor - purple to lb rather than pk of map.

across Russell Sq. leases falling in & houses being done up with terra cotta facings. not many what you'd call carriage people living here now. perhaps still yellow as map.

East Upper Bedford Place. 4 1/2 st. boarding house. red as map. up Montague St. to Woburn Sq. red as map - wood paved at S end is Upper Montague Mews belonging to Wolfe a large Jobmaster - his coachmen. a good class live here. pk as map. N to Gordon Square. better than preceding. 4 1/2 & 5 1/2 storied houses. macadam paved. yellow as map.

North Endleigh St. Devita St. Gordon St.

Endsleigh Gardens - red

Upper Woburn Place - red

Javistock Place

This man was not a Salvation Army man. He called himself some adjective Salvationist & wore a naval uniform. 8/11

are all alike. red & yellow - in map yellow. Endsleigh Gardens. less good. apartments. N^d Residence. homes for ladies etc. red rather than the yellow of the map.

Upper Woburn Place. principally N^d Residence. all nations - Welsh - French & American board. ing houses. red rather than yellow.

S^d Javistock Square. better - no N^d Residence. 4th st. used to be many Jews here but they are leaving - going to Hampstead - yellow on map.

East along Javistock Place. better is than E of Coam St. Tenements east of Coam St. p^t - some questionable characters living here - red on map west of Coam St. on the north is the Salvation Catholic Church & the place is called S^t Andrews Temple & training hotel. lately shut because it was found that the Salvationist running it was defraying his expenses by ordering bicycles & then pawning them. This Building has had a chequered life. was a chapel. then a disorderly club. lately

lately a cycle school & cabinet factory.
 N up Merchant St. on the west side
 is Margaret Row. in map lb. now demolished
 & closed. north of it are South Crescent
Mews. cabged - poor - not many living there -
 belonging to one Pettitt who has 3 other
 yards - on a wall was a notice 'According
 to Union Rules any driver giving blood
 money will be discharged.' Turner said his
 drivers were a 'worn lot'. lb as map.

N to Burton Crescent. the ~~W~~ side shd be pk
 rather than the purple of the map. on
 the west side are some questionable character
 houses let out in floors. 42 st. but better
 than it used to be. purple as map -
 behind it on the W is Burton St.. N
 end lb & lb. over ~~from~~ from Brantome Place
 on the W side is a common lodging house for
 women - of a disorderly character. two specimens
 were parading the street & objurgating the
 deputy with a very choice selection from their
 vocabulary. N of Burton Crescent may be
 lb

Burton Crescent.

Burton Crescent & side purple

Brantome Place.

Worsement.

Brantome Place db b?

N. Crescent Mews db b?

Mabledon Place - purple

db. & the south of it remain purple as map.
N. through Brantome Place. 3¹/₂ st. rough
Irish, thieves, overcrowding. all doors open.
windows patched & dirty - women sitting on
doorstep suckling babies - children pale &
very dirty - much drunkenness - I have
known them sell their Xmas dinners! Tickets
given by the charitable for change at the
seaside often sold - flower girls - clothes
not very bad though dirty - add a line
of black to the db of map.

S.E. to N. Crescent Mews. cabs - SE side used
to be small houses and many of which
are now demolished. Those that remain are
still bad - are mere hovels at the S.E. end -
one bare foot - windows broken - add a line of
black to the db of map. Several came in
here for the clearance north of Cones St
(black in map) they won't leave the neighbours -
- 'good if they can help it.'

N. along Mabledon Place. many doubtful house.
& two lodging houses - beds 6.90 & 1/-. The
doubt

Mableton Place

Duke's Road - pk

General Remarks

Doubtful houses said Turner are practically 'brothels' & the man who keeps the doorknocker has already been 'done' as a 'fence'. Bits of bread & bacon in the street. purple barred black rather than the pink of the map.

Into the Ruston Road then South down Duke's Road. flats on the E side - clerks p.R. # 3 rooms in basement to let £45 a year - not marked in map - at the south east end is called Bowers toffee factory. 'Noone wd eat their sweets if they knew what rough, dirty girls they are packed by'. W along Woburn Bldgs. 3rd. shops - some let out in floors - purple as map.

General Remarks

Brentone Place & N Crescent news gives a sudden check to the yellow & red prosperity of the Bedford Estate. Note that some are the outcasts from the Cromes

Publicans & closing time

Corner St. clearances. (Black in map).

As to closing times of Public Houses.

James said there is undoubtedly a good deal of treating by Publicans in back rooms after hours. Tradesmen come in, closing time surprises them. The publican does not like to turn them out. They fill up their glasses & adjourn to the back room. It is practically impossible for the police to discover them or to enter the house upon suspicion.

James had never thought of the possibility of forbidding publicans to live on their premises & making them turn both themselves & everyone else out of the house at closing-time. The manager system would make such a measure much easier now than formerly. Many managers he thought would be glad to live away if they could and such a system would make them less eager to open early or close late or entertain after hours.

The West streets.

83
asked to name the west streets in the
subdivision. he said he sh^d give

Derry St

Prospect Place

Emerald St

* Eagle St

} the first place

a proxime accessit.

District covered.

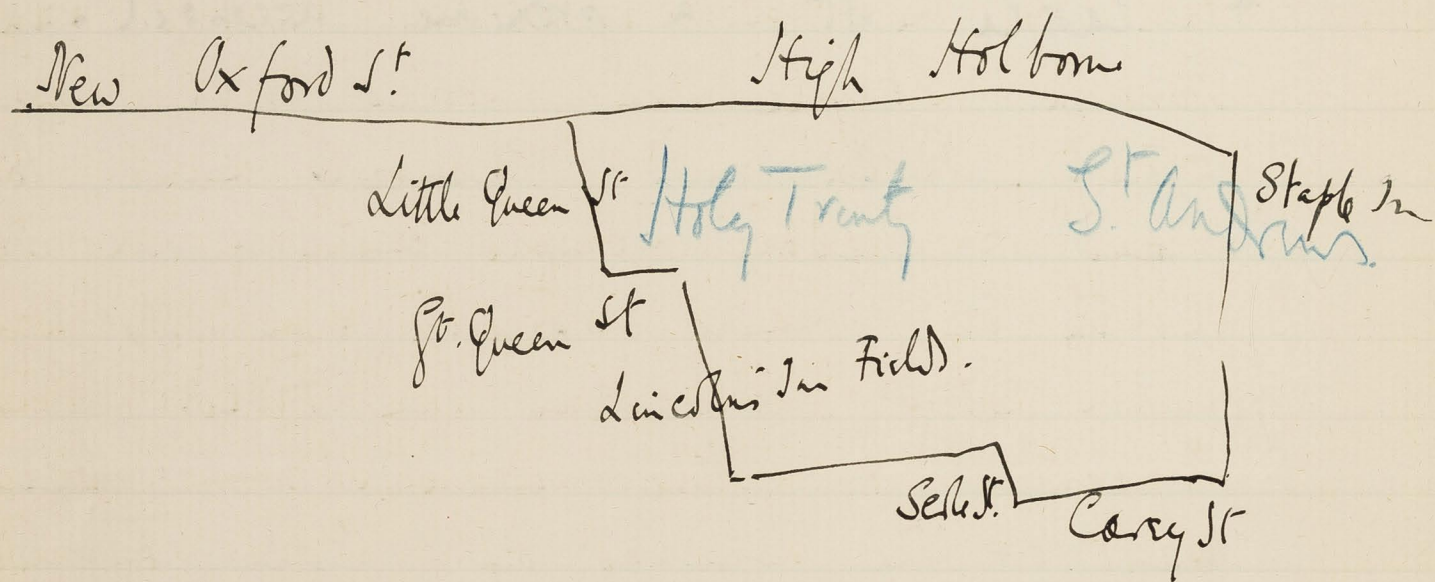

New Oxford St.

Museum St.

July 21.

Dist 2

G. H. D.

Walk with Police Constable E. Tait round district bounded on the North by the New Oxford St & High Holborn, on the East by the City boundary which runs through Staple Inn, Took's Court, Curator Street, Rolls yard, Chancery Lane, Bell yard & Middle Temple Lane; on the South by Cary Street; & on the West by Selby St & Lincoln's Inn Field. Great Queen St & Little Queen St. — being part of the parishes of Holy Trinity, Lincoln's Inn, & St. Andrew.

Starting at the west-end of New Oxford Street. Asphalt paved. Easy to clean but slippery when muddy, & breaks up very easily when there is any frost. 4 st. shops with houses & apartments over. red as map. High Holborn is rather poorer. 4 st. poorer shops. with some working class. St. John Museum St. 4 st. shops. all let out.

Costs of S side of
High Holborn.

Staple Inn

at overhead to skilled workmen. rents for two rooms
on first floor 10/- per week, 8/- on 2^d, 7/- on 3^d.
pkbarrid rather than pk of map. E along
Broad St., east past Smart's BChp. Kellys the
Directory people have all the west side, on the
east, 3¹/₂ st houses, poor but not the lowest,
no thieves, road sweepers, lb rather than lb
of map, 'has improved', ^{the} windows broken &
patched, & bread & cats munching garbage in
the street. ^{E along Holborn} Red Lion Yard. no way through to
Whetstone Pk, all factories, in map purple.
East of it is Holborn Place. Factories - way
through to Whetstone Pk. Dickbone Ct. only
warehouses. Great Dunstable, 3 & 4 st. shops
& houses - pk no map.
E across Chenevry Lane, on S side of Holborn before
reaching Staple Inn is Staple Inn
Buildings. The New Buildings of the Bank.
Bank Bank take up the west side. On the
east are 5 houses, 3 st. rath. quiet poor -
chs clean, windows fair. purple to lb in
map lb. Through Staple Inn. trees, old fash
lms

Courts off East side of Chancery Lane.

Lookes Court - purple

Chancery Lane, courts off W side

Chichester Rents S side pur

89
faded, quiet, restful, green after heat but rise of
Oxford St. W. to Southampton Bldg. all offices - ^{the} Birk.
Bank a large Dalton base Building on the
on the E side -

Into Chancery Lane then S. Quality Court on the
East side. patent offices, 3 1/2 st, draughtsmen & type
writers, only caretakers living here.

E along Curator St. & N up Lookes Ct. 3 1/2 st.
National Chambers, a common lodging house
at the N.E. end. home of law writers 'scribes',
shabbies, sandwich men, costers, some thieves,
round the corner is a laundry with rooms let out above.
Breams Bldg. all offices. & Stac Yard the same.

on the West side of Chancery Lane. South of Lincoln
Inn Rd square. on Chichester Rents. N side
is all offices. South side are small shops with
working class living over, scribes, poor but not
worse than people in appearance. lb in map.
Bishops Court. both of it. has west end
of N side down, not people, S side is all
offices. in map lb.

N up Chancery Lane, turning West at Whelstone
Park

Whetstone Park.

Little Queen St.

General Remarks.

Σ. Tait. PC. 17. ER.

None living on South side - people as map on the North - fostered tenement, respectable working class, a pink class living in the first floor but less good above - mess in street, packets of bread steam about.

Map Gate St. & W. to New Dumfries Passage. 3rd. flagged passage with small shops on either side - respectable working class - people as map.

W. to Little Queen St. on the E side is George St. poor corner, lb. living on South side - a pile of old bread & pea pods in the corner. South of it is Joz. Ford's Bldg. only two houses on the South side. 4th. ^{on N side} doors open windows dirty, children pale, dirty but well-clothed - lb as map.

General Remarks.

Σ Tait. has been 10 years at Bow St. and 16 years in the police service - coming here from the Caledonian Road subdivision - He is nearly 6 ft high; ^{stiff}

E. Tait.

Policeman's duties.

No change in working classes.

Queries of Licenses

Mr. The Inn of Ct. Hotel has no
bar but a full license ^{used by outside party} - so therefore
worked as a restaurant.

walks as though he had a poker down his back.
Long face, dark beard & moustache, black sordid
hilly cock hat, tail coat & trousers, new
boots too tight for him - as if dressed for a
funeral. Is rather a stupid man or has had a
recent sorrow. Is in the Reserve, his next
step wd be to ^{grade of} sergeant, but fears his
time for promotion has passed.

The most tiring part of a policeman's duty he thought to
be the direction of traffic. 'Not everyone can
do it'. He thinks it requires a special gift
to enable you to 'keep the traffic moving
& your foot crossings clear'.

He has noticed no change in the working class since he
has been in the force. Thinks they drink as
much now as ever they did when they have
the money.

There are 400 men in the Bow St. subdivision. of
whom 96 are living in the Section house.

No. 243. High Holborn. The Royal Music Hall. Has two shops
one at either side of the Hall fronting on Holborn.
counted as one house because they only have one license.

District covered.

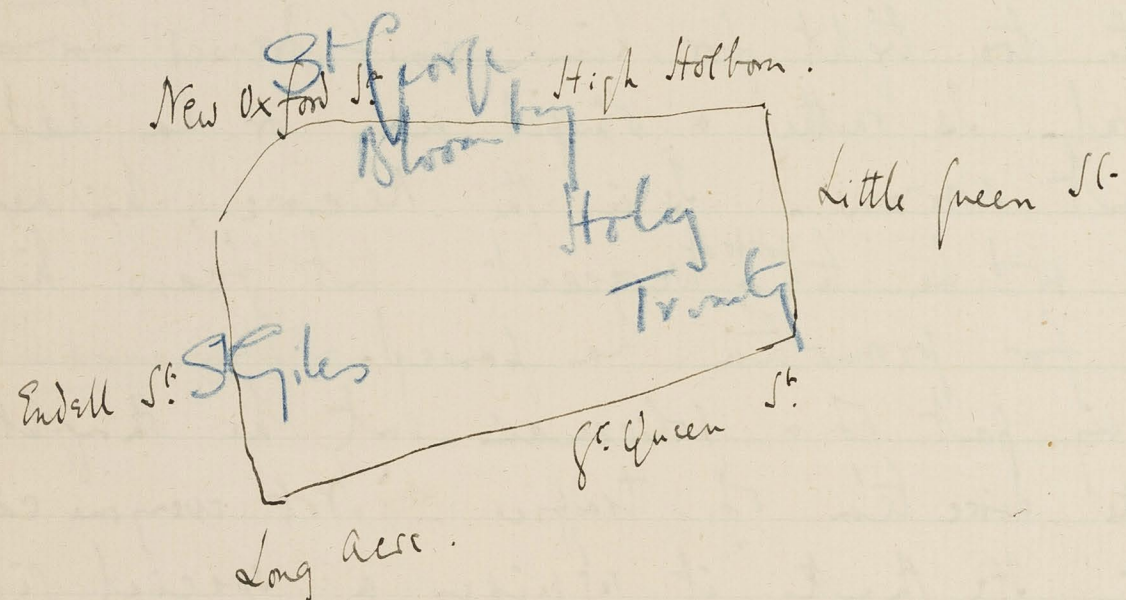

Great Queen St.

Newton St.

July 25. 98. Monday. Dist 2 CP ② G.H.W.

Walk with PC & Jait. round district bounded on the North by New Oxford St & High Holborn, on the East by Little Green Street, on the South by Great Queen St & Long Acre & on the West by Endell St & Shaftesbury Avenue, being part of the parishes of St Giles, St. Georges Bloombury & Holy Trinity.

Starting at the west end of Great Queen Street, then East. Great Queen St. a mixture. some poorish working class, shops with owners living above, two or 3 where servants are kept, 3 or 4 storied, street asphalt paved, bus line, red brick Trigo Jones house on S side, & Freemason's Tavern, South side perhaps better than the N. in map as red to pink. Map Little Green St. shops - let out above. into Holborn, W to Newton St then S - cobble paved. on the east side is the Holborn Rest which now covers the

dark blue shown in map. The west side taken up by a large firm of ball & rort furnishes. Facing the East end of Macklin St. on the E side are the Holland Dwellings. Tenanted by market porters & policemen, purple as ^{2 rooms - 6/6} map. South of it is Trinity Court. in map black - on either side is a Lodging ^{for women} house. not a lot of the women of low repute sleep there & match & flower sellers, 'beds about 6d a night' said Jait. The rooms as seen through the windows giving on the Court looked clean, in a bedsteads. (?) rather db than black.

Wimbleton Bldg. making the S corner of Macklin & Newton St. flats - 3v. 8/6. purple as map. N to Broad St. then W to Drury Lane. The west side is being rebuilt (db in map) on the E side (purple in map) on the Goldsmith St. Buildings. tenanted by a very poor, very rough class about as rough as we have them. shd be db. shops underneath.

E along Goldsmith St 3 1/2 st. poor rough - not prostitutes but thieves, majority Catholic ^{country}

Trinity Court db

Drury Lane

21.iii.99. F.2A RGH.D.
 NW side now tenanted by distillery stable with men living over: pk.
 Drury Lane at NW pk

Goldsmith St

Goldsmith St E end N side - lb

Macklin St

Macklin St S side pk
N side db

99
cockney Irish - Faces at windows of criminal type
but windows themselves fair clean & unbroken,
children dirty, pale, sore eyes. ^{It is the} Board School
Infant School on South side - on the N side
at E end (db in map) are quiet poor, road
sweepers & paviers, men employed by the Vestry!
lb rather than db. South into Macklin St
the E corner ^(opposite Macklin St) (black in map) is now covered
by the St John's Casual ward, the west corner
by the mortuary -

Macklin St on the South side from E to west -
first purple suburbs (no black) then the
R.C schools, then respectable 3rd dwellings
occupied by skilled artisans, then a brass
factory & then more pk bldgs up to Drury
Lane. On the North side, west of
Newton St are first the mortuary, then
a common lodging house - low class of market
porters, black as map, then Staffordshire
bldgs - working class, purple. then another
lodging house - market porters, shablacks
costers, db lined - (in map it is all black).

Parker St

Shelton St. db l?

Parker St. nw - pk }
ne - lb }

Wilson St.

Wilson Street & end purple

up Charles St. coaching }
messy } →

In Drury Lane between Macklin & Goldsmith St. are more 'Dwellings' over shops. purple as map. 3. then E to Shelton St. Only one house on the N side - poor rough. db. lined - The south side is down - in map black.

to Parker St. The south side of the west end is black as before - bread in St. further East are warehouses, a dog house (black) the back of one that has a respectable front in Q^t Queen St. prices 6^d 9^d & 1/- - just opposite on the N side is the LCC club house with a uniform price of 6^d.

On the N side west of the LCC house are 'Butt' 4 st rathic. respectable working class, no poor, 2 or 7/6, purple by pink. & a turning has been made into Shelton St.

W along Wilson St. paper & carriage factory on the S side, dairy staples on the N & East of them stables belonging to Combe's Brewery.

The S.E. corner of Charles & Wilson St. is poorer, purple. in map pink. in Brokers Alley which leads east from Castle St. to Drury Lane, on N side

Worsment in Betterton St

Betterton St - db.

Broad St

Broad Street - pk

Jait thought that the inhab. fronts of the ^{Hyde St} }
houses in Parker St folds with St were a }
class above the Whitechapel houses because in }
the former they all work for a living

side is the St Giles' Mission for fallen women &
a cloth workers. W along Castle St mesog.
3 attic. shavings, hay, paper, vegetables in the
street. purple as map. Map Endell St east along
Betterton St 4th cobbles. poor, rough noisy class, organ
playing, crowd of ch. dancing & listening, pale, fairly
booted. Fed. bread, mess in st. the inhabs are coopers
market porters road sweepers - most doors open -
birdcages outside windows all were fairly clean & unbroken
db to db. rather than purple of map. N to Shoto gardens
Becomes with Dung Lane - down - Two communal lodging houses
on the south side - db as map - on the N are Combe's brewery
& the St Giles' Workhouse. N to Broad St asphalt paved,
working class, salesmen, porters, mechanics living over
shops, no servants kept pk rather than red of map -
Lascelles Place on the S side. 3 1/2 st. dingy. working
class. doors sharp purple to pk - in map pk.
Map Museum St New Post Office on E. shops on west - pk as map
& to Hyde St. N side pk rather than purple of map. into Oxford St.
Vine St on the S side is all distillery.

General Remarks - Betterment in Parker St area by reason of demolition &
rebuilding has been followed by worsment in Betterton St at the N
end of Dung Lane the db. has nearly moved across the road.

District covered.

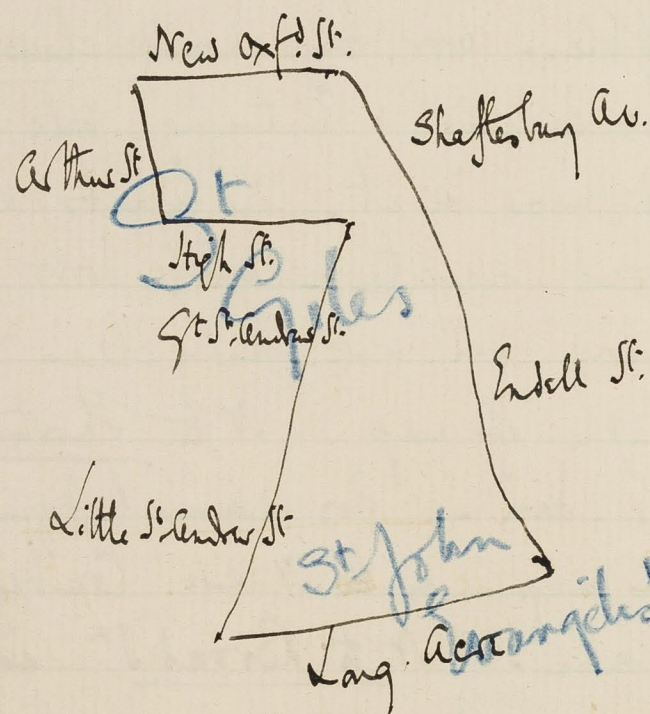

Shaftesbury Avenue - pk b²

Dyott St. - S of Oxford St. - pk

Clarks Bldg

Police Section House.

July 26. 98.

Dist 2 CP2 G.H.D.

Walk with R. & Tait round district bounded on the North by ^{New Oxford St.} Broad Street, on the East by Ennill Street & Shaftesbury Avenue, on the South by Long Acc. & on the West by Great Little St. Andrew St., High St. & Altham St. being part of the parishes of St. Giles & St. John the Evangelist

Starting at the corner of Shaftesbury Avenue & Broad Street. Flats here. ~~is~~ servants kept, called Ashley house, respectable, theatrical tenants, pk barred - is marked as the site of a church in the map. Map Dyott St. 3 1/2 tallie - houses on W side only. St Giles Mission occupies 4 of them. Seaton mansions at SW end. purple 6 pk. in map purple. better since removal of clothing house. W along High St. on the N side are Clarks Bldg police Section house along the West side, on the East are working class, mainly Irish. 3rd is a paved passage - purple as map. 45 police live

Arthur St.

Shots Gardens.

Neal St.

worment.

Neal St - exc SE end - lb

live here. w to Clarks News, warehouses, factories, forge - only one foreman living here. Pr up Arthur St 4th st. resp, working class. 4th st. top floor 7th for 2 rooms, then 8th. then 10th, tailors, homeworkers, no poor, quiet character people to print. in map pk. Bucknall St on the E side is all washes, 8th west in st. Carver St out of N side of Bucknall St factories, morocco leather colouring works - 1 foreman living. W. along Lawrence St narrow, asphalted st, all small workshops, cabinet makers, upholsters & carpenters. ^{pk} in Hayes St out of the N side, small workshops, no one living there.

Sinto High St 3rd st, asphalt, shops, pk to pk in map pk. south down Edell St shops on W side, old pictures & print, above let out, pk rather than people of map. W along Shots Gardens 3rd st. small shops, Irish, rough poor, working class, fling bricks at the police but are not criminal. It is as map. in the news on the N side (ob in map) there is no one living. W to Neal St 3rd st. much like Shots Gardens. many Irish cockneys costers road sweepers & news vendors. On the SW side

Great St. Andrew St.

The Seven Dials.

Queen St.

Queen Street N. side db b²

109
side between Long Acre & Castle St. Neal St. is
purple on map. Comber's men live here. at the
N. end the houses are coming down. The rest
is db db rather than purple of map.
I down Great St. Andrew St. 3 or 4 sh. small
shops. a great many bird fanciers & frame makers
abovers let out, some poor, purple to pt. in
map pink. on the E side is Neals yard - all
stables

at the centre of St. Andrew St. meet the seven streets
i.e. St. & Little St. Andrew St., Great White Lion
& Little White Lion St., St. & Little Earl St.
& Queen St. giving the district the name
of "Seven Dials".

E along Queen St. - 4 houses coming down on N side,
& one very rough doo house (a^d per night), Comber's
Brewery occupies the whole of the South side
The Six storied Dwellings east of the doo house
let out in one & 2 roomed tenements, is very bad
'about as bad as it can be. rough set sitting on
door step - cobble paved - bread & mess in street.
db. barred black rather than purple of map.

Nottingham Court. Black

Long Acre.

Battle St - S side pk

Mercer Street purple
(W side & part of E)

South down Meal St & along Castle St. N side purple
South side where there are Buildings with roof
current garden salesmen as in habitants - pink.
'Both sides used to be the same but as soon as
the Bldgs were built the better class went
into them.' It is up Nottingham Court.

Black in map still black. '3 or 4 police had
their heads cut open here last January.'
3rd houses, all doors open, bird cages at windows,
mess, barrows, bread, potatoes, lemons, druggled
& hatless women, factory wall half way up E side,
rent 6/- for 2 small rooms, said one woman -
bird cages & flowers at windows. windows
dirt broken & patched.

I down Endell St into Long Acre. carriage bay
wood paved, market commission agents
living over - red as map. W past the end
of Meal St. the W side is all the Brewery
& the East are flats with market shops
under. Langley St. all Brewery (Carber's)
It is up Mercer St flats on the East side,
pink as map but north of them purple; the
west

112
Little St Andrew St.

Little S. Andrew Street - pk

Castle St.

General Remarks.

113
west side is 4 st, with market porters & carmen, 'less good than formerly'. purple rather than pk of map.
across Castle St up Little White Lion St. purple on W, pk on E where a good class of Comber's men live - I don't know Little St Andrew St. wood paved, 3 or 4 st houses, shops, same class as St Andrew St. Bird fanciers, Brass founders & Saddlers (proximity of Aldridge's Horse Repository). pk rather than purple of map.
E along Castle St. The famous Castle St. murder took place here. this end is purple to pk in map purple. at the S.W. end are the Queen's mansions. ^{new} pk.
I don't know Chapel Place all cleared. into Long Acre.

General Remarks.

The worst bits in this walk are Nottingham Place, Shot's Gardens. which remain as they were when the map was made. There is no movement in Neal Street probably owing to displacements in Parker St. all the rough Irish are born

Lax Vestry unswept streets

Absence of happiness.

Market porters

Irish cockneys.

born & bred in the neighborhood; said Tait.

The streets were messy; heaps of pea pods, old
lettuces & crushed fruit from the market lying
about. To say nothing of loose straw from stables &
packing from packing cases. Vestry very lax & slow
to move.

It was a very close, airless & smelly day.

Noticeable absence of happiness in these streets. Stern
hardened look of the women - ^{the} furtive look of
trapped beasts. Children pale, with an older
less healthy appearance than among the last bred
children.

Great untidiness in the houses of the poor streets windows
open & unmade beds & tables lying about on
chairs, dark small rooms. But outside were
flowers & flower boxes even in the roughest streets.
Round day here were market porters overstayed, sitting
about, some drunk, others old & shaky, all looking
as if they did drink. Irish cockneys, not in moral
but w^l steal if the chance offered. Bash in the heads of
the police now & then. Sometimes when their houses are
pulled down they have to move but they w^l of their
own free will.

District covered.



Great Queen St-

July 26th

Dist 2

CP 2

G.H.W

Walk with PC. E. Tait. round district bounded on the North by ~~Great Queen St~~ ^{Great Queen St}, on the East by Lincoln's Inn Fields & Serle street, on the South by Bookellers Row & Holywell St & on the West by Dury Court & Dury Lane being part of the parishes of Holy Trinity & Dury St. Clement Danes.

Starting at the west end of Great Queen Street there is a court on the N side called Queens Place - 4 cottages, windows broken, children clean, quiet poor, lb, not shown in map. 2 rooms at the back 5/- 7/- for two rooms on the top floors & 5/- & 5/6 for each room in the front' - said one woman - New Y^d on the South side - printing works, one fore-man only living there. Middle Y^d further E on the S side - Wesleyan Sunday School with one house belonging to the school on the East side. South down the W side of Lincoln's Inn

Sardinia St.

Sardinia St. lb. l. 2

Wild Ct. betterment.

Wild Court lb

Great Wild St. worsement.

Gr. Wild Street - db

In Fields, turning west ~~under~~ through tunnel under house into Sardinia St. 'like Neal St' said Tait. Some thieves, no prostitutes, plenty of Irish, no better than before though one public house less than there used to be. not quite so bad as Sardinia Place. 4th asphalt paved ~~bb. db.~~ rather than the purple of the map. N up Sardinia Place. only one block of houses on the W side north of little Wild St. one barefoot child, doors open, 3¹/₂ st. children pale, sore eyes but well fed. stable & Electric Station on the E side.

W along Wild Court. 3¹/₂ st. used to be rough - in map. no house still db at W end. N side. the ~~rest~~ have been cleared out & occupied for the last 3 months by a new class - on the N side is Holy Trinity mission. Commissionaires, porters & mechanics now live here. one clothing ho for men 5th a night. ch. lb to purple - into Great Wild St. cobble paved. 6th Peabody dwellings on W side - respectable class. Tait lives there himself. 3^h at the N end & all the E side is rough, low, 'like Sardinia St.' great mission St. db

Little Wild St.

Black.

Kemble St

worshment.

Kemble St - S side - db

Drury Lane

Drury Lane - E side db

db rather than the people of the map. Into Little Wild St. 2nd rath. exc. the Sardinia Bldgs 6th on S-E side. 'Worse than Nottingham Court' many flower girls, drunk, Irish, fighting set. the buildings do not look so bad outside but Jait says the smell inside 'is awful'. 80 or 90 different families living there. rents 10/6 for 3 r, 3/3/6 for a single room. Baskets of roses & mignardie on the pavement with girls sitting beside them & arranging them. The black shown in the map shd. come just before the corner which is taken by Munros' Covent Garden Warehouse.

Into Sardinia St. west along Kemble St. like Neal St. but not so bad as Nottingham Court. The South side is very poor, small shops, 4st houses, Kemble St. Chambers 4d a night, very rough. very dirty children on pavement & in groups round the doors, db. rather than the people of the map

Into Drury Lane of which the west side below Russell Street is down. The E side is 4st poor rough, db rather than people of map

Nags Head Court.

Courts off the East side
of Dray Lane

rough.

Stanhope St.

map. East into Nags Head Court called in map
Kings Head Ct. narrow, asphalt paved blocked
with empty market baskets, meat boxes & bread
lying about, doors open, windows broken dirty
4 houses only on N side, the South side is the
back of the Everleigh Bldg. in Stanhope St.
there is a gate through to Stanhope St. but it
is padlocked - rough poor, children with sore
eyes - db. as map. South of it is Hestford
Place - ^{called} in map Brown Bldg. 3 st. poor, rough
flowerseller, coter, news vendors, poters, dirty children.
db. as map. S of it is Crabby Place. houses on both
sides shut & condemned exc 3 at E end.
White Horse Yard. The North side is closed & some
too on the South. Looks very rough. at the East end
on the N side is a woman's dos. house. 4^d per night.
Close Court: 'like Kemble St.' - 3 st. chs ragged
but fairly fed, db. as map
S to Blackmoor St. 3 or 4 st. narrow. shops. 'not
occupying whole house' - pt as map.
E into Stanhope St. then N. 'Same as Kemble St.' asphalt
paved. 'has gone down of late years'. Between
White

Stanhope St

Stanhope Street - lbt?
db part now dbl?

Senzell St

Here St, N end, db

Clare market

Clare St db

White horse yard & Kemble St is worse than the rest, ^{'but not much better'}
Evensley Buildings in a court on the W side of
White horse yard. poor rough working class. 'In most
of these place there are many living who have
been convicted.' very narrow, broad, mess. The
inhabitants here a trifle better than White Horse yard
'but wd not be fast dropping a brick on my head if
they got the chance.' shd all be db.

2 then South - down Ver St 4 st. small shops,
cobble paved, Bd school on E side - by no means
quiet poor, but poor rough. db rather than lb
of map - W along Senzell St - poor, low, rough,
going down, asphalt paved, db as map - There is
no passage out of the South side into Clare
St as shown in map.

Clare St 4 st. street market. Haddock 2^d to
4^d each, Kippers 12^d & 2^d per pair, bread 2 lb
for 22^d & 3^d. Unlike other street markets very
few of the prices were marked - poor, rough,
db rather than purple of map.

Back to Ver St great changes on the East side
South of Sheffield St Clare market down - on the
East

Vere St.

at the N.E. end of Vere St.
is a large workhouse with
180 to 200 beds - 4d a night.

Bear Yard.

Sardinia St.

Sheffield St.

Sheffield St. - S side lb

east side is a new Red brick Parish House of
St. Clement Danes, & south of it ~~newspaper~~
Bldg. a printing office. Has a large piece of
lb disappears - N up Vere St. turning
East just north of the Board School into
Bear Yard. late Portsmouth place - on the
N side are two houses, 3rd rate, quiet - poor
lb. & east of them the Strand Union work
house - not colored in map. On the south
side is the Casual ward. S past the
east side of the Casual ward. The houses
on the east side are called Portsmouth Bldg
poor-lb. with two rough houses next to
them going south - lb. in map all is lb -
N to Sardinia St. - poor on S side, printers, much
drink, lb to purple, in map purple. South
through Lincoln Inn Fields & Portugal St.
turning W at Sheffield St 4th. asphalt.
not particularly rough - market porters -
lb rather than lb of map (S. side only).
on the south side opposite Bear Yard is Trinity
late Gilbert Ct. behind St. Clement Danes.
Lamb

Holles St.

Holles Street - db

Newcastle St.

Wych St. purple

waiters & shop assistants
living overhead →

Holywell St.

Parish Ho. with 2 rough houses still remaining
db. Portugal St. now has been continued
into Vere St.

W. to Holles St. some houses down, 4 st.
rough, low, cobble paved, mess, old boots, bread
fish, potatoes & meat in the street - db rather
than purple of the map.

South of it is Stoughton St. 3 st. does not
look very much better than foregoing but Jait
said that it was & was inhabited by a pop.
working class, wood paved, purple as map.
South down Newcastle St. is poor. pk as map
asphalt paved, shops.

E along Wych St. 3 st. shops, 3 st. purple rather
than pk barred of map. W along Holywell St.
→ second class booksellers & chemists of doubtful
reputation - very busy, passengers only - pk barred
as map. N up Drury Lane on the east side
are Craven Bldgs 3 1/2 st + all - china pots, clean
windows, doors shut, skilled mechanics, pale
children. pk as map. There is a passage into
New Castle St. at the E end. N of it is

Craven

Drury Court.

Craven Yard - pk

Drury Court - lb

General Remarks.

Craven yard - only 1 ho for a foreman on N side.
The rest stables - thus lb of map disappears.
S. down Newcastle St. W. then N up Drury Ct
small shops, poor, ^{map 1.12.} lb rather than pink of
map. factory wall on E side. Petty ford Court. out
of the East side is private & leads only to
Hooney's public house. Denham yard on
the West side, is very narrow & dirty -
bread, mess, 3s t. 3/6, 4/8, 5/ for single rooms -
lb as map.

General Remarks.

Note a fairly general worsement in the streets
that remain following on the demolition
of the courts on the West & East side
of Drury Lane.
Good temper & curiosity of the inhabitants
of the courts. 'Government Inspector, I
suppose, any one can see what the other is'.
'Don't pull down our houses guv'nor, before
building us up others to go into.'
'See he's taking our pictures, look yer best
Noiza.'

Loiza.

a hot, thundery day. Sleepy, weedy men in
the courts & streets & stout, busy Irish
women - a few drawn-faced children.
Many small public houses, full today of
women & children.
Messy streets - No opium dens.

Chief Inspector Dykesley.

Disorderly Honors.

September 15. 98.

CP(2)

G.H.D.

Interview with Inspector Dykesley of the E or Bow street sub-division at the police station.

Inspector Dykesley is Chief Inspector at Bow St. and acting Superintendent while Mr. Cole is away on his annual leave.

I went to arrange about a constable to go round with me & the following is a report of a conversation which Mr. D wished to be considered strictly confidential.

Dykesley is a fat bulky man with short greyish hair, whiskers & beard, has been in the service nearly 25 years, much of which was in the Soho division; he has 'shut up' more disorderly houses than any man in the service. In Soho he said that shutting up was nearly another form of 'moving on' but

Bullies.

Licensed houses.

137
useful & necessary in that it kept them within certain limits. If it were not for prosecution every other house in Soho w^d be a 'brothel'. After a pause he added 'very nearly every other house is now'. They are kept by Bullies or 'ponces' who for the most part are German, Austrians & Dutchmen, a few are French very few are English. There is a bill before Parlt^l now for condemning such men for expulsion from the country for the first offence & 5 years penal servitude for the second. He hopes & thinks it will pass. For his part he has no doubt but that licensed houses are the only solution of the question. Think that any shock to the national conscience w^d be fully worth it. Wagers under the present system stand much less chance than under a licensed house system - has seen it happen over & over again. Man has a drink walks down the street & is accosted ~~over~~ many times on his way home. Finally he takes a woman home. This man

Children & beer.

He has never seen a child drunk
under 16 or 17 years of age & very
few at that age.

Drink

Police & publican.

there are scores like him w^d never have gone to a
licensed house.

As to children fetching beer, he thinks it a
bad thing because of the language the child
hears & the things he sees. 'A publican may have
told you that the presence of a child helps him
to keep his house quiet but don't you believe
it.'

Women's drinking begins when they first go shopping
does not think it is on the increase, men's
drunkenness he is sure is on the decrease - owing
chiefly to education & the efforts of the Temperance
party. Mr T is not a teetotaler himself.

As to police receiving payments from Publicans.
I know nothing of it. Of course there may be
a case here & there among 16,000 men but
it is very rare. 'Publicans are now too much
afraid of the police'. Naturally every man
denies it when by admitting it he w^d be
accusing himself & the penalties are heavy.
Inspector T was very reticent under these questions.
He thinks there is great harm in the police receiving
anything & does not believe that they do.

District covered.

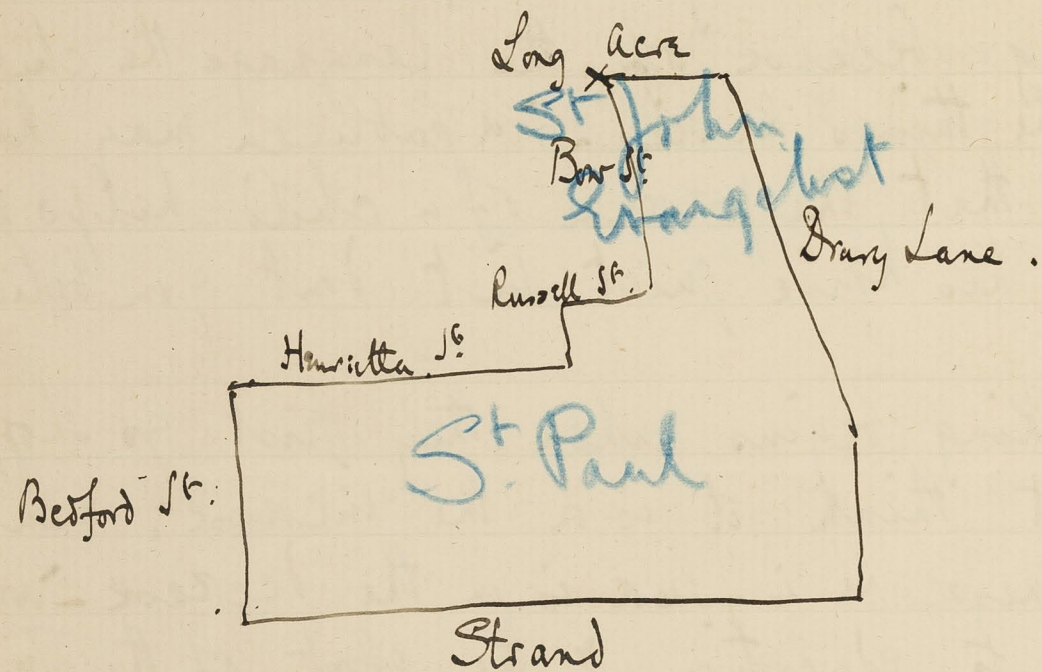

The West side of Drury Lane.

Broad Court pk b²

Cross Court - purple

Tuesday, Sep 20, 1898.

Dist 2 CP 2 G.H.D.

Walk with Police Constable G. Moir round District bounded on the North by Long Acre, on the East by Drury Lane, on the South by the Strand & on the West by Bedford St, Henrietta St, Russell St, & Bow St, being part of the parishes of St John the Evangelist & St Paul.

Starting at the corner of Bow St & Long Acre, East along Long Acre, the South side is all factories (in map purple) South down Drury Lane.. great clearances on West side, all down from ~~Bow St~~ ^{Russell St} ~~east~~ to White Hall St, & from Drury Lane to Catharine St, including Vinegar Yard & Russell's Court, the in map 'but used to be very rough'. on the W side is Broad Court. new, 4st, flats, red brick, fairly respectable, some serots kept pk barrel - in map pink. South down Cross CP 4st. working class people - not colored

Russell St - pk

Martlett Court - pk

White Hart St White Hart Street & of Angel Court - db

Angel Court lb & db

143
in map. east along Dukes Court. much down & the
rest to come down shortly. two houses on north &
4 on south still inhabited - poor & quiet. windows
dirty. purple both in map purple.
I down Dry Lane & west at Russell St 4 st.
better west than east. mix of shops
& flats. pk based rather than red. Dry
Lane Theatre takes up all south side. It up
Crown Ct to Martlett Ct 3 st. respectable quiet
clean - no poor - rents 8/0/0 for 2 rooms - both
pink. map gives Martlett Ct purple.
South down Dry Lane past the clearances
which are shut in by a boarding. west at
White Hart St. 4 st narrow. asphalt paved.
'overcrowding here on Saturday nights' - two
very poor rough houses on the south side
just east of New Church Ct; this bit is db
rather than lb of map. The rest lb. as map.
The db. bit w of Angel Court has gone.
South down Angel Court. - cotes, 5 st. 'Strand'
Buildings on E side. lb rather than purple of map,
rougher lower down & db. (in map purple). cotes
flower

Courts between White Hart St
the Strand

Courts North side of Strand

145
flower girls, a few the ones 'but not near so bad as
Wilde House' (in little W.C. St), doors open, bread,
Hatters, pale, sore eyes, ill looked & dressed but
clean children. The turning at SW end (ob in map)
has been blocked by extension of restaurant
from the Strand.

N to White Hart St then E & South down New Church
Ct. 30 ft, houses on E side only; The S.E. end is
the back of a restaurant & the SW side down
for a fire; Irish cotes ob. as map but less fit.

N to Hart St & E to Dry Lane then S. on the
west side is Feathers Ct. 4 st. flagged cart,
dark, airless, 'the worst in the subdivision' - thick
cotes, 4/ or 5/- for one room - paper & mess,
6 cats - ob. as map.

South to the Strand on the west, on the north side
is Windsor Ct. 4 st, one woman said the
rents of the court were "5/9 to 8/6" for two
small rooms; only one inhabited house on W
side at NW end, cotes & flower seller, ob.
as map.

W. part the south end of Angel Ct. & north
int

Helmet Court - lb

Catherine St.

Catherine Street - pk

Exeter St.

Courts N side of Strand

Helmet Court. map mounters, gold & silver paper makers.
better than formerly when it opened at SE end
into Angel Ct now lb rather than lb of map.
N up Catherine St. 3 or 4 stories. shops ^{theatre} shops
with owners above - publishing houses -
pink rather than purple of map.
N past York St wood panel, south side are
publishers & north side market shops -
pkbt. board - South down Burleigh St.
W along Exeter St. as map. Ditto, printing
offices at west end; ^{east}
W along Strand N up Southampton St.
very few living here.
W along Strand. on the north side is Sanby
Court. lb in map. no one living here now. exc
Romano the proprietor of the restaurant at
the SE end. nor is there anyone in
Bull Inn Ct. - both marked lb on map.
N up Heathcock Ct & Exchange Ct. lodging
house of the Corps of Commissioners -
great numbers of them waiting about - smart
well dressed, benedalled - on the chance of

7
Maiden Lane

General Remarks.

Displacement of Population

a job. N up Bedford St. Bodega rest & civil service stores on W side; shops & eating houses on the east, in map red.
East along Maiden Lane. Sporting & Dramatic Club at S.W. end. has often been raided - frequented by pugilists & fighting men - several theatrical rehearsing schools in the street. Sussex Mansions on N side, flats, 4th & 2nd fls. red as map. N to Henrietta St. publisher - red on map east to Russell St. red as map - market overflow.

General Remarks. Note a general betterment owing to demolition & rebuilding. Those who have been displaced said miss first tried to get rooms in the immediate neighborhood, but failed; they then went to Battersea, some went north.
The great clearances on the west side of Drury Lane will be made in to a potato market. Covent Garden does more business every year & floods the neighbouring streets with

Public Houses in the Strand District

Notes on licensed houses.

151
fruit boxes & vegetable ends, & commission dealers shops.
The industries of the neighbourhood are market
work, theatrical business & publishing.

Public Houses 'do a very good business', there is very little changing hands here. Brewers put their own men in as managers & keep them there, the public house brokers about here however in consequence had little business. Miss does not think that the number of licensed houses affects the amount of drunkenness. He wd. have the number of houses up to but not above the demands of a neighbourhood. as each lease ^{of public} falls in the Duke of Bedford shuts it up & insists on its being reopened as a different business.

Note. The restaurant west of the Adelphi Theatre is an oyster shop with a beer license. It is marked as a restaurant because it has no bar & customers do not go there primarily to drink.

Cockburns 'Temperance' Hotel' in Henrietta St.

is marked also as a restaurant in the map because
there is no bar & strangers can not go in
to lunch or dine. It has a full public house license
 The 'Market Stone' a public house in Russell
 St. is open at 3 am on market days -
 Every day is a market day now but by agreement
 it is allowed to open at 3 on Tuesdays Thursdays
 & Saturdays when the other houses open at 5.

District covered.

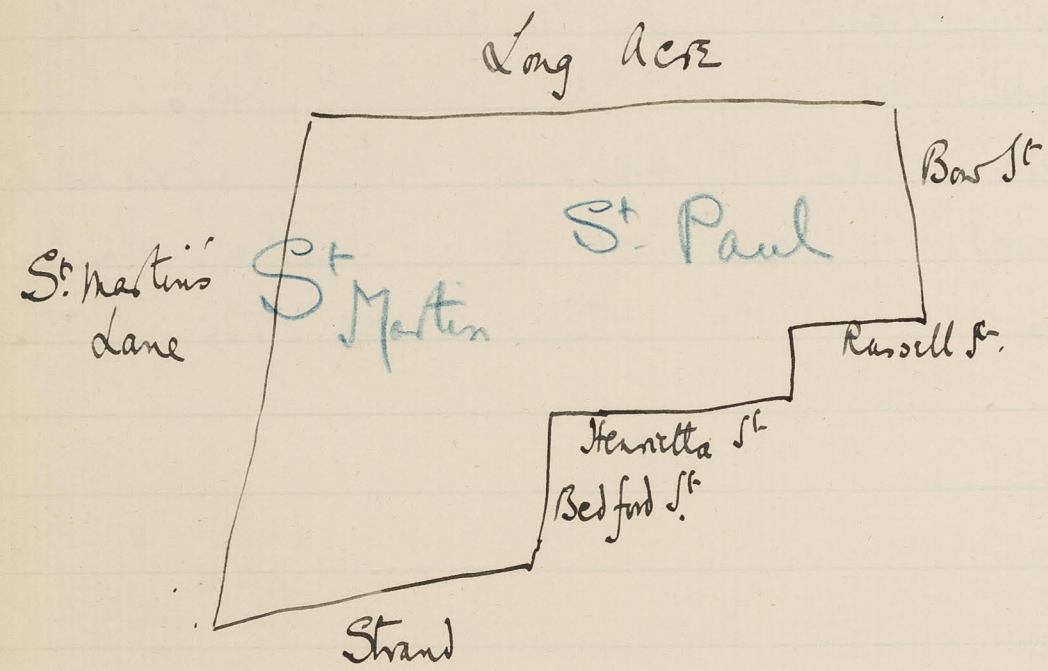

James St.

Sep 22. 98.

Dist 2 OP (2) G.H.D.

Walk with Police constable G. Moir round district bounded on the North by Long Acre, on the East by Bow St., Russell St., Henrietta St. & Bedford St., on the South by the Strand & on the West by St. Martin's Lane; being part of the parishes of St. Paul & St. Martin.

Starting at the corner of Bow St. & Russell St. rd as map. W to James St. blocked with carts & market baskets, market agents & dealers, on either side, well to do tho' not quite so good as Bow & Russell Streets. 4 stories rd as map. The public house on the corner of Floral & James St (N side) is a '3 o'clock house' ie open 3am on market days. W. along N side of Covent Garden, an intricate block of carts & baskets. Lock hats coffee house under the colonnade here has a special license to open at 2 AM. Went along King

Court N side of Strand

Harveys Buildings purple

Courts west side of Bedfordbury

Court
Turner's Buildings - black

King street - 4 ^{rather} storied houses - rather better than James St. red as map. W into Garrick St. shops, chambers, clubs, auction rooms, publishing houses. red as map, S down Bedford St. the same - into the Strand then west. On the north side is a court called Harveys Buildings. Ho north side only; only two, one a factory or offices the other (westerly one) a common lodging lodging house. 5th a night. fairly respectable: in map pink: now purple

Map Agar St. west side is Cheung x loop: will do shops on the east. red as map -

W along King Wm St. 4 storied - shops - red as map

Map Adelaide St. 4 st. shops - red as map -

E along Chandos St. & north up Bedfordbury.

going north on the west side are

Jaylor's Block. It is in map. some living there: factories on either side - is now mercery passage between Bedfordbury & St. Martins Lane - north of it is Anna Jane Yard. carmen contractors, also father Tom living here; not colored in map:

North of it is Turner's ^{Court} Block. The worst spot in the Sub

Turners Court.

rough.

Courts w of Bedfordbury.

subdivision, worse than Feather's Court because there is more of it, said Miss. Has had many fights here with the inhabitants; a policeman's throat cut 3 months ago. a bad class of 'rough' living here - lower class market porters & costers; Irish Cockney. cement paved; Draggled women sitting on doorsteps singing, bread & mess in court, 4 or 5 persons to a room, doors open, children with holes boots & clothes but well fed & clean faces, pale; smelly airless place; is favorite escape for watch snatchers from St. Martin's Lane. Old red tiled houses. Thieves but not prostitutes living here. Sh. barred - in maps purple - [not coloured in large map: I think there must have been some confusion between them & Taylor's Bldgs].

North of it is ~~great~~ May's Buildings. formerly great May's Bldgs. North side is factories ex same as at N^W end. Built 1739. South side 304 st. respectable purple as map.

North of it just south of the Church, Chemistry Alley is all down, used to be a den of prostitution.

North of it is St. Giles's ^{in map purple} factories both sides one tailor shop at N^W end. formerly a brothel here.

Bedfordbury - W. side lb.

Courts east of St. Martin's Lane

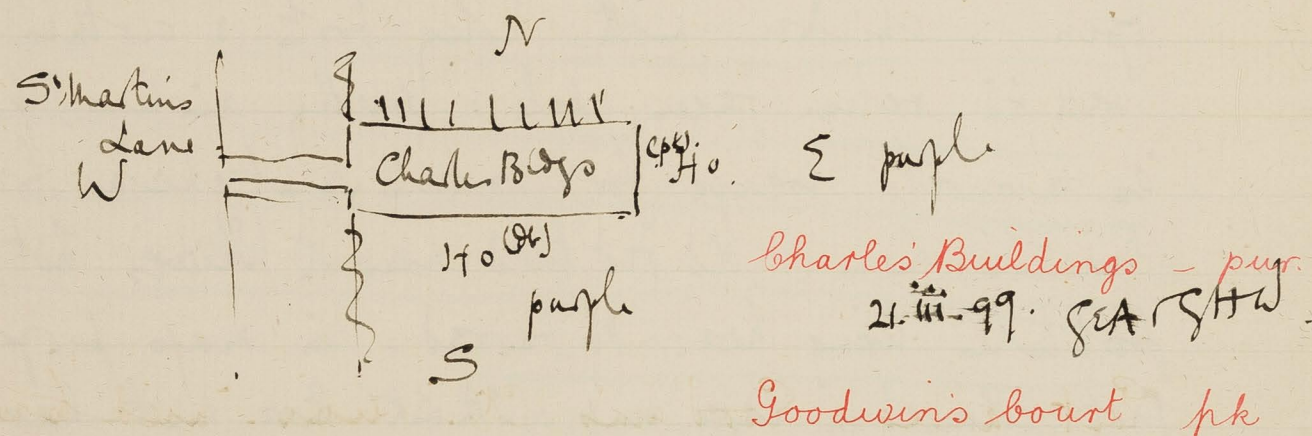

Goodwin's court pk

New Street - pk b¹

South down Bedfordbury. shops & public houses on the west side & Peabody Bldgs on the east. the west side is mixed - some poor living on top floors but not rough: & purple rather than bk of map. Peabody Bldgs are purple top bk. in map pink. Walking Chandos St. N up St. Martin's Lane. a centre for dentists & artificial tooth makers: the west side has been rebuilt: & at the Cranbourne St. end are large blocks of Chambers. at the S. end is Charles Bldgs. - through two iron gates. 4 houses only. 35th. purple - top. working class - purple - not marked in map -

East along Goodwin's Ct. shops - used to be a very busy street but has lost it of late years. houses on S side only; old fashioned: small paned bowed fronts - flower. purple top bk in map purple. up St. Martin's Lane then E along New St. shops, used to be a very busy St. but has lost it of late years. hardly so good as St. Martin's Lane though many keep a servant. pk based to red, in map red. There is a restaurant with a beer in license on the S side, marked as a restaurant

(New St): continuation N. of New St - pk

Courts of the South side
of Long Acre.

(Part of) Rose Street pk

Conduit Court lb l^o

Langley Court lb.

- absent in the map because men go there to eat & not to drink. Past the top of Bedfordbury. Map Garrick St. W to St. Martin Lane. on the E side N of New St. is a court with 4, 5 storied houses chambers, nameless, pk. not shown in map - E along Long Acre. South down Rose St. to Floral St. all factories. In Rose St. are two houses on the W side - pk. are used to be a brothel in map out.

E along Floral St. & N up Conduit Court. factories west side; four houses on East side - poor. ~~lb~~ ^{lb} ~~as~~ ^{is} ~~is~~ ^{is} probably a brothel. ~~houses~~ ~~are~~ ~~not~~ ~~coloured~~ ~~in~~ ~~map.~~ ~~see~~ ~~the~~ ~~map~~ ~~is~~ ~~not~~ ~~coloured~~ ~~in~~ ~~map.~~

E past Banbury Ct factories both sides. to Langley Ct. in map lb on both sides - now 300 houses on west side only. poor, not rough, lb rather than lb.

E to Stannover Court. a thieves lodging house on the East side - 5d per night - rough thieves market overflow - basket factory on E. both sides lb barred as map -

General Remarks

The Strand

Prostitution

Police Constable George Moir.

58. E

The only bed bit in this walk are the courts on the west side of Bedfordbury.

As to the Strand Moir said he thought it less of a shopping street than it used to be. More hotels are being built on the south side of it bet the Strand & Embankment but their occupiers shop in Regent & Oxford St & Piccadilly.

Many fewer prostitutes in the Strand. You will not see one at 1 am. They have gone to Piccadilly mainly Moir thinks because Sir John Bridge at Bow St gives them such heavy sentences & the other magistrate is more lenient.

Confidence tricks much practised at the west end of the Strand 'invariably on Americans'.

Moir is about 30 years of age: is a native of Aberdeen: was one year in the Roxburgh County police before he came to London. Lives in the Beehive house at Bow St & pays 1/- a week for his room: is not called up after hours except for fires: Tall, burly man, florid face, light moustache.

District covered.

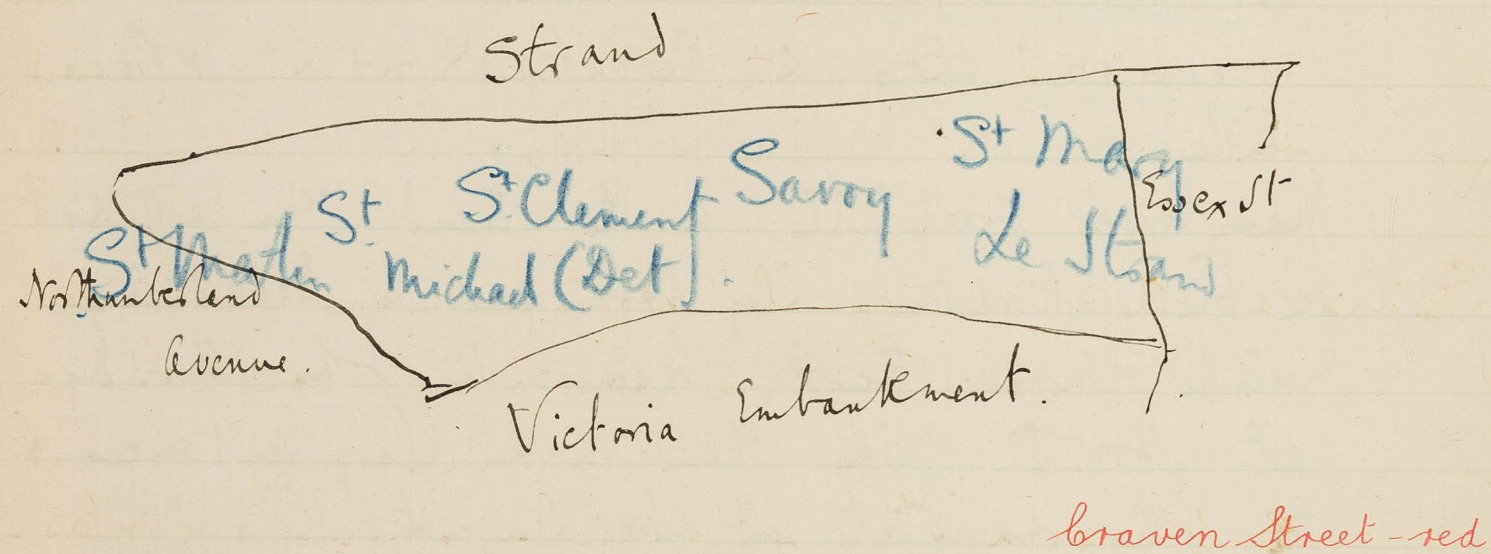

Villiers St.

Sep. 23. 98.

Dist. 2

CP (2)

S.H.S.

Walk with Police Constable G. Moir round district bounded on the North by the Strand; on the East by Essex St., on the South by the Thames Embankment & on the West by Northumberland Avenue: being part of the parishes of St. Martin, St. Michael, St. Clement (detached) The Savoy, & St. Mary le Strand.

Starting at the corner of the Northumberland Avenue & the Strand; west to Northumberland St.: a great part of the E side is down. ~~to~~ to Caven St. 4 i' cloied. Hotels & doctors - one or two hotels of doubtful reputation - one having been ^{tried} convicted as a brothel, but better than it used to be. rd. not coloured in map (these hotels have full licenses, but they are not marked upon the public house map because they are only used by residents & have no bars). E part Brewer Lane. aty back. to Villiers St. - shops - rest. hotels - great street for passengers from Charing x met ^{King}

York Place - red

Streets off the South side of Strand.

Savoy Bldg.

Lancaster Place - pk

railway. haunt of prostitutes. much street thriving of an evening. escape east along York Place. It is map - low all down - very bad smell here. to Wickham bank private hotels & offices, respectable. 4 1/2 st - pk based. as map.

N to the strand, west to Durham St. the south to William St. all offices. Cook's Bank arch across William St. a crowd of 47 redy men waiting for chance employment with sandwich boards. South under the Adelphi Arches. wine cellars of the big London merchants. back, lit by gas. none allowed down at night. open out under Adelphi Terrace - back again west to York Bldg. 3 1/2 st - office. large number of German waiters from the neigh bying hotels live down here. pk based a map.

N to the Strand, then E. south down Beaufort Bldg & East. the houses marked on map are now closed & condemned. this passage is called Albert's Passage. into Savoy Buildings 3 1/2 st. quiet & cheap. apartments & waiters from the Savoy hotel pk as map.

E to Wellington St. & south to Lancaster Place

Courts opposite the Law Courts.

Thanet Place - pk b^o

Essex St. pk.

Block of Hotel streets

offices - with car takers - pk. not ^{coloured} marked in map -
East along the Strand. On the South side, west of Strand
Lane is Angel Court. - one dwelling ho on east side - pk -
the rest is Vickers newsagents shops & warehouses -
East then South down Thanet Place. 3 1/2 st. - servants
kept - boarding houses - very quiet - pk based rather than
pk of map -
W. along Strand turning South down Devereux Ct. 4 1/2 st. - flagged
Chambers & apt. pk as map. into Essex St. offices &
institutions, car takers living above, pk, not coloured in
map. W. into Milford Lane. printing office of
the 'Graphic' & 'Illustrated London News'. stables on the
East side. W. into Water St. W.H. Smith's stable
on E side. the west side is the back of Arundel
Street.

W into a block of streets Arundel, Stward, Norfolk & Surrey
streets. which are all hotels & offices. for the
most part, new high buildings, used to be small
private hotels. but the greater demand for hotel
room in the last 5 years has rebuilt them all -
in map they are red. question now is whether they
shd be left red, or marked yellow, or not coloured
at

Adelphi Terrace.

John St. red

a free Vintner.

at all. West along strand turning South at Aden St. offices, theatrical & medical agents, hotels, west along Adelphi Terrace. Clubs & offices, wine merchants, Royal Statistical Society, Charles Booth at No. 9. at the west end is the Caledonian Hotel. 'a great place for football teams visiting London has a bar & is therefore marked red as a public house in the map. Down Robert St. to John St. red rather than pinked, w along Duke St. pinked as map. 'used to be a hotel here but now cleared into York Place. rough, casuals on South side - as map. The north side with the exception of ~~the~~ ^{one that} ~~the~~ two houses consists of the back of the strand into Villiers St. hotels & shops. on the East side is a free Vintner. ie he has the right to sell wine in glasses on the premises & spirits off. there are a few of these licenses existing except in the city: one we have already had at the corner of Southampton Bldg. out of Holborn. They are not marked on the map.

General Remarks. Note disappearance of small dark blue plots from York Place & Alberts passage.

Children & beer.

Prices of public houses.

Preponderance of Scotch in the Police.

a rise of new hotels.

As to the fetching beer, Moir objects to it because of the sights they may see & the language they hear. This objection he said applies only when the children of the better class are sent - 'as they are' - rough children w^d hear & see every bit as bad in their own courts & homes. He has never seen a child drunk though he has seen them being given drink. He is sure that not even the most drunken parent w^d ever allow or encourage a child of theirs to get drunk. Fear of drunkenness w^d not in his opinion be the ^{proper} reason for preventing ^{children} ~~sober~~ fetching beer, because that is not the danger.

As to prices, £36,000 was given for the Chandos public house in Chandos St. 3 years ago.

He also spoke of the extension of the manager system & the evidence of its increase afforded by the decreased business done by the public house brokers in the Strand district.

Moir is a native of Aberdeen. Says that more than $\frac{2}{3}$ of the police are Scotch - out of 95 (?) at the Bow St. section houses 35 are Scotch & only one or two Londoners. They won't have Londoners.

District covered.

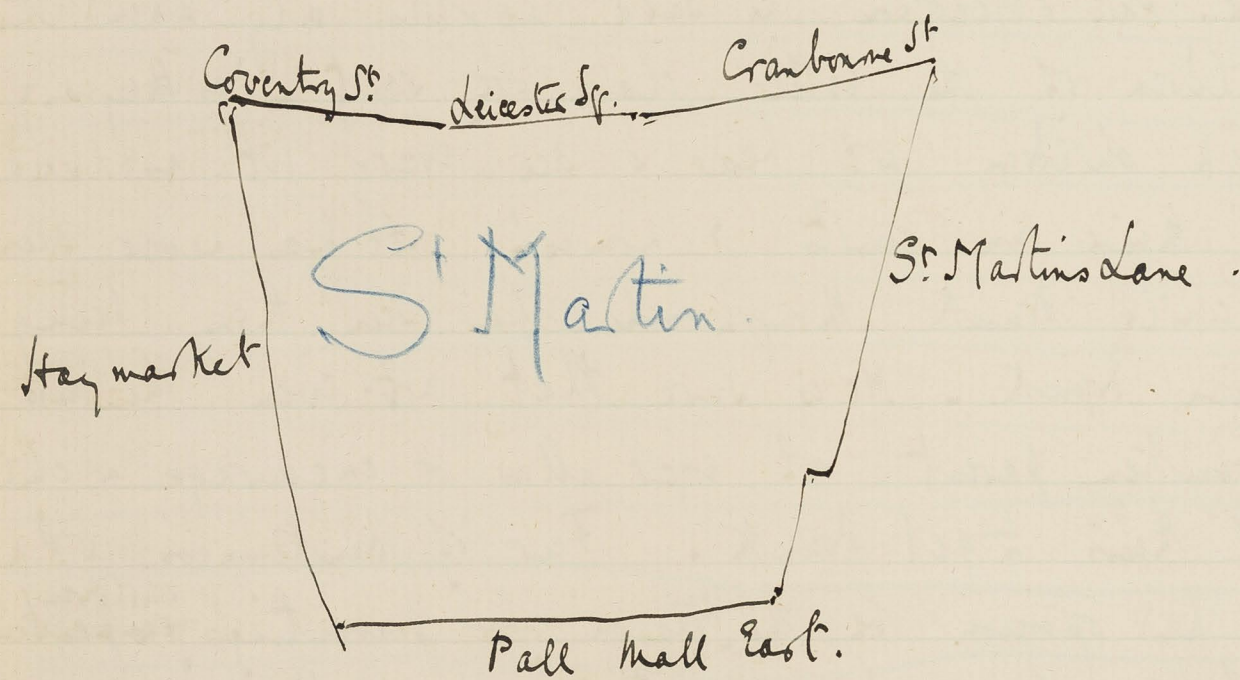

Streets out of west side of Haymarket

September 29. 1898.

Dist 2 CP 2 G.H.W.

Walk with police constable Albert Gunn of the C police Division (Vine St. subdivision) round district bounded on the north by New Coventry St & Cranbourne St, on the east by St. Martin's Lane, on the south by Pall Mall East & on the west by the Haymarket, being part of the parishes of St. Martin

Starting at the corner of ^{Haymarket St} ~~St. James St~~ & ~~Coventry St~~ South down ^{St. James St} ~~St. James St~~ - shops & theatres, many old estab shops. 4 stories - wood paved. cab rank down the middle - red as map. on the W side is Roundel Place which runs due E, then N into Coventry St. cement paved. is only a footway, shops with chambers over as yet untenant; on the east side where the passage runs north is a low class club - betting - tape machine etc. all the windows facing the front are of ground glass - pink as map. South to Panton St. 4 st. shops rest,

Panton St Oxendon St.

doubtful reputation.

? mark these chambers pinkish.

Suffolk Street - red

Whitcomb St.

Whitcomb St red

theatre, laundries: 'a street of doubtful characters': prostitutes living here: men brought to their rooms & also to the restaurant-hotel rooms. - but more respectable than it used to be: map marks west end pink red & the east pink. East to Oxendon St. at the E corner of Oxendon & James St. is the American hotel. of more than doubtful repate. north of it are rooms rented by tailors working for west end firms. north of Panton St. on the E side are chambers. pink as map. south to James St. chambers at the East end on N side, otherwise all shops & warehouses. pk to pk barred. South down St. James St. on the East side is Suffolk Place. well todo. like Suffolk St. hotel, residential chambers (houses let out to a better class than the ones themselves / clubs. yellow as map. S to Pall Mall East & north up Whitcomb St. Stables belonging to large west end shops on the west side as far up as St. Martin's St. otherwise a mixed st, small shops, public houses, houses of doubtful reputation, club waiters, post etc, at the

Courts off Whitcomb St.

Princes' Court - purple

Club waiters, barbers & prostitutes

at the E corner of James St & Whitcomb St is the back of Macmillans very large new premises which face on St Martin St. The street as a whole is pink as map. though on the West side, North of Fenton St are Eric Chambers, good, residential road rather than pink.

at the S.E. end is Motcomb Court. now Hampton's furnishing house has extended to take in the south side & the two staired houses on the N side are used as small workshops. This court need to have a very bad reputation! on the ^{West} ~~East~~ side of Whitcomb St is Princes Court.

both sides belong to the same man who lets out the rooms to prostitutes & waiters - the north side looks very shady. old curtain drawn over each window. Is a regular meeting place for club waiters, barbers, & prostitutes for the exchange of information! is so in map but shd now be pink or purple. with perhaps a line of ^{black} ~~pink~~.

N to Spur St. 4 st. shops & Chambers. respectable. pink. as map. S to Blue Cross St. shops. less good. Some

St. Martin's Street.

S. Martin's Street (NW) - pk

Orange St.

disappearance of blue.

Some prostitute offices. purple as map. South down
St. Martin's St. at the NW end are ^{tenement} chambers.
pk. (not colored in map) - working class.
the east side making the south side of
Lancaster square is down for the extension of
the Dental Hospital, causing the disappearance
of a bit of blue. South of Blue Cross St
on the E side, also all coming down except
the barracks. Below Blue Cross St on the
west side is Macmillan's new house. "
just below it a "Circolo culinario Italiano"
where waiters nap before going to bed - a
'low class place': part of the E side of the
turning into Whitcomb St. is down, on the N side
are chambers. purple ^{as map} mixed class - less good
than the tenements at SW end of St. Martin's
St.

East along Orange St. the blue is gone from here.
Public baths on N side. to Charing X road.
then W along Green St. new chambers on
N side - shops - under - pink as map - many
intended - South down Longs Court.

Courts east of Charing X Road.

S. Martin's Court - pk

Cecil Court - red

two houses on the west side still remaining, look poor, Gunn thinks they are now untenanted. They were once occupied by a low class of French prostitutes. He had to enquire into a case from here. Soon all to come down so pk need not be marked.

east to the Charing X road. the purple of map either side of the Alhambra is down.

west along Bear St to Coventry St. - part of south side is down. the west shops & pubs. north side shops with some foot living over. south side is pink rather than purple of map, & the N side pk rather than red. Windows of house at extreme west end.

East along Bear St to Charing X road on the east side of which is St Martin's Court. all the south side down for Wyndham New Theatre. what remains is pk rather than purple. then S. into that part of it which runs between Charing X Rd & St Martin's Lane.

on the south side are buildings - residential chambers inhabited by all sorts - respectable & other wise - shops below. the same with Cecil Court all red rather than the purple of map

Albert Gunn.

migration to Battersea

Bathis.

General Remarks. Albert Gunn is tall, ~~dark~~ ^{light} nose. Cache, slightly pockmarked face, pleasant, & not so fearful of talking when not asked ^{directly} ~~by~~, as some of those I have been round with. Has been 15 years in the police force & all that time in this division. Is a Scotchman.

As to migration of population - the working class who have been displaced by demolitions have gone to Battersea - whenever he has occasion to go there he sees some whom he has known in the division. The Subdivision he said is peculiar because of the large numbers who come to it in the evening - pleasure seekers & prostitutes. Bathis he thinks the worst feature of prostitution but fear of imprisonment under the new law which comes into force this month has already made a number leave the country. 'They will pay fines but will not go to prison.'

District covered.

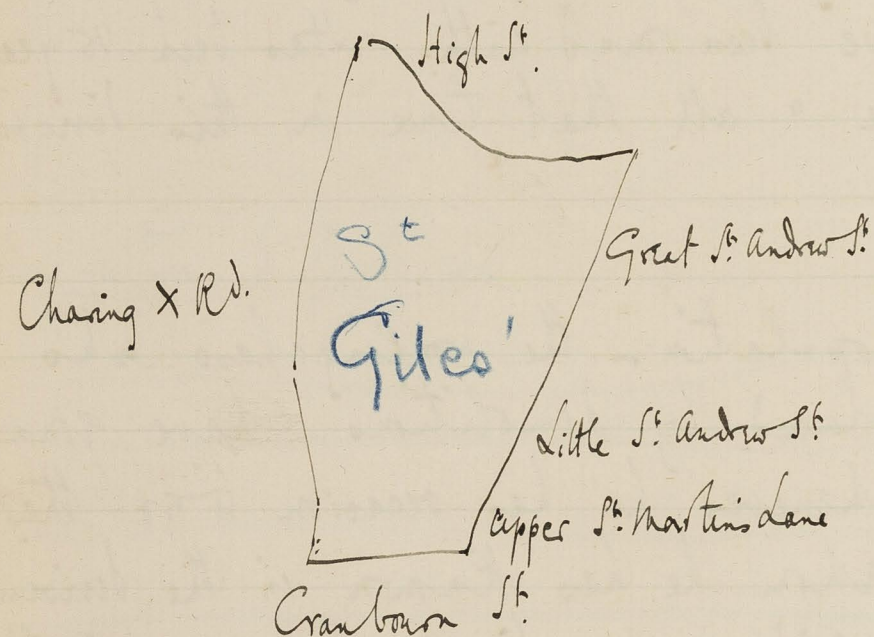

West street

Sep 30th 1898.

Dist 2 (182) S. H. D.

Walk with R. A. Gunn round District bounded on the North by High Street, on the east by Great & Little St. Andrew St. and Upper St. Martin's Lane, on the South by Cranbourn St. and on the West by the Charing Cross Rd. being part of the parish of St. Giles

Starting at the corner of Cranbourn St. & Leicester Square. east along Cranbourn St. 45 ft. shops - owners & lodgers living over. red as map. Up Upper St. Martin's Lane. Aldridges horse repository on W side. harness makers etc on the East (in the E Division]

West along West St. the police section house which fronts in the Charing X road runs back into the NW end. a street with a bad reputation. 'a fair smattering of "sutch" men (i.e. larceny from the person) burglars as well as bullies & prostitutes. There is an influx of foot into this street of an evening. in map purple. ad

Lumber Court.

Lumber Court ll l^o

prostitutes & criminals.

Lower St.

Lower Street - ll l^o

St. Andrew St.

Little S. Andrew's St^e - pk

add a line of black. E along Lumber Court. a common lodging house of the N side 4^o a night. also small shops - general dealers. everything from rusty nails to oil pictures for sale. 'are most of them receivers' a few Irish, poor, rough, noisy most nights. rest of Lower St^e are the same class of dealer & a few 'thief-prostitutes' who go with men more for the sake of thieving than prostitution. Sunday morning & at dinner time on week days are the busiest times for the street. add a line of black to the purple of the map. or make it oblind.

into Lower St^e less bad than formerly. NW end now a factory & the S.E. end belong to the pneumatic carriage Co. Less bad than formerly because fewer inhabitants, those that remain are of the same class ie prostitutes, lullies, thieves. 'Lower St^e & Lumber Ct^e have a greater proportion of criminals than West Street.' perhaps lb lined rather than oblind of map.

Map Little S. Andrew St^e a mixed class. shops - 'are not criminals but are the class that fraternise with them'. look fairly well to do. pk rather than purple of

Little East St.

Street market -
prices.

St. Andrew St.

of map - west along Little East St. a street market.
 Busiest a Sunday mornings until 11 & on Saturday
 nights. Many of the smaller restaurant keepers
 buy here. Several jewellers who have meted English
 men. Some prices - Bread 8^d for a 4 lb. loaf. (round
 the corner in St. White Lion St. the 4 lb loaf. well baked.
 Dark brown crust - was selling at 5^d. Some said that
 both had their customers, distinct classes, the one willing
 to pay 5^d & the other 6^d). Good ramp steaks 10^d top.
 scraps of meat for 3^d lb. Good apples 1^d lb.
 Good plums 2^d lb. fine English tomatoes 3^d - dark red -
 good potatoes, 4 lb. for 2^d. Jamsons 1^d lb. Hot bullocks
 cheek 4^d lb & the same for fish or liver. Fair
 mackerel 4^d & 2^d each according to size.
 Very few of the barrows belong to the shops -
 Carters come from Goldsmith, New Compton, &
 Stacey streets. pk as map.
 Map St. White Lion St. west. pk as map. many
 prostitutes living in the street but not many
 men brought home. Map St. Andrew St. a
 fair mixed class. picture dealers. Curio - bird fanciers.
 pk barrow to pk. Sats Shaftsbury Avenue
 then

Stacey St.

Stacey Street (NE) lb

New Compton St.

New Compton St. - pk

then south - on the south side are now Chambers & Institution
on the north side. 4st. shops letting out rooms above.
several prostitutes living above. much improved
since the clearances made in 85 & 86: those on
the north side are chiefly foreigners tho' they
have English names to their shops.

Up Stacey St. a rough block of Buildings at the
NE end. The class that w'd drop a brick on your
head: some criminals. Crooze & Blackwells girls -
child with sack skirt & children with pale faces
sholey boots - bread in street. NE end is lb
the rest working class tailors, harness makers etc
working for west end shops. pk to purple in character
exc NE end. no overcrowding that he knows of.
landlords are stricter now than they used to be.

E along New Compton St. regular workers, home tailoring,
saddlers, watchmakers, jewellers, generally in com-
-munion with west end firms. street asphalt paved
rather messy. 4st ho. many newly fronted. pk
rather than purple of map. on the N side is
Church passage public ho on W corner being
rebuilt. house above it down & above that a workho.

Denmark St.

High St. pk 4th

Charing Road.
Shaffersbury Lane.

{ Charing Cross Road - red
W side N end pk

so the ph of map disappears. on either side of the ^{Church pass} south side
New Compton St. are both do.
W along High St. + South Jan Little Denmark St
& its continuation called Slojd Court. all factories -
Cross & Blackwells & a tinplate works.
West along Denmark St. 3rd. Some bad houses with
broken & dirty windows. prostitutes - but the rest
skilled workers. gunmakers. sword. saddles. billiard
cues. pink as map. back to the High St.
Dover mansions on the S side. pbanned but rather
than ph of map. South Jan Denmark place.
houses on N side only. soap working class. Cross &
Blackwells corner. the south side is all factories -
purple to pk. in map purple ^{cherry x red}
along High St. turning south at Shaffersbury Avenue.
the E side - uncoloured in map. is flats with shops
under - red. Phoenix St. at of the E side -
mixed. the west end is occupied by foreign bullies
& their associates. one known bully was entering
one house. a small young man. good looking. grey
felt hat with black band, black moustache, blue
serge suit. as a whole the St is purple as map.

Lichfield St.

Lichfield Street - S side pk

Rents.

Prostitutes.

Rebuilding of Pubs.

South to New Compton St. - 4 st. working class - purple to pk in map purple.
South of it is Lichfield St. lodging to on N side - purple in map on N side - pink on South - here begin the improved industrial dwellings which reach right away down to St. Newport St.
on the east side of Chancery X road is the police section house & then buildings. pink as map.

General Remarks.

As to rents - nothing to be had under 8/- per week for 2r. and you won't get much for 8/-: 10/- or 12/- is the more usual price in a working class street like New Compton St.

A very large number of prostitute - English - French - German & Belgian. They run up the rents. For * foreign prostitutes the bally is of distinct use. He goes as their husband when they look for lodgings & will agree to 2/00/- a week more than any English man or woman would be asked. That is how they get their lodgings.

Note much rebuilding of public houses in the Subdiv.

District covered.

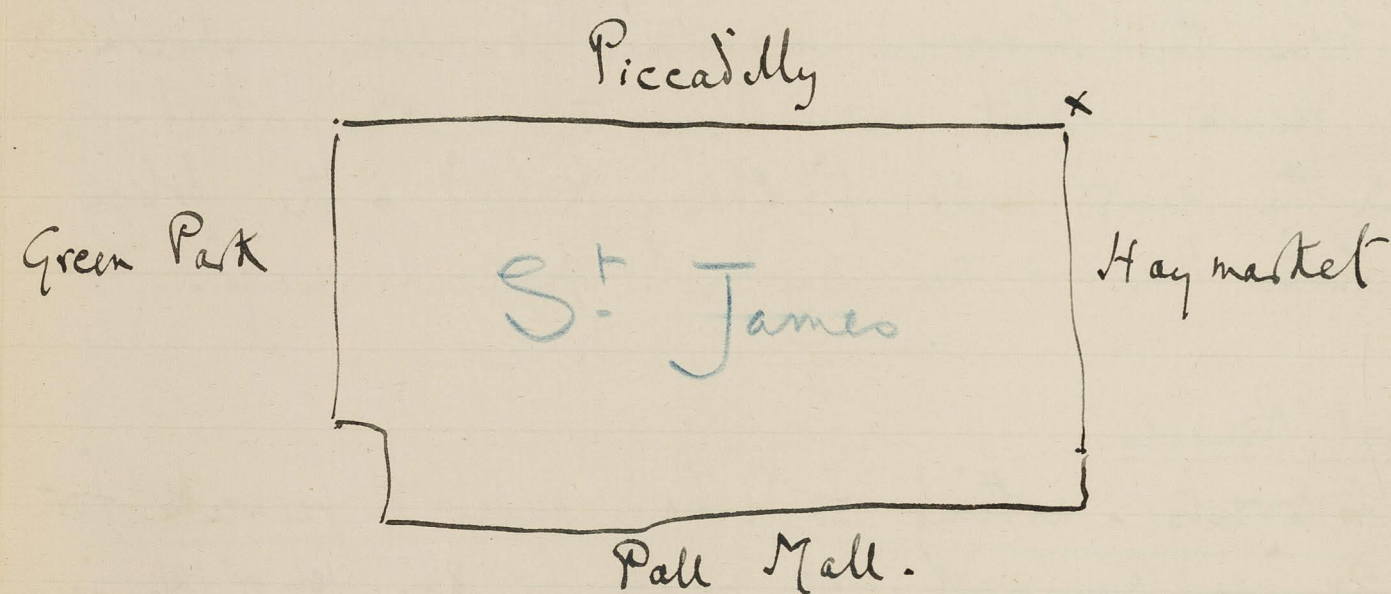

Jermyn St.

Massage establishments.

Monday. Oct 3rd

Dist 3 CP(2) G.H.D.

Walk with P.C. A Gunn round district bounded on the North by Piccadilly, on the East by the Haymarket on the South by Pall Mall, and on the West by the Green Park - being part of the parishes of St. James' Piccadilly.

Starting at the corner of Piccadilly & the Haymarket South down the Haymarket - shops, many old established with country connection - bootmakers etc. cab rank down centre. turning west at Jermyn St. this end not so good as west of Regent St. On the north side a massage establishment of doubtful character - generally nurses who have been turned out of hospitals, frequented by old gentlemen, are respectable or the reverse according to the character of their customers, the wonder to us (police) is how they get the money to start these establishments - said Gunn. on the south side 'some of the gay class'. South down Market St. - pk to rd. 4st. asphalt paved, the west

St. James' Market.

Streets & yards west of the
Haymarket.

Norris St. red

S. Alban's Place - pk b.

west side is back of Regent St. houses. the red at NW end
is Elkington's show rooms. west into St. James' Market
the centre piece is all down (see map). 38th. old fashioned
houses, working class, packing case makers, regular
workers, pink as map.

8
Down Haymarket, west at Norris St. chambers,
a new place belonging to Parcel forwarding agent
on the E side, red rather than pk of map. again
down the Haymarket, on the W side is Anglessea Gd.
stables with men living over, pk as map. to
Charles St. shops & apartments, red as map.

9
Up St. Alban's Place. 'bedrooms for gentlemen'.
'secretaries of clubs who by day use the club
as their home, sleep here' - respectable - lodgers
of a higher class than the landlords. red
rather than pk of map.

10
South down Royal Opera Arcade shops on W side
only. New Carlton hotel on E. Small old fashioned
'very few people pass through here, shops with
a country connection, for gentlemen, esp boot
makers. none living.

11
E to Waterloo place - offices: secretaries only living
alone

Pall Mall Place - red

St James Sq.

Passages N of Pall Mall.

St James St.

above. West along Pall Mall. principally clubs - on N side some chambers & shops. red as map. It up Pall Mall Place. h. with shops under on E side, ~~only~~ apartments. quiet. resp. shops with a family trade. 3 1/2 st. called in map King's place - red rather than pk of map. It into King St. Theatre - action rooms, apts, restaurant (hillis) - many chambers & new bldgs not yet occupied. red map. W to St James Square. clubs & private houses. clubs just encroaching on private h. yellow as map. West along King St & South down Angel Ct. the west side is closed. lanes boarded up, the east side is the back of Pall Mall place. W to Crown Court. narrow. much frequented passage, tumble down old houses leaning forward & against one another, shops. 'a place to run round to when you've forgotten something'. 3st. hardworking respectable people. general shops, small tailors, grocers etc. pk as map. N up St James St. ~~at~~ rank down center. clubs. shops wine merchants, gunmakers: apartments over shops. Pickering Place on the E side. 4st. all office. S side is back

Streets west of St. James St.

Cleveland Row - red

Russell Court - pk

back of Pall Mall. N then across to W side of St. James St. at Park Place. apartment, hotels. respectable. red a map. S. on W side of St. James St. is Blue Boat Yard. stables. old-fashioned. red tile roofed. gun factory. wine merchants cellars. 'Ed. Roebury keeps his horses here.'

South to St. James Place. 45 St. chambers. 'shady' characters used to live here & are in and out occasionally now. character red to yellow in map. St. Little St. James St. 4 St. north side only. apartment. stables at W end. South to Cleveland Row. house at the W corner is chambers (not coloured in map) a great place for officers ~~red~~ red to yellow in map red. 45 St. at N side is Russell Court. stables. coachmen over. pk. not coloured in map. W to Cleveland Square - apt. & houses. red to yellow. in map red. N up continuation of Cleveland Row. hotel apts on East side. large ho on west. east side not coloured in map. red to yellow.

Back to St. James St. north to Barnet St. chambers. red in map into Alington St. yellow a map.

Jermyn St.

Streets off Jermyn St.

Why yellow on S side in map?

Appletree Yard - all pk

Osmonde yard - pk

Duke St.

N to Piccadilly. shops. chambers. hotels. East as far as Regent St. south then west along Jermyn St. better this end than East of Regent St. shops. tailors. grocers. book makers. florists. game dealers. hatters etc all for the convenience of young men occupants of the apartments & hotels which make up the rest of the street. Great number of handsome cabs constantly passing the street. red to yellow. in map red. South down Wells St. apartments pink (red in map) pink. Babmaes News at the South end is pink stables - pink in map. on the N side of Jermyn St. is Eagle Place & west of it Church place - shops - & restaurant (not long ago convicted as a brothel) 3 st. pk (red in map) pk.

to the S down York St. apartments & shops. red as map. on East side is Appletree Yard. stables, factories, & backs of houses. opposite it is Osmonde Yard. stables & workshops. back of clubs. pk rather than purple of map.

to Duke St 3, 4 & 5 st. shops & chambers hotels. red as map. on the West side is masons

Mason's yard. private shoe stable & Electric light ⁱⁿ stall
 pt as map. west along Roper St. Vicard's hotel
 on S side is restaurant frequented, said sum. by some
 doubtful characters. ^{also map} N up Burg St. - chambers etc
 rd as map. W along Jerny St. to St. James'

General Remarks.

General remarks: no poor in this walk. In the map of
 public houses. only those houses are marked which
 have a bar. those which have none are not
 marked at all. Thus many of the hotels in Jerny
 St. are fully licensed but do not appear ^{those that do} as
^{reckoned} a public house ~~where~~ they have a bar, ~~or~~
 as a restaurant ~~where~~ outsiders (from police
 evidence) are in the habit of using them as
 such.

In Piccadilly we passed a very tall man with immaculate
 hat, clothes, umbrella & boots: reddish beard: ~~rather~~
 might have been a foreign prince. One of the best
 known bullies in the subdivision: said sum.

District covered.

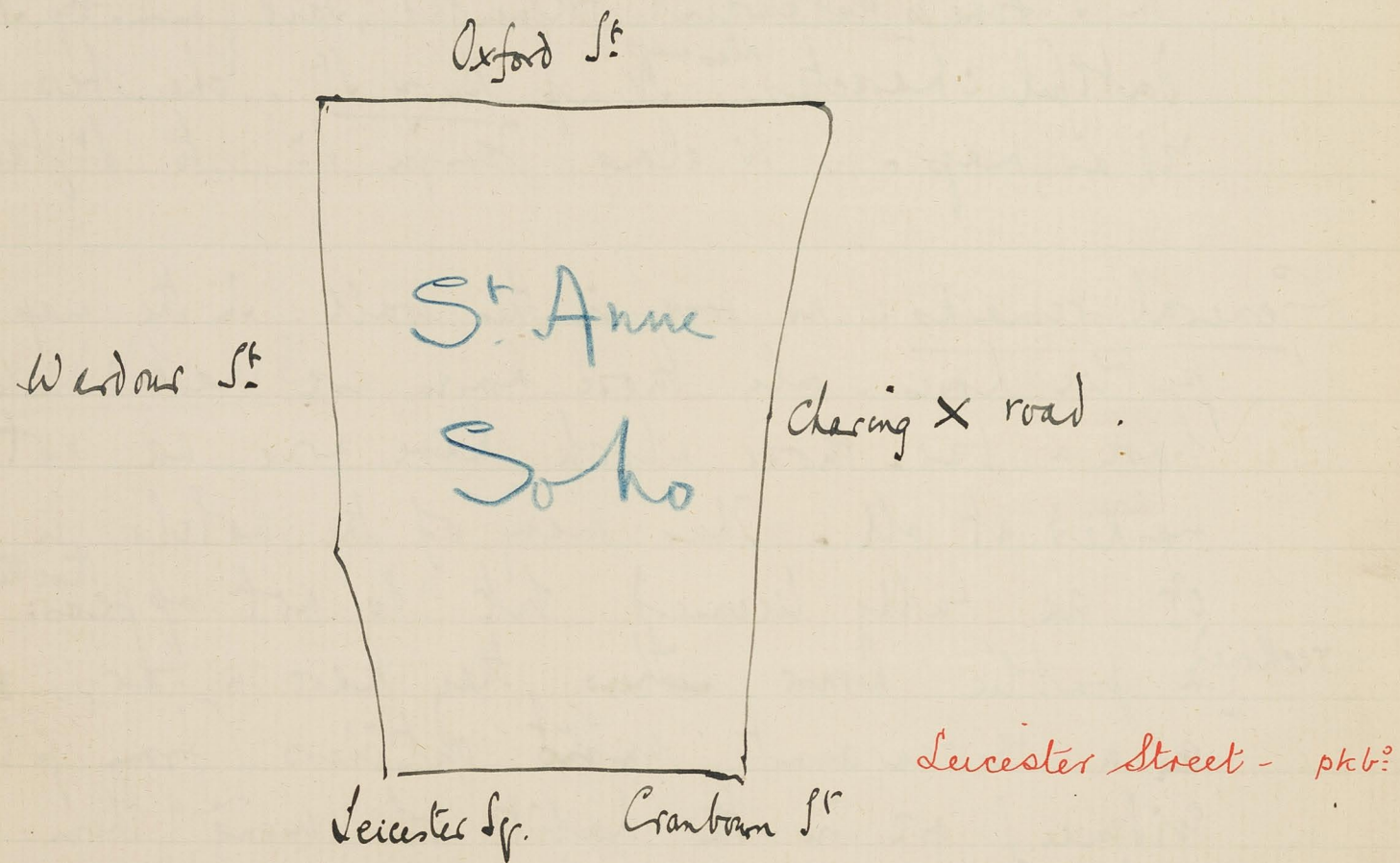

Leicester St.

Dist 3

Oct. 27th

G.H.S.

Walk with PC. A Gunn round district bounded on the North by Oxford Street, on the East by the Charing X Road, on the South by Cranborn St & on the West by Wardour St. being part of the parishes of St. Anne Soho.

Starting at the South end of Wardour St. & then E at Diels St 3 & 4 st. - many foreigners esp at E end french chefs & scullery men. small wholesale shops working for west end houses - harness platers, makers pk as map. on the South side is Leicester St. houses with tailors working for west end ho on east side. Heaps ironmongery (makes weights for London) on the W & also a stage school. pk rather than red of map. E to Leicester place Hotels - de Paris. Queens Hotel & de l'Europe all belonging to Baker Bros. houses 41 st + all. a street where foreigners playing at the music halls lodge, you will see troupes of dogs, canines or dancing bears come out of the house doors.

Little Newport St.

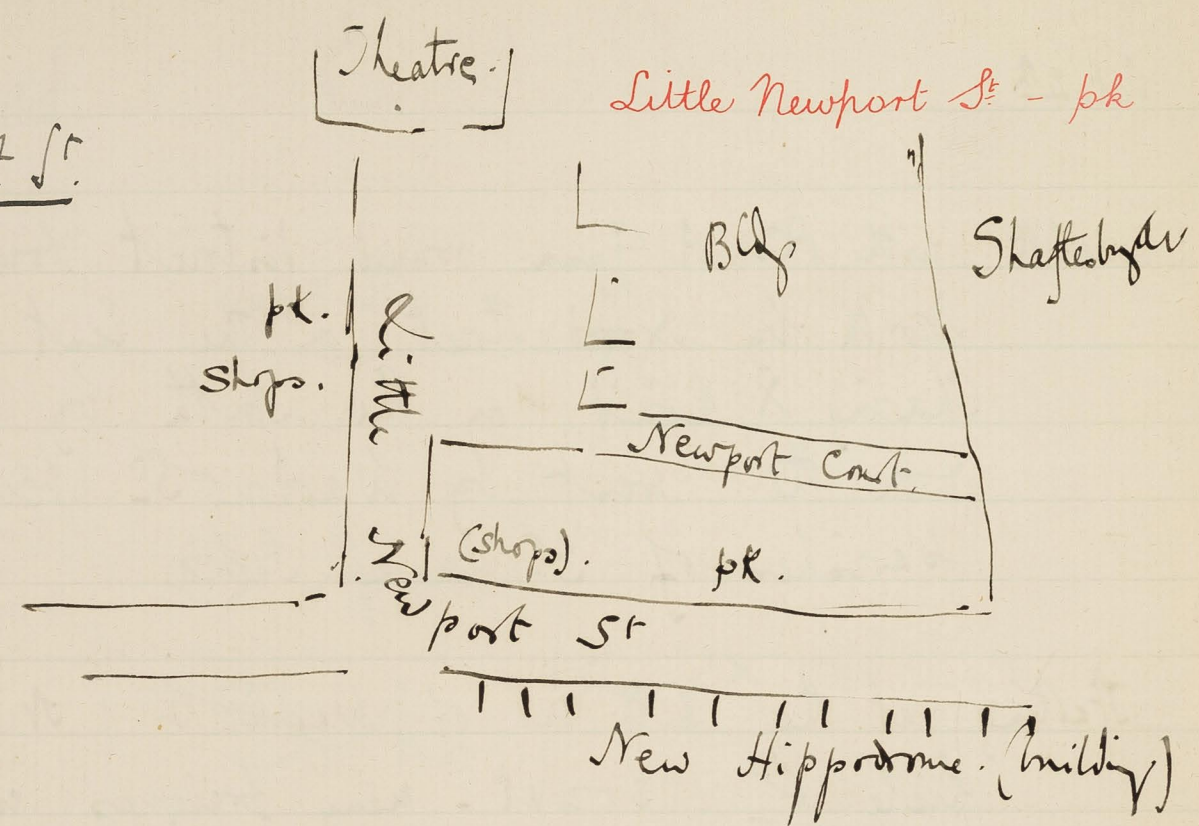

Newport Buildings

East along Little Newport St. much better character now than formerly. very active shopkeeper visiting man with a keen scent for brothels, has driven prostitutes to the east side of Chering X road & Shaftesbury avenue, out of the parish. shops - pk rather than purple of map. The south side is down & foundations being laid for a new Hippodrome & apartments. That part of Little Newport St. running due north is also pk rather than purple. East down Newport Court - street houses, shops under, south side only. the road as the buildings. shops are general dealers, men who carry off the waste of the sale rooms - lodgers over are poor rough, some thieves - windows dirty. In the shops cats meat, books & clothes pins in a heap together for sale. The shops facing this way have felt the influence of the court & are worse this side than the other (N). The whole purple as map. Newport St. on the east side of Little Newport St. as best - many poor - look better than they are because the superintendents are sharp in the matter of appearances & repair of broken

Gerrard St.

Nassau St. - pk. (W side only)

Wardour St.

Look up S end of Wardour St.

Wardour St. S. end pk

Shaftesbury Avenue N side pk 6°
S - red

Greek St.

Greek St. - pk

broken windows etc. of few children - such as these were
 pale, well fed: lowest rent of 2 rooms: occupants
 pay the rent though they have hardly enough to live
 on besides - purple to lb, in map purple.
 N to Nassau St. - Shaftesbury theater on E side -
 cheap apt. on W side - pk. not col in map.
 West along Gerrard St. 4 1/2 st. wood paved - many
 societies clubs. the Nat Telephone Co have their
 offices in what was the Old Pchican Club.
 pk as map. N side is Macclesfield St. - used
 to be well known brothels on both sides. looked
 as if there was one still - purple as map -
 horse & Dolphin Yard on the east side. factory
 room living. not shown on map. Dancey Yard
 on the west side. workshops back of houses -
 Map Wardour St. apt. shops. S end is pk rather
 than purple of map. across Shaftesbury Ave
 pink on both sides. shops with apt. over.
 N up Greek St. no poor. better than formerly.
 4 st. shops - with a good class above - like Fifth
 St. many cheap - pink rather than purple of map.
Church St. runs E-W. 4 1/2 st. Kethners Restaurant.
 found

Frith & Dean Streets

Old Compton St.

Old Compton St. - pk

Frith St.

brothels but prostit. have been driven out to Tottenham
at Rd district & Phoenix St. 4th st. purple to pk
Map Frith St. mixed - many prost. bullocks - 4th st. a
noted restaurant for bullocks on the E side. pk as
map. W to Dean St 4th st. shops - mixture of whole-
-sale firms & dwelling houses - fewer clubs than formerly.
~~shops~~ some reputed brothels - a little better than Frith
St. in character from pk to pk bar. - in map pink.

Old Compton St. - large proportion of foreigners - apt
to be quarrelsome - shops & restaurant - some poor
windows dirty - houses off road used by prostitutes
purple to pk in map purple.

N up Dean St to Bateman St. small shops. 4th st.
west of Frith St better than east of it. silversmiths
working for Bond St. firms one a woman - purple to
pk in map purple. on the N side is Bateman's
Extension of Women's Hosp has taken up large part
of west side - some poor houses - ch. clean & well
dressed. birdcages at windows - rough at times -
purple to pk in map purple - west to Frith St.
north end better than the south - 4th st. tailors - watchmakers
jewellers - apartments - pk, in map purple. W to
Dean

West side of Dean St.

Head Court St.

Little Dean Street - N }
S } purp }
 } lb }

East side of Wardour St.

Dean St. much mixed. all trades - jewellers, printers. rent of front room 9/- or 10/- if on first floor 14/- no crowding. On the west side is the Royalty News. stables only one living over. Fanns Yard only backs of houses & work shops. W into Richmond Buildings 3 1/2 st + attic. a colony of waiters. come home late, make fair but rather un-certain money, gamble a great deal & never seem to go to bed. in appearance purple to pk in map purple. South of it is Head St. has become a Jews haunt, some come here from White Chapel & some from abroad poor great many children in this street, well fed, dirty, well clothed; has been Jewish for the last 4 or 5 years. purple to lb. in map purple. South of it is Little Dean St. The N side looks clean & resp. & factories - purple rather than lb of map. On the south side were 2 noted hotels, now shut. some respectable poor houses lb rather than lb of map & a wooden house which is still used as a night club - all doors shut windows clean.

N up Wardour St. turning E at Ship Yard. In house at the E end. lb. unmarked in map. & near the west side of the turning running into St. Ann's Court.

ll as

St. Ann's Court.

Little Chapel St - pk

(Hollen St factories)

th as map. This house known as a 'back cottage' was formerly a small cottage mill at the end of the yard of a house in Warden St, entered through this house: now let separately & used to open into the passage: 'back' cottages are a feature of soles & many workshops & dwellings are built upon the sites whose existence wd not be guessed from the street front. into St Ann's Court. rough building on the south side & a frame waters. very small shops but old established & doing a large business on the north at the west end. The building's hold many casuals, rough looking women at the entry. Colney Irish, some may have come from Little Dean St. Do the usual Irish trades 'wash, clean, carry & chae'. The house east as 30ft, basement. cement passage. Jews coming in. shops on S side. children dirty, no overcrowding. th as map. the Wdys as th. N up Warden St & east along Little Chapel St. no poor now. Edward & Robert's antique furniture. Dept. pk rather than people of map. warehouse N side. N to Hollen St. Heath's hat factory on N side & new factory on S. in map purple. some living I think.

Dryden Chambers - red

Small streets between
Dean St & Wardour St.

Diadem Court - purp.

Soho Square.

Fancenberg here.

N to Oxford St. then East on the South side are Dryden Chambers - on map Allen Court. 4th floor. residential chambers. servant Rept. respectable - red to yellow unmarked in map. South down St. Chapel St. Thalia Club. night dancing club. on E side - small shops. pr as map. on the East side is Ditchfield St. foreigners on N. most of S side down. 4th floor. pr as map in to Dean St. N end being altered rebuilt as residential chambers over shops. S. on the W side is Diadem Ct late Court Court. 3rd floor. poorish, not rough, windows unbroken, houses done up, some cheap living here. purple rather than N of map. S to Carlisle St. 4th & 5th floor. good old fashioned houses pr as map. East to Soho Square. The only square in London with four corners. The streets run out of the centers of the sides instead of the corners. hospitals & business houses. very few living. N up Soho St. 4th floor. shops & business houses - a few foreigners living over East along Oxford St. then South down Charing X road. turning West at the Fancenberg new. no one living. mostly Cross & Blackwells factories. Some other workshops St. Swithin St. St. patricks Church

Manette St.

Old Compton St.

Old Compton St. E end purp

Star Court - purp

General Remarks.

takes whole of South side to Soho Square & Coroe & Mack wells the north ^{map} St George Yard. only, he occupies on South side by a housekeeper. purple. the rest is washed in map lb. South to Manette St. late Rose St. has on N side Orange yard. with only 1 ho. resp. purple top on N side - in map lb. on the South side are very narrow dark workshops, 2 & 3 floors. lett out as 'ittings' -

South past Schools & Board School laundry center which have taken the place of the large bit of lb. shown in the map.

Sts Old Compton St. late Little Compton St. 4 st. shops - number of prostitutes living at this end. Some bring men home. purple. map marks this end lb. out of this end of Old Compton St. ^(N side) is Star Court. only 1 ho at NW end. resp working class - purple. workshops & 'ittings on the other sides. in map lb. E along Moor St. 4 st. shops pt. red as map.

General Remarks. Note the 2 & out habits of prostitutes & foreigners. less roughness in district owing to fewer roughs & improvement of remainder. Many jew children, few of other nations - many foreign clubs - lathouses & gambling habits of waiters - Temptation to police in Westend.

District Covered.

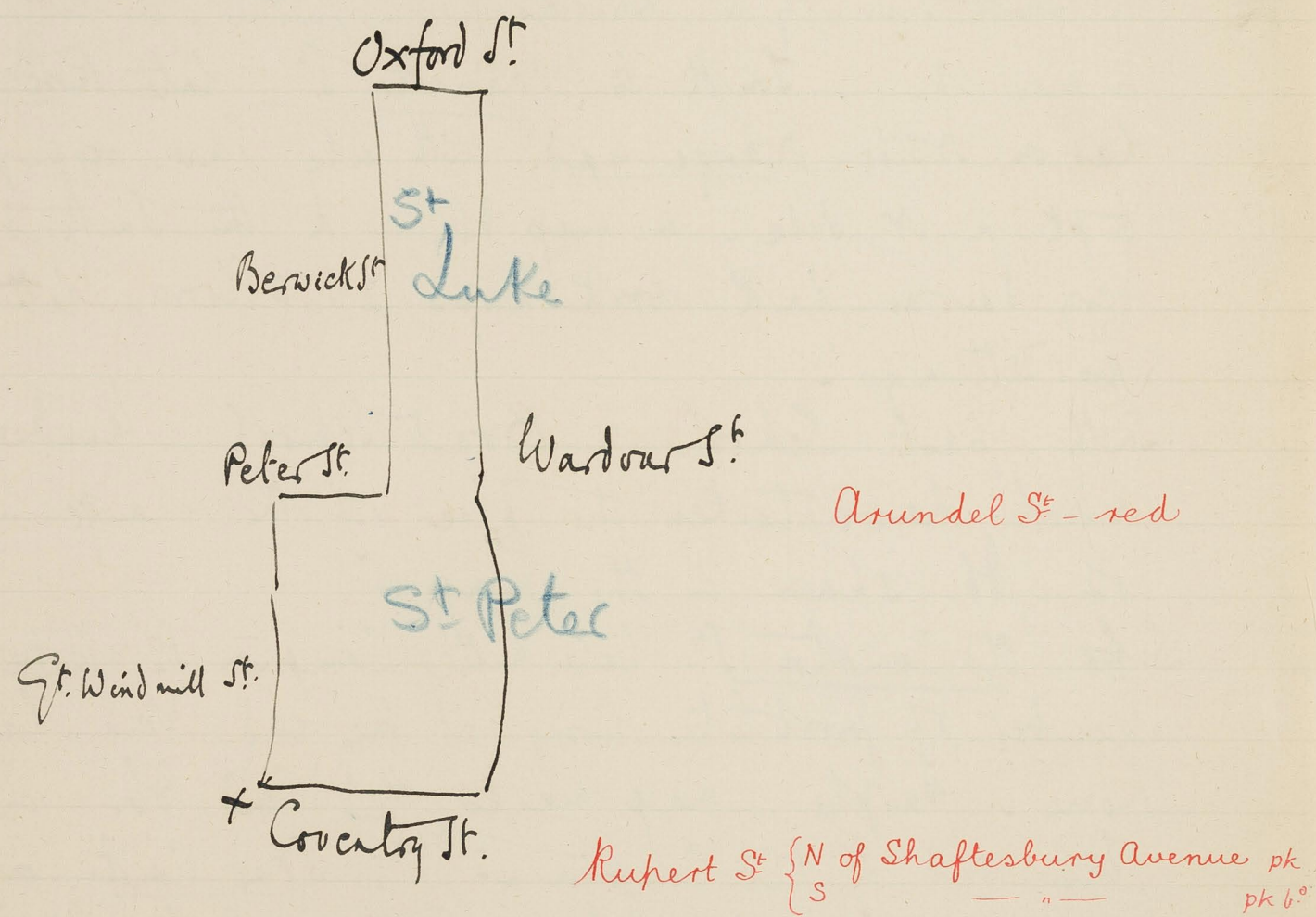

Rupert St.

Marie Lloyd.

Cooney (?)

Dist 3 (1) (2) G.H.S.

October 6th Thursday.

Walk with P.C. A Gunn round district bounded on the North by Oxford St, on the East by Wardour St, on the South by Coventry St, & on the West by St. Windmill St, Peter St & Denwick St — being part of the parishes of St. Luke & St. Peter.

Starting at the corner of St. Windmill St & Coventry St. East to Arundel St. 4th st. Hotels, Providenti, Mattis, etc. 4th st. used as restaurants for outsiders, patronised by foreigners esp but largely also this last year by Americans, the NE end (purple in map) is Chambers - scots. kept. red like rest of st. East to Rupert St. better south of Shaftesbury Avenue than North of it. 3rd & 4th st. shops - hotels respectable. no poor - red rather than purple of map. Marie Lloyd's husband on Courtney keeps public house on the West side ("She's a shady lot, & in the with the bookmakers"). her maiden name was Wood. A raid last night in a betting club in Denman St, police had expected to

Rupert Ct

Rupert Court - purple

Shaftesbury Avenue

Rupert St

to take Courney, but for a wonder he was not there.
East along Rupert Court. 3rd. small shops. many
franch. was a den of prostitutes but they have moved
out lately. some still remain. narrow. dark, flagged
passage. a famous foreign dog vet on the south side,
on the north me 'jones' who specialities are
advertised for sale in the animals in London & the
provinces. windows dirty but unbroken. blinds
daggled, laundries. rents high 10/- or 12/- for
2 rooms - purple rather than lb of map.
Map Rupert St. to Shaftesbury Avenue south side
are new flats, shops under, all sorts over, some
servants, pickered board. a message estate here.
run in last night for robbery. found to be a simple
brothel. on the north side map marks the Avenue
lb. it is poorer than the rest but not better than
formerly: some prostitutes & the head, rents here
14/- to 16/- for ^{one or} 2r. 4st. purple rather than lb.
Map Rupert St. 3 & 4 st. shops. foreign element large.
many french & a few German. purple to lb in
map purple. East along Upper Rupert St.
5th steps at west end. small shops. foreigners.

once

Little brown court - all pk

Little Palloney St.

Jews:

Court N of Little Palloney St.

Green's court - purple

once they get in up go the onto: widows dirty but not
 poor. pk to purple in map purple. N to little
Crown Ct all foreigners. shops. tailors & boot makers
 working above. many jews on N side. pk to purple.
 in map pk & lb. W along Little Palloney St.
 not a market S but a great many barbers in
 the st. High red brick Bldgs on S side. have
 take up all of Crown Ct. many jews tailors &
 boot makers, 5 st. dark raised wells behind
 the front st. pk to purple in map pk. on the
 North side of the Rd. is William Fisher Court.
 stables with some living over, a ^{gold} ^{brad} factory. at the
 SW end is a house known as 'Mother Moppo's
home' where there are sitting for west end boot-
 makers - character purple & lb. in map lb.
 East of it is Green's Court. very many jews, smell
 of fried fish, 4 st. shops, tailors & boot fittings,
 narrow, messy, dark, much paper about. some
 as fairly well to do. purple rather than lb of
 map. at the SW end through a swing door is
 a turning leading to a 'back cottage' - a found
 in many streets about here - N into Peter St.
 the

Peter St.

Walkers Passage

prices.

Walkers Passage - pk

Wardour St.

W end has a respectable set of houses on the south side with Brecknell & Tamers (Kopmarkel) candle factory at the extreme west: purple to pink at the end: opposite on the N side is Board School & playground. East of Green Court is myher. Cotes St. Peter Bldg on S side. Jew. cotes. mess vegetable ends. is now used with Berwick St. as a street market. After the tailors strike in 1881 the tailors left Cend St. dispersed; in Cornaby St. was a great St. market depending largely on their custom - custom moved so the cotes moved. purple as map. South down Walker's passage. very big passengers, luteless ship. 3 or 4 st. no poor. shopkeepers. beefsteak 10 to 1/2 bread 6^d for 4 lb loaf. pk rather than purple of map into St. Paltrey St. west, on the N side, are Paltrey Bldg. stretching back is what was formerly a court. balconied, dark, dismal looking, rent 8/9 for two rooms. called Paltrey Buildings. west to Wardour St 2 st narrow. west side poorer than the east, purple to pink as map. on the west side is Doris Place. 9 houses, on N. W & south sides, 2 st, one room thick. st. faced old

Peter St.

prices

Tyler's Court.

Tyler's Court - lb

Streets west of Wardour St.

Portland Street - purple

old houses, court create paved - in the middle of the court was former a grocery store-place, now removed letting in light & air. very poor - coppers, sometimes do well but casual - lb as map. quiet - past Peter St. mackerel (fair) 2d each, herrings 'all alive', four a 1. shops. people as map. Map Wardour St. turning West at Tyler's Court. 4 houses, 30ft. poor quiet, 'women sellers of wares wearing a pearl in eardrums' living here, one house better than the rest with flower entry. lb. not colored on map. through one of the houses here on the N side is an entry to a 'back cottage'.

N to Edward St. Jews. has fine inn. small shops. looks less good than pink of map is purple. South Lane Jack Lane. Stables, tailors & boot-makers sitting at the S end.

N to Portland St. all nation here - shops. several thieves standing at the corners 'They make a crowd at the dinner hours & then do business'. Some fairly well off people living in the street. purple rather than lb of map. on the south

Noel St purple

Berwick St.

South side are Wardour new, none living: factories, ^{away}
N to Noel St. 3 or 4 st. curiosity shops. and an
'invisible china vender. has improved in character
shopkeepers then selves live above. purple rather
than lb of map. that part of the street west
of Berwick St. is also better than lb. new french
protestant school on the south side & respectable
working class: on the north side the greater part is
wholly one of poor home remains & one restaurant.
'suppers after the theatre' a hotel.

N to Oxford St. then west, then south down
Berwick St very mixed. ^{people as well} Some good firms - restaurant
at N end is a hotel. many silver smiths, platers
engravers working for west end houses, small
shops. below Broad Street Berwick St. is a
street market, barrows & shops, meat for
2d per lb. fair mutton 7d. bacon 4d - to 10d.
Black Lion Court on the west side opposite the
Church has one house only tenanted by a sweep.
lb. not marked in map.

General remarks. Note the number of silver smiths
r

Crowding..

Few children.

Restaurants.

Want of playgrounds.

24
• learned platers in the district: small men & women working for west end shops: 'our factories' as they call them. Gunn said there was no overcrowding except among the Jews 'they will always occupy all four corners of a room & take in a lodger to fill the centre'. Sanitary authorities much stricter in this respect than formerly.

Very few children about the streets.

Many restaurants. These are far more numerous than it appears on the map for the map gives only those that have beer, wine or spirit licenses.

Great want of open spaces. Why shd. not Johns Green or Golden squares be opened to the children of the neighbourhood? The only available spot near at hand seems to be the small churchyard of St Anne's.

District covered.

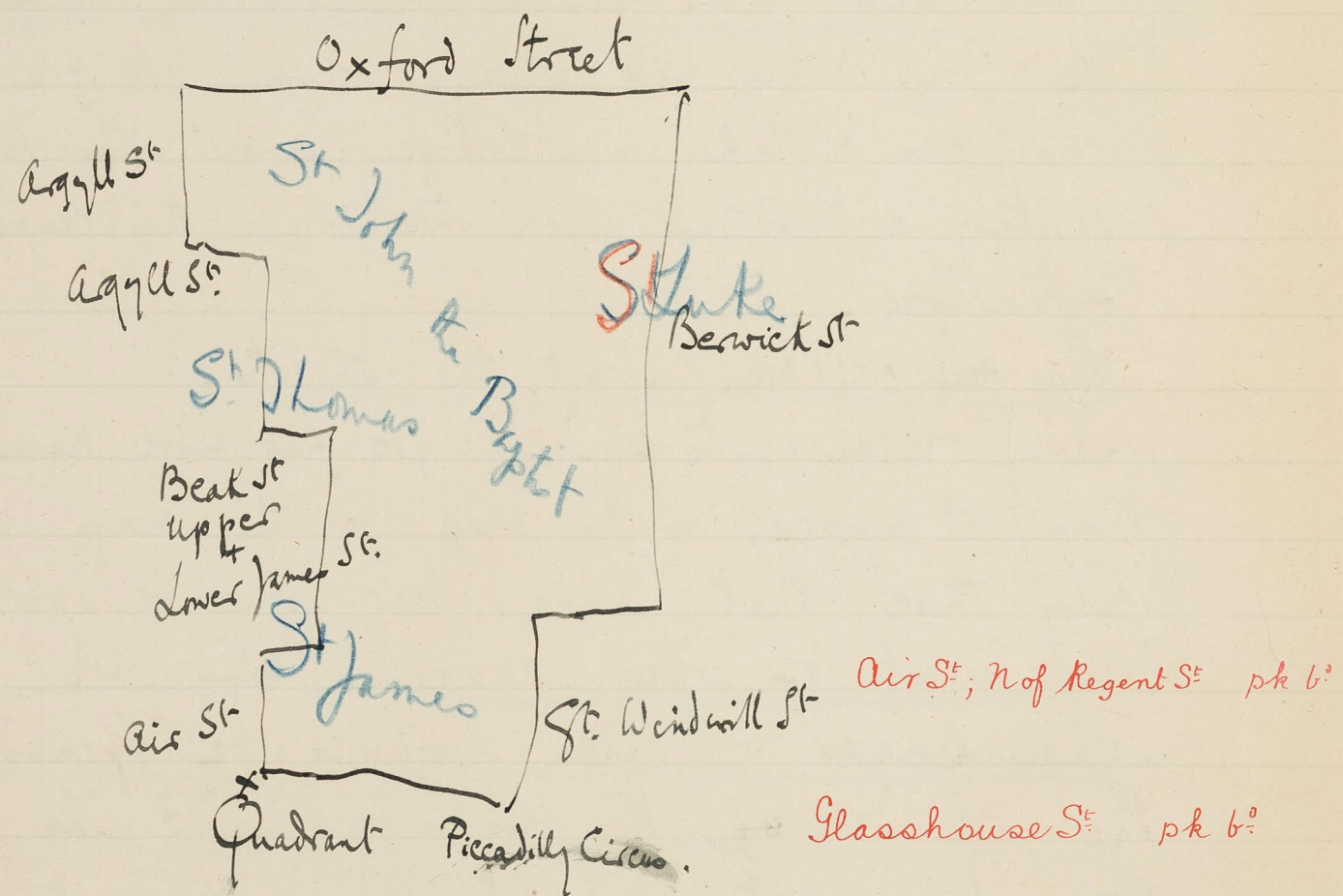

Glasshouse St

Sherwood St pk

October 7th 98.

Dist 3

CR 2
G.H.D.

Walk with P.C. A gun round district bounded on the North by Oxford St. on the East by Bevic St & St Windmill St. on the South by the Quadrant & Piccadilly Circus and on the West by Lower & Upper James St, Beak St & Carnaby St & Argyll Place St. being part of the parishes of St John the Baptist, St Luke, St James & St Thomas.

Starting at the corner of the Quadrant & Air St. N up Air St. Cafe Royal on E side (whole) 374 st on W. shops. some servants kept pked up R in map pink. East along Glasshouse St. with staircases east of Air St. as all business houses - some cartakers living over. 3+4 staired. in map red. Sherwood St capaldi parade on the north side is Kings Arms Yard. stables & builders & tailors rooms. only two families (drivers) living there - purple & lb. not colored in map. N up Sherwood St 374 st. shops. much better now than formerly. no poor - asphaltic paved

Seaman St.

Sherwood Place - pk

Wellington Mews - purple

Windmill St.

St. Windmill St. E - pk
W - purple

Ham Yard

Sherwood St

pared. Saw restaurant on the East side is one of the few houses in the west end after the style tradition of the City Chop house - pk rather than purple of map. Sherwood Place at of the East side 2^d st. good class. pk. - not colored in map. East along Seaman St. on the South side is the Pelican Club (raided for gambling two nights ago) & the Scandia, a hotel employees club on the north side. at the East end on the N side were two noted brothels, now empty: some rebuilding on N side. ^{pk} Wellington Mews out of the N side. built 1822. stables - carmen living over. good class. purple. in map pk & st.

E into St. Windmill St. 3^d st + att. 14th st. mixed. some fairly off. shops. some poor above. purple rather than lb of map on W side, on the East side at the corner of Little Rattery St. are red brick Buildings taking up the whole of St. Cross Court. in character pk to purple. - on the west side Ball yard. It in map is now all down & closed. north of it is Ham yard with its soup kitchen & hospice - founded 1846.

rebuilt

Cont. off the west side of
Great Windmill St.

E of St. Windmill St.

Archer St. purple

(continued in Book 13 J. page 1)

rebuilt in 1883. some living in Stan. Yard, now except
those over the Japs kitchen. The rest is factories &
advertising agents offices. 32 men were standing
inside the kitchen, all hatted or capped, with
good boots & fair clothes, clean faces & shaved
'many old soldiers'. they came here not only for the
day but for chance employment by the adve-
-ment contractors - chiefly two firms with one store-
North of Stan. Yard is Smiths Court. 2 or 3 st. houses
on south side only, workshops on N. asphalted court -
poor casual labourers on the south side, one a sweep,
used to be noisy, now quiet. Tailors settings & a
shoeing forge on N side. lb bld is map st. but
less of it now. On the east side of St. Windmill
St. is Archer St some poor but not many, 4 or 3 st.
'Buildings' at N end with others behind them
lowest tent said James was off for ^{widows clean washed} 2 rooms -
right club ^{is a} Parsons Francis on the south
side. purple rather than the lb of map.
Windmill St N of Archer St. is pk rather than
lb of map. West along Brewer St 4 st. shops -
some Jews. many owners living above - No. 41 is the
Theatre

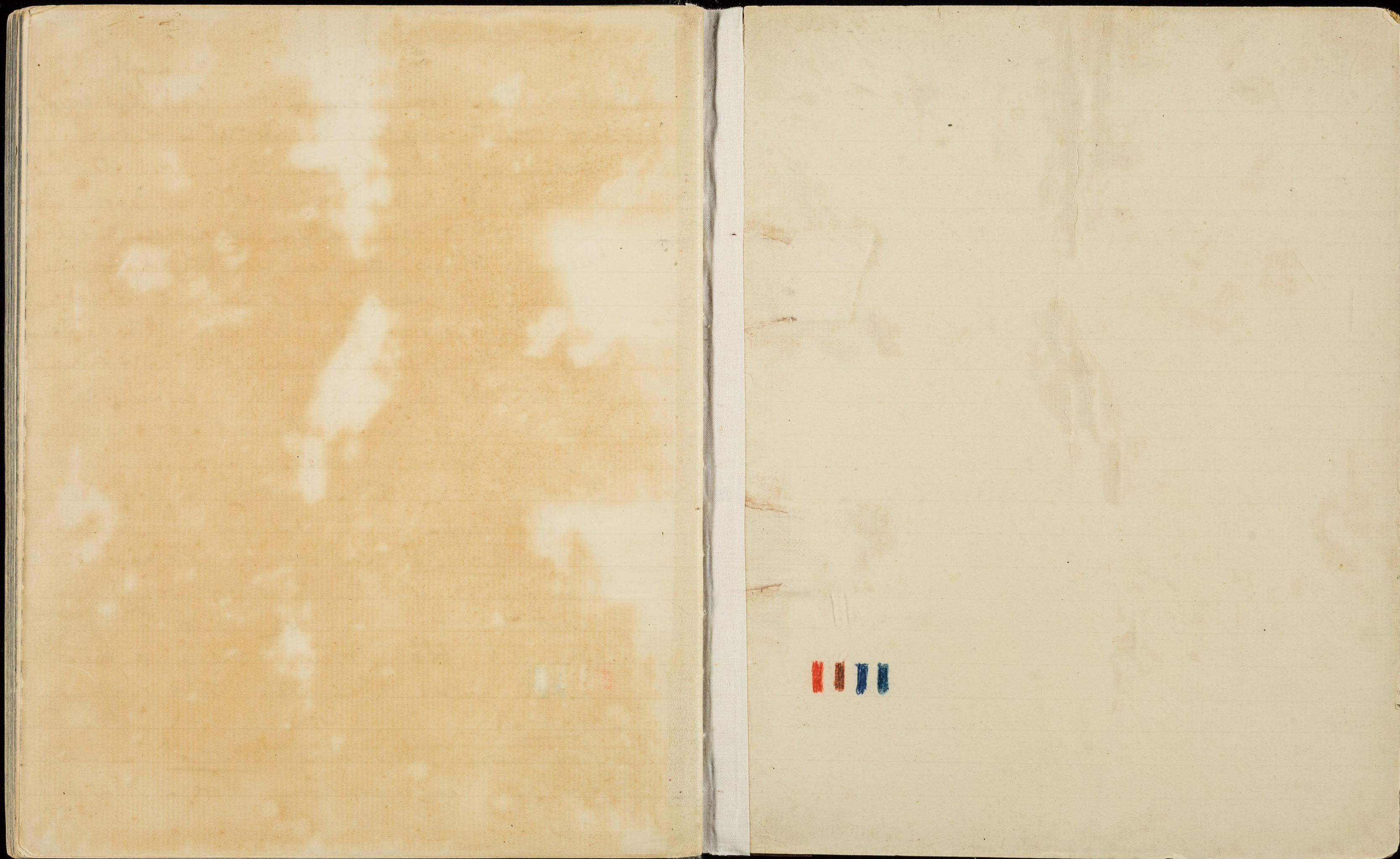

Faint, illegible stamp or mark on the left page.

Small, colorful mark consisting of four vertical bars (red, brown, blue, blue) on the right page.

