

B 208

XXXIX

Nonconformist (2)

17. Upper Holloway.

From Charles Booth,
9, Adelphi Terrace,
Strand, London, W.C.

COLL U

B (208)

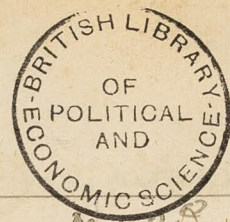

[i]

Name	Denomination	Address	Page
Parsons. Rev. Littlejohn H.	Congregational	5 Portland R. Finsbury Park	1-
Webbary J. B.	Presbyterian	2 Hillside Lane. Hornsey Lane	23-
Norris W. Ryle.	Calvinistic Methodist	Sussex R. Up-Holloway	33-
Turner. Rev. W.	Primitive Methodist Bunham R. Anneton R. + Housey Rise	30 Woodstock Rd. Finsbury Park	41-
Spear. Rev. Robt	Highgate Hill Unitarian	Arundel House, Highgate Hill	57-
Ramsay. Rev. Alex	Presbyterian		67-
Houghton. Mr. Walter	Salvation Army Holloway II.	74 Lancaster Road Stroud Green N	79-
Alexander. Mr. W. H. J.	Friends Meeting House Mercer Rd.	17 Gracechurch Street	95-
Highgate Hill Library.	A Visit to		103
Mr + Mrs E. Garrod	Brethren.		109
Bird Mr + Mrs Parnell + Edwards	Grove Road Samaritan Mission	93 Grove Road	115

Rev. L. H. Parsons, Congregational minister



REV. LLEWELLYN H. FARSONS.

A St. Anne's parish.

17
13
Nov. 19. 1897 - J.C.

Interview with Rev. Llewellyn H. Parsons, 2
5 Portland Rd. - Finsbury Park.

Finsbury Park Congregational Church, of which Mr. Parsons is minister, is so prominent a centre of social & religious activity that I expected to have found a rather exceptional man at its head. Mr. P. did not strike me as above the average either in ability or energy, however, but he has a good & distinct voice, & clear, if not brilliant, style of thought, probably preaches well & chooses taking subjects, for he says he has a congregation of 1200 or more on Sunday nights. For the rest he may have been one of those who have greatness thrust upon them, coming here 5 years ago to an old-established, wealthy & flourishing flock, including many ladies with leisure to devote to the work.

Finsbury Park Church, which was founded 30 odd years ago & rebuilt in 1884 at a cost (for site & building) of £13000, is a rather handsome & pretentious looking building, with a

Population Reached

Persons Employed

Buildings

lofty & showy tower. It stands in Seven Sisters Rd., at corner Palmerston Rd. & close to the notorious Campbell Rd., & it is in these two & immediately adjoining ^{poor} streets that it finds the vaison d'être of its missionary efforts.

By means of church, mission, visitors, &c., all classes are touched, the well-to-do from a wide area, including Finsbury Park, St. James, Holmsey, &c.; the poor from the quite immediate vicinity of the church.

Besides the minister, a lady visitor is the only person paid. There is quite a crowd of voluntary workers in one way or another - about 60 or 70 who fill some distinct office, besides those who help with S. School, choir, open air meetings, &c.

Church holds 1240; lecture hall 300, a very good, comfortable room; there are also ante-rooms attached to church. The

Services & Attendance

mission is carried on in 2 houses adjoining
the church in Palmerston Rd.

Sunday morning, 1000 attend; evening
1200. Wednesday evening, 250 to 300.
Church membership, 850. Membership & con-
gregation almost entirely middle class.

Young Men's Union meets on Sunday
afternoon; membership 25; attendance 15.

Palmerston Rd mission - Sunday eve
attendance over 100.

Open air mission held from May to
Oct. "Few actual conversions known" as
result but signs not wanting that blessing
attended the work.

Sunday school - on books 818; average
attendance, nearly 600. It occupied a poor
deal for want of room. Held in lecture
hall, overflows into mission rooms & church.
More work w. be done in several ways
if room permitted.

Pastor's Bible class for children on

Wednesdays. Attendance & interest well maintained.

A special feature is made of a young people's service on last Sunday in each month. The pastor preaches on some popular social topic. On Nov. 28 his subject is "Hill Paine's work 'The Christian'". The church is crowded at these services.

The week-day engagements start with a mothers' meeting on Monday afternoons, with an average attendance of 45, an increase on last year. These are given a free excursion & a free tea once a year, & are allowed a small rate of interest on their deposits, wh. last year amounted to £37.

Then follow a round of engagements taking most afternoons & every eve. but Saturday: "Jeanne Lyinn" (otherwise Band of Hope), penny bank, literary society, Workers, Bony Bee, & Watering Societies.

Social Work -

9
debating class, missionary societies,
choral society, Christian Endeavour Society,
etc. The last named has 250 members
& goes well.

The Temperance Society has 130 mem-
bers. Hold outdoor meetings in summer,
indoor in winter. The penny bank
gives 5% interest; deposits last year
£152; balance remaining £84.

The Literary Society, wh. has 178
members has this year copied the method
of Highbury Quadrant, in arranging a
series of lectures by first-class men,
& has issued an admirably got-up
programme. The lectures attract fairly
large audiences, & are held in the
church.

Visiting & Relief go hand in hand in
this church, & in one way or another there
is a good deal of both. The congregation
are very liberal, as well as kindly, too.

Visiting & Relief

Visiting & Relief (contd):

By the "Home Mission".

Parsons says - ready to welcome or to help,
& "they don't relieve with a tract."

The paid lady visitor is much beloved
& well received. She works in the poor
streets of the district generally, & is in
the vestry of the chapel every morning at
10, to administer spiritual ^{or other} bodily comfort.
She is supplied with food tickets wh.
she distributes at her discretion, though
she may not go beyond a certain amount
without permission of the Home Mission
Committee. This Committee consists of ladies
who visit also, & report cases of distress.
A special point is made of finding out
& helping those respectable needy people who
w^d. never come forward to ask for it or
let their poverty be known. Relief is
given without respect to creed. Last ^{Winter} year
was so mild that less relief was given than
usual: it amounted to £44 in ^{food} tickets;
£5 in coals; & £3 in blankets. Hospital
& Convalescent Home letters were given in

Visiting & Relief (contd)

By Palmerston R^d Mission

13
in addition, as well as admissions obtained to cripples houses, etc. They do not always avoid imposture - find sometimes that people are getting help from 3 or 4 sources - but on whole suffer is little or most. The visitor knows the people well.

The Palmerston R^d Mission confines its work practically to that road & the lower part of Campbell R^d (the upper part is looked after by New Court Church Mission). The Mission is under the general charge of Miss Fuller (31 Alexander R^d, N.), of whom Mr. P. speaks highly. She is a shrewd lady, & does her work very thoroughly. Voluntarily devotes herself to this, & is a great authority on Campbell R^d, "about the worst street in N. London." This road, particularly the lower part, is the resort of criminals & tramps; probably a policeman wd not dare go down it alone at night, but Miss F. goes in & out amongst the people quite freely. In many & is always well received.

Visiting & Relief (cont^d)

Gifts of Clothing, etc.

of the houses (8 rooms) there is a family in every room. The greatest difficulty they have is the scouring character of the population, so that the good done is often went to their eyes.

The report of the mission speaks of "much encouragement" & "some disappointments." "Results are slow, but they keep piling away." "The weekly visits are regarded by the people as bright interludes."

The mission gave about £33 in relief tickets last year, & spent £4 on a free tea.

Other sources of relief connected with the church were the Doves Socy. wh. exchanged 134 tickets for useful garments; the Busy Bee, wh. looks after poor children, & gave away 200 garments, besides a free tea & entertainment; & the Maternity Socy. wh. had 22 boys. All this was done last year.

Other Influences

New Court Chapel has a mission in Lemox
Rd., it is doing good work.

St. Annis, Pool's Pk., not doing very
much. Vicar a nice old gentleman, but past
active work.

Finishing Pk. Lads Institute, in Pool's
Pk., has 50 or 60 gutter lads in training.
The lads meet there in evenings; have
the various forms of recreation of a club
or institute, with refreshments, &c. Mr. P.'s
church takes a great interest in this
institute, & subscribes to it, but has no
organic connection with it. Mr. P. thinks
very well of it, & may establish a direct
connection, he thinks. The following take
an active part in it:—

Mr. Willis of Strand Green

" Herman Wilkins

" Connelly

No co-operation with other churches.

Local Government.

Poor Law.

Prostitution
& Police.

Drinks.

19
Sanitary authorities very wily. Continually
meeting officials on his visits. If things
were not well looked to in Campbell
R^d there wd. soon be an epidemic.

Out relief well & liberally administered.
has with several cases of old people helped
by it. Complaints here, as everywhere,
about the parish doctor not being so
courteous or attentive as he is to his
paying patients.

Prostitution allowed much too freely
in Seven Sisters R^d. Two or three
women stand together at corner of Wilberforce
R^d. Shd. be moved away, as they
are a temptation to the thousands of young
men who pass on way home for business.
otherwise has no complaint against
police, who are courteous & efficient.

Drinks awful; p.l.'s innumerable.

Character of population

Portion touched

Persons employed.

St. Mark's parish.

St. Mary's parish.

17

CP 2

Interview with the Rev J A Mehamy Pastor of the Scotch Presbyterian Church Cranek Road - At his house 2 Hillside Lane Hornsey Lane IV

Mr Mehamy is a prosperous energetic Scotchman in middle life but young rather than old. He has £1000 a year stipend & lives in a very good house - well furnished. He has been 12 years at this Church which is well attended drawing its congregation from all around to some considerable distance.

There is a poor portion of the district served by the Andover Road Mission - otherwise the population are well to do - well paid clerks, managers & business men

This church caters for the Scotch & is largely fed by new arrivals in London who are promptly looked after brought under church influence & in many cases set to work.

Mr Mehamy & a lady missionary (who is in responsible charge at Andover Road) are the only paid. There is besides a very thorough voluntary organization consisting of Elders, Deacons (or managers) district visitors - Sunday school teachers &c (18 Elders, 18 managers, 55 dist visitors, 35 Deacons members - 93 teachers)

Buildings

Services

Social Agencies

Educational
Visiting

Charitable Relief

The Elders govern in matters spiritual & the Managers in matters financial. There are 1000 Church members (Communicants)

Church with 1100 places. Large Hall for 500 Small Hall ^{class room} 200. Mission Hall 500 with smaller hall & class room

10 o'clock (Sunday) Young men 10.30 Prayers Meeting (self managed)

11-12 School children (in their own Hall) - 11-12.30 Morning Service ^{in Church}

3-4 Sunday school - 6.30 to 8 Evening Service

Full congregation morning & evening - Mission Morning Service 1.50 ^{Evening Service full - Sunday school in afternoon}

Something song or story night - Monday Temperance guilds

Tuesday Literary Society (300/400 members) with a library

Wednesday - Service 1.50-2.00. Afternoon dress meeting

Thursday - Young people Christian Endeavour

Friday - Chorus Martin & Choral Assoc & Bands of Boys

Saturday - nothing.

In the mission they have Mothers meeting & other things & on Saturday a concert which is well attended. All volunteers singing. (See leaflet - good)

Sunday school only - 700 in Church school, 1600 in Mission School

of the poor district is completely mapped out & well known

& the congregation is looked after by Elders & all organized in districts.

Very cautious & not much. They look after their own people. Money spent very carefully

Church

ADULT SERVICES.

November 4 ...	Thursday, 8 p.m. ...	MR. JAMES FERGUSON.
" 7 ...	Sunday, 11.15 a.m. ...	MR. GEORGE P. PEACOCK.
" 7 ...	" 7 p.m. ...	CAPTAIN GEORGE CLARKE, R.N. <i>Address on work of British and Foreign Sailors Society.</i>
" 11 ...	Thursday, 8 p.m. ...	MISSION GOSPEL BAND.
" 14 ...	Sunday, 11.15 a.m. ...	MR. DAVID M. STEWART.
" 14 ...	" 7 p.m. ...	MR. JOHN TOD.
" 18 ...	Thursday, 8 p.m. ...	MR. ALEXANDER DURWARD.
" 21 ...	Sunday, 11.15 a.m. ...	MR. H. W. HENVILLE.
" 21 ...	" 7 p.m. ...	REV. J. B. MEHARRY, B.A.
" 21 ...	" 8.15 p.m. ...	<i>Lord's Supper.</i>
" 25 ...	Thursday, 8 p.m. ...	MR. WALTER SAWYER.
" 28 ...	Sunday, 11.15 a.m. ...	MR. HENRY W. BIRD.
" 28 ...	" 7 p.m. ...	MR. ARTHUR ROBERTSON.

SATURDAY ENTERTAINMENTS.

- November 6.—8 p.m. **Temperance Tale**, "Little Goldie," with Magic Lantern Illustrations. Reader, Miss OLIVER.
- " 13.—8 p.m. **Special Instrumental and Vocal Entertainment**, by MISSION MILITARY BAND AND FRIENDS, in aid of Band funds. Admission, Andover Road 2d., Crouch Hill 6d.
- " 20.—8 p.m. **Concert**, MISSION SUNDAY SCHOOL TEACHERS.
- " 27.—8 p.m. **Concert**, Officers of MISSION SAVINGS BANK AND FRIENDS.

SUNDAY.

- 11.15 a.m. Adults' Service.
- 11.15 " Children's Service.
- 3 p.m. Sunday School.
- 3 " Young Women's Bible Class.
- 4 " Young Men's Bible Class.
- 4 " Boys' Brigade Bible Class.
- 6.45 " Children's Service.
- 7 " Adults' Service.

MONDAY

- 2.30 p.m. Mothers' Meeting.
- 6.30 " Girls' Drill Class.
- 7.30-8.30 " Savings Bank.
- 8 " Adult Total Abstinence Society.
- 8.30 " Boys' Brigade Drill.
- 8.30 " Self-Help Society (fortnightly).

TUESDAY.

- 6 p.m. Children's Play Room.
- 6.30 " Girls' Working Meeting.
- 8 " Men's Band Practice.

WEDNESDAY.

- 3 p.m. Women's Bible Class.
- 7.30 " Children's Band.
- 8 " Men's Band Practice, New Members.
- 8 " Boys' Brigade Reading Room.
- 8.30 " Choir Practice.

THURSDAY.

- 8 p.m. Adults' Service.
- 8.30 " Boys' Brigade Gymnasium.

FRIDAY.

- 8 p.m. Young Men's Gymnasium.

SATURDAY.

- 8 p.m. Adults' Entertainment.

The Rev. J. B. Meharry, B.A., will conduct the Service on Sunday evening, 21st November. We heartily invite a full attendance of all our friends and neighbours.

Lord's Supper. Mr. Meharry will conduct the quarterly celebration, after the ordinary Service, the same evening.

British and Foreign Sailors' Society. Captain Clarke, R.N., will give an Address on the work of this Society, on Sunday evening, 7th November; special collection for its funds.

Military Band. Our Band and their friends will give a special Instrumental and Vocal Concert, on Saturday, 13th November, in aid of the Band funds. Admission, Andover Road, 2d; Crouch Hill, 6d.

Savings Bank. We would draw particular attention to the near approach of winter, and urge all our Friends, meantime, to put as much as possible into the Bank, to provide for warm clothing, coals, Christmas, sickness or want of work. We are glad the money deposited is more than it has ever been before.

THOSE WISHING TO BE VISITED AT THEIR HOMES, OWING TO SICKNESS OR OTHER CAUSE, WILL PLEASE GIVE NOTICE AFTER ANY SERVICE. CHILDREN ADMITTED TO ADULT MEETINGS ONLY IF WITH PARENTS.

ALL ARE HEARTILY INVITED.

Please hang this above your mantel-piece during the month.

Andover * Road * Mission.

NOVEMBER, 1897.

"Fight the good fight, lay hold on eternal life, whereunto thou art also called."

ADULT SERVICES.

November 4 ...	Thursday, 8 p.m. ...	MR. JAMES FERGUSON.
" 7 ...	Sunday, 11.15 a.m. ...	MR. GEORGE P. PEACOCK.
" 7 ...	" 7 p.m. ...	CAPTAIN GEORGE CLARKE, R.N. <i>Address on work of British and Foreign Sailors Society.</i>
" 11 ...	Thursday, 8 p.m. ...	MISSION GOSPEL BAND.
" 14 ...	Sunday, 11.15 a.m. ...	MR. DAVID M. STEWART.
" 14 ...	" 7 p.m. ...	MR. JOHN TOD.
" 18 ...	Thursday, 8 p.m. ...	MR. ALEXANDER DURWARD.
" 21 ...	Sunday, 11.15 a.m. ...	MR. H. W. HENVILLE.
" 21 ...	" 7 p.m. ...	REV. J. B. MEHARRY, B.A.
" 21 ...	" 8.15 p.m. ...	<i>Lord's Supper.</i>
" 25 ...	Thursday, 8 p.m. ...	MR. WALTER SAWYER.
" 28 ...	Sunday, 11.15 a.m. ...	MR HENRY W. BIRD.
" 28 ...	" 7 p.m. ...	MR. ARTHUR ROBERTSON.

SATURDAY ENTERTAINMENTS.

November 6.—8 p.m.	Temperance Tale , "Little Goldie," with Magic Lantern Illustrations. Reader, Miss OLIVER.
" 13.—8 p.m.	Special Instrumental and Vocal Entertainment , by MISSION MILITARY BAND AND FRIENDS, in aid of Band funds. Admission, Andover Road 2d., Crouch Hill 6d.
" 20.—8 p.m.	Concert , MISSION SUNDAY SCHOOL TEACHERS.
" 27.—8 p.m.	Concert , Officers of MISSION SAVINGS BANK AND FRIENDS.

SUNDAY.

11.15 a.m.	Adults' Service.
11.15 "	Children's Service.
3 p.m.	Sunday School.
3 "	Young Women's Bible Class.
4 "	Young Men's Bible Class.
4 "	Boys' Brigade Bible Class.
6.45 "	Children's Service.
7 "	Adults' Service.

MONDAY

2.30 p.m.	Mothers' Meeting.
6.30 "	Girls' Drill Class.
7.30-8.30 "	Savings Bank.
8 "	Adult Total Abstinence Society.
8.30 "	Boys' Brigade Drill.
8.30 "	Self-Help Society (fortnightly).

TUESDAY.

6 p.m.	Children's Play Room.
6.30 "	Girls' Working Meeting.
8 "	Men's Band Practice.

WEDNESDAY.

3 p.m.	Women's Bible Class.
7.30 "	Children's Band.
8 "	Men's Band Practice, New Members.
8 "	Boys' Brigade Reading Room.
8.30 "	Choir Practice.

THURSDAY.

8 p.m.	Adults' Service.
8.30 "	Boys' Brigade Gymnasium.

FRIDAY.

8 p.m.	Young Men's Gymnasium.
--------	------------------------

SATURDAY.

8 p.m.	Adults' Entertainment.
--------	------------------------

The Rev. J. B. Meharry, B.A., will conduct the Service on Sunday evening, 21st November. We heartily invite a full attendance of all our friends and neighbours.

Lord's Supper. Mr. Meharry will conduct the quarterly celebration, after the ordinary Service, the same evening.

British and Foreign Sailors' Society. Captain Clarke, R.N., will give an Address on the work of this Society, on Sunday evening, 7th November; special collection for its funds.

Military Band. Our Band and their friends will give a special Instrumental and Vocal Concert, on Saturday, 13th November, in aid of the Band funds. Admission, Andover Road, 2d; Crouch Hill, 6d.

Savings Bank. We would draw particular attention to the near approach of winter, and urge all our Friends, meantime, to put as much as possible into the Bank, to provide for warm clothing, coals, Christmas, sickness or want of work. We are glad the money deposited is more than it has ever been before.

THOSE WISHING TO BE VISITED AT THEIR HOMES, OWING TO SICKNESS OR OTHER CAUSE, WILL PLEASE GIVE NOTICE AFTER ANY SERVICE.
CHILDREN ADMITTED TO ADULT MEETINGS ONLY IF WITH PARENTS.

ALL ARE HEARTILY INVITED.

Please hang this above your mantel-piece during the month.

There is a ring of prosperity & satisfaction about Mr
 Meharry's report which contrasts strongly with very
 much that we hear. His church touches & holds
 the people for whom it is intended. The mission
 is simply an offering of the congregation - an attempt
 to do their part in bringing assistance & religion to
 the poor. It seems to be carried on on good principles
 but to be neither more nor less successful than many
 similar efforts. The admitted failure of the religious
 bodies generally to interest the working classes - or do
 anything much beyond entertainments for any but the
 children (always excepting Mother Meetings) Mr Meharry
 attributes to lack of adaptation of means to
 end. If the preaching were suitable it would not
 fail to draw the people as listeners. The services
 must be suited to the people. He thought the
 Catholics succeeded better in this. Mr Meharry
 has, & prides himself on, a rough & ready tongue &
 might succeed - but he has not done it & might find
 success in any deep sense more elusive than he supposes

31
He reports a marked improvement in dress, appearance, cleanliness, & good behaviour in the
mission people during his 12 years.

Nov. 25th

St. Mark's parish.

CR (2)

Interview with Rev. W. Ryle Davies, Calvinistic Methodist Chapel, Sussex Road, Upper Holloway.

Mr Davies is a Welshman of about 50: probably the son of a small farmer or tradesman in some country district. As though he speaks English accurately, he is not fluent in the language, and is probably much more at home in his own.

Of the people round his chapel Mr D. knows nothing. The services are in Welsh, and therefore of course there is no attempt to bring in others. The congregation is drawn from an area of some ten or more square miles: there is no chapel nearer than New North Road in the south, and none to the north: the people come from as far as Infield, Edmonton etc.

Besides Mr D. about 12 members of the Church visit, and some 30 or 40 teach in the Sunday Schools which are held at four centres.

Church with room attached: and rooms hired for Sunday Schools.

The usual morning and evening services on

Persons employed.

Philips.

Services.

Sunday with Sunday School, which is more of a service than a school, in the afternoon. The congregation in the morning is about 90, in evening about 250, and about 200 come in the afternoon remaining for the evening service. Few come in the morning because of the distance. The church members are 350. The people are chiefly working class, ^{and shop assistants} with a sprinkling of tradesmen (one of the Jones Brothers is a Deacon); most of them are young men and women.

How many Welsh there are in the district for which he is more or less responsible Mr D. does not know, and therefore cannot estimate the influence of his church; he thinks however that the Welsh working classes in London attend church much better than the English, who as far as his observation goes do not go at all. There is a Welsh population in London of about 70000 and 26 churches which have about 10000 members, but many, especially when they marry an English girl, go to an English church.

Most of the Welsh who come to London come

Social Agencies.

Visiting.

Education.

from country districts, when they have nearly always been chapel goers. If they are church members their minister writes to Mr Davis to announce their coming, and he at once calls, as owing to the temptations of London life it is more important to secure them at once.

Apart from its spiritual ministrations the Church is looked upon as a social centre and something is going on almost every night, entirely confined of course to church members and their Welsh friends; literary society, debates, social meetings, concerts etc.

There is no attempt to visit the whole congregation; they are too scattered; but a book is kept in which members enter the names of those who for any reason wish to be visited and Mr D. and the 12 visitors visit them. In addition Mr D. visits those who are lax in attendance, but often finds it difficult to trace them, as they more often give notice.

There is no Sunday School for children, but for adults only, held at four centres; in a

Relief.

39
Welsh Church all the members are supposed to attend the School.

About £50 a year is spent in relieving needy members of the church; none would ever be allowed to apply to the parish for relief. But Mr. D. seemed to think that his people were rather close-fisted and less ready to assist one another than the English working class; he has been much struck by the charity of the English poor. "We go to church better" he said "but I don't think we help one another so readily as even the drunken and dissipated among the English help their neighbours". This is partly perhaps a racial characteristic, but partly due to the fact that the Welshman comes to London to make money. Even though he lives and dies there he never looks upon London as his home. Home to him is always the quiet village among the Welsh mountains where his people still live, and his longing is "then to return and die at home at last".

Rev. W. Turner
Primitive Methodist

The Holloway Circuit

- (1) St Anne's parish
- (2) St Peter's ---
- (3) St Mary's ---

Personal Note

G.A.
Nov 27/97

17
4
Rev W. Turner. 30 Woodstock Road
Finchley Park St. 2

Mr Turner is the Minister in charge of the Primitive Methodist Holloway Circuit. This includes 5 preaching stations: (1) Durham Road Chapel, (2) Dartmouth Park Chapel, (3) Hornsey Rise Mission, East Finchley and Woodberry Mission. Of these, the first three are in Upper Holloway & the other two outside the London boundary.

Mr Turner is an elderly, hair turning grey. A little whisker under chin, otherwise clean shaven. Kindly face, which was quite pleasant when he smiled as he frequently did. A regular homely man of the people, & not at all the man one would take for a minister. His conversation proved him to be a shrewd tactful countryman. He comes from North Staffordshire and has only been in London a little over a year.

He did not complain of being overworked but seemed to take it as a matter of course, his trouble being that the practical impossibility of overseeing the five places efficiently. He preaches as a rule 4 nights a week & 3 or 4 times every Sunday besides a monthly lecture.

London People not self reliant

Character of the People

Character of Congregations

43
Tomorrow (Sunday) he will preach at East Finchley, walk back to dinner, address the children at Durham R^d in the afternoon & preach at Woodberry Town in the evening. However he does not regard it as so hard as in country circuits where long distances have to be walked.

The people here are not ~~so~~ taught to be self reliant: they depend too much on the minister and some seek office for its own sake. In country places, the local preachers & members know they have got the work to do & they do it. Have some first class laymen, well informed & good preachers in the country but few in London. In London it is the rush, rush, rush of business. One or two of his best men don't get home until 9 or 10 & have little time to prepare.

Near Durham Road the people are poor working class; many of a low type. Near Dartmouth Park they are also working people but rather better than Durham Road. To north of Hounsey R^d station a respectable people but south of that poor again.

Congregations at all the chapels are working class, both men & women. A few better off (a builder for instance who has offered £500 toward a new chapel) are conspicuous.

At Hornsey Rise they have a large number of servants.

Minister paid. 23 lay preachers of whom 17 belong to Upper Holloway. 13 class leaders, 6 stewards. Sunday school teachers & mission workers

Durham Road Chapel (seats 300).

Dartmouth Park (Anatola Rd) Chapel (seats 400)

Hornsey Rise Mission (seats 150) - a shop change
Hornsey Road

Persons Employed

Buildings Used.

Meetings Held

PLACES.	TIME.	
DURHAM ROAD. 50	11.0	Attendance 50
SEVEN SISTERS' ROAD. 120	6.30	" 120
Open Air Mission 27. 2. 6. 6	6.0	By Mission Band. Mainly men & S.S. teachers.
Wednesday, Preaching. 6. 8.0	8.0	small, 15 to 20 members.
Friday, Christian Endeavour .. 15. 20.	8.0	
EAST FINCHLEY.	11.0	
"	6.30	
Open Air Mission	5.45	
Tuesday, Preaching	7.30	
Thursday, Prayer Meeting	7.30	
DARTMOUTH PARK. 75	11.0	Attendance 75
ANATOLA ROAD 250	6.30	" 250
Open Air Mission 20.....	5.30	Mission Band 20 members.
Thursday, Preaching .. 40.	7.45	" 40
Friday, Christian Endeavour ..	7.0	
WOODBERRY.	11.0	
St. JOHN'S ROAD.	6.30	
Open Air Mission	5.45	
Tuesday, Preaching	8.0	
Friday, Christian Endeavour ..	8.0	
HORNSEY RISE 40 150	11.0	Attendance 40
MISSION - STATION PARADE	6.30	" 150. One of the best services.
Open Air Mission 1. 45.....	5.45	Mission Band. 15 members.
Wednesday, Preaching	8.0	
Friday, Christian Endeavour ..	7.30	30 or 35 members. food society.

Sunday School

Thursday, December 9.

One Hundred Views of the Holy Land.

Zimelighit Entertainment

Primitive Methodist Chapel,

—* DURHAM ROAD. *—

HOLLOWAY CIRCUIT.



2/6 per 1000. 1000 assorted, with notice of meeting printed on back, 4/6: 500, 3/-, prepaid, of W. Ward, Printer, Greyfriar Buildings, Nothing-ham. Temperance series same price.

"God commendeth His love toward us, in that while we were yet sinners, Christ died for us."—ROM. v. 8.
"Hereby perceive we the love of God, because He laid down His life for us."—1 JOHN III. 16.
"Greater love hath no man than this, that a man should lay down his life for his friends."—JOHN XV. 13.

Sunday School are small: Statistics are as under: taken from the P.M. official returns.

	On Books.		Attendance	
	Teacher	Scholars	Teacher	Scholar
Durham Road.	35	179	M. 12. A. 22	M. 81. A. 120
Dartmouth Park	24	173	A 17	A 130
Hornsey Rise Mission. (Only recently started)	6	About 30	—	at 20

Social agencies include

A Ladies Working Meeting (Wed) at Durham Road.

Bands of Hope. Durham Rd 179 members, Dartmouth Park 158.

Occasional lectures & entertainments. The following extract from Circuit Plan shows the special engagements for the Oct-Dec. quarter.

- DARTMOUTH PARK.**
- Oct. 10 School Repetition Services, by A. Ward and Rev. W. Turner.
 - " 11 Public Tea Meeting, No. 1 and others.
 - " 17 Evangelistic Services, Messrs. J. Thorne and W. H. Tucker. Monday, No. 7; Tuesday, No. 20; Wednesday, No. 21; Thursday, No. 13; Friday, Testimony Meeting. Sunday, 24th, Messrs. Stather and Jackson.
 - " 25 Public Tea Meeting, and Lecture by Rev. W. Turner. Subject: "True Manhood, its Characteristics, and How to Attain it; an Appeal to Young Men."
 - Nov. 21 Evangelistic Services, by Messrs. Pountney and Smith. Monday, No. 20; Tuesday, No. 3; Wednesday, No. 16; Thursday, No. 23; Friday, Testimony Meeting. Sunday, 28th, by Messrs. Plumb and Knight.
 - Dec. 12 Special Sermons for Trust Fund, by Rev. W. Turner.
 - " 31 Coffee Supper at 9-30. Watch-Night Service at 11, Nos. 9, 13, 20, 23.

- DURHAM ROAD.**
- Oct. 20 Lecture by Rev. W. Turner. Subject: "Absalom, the petted son of David; a lesson to parents, and a warning to young men."
 - " 31 School Anniversary, by the Rev. W. E. Crombie, of Forest Hill.
 - Nov. 1 Public Tea Meeting, Rev. W. E. Crombie, Nos. 1, 2, 10, 12.
 - " 17 Lecture by Rev. W. Turner. Subject: "On the Threshold; or the Last Words of Great Men."
 - " 28 Special Sermons for Trust Funds.
 - " 29 Public Tea Meeting, No. 1 and others.
 - Dec. 31 Coffee Supper at 9-30. Watch-Night Service at 11, Nos. 2, 12, 17.
 - Jan. 3, 1898 Lecture by Rev. W. Turner. Subject: "Lamech's Song to his Wives; or, The Progress of Crime."

- HORNSEY RISE MISSION.**
- Oct. 4 Public Entertainment, by Mr. R. Stather and Friends.
 - " 17 Special Sermons, by Rev. C. Jupe, of High Wycombe.
 - " 18 Public Tea, Rev. C. Jupe, No. 1, and others.
 - Nov. 7 Evangelistic Services, by Mr. G. Plummer. Monday, No. 22; Tuesday, No. 11; Wednesday, No. 24; Thursday, No. 10; Friday, Testimony Meeting. Sunday, 14th, by Mr. S. S. Brush.
 - " 24 Lecture by Rev. W. Turner. Subject: "The Life and Times of Savonarola, the Italian Reformer."
 - Dec. 31 Coffee Supper at 9-30. Watch-Night Service at 11, conducted by No. 1.

Sunday

Thursday, December 9.

One Hundred Views of the Holy Land.

Evening Entertainment

Primitive Methodist Chapel,

DURHAM ROAD.

HOLLOWAY CIRCUIT.

On Wednesday Evening, November 17th,

THE

REV. W. TURNER

Will (D.V.) deliver the

Third of his series of Lectures

On behalf of the Trust Funds. Subject—

"On the Threshold; or, the Last Words of Great Men."

Chair to be taken at 7.45, by

Mr. W. H. TUCKER

(CIRCUIT STEWARD).

Collection at the close.

Please favour us with your presence.

Sunday School are small: Statistics are as under: taken from the P.M. official returns.

Table with columns: Location, On Books (Teacher, Scholars), Attendance (Teacher, Scholars). Rows: Durham Road, Dartmouth Park, Hornsey Rise Mission.

Social agencies include

A Ladies Working Meeting (Wed) at Durham Road.

Bands of Hope. Durham Rd 179 members, Dartmouth Park 158. Occasional lectures & entertainments. The following extract from Circuit Plan shows the special engagements for the Oct-Dec. quarter

DARTMOUTH PARK.

- Oct. 10 School Repetition Services, by A. Ward and Rev. W. Turner.
Oct. 11 Public Tea Meeting, No. 1 and others.
Oct. 17 Evangelistic Services, Messrs. J. Thorne and W. H. Tucker.
Nov. 25 Public Tea Meeting, and Lecture by Rev. W. Turner.
Nov. 21 Evangelistic Services, by Messrs. Pountney and Smith.
Dec. 12 Special Sermons for Trust Fund, by Rev. W. Turner.
Dec. 31 Coffee Supper at 9-30. Watch-Night Service at 11, Nos. 9, 13, 20, 23.

DURHAM ROAD.

- Oct. 20 Lecture by Rev. W. Turner. Subject: "Absalom, the petted son of David; a lesson to parents, and a warning to young men."
Oct. 31 School Anniversary, by the Rev. W. E. Crombie, of Forest Hill.
Nov. 1 Public Tea Meeting, Rev. W. E. Crombie, Nos. 1, 2, 10, 12.
Nov. 17 Lecture by Rev. W. Turner. Subject: "On the Threshold; or the Last Words of Great Men."
Nov. 28 Special Sermons for Trust Funds.
Nov. 29 Public Tea Meeting, No. 1 and others.
Dec. 31 Coffee Supper at 9-30. Watch-Night Service at 11, Nos. 2, 12, 17.
Jan. 3, 1898 Lecture by Rev. W. Turner. Subject: "Lamech's Song to his Wives; or, The Progress of Crime."

HORNSEY RISE MISSION.

- Oct. 4 Public Entertainment, by Mr. R. Stather and Friends.
Oct. 17 Special Sermons, by Rev. C. Jupe, of High Wycombe.
Oct. 18 Public Tea, Rev. C. Jupe, No. 1, and others.
Nov. 7 Evangelistic Services, by Mr. G. Plummer. Monday, No. 22; Tuesday, No. 11; Wednesday, No. 24; Thursday, No. 10; Friday, Testimony Meeting. Sunday, 14th, by Mr. S. S. Brush.
Nov. 24 Lecture by Rev. W. Turner. Subject: "The Life and Times of Savonarola, the Italian Reformer."
Dec. 31 Coffee Supper at 9-30. Watch-Night Service at 11, conducted by No. 1.

Sunday School

2/6 per 1000. 1000 assorted, with notice of meeting printed on back, 4/6: 500, 3/-, prepaid, of W Ward, Printer, Greyfriar Buildings, Notting-

ham. Temperance series same price.

"Greater love hath no man than this, that a man should lay down his life for his friends."—JOHN xv. 13.

"Hereby perceive we the love of God, because He laid down His life for us."—I JOHN iii. 16.

"God commendeth His love toward us, in that while we were yet sinners, Christ died for us."—ROM. v. 8.

But in reality these things are the result of man's own wickedness. God wants men to escape from pain, suffering, and poverty, and many other evils. He sent His Son into the world, and the gift of eternal life in the future. For this purpose Christ lived and died. The life and death of Christ are the greatest proof that God loved and still loves the world.

Why are so many people poor? And because pain and suffering and poverty abound, they will not believe in God's love.

it is true all the same. Many say if God loved the world, why is there so much pain and suffering—

ANY people will not believe that God loves them, but

why are so many people poor? And because pain and suffering and poverty abound, they will not believe in God's love.

it is true all the same. Many say if God loved the world, why is there so much pain and suffering—

ANY people will not believe that God loves them, but

why are so many people poor? And because pain and suffering and poverty abound, they will not believe in God's love.

it is true all the same. Many say if God loved the world, why is there so much pain and suffering—

ANY people will not believe that God loves them, but

why are so many people poor? And because pain and suffering and poverty abound, they will not believe in God's love.

it is true all the same. Many say if God loved the world, why is there so much pain and suffering—

ANY people will not believe that God loves them, but

why are so many people poor? And because pain and suffering and poverty abound, they will not believe in God's love.

Social

Sunday School are small: Statistics are as under: taken from the P.M. official returns.

	On Books.		Attendance	
	Teacher	Scholars	Teacher	Scholar
Durham Road	35	179	M 12. A 22	M. 81. A 120
Dartmouth Park	24	173	A 17	A 130
Hornsey Rise Mission. (only recently started)	6	About 30	—	at 20

Social agencies include

A Ladies Working Meeting (Wed) at Durham Road.

Bands of Hope. Durham R 179 members, Dartmouth Park 158.

Occasional lectures & entertainments. The following extract from Circuit Plan shows the special engagements for the Oct-Dec. quarter.

- DARTMOUTH PARK.**
- Oct. 10 School Repetition Services, by A. Ward and Rev. W. Turner.
 - " 11 Public Tea Meeting, No. 1 and others.
 - " 17 Evangelistic Services, Messrs. J. Thorne and W. H. Tucker. Monday, No. 7; Tuesday, No. 20; Wednesday, No. 21; Thursday, No. 13; Friday, Testimony Meeting. Sunday, 24th, Messrs. Stather and Jackson.
 - " 25 Public Tea Meeting, and Lecture by Rev. W. Turner. Subject: "True Manhood, its Characteristics, and How to Attain it; an Appeal to Young Men."
 - Nov. 21 Evangelistic Services, by Messrs. Pountney and Smith. Monday, No. 20; Tuesday, No. 3; Wednesday, No. 16; Thursday, No. 23; Friday, Testimony Meeting. Sunday, 28th, by Messrs. Plumb and Knight.
 - Dec. 12 Special Sermons for Trust Fund, by Rev. W. Turner.
 - " 31 Coffee Supper at 9-30. Watch-Night Service at 11, Nos. 9, 13, 20, 23.

- DURHAM ROAD.**
- Oct. 20 Lecture by Rev. W. Turner. Subject: "Absalom, the petted son of David; a lesson to parents, and a warning to young men."
 - " 31 School Anniversary, by the Rev. W. E. Crombie, of Forest Hill.
 - Nov. 1 Public Tea Meeting, Rev. W. E. Crombie, Nos. 1, 2, 10, 12.
 - " 17 Lecture by Rev. W. Turner. Subject: "On the Threshold; or the Last Words of Great Men."
 - " 28 Special Sermons for Trust Funds.
 - " 29 Public Tea Meeting, No. 1 and others.
 - Dec. 31 Coffee Supper at 9-30. Watch-Night Service at 11, Nos. 2, 12, 17.
 - Jan. 3, 1898 Lecture by Rev. W. Turner. Subject: "Lamech's Song to his Wives; or, The Progress of Crime."

- HORNSEY RISE MISSION.**
- Oct. 4 Public Entertainment, by Mr. R. Stather and Friends.
 - " 17 Special Sermons, by Rev. C. Jupe, of High Wycombe.
 - " 18 Public Tea, Rev. C. Jupe, No. 1, and others.
 - Nov. 7 Evangelistic Services, by Mr. G. Plummer. Monday, No. 22; Tuesday, No. 11; Wednesday, No. 24; Thursday, No. 10; Friday, Testimony Meeting. Sunday, 14th, by Mr. S. S. Brush.
 - " 24 Lecture by Rev. W. Turner. Subject: "The Life and Times of Savonarola, the Italian Reformer."
 - Dec. 31 Coffee Supper at 9-30. Watch-Night Service at 11, conducted by No. 1.

Sunday

Social

Primitive Methodist Chapel,
Durham Road, Seven Sisters Road, Holloway, N.

Admit Bearer to the Grand
Miscellaneous - -
- - Entertainment

On Monday, November 29th, 1897.

MADAME LOWE
HAS KINDLY CONSENTED TO SING
"THE BETTER LAND."

THE PRIZE BANNER
Awarded to the DURHAM ROAD SUNDAY SCHOOL CHOIR by the
Sunday School Union, will be
UNFURLED,
AND SELECTIONS SUNG BY THE PRIZE CHOIR.

Pianists - Madame LOWE, Miss TAYLOR, and Miss TACKLEY.
Cornet - Mr. METCALF.

Doors open at 7.30. Commence at 8.
ADMISSION FREE
COLLECTION FOR REDUCTION OF CHAPEL DEBT.

Please use this Programme if possible; if not, kindly hand to
a friend who can.

Sunday School are small: Statistics are as under:
taken from the P.M. official returns.

	On Books.		Attendance	
	Teacher	Scholars	Teacher	Scholar
Durham Road	35	179	M 12. A 22	M. 81. A 120
Dartmouth Park	24	173	A 17	A 130
Hornsey Rise Mission. (only recently started)	6	About 30	-	at 20

Social agencies include
A Ladies Working Meeting (Wed) at Durham Road.
Bands of Hope: Durham R 179 members, Dartmouth Park 158.
Occasional lectures & entertainments. The following
extract from Circuit Plan shows the special engagements
for the Oct-Dec. quarter

- DARTMOUTH PARK.**
- Oct. 10 School Repetition Services, by A. Ward and Rev. W. Turner.
 - " 11 Public Tea Meeting, No. 1 and others.
 - " 17 Evangelistic Services, Messrs. J. Thorne and W. H. Tucker. Monday, No. 7; Tuesday, No. 20; Wednesday, No. 21; Thursday, No. 13; Friday, Testimony Meeting. Sunday, 24th, Messrs. Stather and Jackson.
 - " 25 Public Tea Meeting, and Lecture by Rev. W. Turner. Subject: "True Manhood, its Characteristics, and How to Attain it; an Appeal to Young Men."
 - Nov. 21 Evangelistic Services, by Messrs. Pountney and Smith. Monday, No. 20; Tuesday, No. 3; Wednesday, No. 16; Thursday, No. 23; Friday, Testimony Meeting. Sunday, 28th, by Messrs. Plumb and Knight.
 - Dec. 12 Special Sermons for Trust Fund, by Rev. W. Turner.
 - " 31 Coffee Supper at 9-30. Watch-Night Service at 11, Nos. 9, 13, 20, 23.

- DURHAM ROAD.**
- Oct. 20 Lecture by Rev. W. Turner. Subject: "Absalom, the petted son of David; a lesson to parents, and a warning to young men."
 - " 31 School Anniversary, by the Rev. W. E. Crombie, of Forest Hill.
 - Nov. 1 Public Tea Meeting, Rev. W. E. Crombie, Nos. 1, 2, 10, 12.
 - " 17 Lecture by Rev. W. Turner. Subject: "On the Threshold; or the Last Words of Great Men."
 - " 28 Special Sermons for Trust Funds.
 - " 29 Public Tea Meeting, No. 1 and others.
 - Dec. 31 Coffee Supper at 9-30. Watch-Night Service at 11, Nos. 2, 12, 17.
 - Jan. 3, 1898 Lecture by Rev. W. Turner. Subject: "Lamech's Song to his Wives; or, The Progress of Crime."

- HORNSEY RISE MISSION.**
- Oct. 4 Public Entertainment, by Mr. R. Stather and Friends.
 - " 17 Special Sermons, by Rev. C. Jupe, of High Wycombe.
 - " 18 Public Tea, Rev. C. Jupe, No. 1, and others.
 - Nov. 7 Evangelistic Services, by Mr. G. Plummer. Monday, No. 22; Tuesday, No. 11; Wednesday, No. 24; Thursday, No. 10; Friday, Testimony Meeting. Sunday, 14th, by Mr. S. S. Brush.
 - " 24 Lecture by Rev. W. Turner. Subject: "The Life and Times of Savonarola, the Italian Reformer."
 - Dec. 31 Coffee Supper at 9-30. Watch-Night Service at 11, conducted by No. 1.

--- Programme. ---

PART I.

Opening March ... "Sinfonia"
 STRING BAND and PIANO.

Recitation ... Selected
 Mr. P. DUNHAM.

Solo ... "Four Jolly Smiths"
 Mr. COOK.

Duet ... "Beautiful Hands"
 Miss TURNER and Master HOWARD TURNER.

Recitation ... "The Night of the Pantomime"
 Miss KNIGHT.

Solo ... "The Holy City"
 Mrs. HOWARD HOOPER.

Recitation ... "The Lifeboat"
 Miss TURNER.

Solo ... "Daddy"
 Miss LILY SAVAGE.

Violin Solo ... "The Broken Melody"
 Mr. A. STATHER.

Unfurling the Banner, Mr. Busbridge.

Selections by Prize Choir.

Collection. Interval of Ten Minutes.

PART II.

March ... Selected
 STRING BAND and PIANO.

Solo ... "The Better Land"
 Madame LOWE.

Recitation ... "The Sister's Story"
 Miss SILBY.

Cornet Solo ... "O Rest in the Lord"
 Mr. METCALF.

Solo ... "The Flight of Ages"
 Mrs. ROOKE.

Solo ... "The Sons of England"
 Mr. COOK.

Duet ... "Excelsior"
 Mr. C. BUSBRIDGE and Mr. T. PEDDER.

Chorus ... Selected
 FULL CHORUS.

Solo ... "The Benediction"
 Mrs. HOWARD HOOPER.

Subject to Alterations.

Sunday School are small: Statistics are as under:
 taken from the P.M. official returns.

	On Books.		Attendance	
	Teacher	Scholars	Teacher	Scholar
Durham Road	35	179	M 12. A 22	M. 81. A 120
Dartmouth Park	24	173	A 17	A 130
Hornsey Rise Mission (only recently started)	6	About 30	-	at 20

Social agencies include

A Ladies Working Meeting (Wed) at Durham Road.

Bands of Hope, Durham Rd 179 members, Dartmouth Park 158.

Occasional lectures & entertainments. The following extract from Circuit Plan shows the special engagements for the Oct-Dec. quarter

DARTMOUTH PARK.

- Oct. 10 School Repetition Services, by A. Ward and Rev. W. Turner.
- " 11 Public Tea Meeting, No. 1 and others.
- " 17 Evangelistic Services, Messrs. J. Thorne and W. H. Tucker. Monday, No. 7; Tuesday, No. 20; Wednesday, No. 21; Thursday, No. 13; Friday, Testimony Meeting. Sunday, 24th, Messrs. Stather and Jackson.
- " 25 Public Tea Meeting, and Lecture by Rev. W. Turner. Subject: "True Manhood, its Characteristics, and How to Attain it; an Appeal to Young Men."
- Nov. 21 Evangelistic Services, by Messrs. Pountney and Smith. Monday, No. 20; Tuesday, No. 3; Wednesday, No. 16; Thursday, No. 23; Friday, Testimony Meeting. Sunday, 28th, by Messrs. Plumb and Knight.
- Dec. 12 Special Sermons for Trust Fund, by Rev. W. Turner.
- " 31 Coffee Supper at 9-30. Watch-Night Service at 11, Nos. 9, 13, 20, 23.

DURHAM ROAD.

- Oct. 20 Lecture by Rev. W. Turner. Subject: "Absalom, the petted son of David; a lesson to parents, and a warning to young men."
- " 31 School Anniversary, by the Rev. W. E. Crombie, of Forest Hill.
- Nov. 1 Public Tea Meeting, Rev. W. E. Crombie, Nos. 1, 2, 10, 12.
- " 17 Lecture by Rev. W. Turner. Subject: "On the Threshold; or the Last Words of Great Men."
- " 28 Special Sermons for Trust Funds.
- " 29 Public Tea Meeting, No. 1 and others.
- Dec. 31 Coffee Supper at 9-30. Watch-Night Service at 11, Nos. 2, 12, 17.
- Jan. 3, 1898 Lecture by Rev. W. Turner. Subject: "Lamech's Song to his Wives; or, The Progress of Crime."

HORNSEY RISE MISSION.

- Oct. 4 Public Entertainment, by Mr. R. Stather and Friends.
- " 17 Special Sermons, by Rev. C. Jupe, of High Wycombe.
- " 18 Public Tea, Rev. C. Jupe, No. 1, and others.
- Nov. 7 Evangelistic Services, by Mr. G. Plummer. Monday, No. 22; Tuesday, No. 11; Wednesday, No. 24; Thursday, No. 10; Friday, Testimony Meeting. Sunday, 14th, by Mr. S. S. Brush.
- " 24 Lecture by Rev. W. Turner. Subject: "The Life and Times of Savonarola, the Italian Reformer."
- Dec. 31 Coffee Supper at 9-30. Watch-Night Service at 11, conducted by No. 1.

Thursday, December 9.

ON

One Hundred Views of the Holy Land.

WITH

Timeight Entertainment

SEE BILLS.

On New Year's Eve.

WILL BE GIVEN

AT DURHAM ROAD

Next Grand Concert

Sunday Schools

Social Agencies.

Primitive Methodist Chapel,

*** DURHAM ROAD. ***

HOLLOWAY CIRCUIT.



Please favour us with your presence

ham. Temperance series same price.
2/6 per 1000. 1000 assorted, with notice of meeting printed on back, 4/6:
500, 3/-, prepaid, of W Ward, Printer, Greyfriar Buildings, Notting-



lay down his life for his friends."—JOHN XV. 13.

"Greater LOVE hath no man than this, that a man should

down His life for us."—I JOHN III. 16.

"Hereby perceive we the LOVE of God, because He laid

were yet sinners, Christ died for us."—ROM. V. 8.

"God commendeth His LOVE toward us, in that while we

Beside these the Society classes meet each week. See list below

Social Classes
Society Classes

Church Membership

Visitation

Charitable Relief

SOCIETY CLASSES.

Places and Leaders.	Time of Meeting.	No. of M'brs.	Renewal of Tickets.
DURHAM ROAD—			
Mrs. Turner ..	Tuesday, 8 p.m.	15	Nov. 17th.
W. H. Tucker ..	Thursday, 8 p.m.	15	"
E. Busbridge ..	Monday, 8 p.m.	16	"
		<hr/>	
EAST FINCHLEY—			
H. Williams ..	Tuesday, 8 p.m.	15	Nov. 16th.
J. Brightman ..	" "	15	"
		<hr/>	
DARTMOUTH PARK—			
J. Austin ..	Sunday, 3 p.m.	19	Nov. 18th.
Mrs. Lilly ..	" 8 p.m.	19	"
W. Turner ..	Thursday, 7 p.m.	20	"
J. Seabrook ..	Wednesday, 8 p.m.	28	"
R. Wheatley ..	Friday, 8 p.m.	16	"
Mrs. West ..	Wednesday, 6.30 p.m.	8	"
		<hr/>	
WOODBERRY—			
S. Bysouth ..	Wednesday, 8 p.m.	18	Nov. 23rd.
A. Ward ..	Thursday, 8 p.m.	39	"
W. Plumb ..	Friday, 7 p.m.	17	"
		<hr/>	
HORNSEY RISE MISSION			
C. Tinworth ..	Monday, 8 p.m.	18	Nov. 24th.
Mrs. Tinworth ..	Tuesday, 7.30 p.m.	38	"
R. Brown ..	Thursday, 8 p.m.	15	"
Mrs. Crafts ..	Wednesday, 8 p.m.	2	"
		<hr/>	
		73	
		<hr/>	
		333	

Membership
Durham Road 46
Dartmouth Park 110
Hornsey Rise 73

229

Nobody does it much, but it is part of the leader's duty to do it. Mr J. calls upon ^{of the member.} some every day but of course cannot give much time to it. When he is planned at a place will go early & call upon some of the members before hand.

Charitable Relief not much. Communion fund but not only about £5. One local preacher, is supported - paid work.

Other Religious Agencies

Newcourt Chapel

St Peter's Church

Hornsey Rise Mission

A split from Durham Road

Not much done in Durham Road by other bodies. New Court has a mission in Lennox Road which is active - Have both men & money.

In Dartmouth Park, St Peter's Church. There's glory is in the Men's Meeting on Sunday afternoon. Don't hear of anything else. Scores go to that meeting, who go nowhere else. Several of their members attend the meeting

Practically no co-operation. Two of Mr T's churches are on Free Church Council list.

The Mission at Hornsey Rise arose out of a split at Durham Rd. When Mr J. came to a feud ~~was~~ existed between two parties there. As he could not reconcile them, he thought it best to find another place for one party so the young people - mainly members of the Mission Band went to Hornsey Rise & have done & are doing well. Still Mr J. recognises that it would have been better to have worked together if it had been possible.

Prospects for future

Income of Circuit

Local Preachers

Mr Turner has brighter hopes & brighter prospects now than he has had yet. The societies are growing & he believes they will have a rise next year. Things are working harmoniously now & the churches are in a condition to grow.

Income of the Circuit is as under

	Local fund.	Sunday School	Total
Durham Road	118	70	£ 188
Dartmouth Park	98	55	£ 153
Hornsey Rise	100	10	£ 110
East Finchley	30	10	£ 40
Woodberry	21	32	£ 53
			<u>£ 544</u>

Asking Replying to a question as to the local preachers, Mr T said that whilst some of them were well received, the people preferred the minister but it depended entirely upon the man. He had known some people walk out when they saw an unpopular man was taking the service. Some went to other chapels when they saw by the plan that a speaker they did not care for was taking the service.

It will be seen the work of the each church is small & collectively not great. They are however entirely working class communities and are supported by the working men. Occasionally they

Môr o gân  yw Cymru i Gyd.

PRIMITIVE METHODIST CHAPEL,
DARTMOUTH PARK HILL, N.

PROGRAMME

OF
GRAND
EVENING CONCERT

Under the direction of

MR. LLOYD WILLIAMS,

GIVEN BY

WELSH ARTISTES

ON

Thursday, November 18th, 1897,

Commencing at 7.45 sharp.

Chair to be
taken by



PETER JONES, Esq.

(Chelsea).

Supported by—OWEN OWEN, Esq. Rev. W. TURNER,
WILLIAM P. JONES, Esq., and other gentlemen.

Programmes **Two pence each.**

Pianoforte kindly lent by Messrs John Brinsmead & Son, Wigmore
Street, and Kentish Town.

Perfumed by EUGENE RIMMEL, 96, Strand.

ORCHARD, Printer, 64, Marlborough Road, N.

55
they get a little outside help us when the Welsh chapel
people gave the concert (see other side) otherwise they get little
help from outside. As usual with Methodists, they
have a debt - £1330 on Durham Rd which they are now
trying to reduce.

Mrs ~~Jones~~ ^{Turner} seems to be working successfully
& altho' heavily handicapped and his influence is certainly
good ~~all~~ even if too widely diffused. His quiet humour
and strength of character enable him to keep control
of the different places for which he is responsible.



PROGRAMME.



PART I.

DUET "Flow, gently Deva" *Parry*
Messrs. LLOYD WILLIAMS & DAVID JONES.

SONG "My Dreams" *Tosti*
Mr. J. ROSSLYN HOWELL.

SONG "The Swallows" *Cowen*
Miss LIZZIE AUSTIN, R.A.M.

RECITATION "The Deacon's Story" *Overton*
Mr. D. EGRYN OWEN.

SONG "The Enchantress" *Hatton*
Miss LIZZIE TEIFY DAVIES, R.A.M.

SONG "The Flight of Ages" *Cowen*
Mr. LLOYD WILLIAMS.

SONG "The Storm-fiend" *Roedel*
Mr. DAVID JONES, R.A.M.

... .. "The Soldier's Chorus" *Gounod*
THE CASTLE STREET MALE VOICE CHOIR.
(Conductor: - Mr. RICHARD GRIFFITH).

SILVER COLLECTION.

Accompanist: - Miss ALICE PRYCE JONES.

PART II.

DUET "Tell me gentle stranger" *Parry*
Miss LIZZIE TEIFY DAVIES & Mr. DAVID JONES.

SONG "Big Ben"
Mr. H. W. PRITCHARD.

SONG "May Morning" *Denza*
Miss LIZZIE AUSTIN, R.A.M.

RECITATION "The Owl Critic" (by desire) *Field*
Mr. D. EGRYN OWEN.

SONG "The Promise of Life" *Cowen*
Miss LIZZIE TEIFY DAVIES, R.A.M.

SOLO "Honour and Arms" *Handel*
Mr. DAVID JONES, R.A.M.

MADRIGAL "Lovely Maiden!" *Pughe Evans*
THE CASTLE STREET MALE VOICE CHOIR.

WELSH NATIONAL ANTHEM "Mae Hen wlad fy Nhadau"

they
prop
hel
La
try

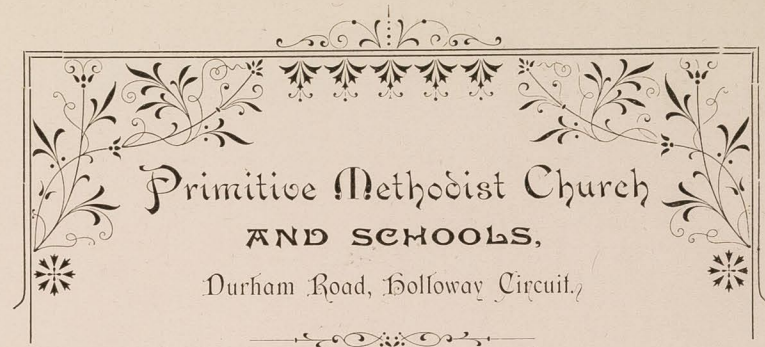

Primitive Methodist Church AND SCHOOLS.

Durham Road, Holloway Circuit.

Dear Friend,
The Trustees of the above Church and Schools beg to kindly appeal on behalf of a debt of £1,330, to meet the interest of which, with current expenses, is found to be a burden that our small society is unable to bear without assistance.

For some months past, our ladies have been holding sewing meetings, and from contributions and private sales of goods, have given us £20. Our Sunday School Teachers, Choir, Band of Hope, and Christian Endeavour are doing their best to help us to reduce the debt.

We now take the liberty of appealing to the Christian public, on whose practical sympathy we confidently rely; and any donations direct to the Fund, or contributions to the Sewing Committee, will be thankfully received by the following Trustees, and friends.

- REV. W. TURNER, Minister, 30, Woodstock Road.
- MR. W. H. TUCKER, Treasurer, 163, Isledon Road.
- MR. T. SAVAGE, Secretary, 20, Horsell Road.
- MR. G. ATKINS, 1, Woodstock Road.
- MR. E. N. BUSBRIDGE, School Superintendent, 1, Clifton Terrace.
- MR. J. MABLY, School Secretary, 57, Thorpdale Road.
- MR. A. DUNHAM, 200, Stroud Green Road.
- MR. T. BARRIER, 117, Gillispie Road.
- MR. B. OWEN, 1 Travers Road.
- MR. J. WESTMORELAND, 27, Athelston Road
- MR. C. BUSBRIDGE, 1, Woodstock Road.
- MR. C. WREN, 127, Effingham Road.
- MR. J. JACKSON, 3, Park Hall Place, E. Finchley.
- MR. W. WEBB, 175, Isledon Road.

- MRS. W. TURNER, President of the Sewing Committee.
- MRS. C. BUSBRIDGE, Treasurer of the Sewing Committee.
- MRS. W. H. TUCKER, Secretary of the Sewing Committee.

chapel
get little
st. they
by are now

cessfully
is certainly
et human
p control
sible.

fa
for
an
of

Môr o gân  yw Cymru i Gyd.

PRIMITIVE METHODIST CHAPEL,
DARTMOUTH PARK HILL, N.

PROGRAMME

OF
GRAND
EVENING CONCERT

Under the direction of
MR. LLOYD WILLIAMS,

GIVEN BY
* WELSH * ARTISTES *

ON
Thursday, November 18th, 1897,
Commencing at 7 45 sharp.

Chair to be
taken by



PETER JONES, Esq.

(Chelsea).

Supported by—OWEN OWEN, Esq. Rev. W. TURNER,
WILLIAM P. JONES, Esq., and other gentlemen.

Programmes **Two pence each.**

Pianoforte kindly lent by Messrs John Brinsmead & Son, Wigmore
Street, and Kentish Town.

Perfumed by EUGENE RIMMEL, 96, Strand.

ORCHARD, Printer, 64, Marlborough Road, N.

they
prop
hel
la
try

fa
fo
an
of

Primitive Methodist Church
AND SCHOOLS,

Durham Road, Holloway Circuit.

Dear Friend,

The Trustees of the above Church and Schools beg to kindly appeal on behalf of a debt of £1,330, to meet the interest of which, with current expenses, is found to be a burden that our small society is unable to bear without assistance.

For some months past, our ladies have been holding sewing meetings, and from contributions and private sales of goods, have given us £20. Our Sunday School Teachers, Choir, Band of Hope, and Christian Endeavour are doing their best to help us to reduce the debt.

We now take the liberty of appealing to the Christian public, on whose practical sympathy we confidently rely; and any donations direct to the Fund, or contributions to the Sewing Committee, will be thankfully received by the following Trustees, and friends.

REV. W. TURNER, Minister, 30, Woodstock Road.
MR. W. H. TUCKER, Treasurer, 163, Isledon Road.
MR. T. SAVAGE, Secretary, 20, Horsell Road.
MR. G. ATKINS, 1, Woodstock Road.
MR. E. N. BUSBRIDGE, School Superintendent, 1, Clifton Terrace.
MR. J. MABLY, School Secretary, 57, Thorpedale Road.
MR. A. DUNHAM, 200, Stroud Green Road.
MR. T. BARRIER, 117, Gillispie Road.
MR. B. OWEN, 1 Travers Road.
MR. J. WESTMORELAND, 27, Athelston Road.
MR. C. BUSBRIDGE, 1, Woodstock Road.
MR. C. WREN, 127, Effingham Road.
MR. J. JACKSON, 3, Park Hall Place, E. Finchley.
MR. W. WEBB, 175, Isledon Road.

MRS. W. TURNER, President of the Sewing Committee.
MRS. C. BUSBRIDGE, Treasurer of the Sewing Committee.
MRS. W. H. TUCKER, Secretary of the Sewing Committee.

Chapel
ret little
sh. they
ey are now

cessfully
is certainly
et humour
p control
visible.

Rev. Robert Spear. (Died recently)
Unitarian

GLA
26/11/47

St Andrew's parish.

17
3

5
2

Rev Robert Spear, Arundel House, Highgate Hill N.

Mr Spear is the Minister of Highgate Hill Unitarian Christian Church, and also the Editor of the "Christian Life" the official organ of the Unitarian Body. I met him at his office at Essex Hall.

Mr Spear is a magnificent specimen of a man: large massive head reminding me of Wm Morris, but a bigger man. Probably about 55; hair and beard turning grey. Enthusiatic about his work especially the social part of it; ~~whether~~ ^{whether} we were talking of the services, visitation or what not, he always managed to return to the Reading Room & the library of which ^{he} is evidently proud & probably justly so. Has been at Highgate 10 years.

The People of the District

The people ~~inter~~change very much. Population is mixed. Dartmouth Park Hill district is the poorest. Bisimark Road & others adjacent are occupied by comfortable people. Clerks &c. These change very little.

Persons Employed

Mr Spear is the only paid worker, ^{£700} Had an assistant but none this year. 24 Sunday School Teachers. Did not know how many others. From Report I gather that 25 to 30 more ^{or} ~~be added~~

Buildings Used

Services Held

Social Agencies

The Chapel seating 350; schoolroom about 200 and 4 or 5 class rooms. Great difficulty is want of space; are now proposing to build additional rooms. Following extract from "Christian Life" summarizes the work of the Church ~~benefits~~ and for this they are appealing for £2000.

Sunday 11- and 7 P.M. Service. About 180 in morning + 120 in the evening. Middle class people + 2 or 3 independent families & employees. Get their own people in the morning.

Sunday School. 300 scholars. Attendance - About 200.

Annual Report for 1894 - gave numbers at 229 + 158.

Ten classes are held in the church owing to want of space.

In to

On week evenings the buildings are almost entirely given up to social work.

want of more rooms. Amongst the Institutions at present in operation may be named the following :-

Social Institute	Children's Singing Class	Ambulance Class
University Extension Lectures	Geological Circle	Penny Bank
Band of Hope	Church Choir	Students' Reference Library
Free Reading Room	Children's Art Classes	Sunday School Library
Free Lending Library	Violin Classes	Teachers' and Vestry Library
Dorcas Society		

The Library numbers 7000 volumes and is used by all classes. 1500 families take out books; of these only

FREE READING ROOM & FREE LIBRARY

LIBRARIAN - - MR. MANWELL.

Report 1894

I have nothing new or special to report of this Institute, but that larger premises are now needed, as an addition of nearly 3000 books has been made during the last two years; in fact, we have more books than we can find shelf room for; and more people attend the room than can be well accommodated. I have every hope that in a short time money may be raised to enlarge the building, for there is no Institute of this kind within three miles of our church that is doing half the service of this for the public. During the last twelve months the Librarian has received upwards of £80 as entrance fees, fines for books kept beyond two weeks, and for the reading of a reserved lot of books. The whole of this amount was expended on further additions to the Library.

61
only 11 are Unitarians. Our people ^{have} their own books at home, Mr Spear explained.

Free Reading Room is crowded. Have 200 to 300 people in ~~every~~ ^{every} night, except Monday & Thursday, when the schoolroom is needed for other purposes. Have Church people, R.C.'s & all sorts come in. They however do not help to support it. A box near the door, but do not average more than $\frac{1}{2}$ a night. In 1894 Report. amount taken from ~~Boxes~~ Boxes at the Doors is £2. 3. 2 $\frac{1}{4}$. The success of this institution is due to the fact that ~~the~~ trouble & money are not spared. All the best magazines, Contemporary, 19th Century &c; class papers, ladies papers & religious periodicals of all shades of opinion are taken and this ^{range} ~~breadth~~ of the printed matters is reflected in the persons using the place. "You can see well dressed ladies sitting by the side of working men." The Library is also supplied with all the important new books. Fines, which amount to £100 per annum, are used for this purpose. Of course, they are not successful financially. 60 or 70 people give £1 a year & in 1894 I see that two donors gave £50 each.

HIGHGATE HILL
Unitarian Christian Church
SOCIAL INSTITUTE.

President

Rev. ROBERT

63
University Extension Lectures are also held on Monday nights.

Prof. Jiffin on Poetry this winter. 180 students, average 150 to 160 present at the meetings. Only second to Fresham College in point of numbers. Textbooks are lent by the library.

Social Institute (Thursday) has membership of about 200 of whom 50 are their own people. Have lantern lectures, concerts etc. Object of society is "to promote social intercourse between the members of the congregation".

Band of Hope has 100 members.

Art Classes include drawing + painting.

Violin classes for Juniors + seniors.

Chess club.

Penny Bank. About £100 paid in during year. Over 100 children in club. In 1894, there were 136 members + an average attendance of 75 each week.

Very little visitation. R.C.'s are good visitors.

Help any persons in poverty but don't profess to give any charity. It simply draws a number of loafers. Dorcas + Maternity Society's expenditure is about £6 a year. Have no special fund for charitable relief.

Visitation

Charitable Relief

HIGHGATE HILL
Unitarian Christian Church
SOCIAL INSTITUTE.

President - - - Rev. ROBERT SPEARS.
Hon. Secretary - - - Mr. P. C. GALLOWAY,
27, Tollington Park, N.

15th SESSION. OCTOBER TO DECEMBER, 1897.

SYLLABUS.

- OCT. 7. **Conversazione.** 7.30 to 10.30.
" 14. **Dramatic Reading**—Browning's Play "Colombe's Birthday."
Arranged by Mr. P. C. GALLOWAY
" 21. **An Evening with Dickens.** Mr. W. A. THOMPSON
" 28. **Lantern Lecture**—"From London to Canterbury with
Chaucer's Pilgrims in the year 1385."
Mr. W. SLATER (S. & P.E.L.)
NOV. 4. **Concert.** Arranged by Mr. H. L. WHITTAKER
" 11. **Holiday Paper with Lantern Views**—"Switzerland."
Mr. C. A. GINEVER
" 18. **Lecture**—"Dr. William's Library: its history & treasures."
By the Librarian, Rev. F. H. JONES, B.A.
" 25. **Lantern Lecture**—"Some of Shakespeare's Heroines."
REV. J. E. STRONGE
DEC. 2. **Lecture**—"An Elizabethan Admiral: Sir John Hawkins."
Mr. A. M. TALBOT, B.A., LL.B.
" 9. **Concert.** Arranged by Mr. J. H. S. COOPER
" 16. **Shakespearian Reading**—"The Twelfth Night."
Arranged by Mr. F. WITHALL

Tickets of Membership, giving admission to all the above Meetings:

ONE SHILLING.

The Meetings are held in the Free Library, Highgate Hill, on
Thursday Evenings at 8 o'clock.

Wm. NEWBOLD, Printer, 14, Junction Road, N.

Visitation

Charitable

University Extension Lectures are also held on Monday nights.

Prof. Jiffin on Poetry this winter. 180 students, average 150 to 160
present at the meetings. Only second to Fresham College in
point of numbers. Textbooks are lent by the library.

Social Institute (Thursday) has membership of about 200
of whom 50 are their own people. Have lantern lectures
concerts etc. Object of society is "to promote social inter-
course between the members of the congregation".

Band of Hope has 100 members.

Art Classes include drawing & painting.

Violin classes for juniors & seniors.

Chess club.

Penny Bank. About £100 paid in during year. Over
100 children in club. In 1894, there were 136 members &
an average attendance of 70 each week.

Very little visitation. R.C.'s are good visitors.

Help any persons in poverty but don't profess to give
any charity. It simply draws a number of loafers. Boreas
& Maternity Society's expenditure is about £6 a year. Have no
special fund for charitable relief.

Other Religious Influences

Church Membership

65
St Joseph's (R.C) is the best attended church in the neighbourhood. More R.C.'s in the neighbourhood than in any other part of London. Have a fairly good school on the side of the Hill - The children are a stratum lower than those in other schools. Give some relief - "Sort of bread and cheese relief"

St Peters (Anglican) have a number of charitable institutions & give a good deal of relief but only to people who attend their services. Tell women to go to Mr Spear as their children are in his school. Has had several cases of this kind.

The Church has been in the same position for the past 2 or 3 years. It now numbers 120 members. Give me a copy of the Report for 1894, which will fairly represent the present condition. This report appears to be issued every 4th year as some of the figures are given for 4 years (1891-4). The total income in 1894 was £427 & they finished with £15 in hand.

The following introductory paragraph to the Report for 1894, gives an insight to the difficulties & conditions under which the work is done:

67

Your Committee have pleasure in presenting to the congregation a report of the year's doings, showing, they believe, signs of steady activity in various directions. They would have been glad to point to an increase in the attendance at our Sunday services, but there has not, at least, been any falling off, and our numbers now will probably be found to compare very favourably with the attendance at most of our other London churches. The number of subscribing members on our roll is almost identical with that of last year, as although several new names appear in this year's list, the total number of new members does not more than fill the places of those whose names are withdrawn, removal from the neighbourhood having been, in nearly every instance, the cause of such withdrawal. The old difficulty of inducing more of our regular attendants to become subscribing members still remains, and no satisfactory solution of the problem has yet been found.

"People think we are a rich" said Mr Spear but he does not agree with them. Whilst the attendance at the services & religious meetings is small, the social work, especially the educational part of it, is a strong influence in the district and reaches far beyond the bounds of the Unitarian community. Mr Spear is undoubtedly an able man & probably one of the most influential of his body in London.

Su. 2nd.

S^t Andrew's parish
(just outside N)

17

69

(2)

Interview with Mr. Alexander Ramsay,
Presbyterian Church (England), Highgate, and Thrift-
Hall Mission, Grosvenor Road, Upper Holloway.

Mr Ramsay is a very pronounced Scotman
of about 35: big, plain, unkempt and rather dirty:
looking as if he came, as he probably does, from
the Scotch working class: but a very good fellow
withal; thoughtful, intelligent, but rather slow and
heavy of speech. He has been here 8 years.

His church is a few yards over the London
border, and his congregation is drawn almost
entirely from outside London. I therefore left it
alone and questioned him only as to the Mission
work at Thrift Hall.

S^t Stephen's parish.

Character of population.

The Mission confines its work to the streets
bounded by St. John's Road, Sharnside Road and Horny
Road, the Railway and Holloway Road, roughly in
fact the parish of St. Stephen. The population is
entirely working class, poor, but not generally very
poor, nearly all two rooms to a family. It was

Persons employed.

Buildings.

Services.

Social Agencies.

71
Large proportion of the men are on tram or bus companies; but there are several factories in the district employing a good deal of girl labour.

Wife Women paid.
About 50 voluntary workers all of whom are connected with the Highgate Church.

One Building including two halls. High Road School for Sunday School.

On Sunday two services for children and one for adults which is attended by about 50 of whom from 15- to 20 would be men. All are of the working class. It is unusually difficult to get hold of the men in this district owing to the fact that so many work on Sunday.

Mothers' Meeting.

Boys' Brigade.

Factory Girl's Club.

Young men's recreation meeting.

Education.

Visiting.

Nursing.

Relief.

73
Both Halls are occupied with something every night. The ultimate object of all the social work is spiritual, but the Mission is run on quite unsectarian lines, and if members of other churches come to any of their social meetings they are urged to stick to their own church. The sole object is to do real mission work and get hold of those who go nowhere else.

Sunday School with about 250 on books and 200 in attendance. Parents and their children simply because it is the nearest school.

The Bible woman spends nearly all her time in visiting from house to house. She is a very discreet woman but is not allowed to give any relief. The ladies who conduct the Mothers' Meetings and some of the Sunday School teachers also visit unsystematically.

Send to R. L. H. H.

Give my little in actual relief, at the most £10

Other Religious influences.

78
a year. Also give interest on Penny Bank, and
sell old clothes cheap, but otherwise all organisations
are entirely self supporting.

The Mission is evidently on unfriendly terms
with Mr Kahn the Vicar who told Mr R. that they
and the Salvation Army were doing the Devil's work
in his parish: apparently the accusation is that they
take away his people and paupers, and it was
for this reason I think that Mr R. insisted on
the fact that his mission was quite unaggressive
and gave practically no relief. When Mr R. wished
to hire Duncroft Road R. S. for his Sunday School
Mr K. who is one of the managers vigorously
opposed. Mr R. seemed to me a most broad minded
man and anxious to live at peace with Mr Kahn.
He fixed on this district as being poor, near
his church and free of all other agencies except
the Church of England. Mr R. says that his
little women whom the church to be most inactive:
she has never met an agent of theirs, nor does
she ever come across visitors from any other body.

Drink.

Religious influence.

77
There is a great deal of drink and the bulk of the poverty is due to it but Mr R. notices few drunken men in the street than in Scotland. Comparing Scotland with England Mr R. notices the great intellectual inferiority of the English working classes, and their much smaller susceptibility to religious influence. And throughout the country, Scotland included he thinks that the churches are losing rather than gaining their spiritual hold.

Mr & Mrs Houghton
Salvation Army

GHA
Nov 30/97

Personal note

Some Salvationists come from other Bodies
but most from non church people.

St Mark's parish.

17

2

Mr & Mrs Walter Houghton. 44 Lancaster Road
Stroud Green N.

Mr Houghton is the Treasurer of the Holloway II
Corps of the Salvation Army, which has its meeting
place at 300. Hornsey Road. Ensign Fairbairn, the
officer in charge had just gone & so forwarded our letter
to him.

Mr Houghton is a builder in a small way. Lives
in a comfortable but small double fronted house. He is
between 30 & 40 and his wife ~~is~~ not quite 30. Both
wore the Army dress. ~~Mr~~ ~~H~~ is a slim, intelligent
looking woman, and her red blouse and blue skirt
suited her well. Mr H. is of rather heavier
build but intelligent & quick. A good business man
I should think. Both were thoroughly in earnest.

Mr H. told me that he was a Wesleyan &
was connected with Finisbury Park Wesleyan
Church. He obtained blessing through a
Salvationist, who visited him when ill some
time before and thought it his duty to join them.

Asked as to whether many of the Corps
had ~~been~~ previously connected with other
religious

81
religious bodies, he at first said not but Mrs H. interposed
& the final resultant opinion was that a certain number
had attended other places but were converted at the Army
whilst the bulk were drawn directly from the non-church
goers. Had 8 from Campbell Road during the past year.

The Corps district is bounded roughly speaking
by Holloway Road (W), Seven Sisters Road & Gillespie
Road (S) & the G. N. Rly main line. They cover the
district pretty well & if the poorer parts of it
were the Salvationists are received. So as far
north as Shond Green Station.

Have the Hall in Hornsey Road, a converted shop
holding 100. Here Wortley Hall (400) near Finsbury
Park Station for Sunday meetings.

Corps numbers about 150 good soldiers -
rather more. About 60 Juniors. Corps is divided
into 3 brigades.

Two paid officers and about 20 local officers
including Company leaders, ^{Chorus} Band of about 18 men.

Holloway II. District

Buildings Used

Membership of Corps

Officers

Meetings held

For Adults.

For Children

Character of Congregations

Usual meetings on Sunday 7. 11. 2.30 + 6.45.

Except the evening gathering, the attenders are mainly their own people. 11 am 60 to 70. 6.45 pm. Average over 300, often full. Two or three open air meetings before each meeting. Also a large open air meeting in Finsbury Park on Sunday afternoon (2.30 to 4.30). Very large attendance & always a good collection - mentioned that last Xmas one gentleman gave two sovereigns at this meeting.

In week evenings a meeting every night ~~from~~ at 8 PM, preceded by open air at 7.15. except on Tu + Fri. Average about 60 attending.

Junior Meetings on Sunday morning (address)

Afternoon. 8 classes, About 50 attending. 70 or 80 on books.

Evening. Meeting - about 70.

In week evenings meetings at 6.45. Wednesday - the Band of Love; Thursday Sewing & Fretwork Classes. Friday. Gospel Meeting.

Congregation - "Allsorts". Majority are working class: a sprinkling of quite middle class people. Large proportion of servants. About one-third men. Rough men drop in - tipsy and some very rough but

Campbell Road

Lodging House Visitation

"we don't mind, we take them as they come. Some of our soldiers come from these people.

Talking of these people led up to Campbell Road, which Mrs H. visits every week. Three or four of them also visit the lodging houses there every Sunday afternoon & sing and talk to the people. Generally find 20 to 30 people in each of the kitchens as a rule they are having their dinner. Some stop & join in the singing. At first, they threatened to turn them out but never did. Now opinion is with their side them and ~~no~~ no one would be allowed to hurt them.

The Lennox Road end of the street is a little more respectable than the rest. Middle part the worst. Place is very much crowded: generally find a family in each room. Would take an afternoon to visit one house if you went to each family. Mrs H. tries to find out those visited by others and avoid calling. People beg, sell shoe laces, women also go out selling things and some work at laundries. Does not think many do charity as people will not have

Campbell Road (cont'd)

87
have them. As one woman told her "To say you come from Campbell Road is quite enough." They have had 8 or 9 converts from Campbell Road during the past year. They move out as soon as they can. The influence of the place is too strong. She would rather expect ^{old} Christians to ~~move into~~ ^{go back into} the street than the new converts to remain. Only one remains is a woman (married). The ~~other~~

The inhabitants of the lodging houses are of the tramp class ^{and} ~~but~~ the people in the houses reckon themselves much better than the lodgers. One couple in a lodging house, they got married & influenced. These people took two rooms directly after, the woman first getting the cleaning of the lodging house as a means of earning the money needed. People come from all classes; one lieutenant recognized a man, she had known at Newcastle on Tyne. He was the son of a shipbuilder that came down through drink. Great number of rows, fighting etc. Mrs H. has seen a great deal of this. Constable at the end told her that his hands and clothes ^{became} were smeared with blood, ^{while} pulling fighting people apart. Many of the women have black eyes continuously.

Visitation

Charitable Relief

Publichouse Visitation.

Much as in other corps. Two officers 18 hrs a week, visiting sergeants. They also write to all new converts

Speaking generally no relief is given. Whatever is done is quite independent. Tell the people they must expect nothing: "it would spoil our work, if they thought anything could be got." Mrs H. seems to have given something in Campbell Road in the earlier days. Says they are "awful cadgers". Found their ~~own~~ address & used to be constantly beset by them with all kinds of excuses - "a child to be buried; something to be got out of pawn" - but we have stopped that. Soldiers never seems to be in want - but help each other - sees in this a fulfilment of the promises of God.

W. H. with some other S. A. men visits the publichouses on Saturday nights. Has been in nearly every ~~house~~ pub. in the district. Quite as many women as men drinking. Take the War Cry & try to get a word with the people. Meet with a good deal of chaff and occasionally roughness.

Big corps most attractive

The Officer

The S. A. system

Self sacrificing spirit
of the People

roughness but generally well received. He has done it every since he joined the corps. At first did not get into the private bars, ^(was ordered out) but now go everywhere. Have had more of the pub. people at the meetings as a result.

Corps is growing but they lose more of their soldiers than a large corps. People are drawn to the bigger corps so they lose more by transfers.

Both spoke very highly of Ensign Fairbairn, who has now gone to Penze. "She got a beautiful hold hold of the people & never had a minute to herself" in consequence.

Mrs H. rather likes the S. A. system. The work is so organized that it goes on evident even without the officers. Thus at this change, the officers coming needed a rest & so the Staff Captain arranged for them to have a week before coming. The local officers carried on the meetings without a break, the only assistance given being that the S. C.'s aide. came on the Sunday.

These couple are good samples of the salvationists. They give practically all their leisure to the Army & that although they have a comfortable home where they might take it easy. Neither seem to think any credit is due to them for the time

they devote to the work but regard it as ~~the~~ thing they naturally should do. Mrs H speaking of the Pub. visitation said incidentally "It was a cross at first" & this spirit of self sacrifice pervades all the work.

Mr W H J. Alexander
Friends Meeting House, Merces Rd

1887
Dec 8/97

Membership of Society

District served

Buildings used

Meetings Held

St George's parish, Tufnell Park.

17

17
1
2

Interview with Mrs W^m Henry J. Alexander, at his office
17 Gracechurch Street E.C.

Mrs A. is a member of the Society of Friends & belongs to the Merces Road, Holloway Meeting. He is in business with his brother as an Insurance broker at the above address.

He is a man about 40; dresses plainly & neatly; Fair, with a short pointed beard. Quite friendly & spoke readily about the meeting.

At Merces' Hall, they have 175 members & 37 attendees.

The latter are persons who worship regularly with them but are not members of the society.

The congregation is drawn from a tolerably wide area, the limits being Highgate ^{Crouch End}, Finsbury Park, on N. & East. Liverpool Road to south. & some from Camden Road & Town.

Merces' Hall. The large meeting room holds 200. Have school & 2 smaller rooms.

Sunday Worship at 11. & 6.30. About 95 in morning & 35 in evening. Almost entirely their own members.

Meetings Held

Social Agencies

Smaller than a few years ago owing to tendency to ^{move} outward.

Adult School 9 am (Sunday) 20 to 30 men. Come from the neighbourhood. Working men & clerks & bookkeepers of the lower grade. ^{Most have} ~~Have~~ a Sunday suit.

11 am Sunday. Small meeting for friends children.

3 pm. Ordinary Sunday school. Small, owing to lack of teachers - About 30 children attend.

Bible Reading & Classes. Monday & Wed afternoons & Thurs eve.
Attended by their own people.

A few social agencies:

- Band of Hope. Tu. 7.30 30 to 40 children
- Gospel Temp^{le} Mtg .. 8.30 15 to 20 people.
- Women Meeting (Mon) . 12 to 20 women.

These are all attended by local people. An attempt has also been made to reach the factory girls by means of a Club on Wed & Friday nights. Get 20 to 30 ~~for~~ girls - some work in factory, others go to daily service. Started with senior girls of S.S. Too early to say as to success. There is a feeling amongst the friends that they ought to do something of which this club is an outcome.

Visitation

Charitable Relief

Co-operate with
Free Church Council }

No systematic visitation. 'Oversers' do more than others but it is left to individual initiative. Practically they are in touch with all the members.

Always look after their own poor. Never allow them to go to the workhouse. Have an exceptional case at Holloway, a man has been allowed to ~~go to~~ ^{remain in} Colney Hatch Asylum. Appears to have ^{been} thought best as a 'matter of discipline'. Also give a little help to outside cases. Ladies make garments etc but all is done by individuals & not by the body as such. Ladies used to make garments for maternity cases. They have 'bags' etc. ~~But~~ they have found that other bodies (the Baptists & the Church of England) are doing all that is needed in this direction so they are ~~not~~ working for the Home at Laura Place, Clapton. Says their Ladies' Working Party was one of the first to do maternity work here. Started over 50 years ago.

Have joined the Free Church Council. Had a district to visit in October but Miss A. evidently did not. Think the visitation was well done. They are distributing some of their "Peace" appeals through the Council

Drink

Local Govt

Marriage

Persons to See

101
Don't see much drunkenness but there is a good deal of drinking.

As to Local Govt. he had not taken any active part, but was convinced that they needed better class people - educated men to take up the work of the Vestry & Guardians Board. Admitted that they had been more active recently.

Have a few marriages at Mercer's Road. Tendency for the newly married friends to move out of the district.

Benhill is their best adult school. Should see Mrs J.B. Braithwaite (Foster & Braithwaite) 27 Austin Friars St. or Mr Joseph Allen Baker (J.Baker & Son) 58 City Road as to this. When we come to South London, Mr Edward Alexander (the brother) will give information as to the Peckham Meeting.

Asked why the Men's Adult Schools were held at 9 am on Sunday. The brothers agreed that it was partly custom - copying the 13' hour model - commencing at 7 am & partly difficulty of getting the Teachers in the afternoon - hard to get back after morning service, when coming from a distance. Croydon has two meetings morning & afternoon. Attendance 100 & 200

Highgate Hill Free Library
Unitarian

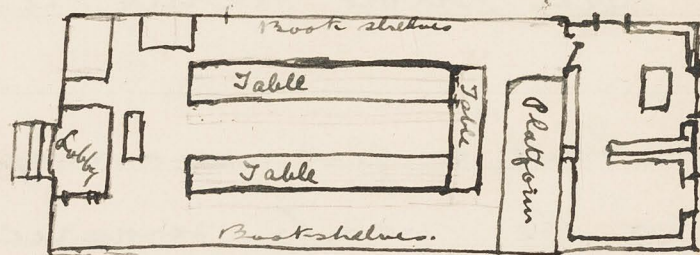

St. Mark's parish.

All Saints parish.

St. Thomas' parish.

St. Mary's parish.

GSA 10/12/97

Mr & Mrs E. Garrod, 19 Stonewall Street, Holloway, N.

Mr & Mrs Garrod ~~are~~ belong to the 'Open' section of the Plymouth Brethren. I called upon them to obtain some general information respecting the Brethren, intending to call again later. Following notes refer to the various parties worshipping in Holloway & Islington.

phen's parish

Hall at Aged Pilgrims Asylum, Hazelville Road.

Exclusive brethren: have a very good meeting more than 100, probably 200 people. Have a large ^{evangel meeting on Sunday evenings.} Everleigh Hall, Everleigh Street, Tollington Park. Also exclusives. A branch from No. 1. Smaller meeting, Wedmore Hall, Wedmore Street. Open Brethren.

Not a large meeting. Mr Burgess & Mrs Patey are the principal men. Park Hall, Blackstock Road. Exclusives. About 45 to 50 brethren. Hall holds 300.

Albion Hall, Hazelville Road. Open brethren. Hall holds 100. Get about 60 to Sunday morning meeting. Room full at night.

Highgate Hill Free Library
Unitarian

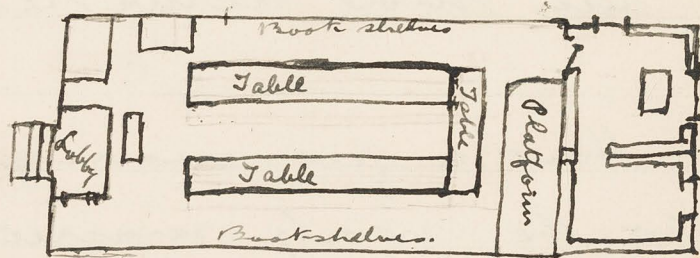

St. Mark's parish.

All Saints parish.

St. Thomas' parish.

St. Mary's parish.

G.S.A. 10/12/97

Mr & Mrs E. Garrod, 19 Stonewall Street, W. Holloway, N.

Mr & Mrs Garrod ~~are~~ belong to the 'Open' section of the Plymouth Brethren. I called upon them to obtain some general information respecting the Brethren, intending to call again later. Following notes refer to the various parties worshipping in Holloway & Islington.

St. Stephen's parish

1) Hall at Aged Pilgrims Asylum, Hazelville Road.

Exclusive brethren: have a very good meeting more than 100, probably 200 people. Have a large ^{gospel meeting on Sunday evenings.}

2) Everleigh Hall, Everleigh Street, Tollington Park. Also exclusives. A branch from No. 1. Smaller meeting.

3) Wedmore Hall, Wedmore Street. Open Brethren.

Not a large meeting. Mr Burgess & Mr Patey are the principal men.

4) Park Hall, Blackstock Road. Exclusives. About 45 to 50 brethren. Hall holds 300.

5) Albion Hall, Hazelville Road. Open brethren.

Hall holds 100. Get about 60 to Sunday morning meeting. Room full at night.

Formerly the brethren meeting at Albion Hall met in the Park Hall, Blackstock Road. The 'Exclusives' bought the property and they had to turn out & failing any other place they had to take Albion Hall, which the Exclusives were vacating. A change of meeting places.

6 Cholmley Hall, Archway Road. A large meeting but outside the London Boundary.

In South west Islington, Park Street Meeting is a large meeting (exclusive) and Barnsbury Hall open brethren.

Mr & Mrs G. worship at Albion Hall. In a small Hall next door to Albion Hall, the Spiritualists hold a meeting. Can hear them singing whilst their meeting is in progress.

The Brethren take the New Testament as their rule of life & church government. They have no ministers set apart as such
and

Spiritualists

The Tenets of Brethrenism

Difference between
Open & Exclusive Brethren

and their name brethren is intended as a protest against such and against sectarianism. They have 'come out from the sects' and do not regard themselves as a sect.

The chief difference between the Exclusive and Open Brethren is in regard to the Communion or 'Breaking of Bread' as they always term it. The Exclusives will not permit other christians to sit down with them whilst the Open brethren will allow other believers to take part with them.

Duncombe Hall, Duncombe Road, is not a brethren meeting.

Will endeavor to get particulars as to the meeting & will write

Mr H. Bird +
Misses Pearson + Edwards
N. London, Samaritan Mission.

ELT 10/12/97

THE NORTH LONDON
Gospel Samaritan Mission.
 MISSION HOUSE:
 93, Grove Road, Holloway, N.

Hon. Pastor:
 Mr. HENRY BIRD, 26, Russell Road, Holloway, N.

Auditor:
 Mr. J. J. VYVYAN, 6, Montpelier Road, Upper Holloway.

Treasurer:
 Mr. J. R. BULLOCK, 3, Gloucester Road, Holloway, N.

Committee:
 Mr. F. J. BRAZIER
 Mrs. F. J. BRAZIER
 Mr. W. H. BIRD.

Mr. A. CLASSEY
 Mr. J. GRACE
 Mr. WOOD.

Missionaries:
 Sisters E. EDWARDS and J. PEARSON,
 The Mission House.

Hon. Secretary:
 Mr. CHAS. J. ANDREWS, 59, Lambton Road, Hornsey Rise, N.

Building Used

St Paul's parish.

17 / 11 / 1900 (2) 115

Interview with Mr Henry Bird and Sisters
Edwards + Pearson at the Mission House,
93 Grove Road, Holloway, N.

Mr Bird is a spare built, grey bearded man
of about 60. Miss Edwards is a woman of
about 40 or so, stout, motherly looking person, quite
a contrast to Miss Pearson, a slim young woman
in the ~~early~~ twenties. The former evidently takes the
lead, the younger woman turning to her and deferring
to her opinion in everything. When I called Mr
B + the younger woman were present, the elder came
in later but was called away again within half
an hour.

The Mission House is a shop with
two floors above; the shop + room at back being
the meeting room (holds 70), ~~with~~ the front room
on first floor is also used for a class room,
the back room + floor above being used as a
residence by the Sisters.

For 4 years they hired Holloway Hall for Sunday
evening service. The Hall changed hands last winter +
all the hires received notice to leave. Place was empty 6 months
+ Mr B. did not apply for renewal of tenancy.

Services etc.

"WE PREACH CHRIST CRUCIFIED."

1st Cor. i. 23.

North London Gospel Samaritan Mission

93, GROVE ROAD, HOLLOWAY, N.

Hon. Pastor - - - MR. HENRY BIRD.

SERVICES.

SUNDAY.— 7.0 a.m. Prayer Meeting.
" 11.15 a.m. Gospel Service.
" 3.30 p.m. Bible Reading.
" 7.0 p.m. Evangelistic Services.
(Both in Holloway Hall and at 93, Grove Road).
MONDAY.— 8.30 p.m. Prayer Meeting.

TUESDAY.—8.15 p.m. Y.P.S.C.E.
WEDNESDAY.—6.30. Children's Service.
" 8.30. Gospel Service & Bible Reading, alternately
THURSDAY.—9.0 p.m. Choir Practice.
SATURDAY.—8.30 " Prayer and Praise Meeting.

"Come thou with us and we will do thee good."

Numbers x. 29

OUR WORK.

OPEN AIR WORK.—Open Air Services are conducted during the summer, at Gloucester and Windsor Roads, and other parts of the neighbourhood.

SAMARITAN WORK.—On application being made at 93, Grove Road, the Mission Sisters, Misses E. EDWARDS and J. PEARSON, will gladly visit sick and other cases.

In addition to these two Sisters, who devote themselves wholly to Mission Work, we have a large staff of Christian workers who would be delighted to read the Scriptures and pray with the sick and infirm, on receiving notice to that effect.

TOTAL ABSTINENCE PLEDGES may be taken at any of our Meetings.

SPECIAL ATTENTION

is called to our **Sunday Evening Services**, held in Holloway Hall, and at the Mission House. The latter Service is particularly designed to meet the needs of the immediate neighbourhood, and an affectionate invitation is given to those who may not be attending any other place of worship to unite with us in this or any of the above Services.

PLEASE HANG THIS UP.

Persons Employed

Memberships

Notes on Meetings

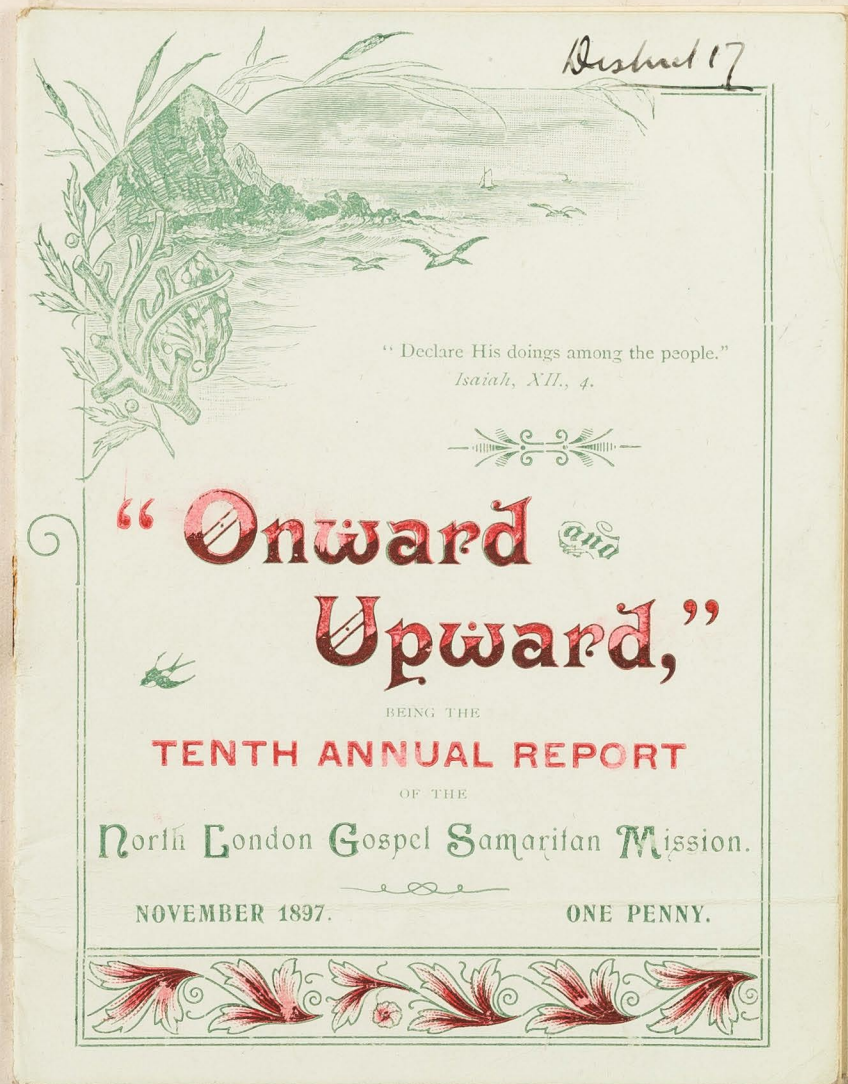

119

Pastor unpaid. 2 Sisters are only paid agents (Their maintenance only cost £41.12 - in the year ending Sept 97) or 16s a week for the two). 9 or 10 other workers.

Mission is organised as a church: the Lord's Supper twice a month. Membership 91.

Sunday evening service averages 60 - a room full - and they want to throw the passage into the shop so as to have more accommodation. Mostly poor ~~people~~ some majority women - some bring their babies. Find it difficult to get strangers in or to reach the men.

Get a good proportion of men at the Bibleclasses. Christian Endeavour Society - 37 members of whom 28 are active. Children's Service on Wed - about 50 - a mixed lot. some very poor, other fairly dressed.

Many open air meetings in the neighbourhood. Held in Alexander, Cornwallis, Cottenham, Devonshire Milford + Windsor Roads. Also in Finsbury Park on Sunday morning. About 100 held this year.

Persons Employed

Memberships

Notes on Meetings

THE NORTH LONDON
Gospel Samaritan Mission.

MISSION HOUSE:
93, Grove Road, Holloway, N.

Hon. Pastor:

Mr. HENRY BIRD, 26, Russell Road, Holloway, N.

Auditor:

Mr. J. J. VYVYAN, 6, Montpelier Road, Upper Holloway.

Treasurer:

Mr. J. R. BULLOCK, 3, Gloucester Road, Holloway, N.

Committee:

Mr. F. J. BRAZIER	Mr. A. CLASSEY.
Mrs. F. J. BRAZIER.	Mr. J. GRACE.
Mr. W. H. BIRD.	Mr. WOOD.

Missionaries:

Sisters E. EDWARDS and J. PEARSON,
The Mission House.

Hon. Secretary:

Mr. CHAS. J. ANDREWS, 59, Lambton Road, Hornsey Rise, N.

119
Pastor unpaid. 2 Sisters are only paid agents (their maintenance only cost £41.12 - in the year ending Sept 97) or 10/- a week for the two). 9 or 10 other workers.

Mission is organised as a church: the Lord's Supper twice a month. Membership 91.

Sunday evening service averages 60 - a room full - and they want to throw the passage into the shop so as to have more accommodation. Mostly poor people - some majority women - some bring their babies. Find it difficult to get strangers in or to reach the men.

Get a good proportion of men at the Bibleclasses. Christian Endeavour Society - 37 members of whom 28 are active. Children's Service on Wed - about 50 - a mixed lot. Some very poor, other fairly dressed.

Many open air meetings in the neighbourhood. Held in Alexander, Cornwallis, Cottenham, Devonshire Milford + Windsor Roads. Also in Finsbury Park on Sunday morning. About 100 held this year.

Persons Employed

Memberships

Notes on Meetings

119
Pastor unpaid. 2 Sisters are only paid agents (their maintenance only cost £41.12 - in the year ending Sept 97) or 16/- a week for the two). 9 or 10 other workers.

Mission is organised as a church: the Lord's Supper twice a month. Membership 91.

Sunday evening service averages 60 - a room full - and they want to throw the passage into the shop so as to have more accommodation. Mostly poor people - some majority women - some bring their babies. Find it difficult to get strangers in or to reach the men.

Get a good proportion of men at the Bible classes. Christian Endeavour Society - 37 members of whom 28 are active. Children's Service on Wed - about 50 - a mixed lot. Some very poor, other fairly dressed.

Many open air meetings in the neighbourhood. Held in Alexander, Cornwallis, Cottenham, Devonshire Milford + Windsor Roads. Also in Fenbury Park on Sunday morning. About 100 held this year.

2
THE NORTH LONDON
Gospel Samaritan Mission.

TENTH ANNUAL REPORT.

"Not unto us, O Lord, not unto us, but unto Thy Name give glory." - Ps. cxv. 1.

WITH the deepening shadows of Autumn comes the pleasurable duty of presenting our Tenth Annual Report. Ten years' service for the King of Kings! How it fills our hearts with joy to look back upon the way we have been led, when we remember how thickly it has been strewn with His loving kindness and tender mercies, more than we have either asked or deserved. There have often been hills of difficulty to climb, storms to brave, foes to fight, and shadows have sometimes fallen across the path; but through all the Eternal God has been our Refuge, and still "underneath are the Everlasting Arms." Since the last report our experiences have been much the same as in previous years. The patient sowing of the good seed of the Kingdom in the Mission Hall, the open-air and the homes of the people, has been steadily continued through much opposition from the enemy, and for those rescued and reclaimed from the paths of sin and wickedness we give praise to God.

3
Samaritan Work.

Explanation of this branch of our work is scarcely necessary, it is so well-known throughout Holloway. The untiring energy of our two Missionaries, who have now for many years devoted themselves entirely to this Christ-like sphere of service, has been the simple fulfilment of the Scriptures, in speaking a word in season to the weary, comforting those who are cast down, and pointing the sick and sinful to the Great Physician.

Some idea of what has been done can be gathered from the following statistics:—

Visits to Families (largely among the Sick)...	No. 2,237
" Hospitals, Public Houses, &c. ...	43
Distribution of Tracts and Booklets ...	2,084
Garments Distributed ...	89
Cases Helped with Coals, Food, or Money ...	328

At the close of this Report (page 11) will be found an item or two of interest, connected with the Samaritan work.

Evangelistic Services.

These have been continued every Sunday evening without intermission, in spite of the fact that we have been compelled, by the closing of Holloway Hall, to hold them at the premises in Grove Road. All unexpectedly the tidings came in January last that we were to leave by the end of the quarter. We held a special closing service, and regretfully quitted the scene of our labours, which had been so owned and blessed of God in the years gone by. Since then, as we anticipated, the meetings have greatly suffered for want of room, and we are now waiting for some kind friend to build us a new Mission Hall.

Our little Hall only seats about seventy, and we believe that quite a number of old supporters have considerably

Persons Employed

Memberships

Notes on Meetings

4

stayed away from this service to make room for strangers. While we thank these friends for their thoughtfulness, we regret their absence, and feel that this state of affairs must be remedied as speedily as possible. This can only be done by the enlargement of our present premises, or the loan of some suitable building close at hand. Of course the goal of our ambition is the erection of a new Mission Hall, and we heartily invite the co-operation of our richer brethren in this pressing matter. These Sunday evening Gospel Services are as old as the Mission itself, with the glorious result—a long roll of names registered in Heaven. Some who made their peace with God at these meetings have entered into His eternal peace; many remain, some labouring still with us, others scattered far and wide, but, thank God, all under *one* banner. Hence the desire by the Grace of God to enlarge this branch of the Mission's work.

Bible Readings.

"The entrance of Thy Words giveth light" Centuries ago this was the testimony of "the man after God's own heart," and it is still found to be true by the little company of God's children who gather around His Word on Sunday afternoons. The meeting is usually led by Mr. Henry Bird, whose pastoral care and tender sympathy in ministering to the spiritual needs of the flock entrusted to his charge by the Good Shepherd, has been accompanied by great blessing. We therefore add our testimony to that of the Psalmist and continue to rejoice in the light-giving influence of the Word of God.

The Lord's Supper

Is observed every second Sunday in the month, at the close of the evening service, and the last Sunday in the Month at the close of the afternoon meeting. All belonging to the Church of Christ we welcome to the table of the Lord. New Members are received in at this ordinance.

Bible Class.

5

We have this movement now fully organized with a President (Mr. W. H. Bird), Secretary (Miss E. Smith), and membership cards.

We append the following lines from its President:—
"Recognizing the importance of Bible Study as a means of grace, the Mission has ever sought to give prominence to the Word of God in its services and to encourage regular and prayerful meditation thereon among its members. We are happy to state that much blessing has attended the Wednesday evening Bible Class during the past year. The Secretary, Miss E. Smith, tells of much that gladdens our hearts, and stimulates us to seek a large and more intimate knowledge of Divine truth. The course of Subjects considered have been:— (1) The Book of Jonah. (2) The General Epistle of James. (3) The Ordinances of Baptism and the Lord's Supper. The Membership stands at thirty-seven, with an average attendance of twenty. The Class is of a homely and conversational character, and no effort is spared to make the Lessons interesting, instructive, and above all, helpful to Christian living. That our aim has in some small degree been realised we cannot doubt, frequent testimony being given to definite blessing vouchsafed. For all of light, guidance, strength and comfort, derived from our studies we devoutly give thanks; may the future witness a keener relish for, and a more whole-hearted obedience to the "Voice of His Word."

Prayer Meetings.

The weekly Prayer Meeting is carried on as usual on Monday evenings. Its character is varied occasionally. Once a month, the Samaritan Work is made the topic, and any case of special need known by the Missionaries is laid before the

119

Pastor unpaid. 2 Sisters are only paid agents (Their maintenance only cost £41.12 - in the year ending Sept 97) or 16/- a week for the two). 9 or 10 other workers.

Mission is organised as a church: the Lord's Supper twice a month. Membership 91.

Sunday evening service averages 60 - a room full - and they want to throw the passage into the shop so as to have more accommodation. Mostly poor people - some majority women - some bring their babies. Found it difficult to get strangers in or to reach the men.

Get a good proportion of men at the Bible classes. Christian Endeavour Society - 37 members of whom 28 are active. Children's Service on Wed - about 50 - a mixed lot, some very poor, other fairly dressed.

Many open air meetings in the neighbourhood. Held in Alexander, Cornwallis, Cottenham, Devonshire Milford + Windsor Roads. Also in Finsbury Park on Sunday morning. About 100 held this year.

Persons Employed

Memberships

Notes on Meetings

meeting and prayed for accordingly. While remembering our own we have not forgotten the needs of those who labour in other lands. The last Monday in the Month is generally devoted to this, some particular phase of Foreign Missionary effort being dealt with by one of the members. Now and again Missionaries from various parts of the World have addressed these meetings, their valuable information and thrilling experiences helping to make prayer more definite and full of purpose. The Lord has been very good to us in answering so abundantly the petitions we have asked of Him. Often has He done this in times of financial difficulty, as well as in many other things. "He is faithful that promised." We are anxious that the attendance should be improved, and remind our readers that they can help to do this by coming themselves.

Membership Meetings.

Once a quarter we endeavour to get the members of the Mission together for praise and testimony. These are very blessed times; the review of the unfailing mercies of the Lord, in the individual and collective experiences of those present calling forth praise and thanksgiving. There are now ninety-one Members on the books.

Christian Endeavour.

All too quickly has the year passed away, bearing with it the endeavours of our little band. The Lord Himself has been with us guiding and directing in all the numerous details of our work. We praise Him for the strength and grace that He has given, and trust that the blessings of the past year may encourage us to attempt still greater things for Him in the year to come. Our membership at

present numbers twenty-eight active, one associate and eight Honorary Members. One Associate has become an active member and two have joined the Mission. The work of the several committees has yielded very cheering results. Their arrangements have included helpful Bible-studies, inspiring Missionary gatherings (sometimes illustrated by Lantern Views), and good open-air meetings. Some of the members meet on Thursday evenings to make garments to order, the proceeds of which are divided equally between Home and Foreign Missions. The amount given to our own work will be seen in the Balance Sheet. At Christmas the sum of £2 was collected and given to the Mission Sisters for distribution among the poor. In addition to this the Sisters were each presented with a Bible as a token of our love and gratitude. We have sought to accomplish the three-fold object of the Society, which is to lead the young people to Christ and into His Church, to establish them firmly in the faith, and to set them at work in the Lord's vineyard. For the success which has attended our labours we are devoutly thankful, and esteem it a great privilege to be "co-workers together with Him."

Children's Services.

These have been held almost every Wednesday evening throughout the year. The attendance has been good and we rejoice to record that the persevering efforts of our Sisters and other helpers have borne fruit in several young hearts who have yielded themselves to the Saviour. The Summer outing was this year spent at Hadley Woods, when fine weather and bountiful provision combined to make a day of gladness for all.

We take this opportunity of especially thanking the many kind friends who have contributed so largely to the success of these services.

119
Pastor unpaid. 2 Sisters are only paid agents (their maintenance only cost £41.12 - in the year ending Sept 97) or 10/- a week for the two). 9 or 10 other workers.

Mission is organised as a church: the Lord's Supper twice a month. Membership 91.

Sunday evening service averages 60 - a room full - and they want to throw the passage into the shop so as to have more accommodation. Mostly poor people - some majority women - some bring their babies. Find it difficult to get strangers in or to reach the men.

Get a good proportion of men at the Bibleclasses. Christian Endeavour Society - 37 members of whom 28 are active. Children's Service on Wed - about 50 - a mixed lot, some very poor, other fairly dressed.

Many open air meetings in the neighbourhood. Held in Alexander, Cornwallis, Cottenham, Devonshire Milford + Windsor Roads. Also in Finsbury Park on Sunday morning. About 100 held this year.

Persons Employed

Memberships

Notes on Meetings

8

Dorcas Meetings.

For the continuance of this most necessary work, we are greatly indebted to the lady-friends of the Mission, some of them members of the British Women's Temperance Association who meet once a month at 93, Grove Road, gladly doing their part towards clothing those known by the Missionaries to be deserving of help. About fifty have been assisted in this way. Friends willing to help this society can do so by sending gifts of money, material, cast-off clothing, etc. to the above address, which would be gratefully acknowledged.

Temperance Work.

The fearful nature and extent of the drink curse in this neighbourhood will be readily admitted by every observant individual. We have in all cases where this has been the special sin, pointed to the Saviour as the only One by whose Almighty help the drunkard can ever hope to be released from the terrible habit of intemperance. We have thus combined Gospel with Temperance, and wherever possible, persuaded to sign the Temperance Pledge. Candidates for Membership of the Mission should observe that Total abstinence is a qualification.

Open-air Work.

Designed to reach the classes who rarely attend God's House this has been a work in which we have delighted to engage although the Lord has not permitted us to know of such striking results as in former years; yet we are confident that this in no way weakens the report, for the signs of the Spirit's power have been visible on many occasions. We have been enabled by the Grace of God to hold nearly a hundred meetings during the summer. When the weather

9

has been exceptionally favourable, we have succeeded in securing considerable crowds, many of whom have stood with rapt attention, listening to the sound of the Gospel. The face is often the index of the soul, anyone who doubts this has only to study an open-air crowd, to see that it is generally true. What a variety of expressions we have observed on the faces of our hearers, on some alas, the stamp of incredulity, the mocking smile, or stolid indifference; but on many we rejoice to say there have been visible signs of awakened interest, tearful remembrance and godly sorrow for sin, sometimes mingled with anxious desire for salvation. These have afforded splendid opportunities of individual dealing. We thank God for the demonstration of His Spirit in the preached Word. The meetings have been held all over the immediate neighbourhood of the Mission, viz:— Alexander, Cornwallis, Cottenham, Devonshire, Gloucester, Mitford and Windsor Roads. In addition to these places, we have now the sole responsibility of the Sunday Morning open-air in Finsbury Park. These have been excellently attended, and times of great blessing. We sincerely thank all the Christian Workers, from Myrtle Street Mission and other places, who have rallied round this gathering.

To all Dear Friends.

We render a heartfelt expression of gratitude. In their number we include the Rev. J. R. Wood and Deacons of Upper Holloway Chapel, Mr. Dell, Holloway Road, Mr. Colenutt, Fortess Road, Messrs. J. Emerton and Sons, Grove Road, and those who have by boxes, subscriptions and donations, given us timely financial assistance. We also remember with gladness our faithful band of workers, who have given such practical tokens of their sympathy with the work of the Mission.

119

Pastor unpaid. 2 Sisters are only paid agents (Their maintenance only cost £41.12 - in the year ending Sept 97) or 16/- a week for the two). 9 or 10 other workers.

Mission is organised as a church: the Lord's Supper twice a month. Membership 91.

Sunday evening service averages 60 - a room full - and they want to throw the passage into the shop so as to have more accommodation. Mostly poor people - some majority women - some bring their babies. Find it difficult to get strangers in or to reach the men.

Get a good proportion of men at the Bible classes. Christian Endeavour Society - 37 members of whom 28 are active. Children's Service on Wed - about 50 - a mixed lot some very poor, other fairly dressed.

Many open air meetings in the neighbourhood. Held in Alexander, Cornwallis, Cottenham, Devonshire, Mitford & Windsor Roads. Also in Finsbury Park on Sunday morning. About 100 held this year.

Persons Employed

Memberships

Notes on Meetings

10

In concluding

This brief account of the doings of another year, we prayerfully commend it to our readers, trusting that its perusal may not be devoid of blessing. As a Mission, we are still firmly resolved to go forward "in the Name of the Lord," ever seeking to proclaim His Truth, and extend His Kingdom—"Till He come."

"Rise, then, to do or suffer!
The day will soon be o'er:
Do what thy willing heart shall find,
And God will ask no more."

(Signed) C. J. A., Hon. Sec.

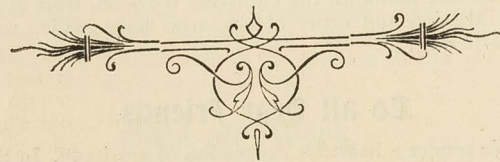

11

Gleanings.

WE briefly enumerate a few interesting cases, some of which are personal testimonies.

Standing up for Jesus—A Sunday evening or two ago, near the end of the service, the pastor made a powerful appeal to those present, whereupon two rose, testifying their desire to obtain salvation through Christ.

Praise for His Great Mercies—"I do praise God that by the instrumentality of our dear Pastor's preaching the Gospel of God's great Salvation, it has been the means of my husband's and my own conversion; and I do thank our dear Lord for His great mercies to us.—A. B. & M. C. B.

Felt quite ready—Miss Edward's writes: "A woman whom I have been visiting for some six months has just died. A very sad case, five children left, one a baby three months old. She being unable to attend to their wants, I did what I could for her and the baby, till within a fortnight of her death. When I returned from a brief rest I found she had passed away. Her last words to me were, "I feel quite ready if the Lord should call."

At the eleventh hour.—Miss Pearson writes: The death recorded this week is that of a woman I was requested to visit a short time ago. I found her very ill, and upon questioning her concerning her soul, she admitted her sinful

119

Pastor unpaid. 2 Sisters are only paid agents (Their maintenance only cost £41.12 - in the year ending Sept 97) or 16/- a week for the two). 9 or 10 other workers.

Mission is organised as a church: the Lord's Supper twice a month. Membership 91.

Sunday evening service averages 60 - a room full - and they want to throw the passage into the shop so as to have more accommodation. Mostly poor people - some majority women - some bring their babies. Found it difficult to get strangers in or to reach the men.

Get a good proportion of men at the Bible classes. Christian Endeavour Society - 37 members of whom 28 are active. Children's Service on Wed - about 50 - a mixed lot some very poor, other fairly dressed.

Many open air meetings in the neighbourhood. Held in Alexander, Cornwallis, Cottenham, Devonshire Milford + Windsor Roads. Also in Finsbury Park on Sunday morning. About 100 held this year.

Persons Employed

Memberships

Notes on Meetings

12

condition, and desired to make peace with God. In a few words I endeavoured to point her to the Lamb of God. She was too ill to say much, and after a few words of prayer I left promising to sit with her in the afternoon while her daughter got a little sleep. I went as promised, but was refused admission on the ground the Doctor had said "she must be kept very quiet." Miss Edwards called the following day, and after some considerable difficulty was allowed to see her for just five minutes, and this only on the condition that the sick woman should not be permitted to speak. She died that same evening at 11 p.m., and we have reason to believe that she found mercy at the eleventh hour.

Found pardon.—A week or two ago we received a cheering letter from a dear Brother, from which we extract the following:—"Dear Friends, before I was converted I was too fond of drink and other worldly pleasures. Many a time had I tried in my own strength to give them up, and failed: but, Glory be to God, one day, with my heart full of sorrow I made my way to the Mission, and there I found pardon, and God has given me strength to continue until now, and I believe will to the end.—J. W.

Pastoral.—"I am pleased to record the blessing of God upon special efforts to reach the unsaved by visiting their homes, and, by personal appeal, endeavour to lead them to Christ for salvation. The result has been that eight persons have made profession of conversion, three of these (all men) being in one week, last February. With such limited space, we cannot enter into the details of these interesting cases, be it sufficient to state that they are all standing well to-day. 'To God be the Glory, great things He hath done.'—Henry Bird."

13

An Appeal.

The Committee has always endeavoured to render the Mission self-supporting, and, considering their social position, the Members have generously contributed to this end. But the sum raised within our own borders is altogether inadequate to sustain the work. Every penny is wisely expended, but to further economise would mean retrenchment. The bare thought of this appals us as we reflect on the needs of the neighbourhood, and therefore we are obliged, however reluctantly, to solicit the practical sympathy of friends further afield—those who value the souls of men, and are able to assist us in seeking their salvation. Let the memory of God's "Unspeakable Gift" dispose the reader to lessen the financial strain that at present burdens the workers, and materially hinders the work.

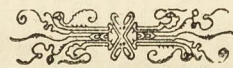

119
Pastor unpaid. 2 Sisters are only paid agents (their maintenance only cost £41.12 - in the year ending Sept 97) or 16/- a week for the two). 9 or 10 other workers.

Mission is organised as a church: the Lord's Supper twice a month. Membership 91.

Sunday evening service averages 60 - a room full - and they want to throw the passage into the shop so as to have more accommodation. Mostly poor people - some majority women - some bring their babies. Find it difficult to get strangers in or to reach the men.

Get a good proportion of men at the Bibleclasses. Christian Endeavour Society - 37 members of whom 28 are active. Children's Service on Wed - about 50 - a mixed lot some very poor, other fairly dressed.

Many open air meetings in the neighbourhood. Held in Alexander, Cornwallis, Cottenham, Devonshire Milford + Windsor Roads. Also in Fensbury Park on Sunday morning. About 100 held this year.

Persons Employed

Memberships

Notes on Meetings

Subscriptions.

Donations and

	£	s.	d.
A friend, per Mr. Wood	2	6	0
Ancell, Mr.	1	0	0
Barlow, Mr. W.	1	0	0
Bassett, Miss	5	0	0
Berry, Mrs.	2	10	0
Brazier, Mr. F. J.	1	8	0
Budd, G. Esq.	4	2	0
Bullock, Mr.	1	10	0
Callow, W. H. Esq.	1	1	0
Carter, Mrs.	3	0	0
Charrot, Mrs.	15	0	0
Do. for Poor Distribution	10	0	0
Do. do.	10	0	0
Daborn, Mrs.	10	0	0
Dell, Mr. H. J.	10	0	0
Doggrell, Mrs.	1	0	0
Dore, S. L. Esq.	10	0	0
Dorcas Society, Ladies of - for Poor Distribution	4	6	6
Freeman, Mr. F. K., F. G. S.	5	0	0
Garbanati, Miss	1	0	0
Greenwood, Mr. C. C.	1	2	0
Mr. W. R.	1	0	0
Mr. W. R. Special for Poor	2	10	0
" Distribution	1	0	0
Hossock, Miss	1	0	0
Jenkins, Mr.	5	0	0
Keating, Miss	2	6	0
Leaver, Mrs.	5	0	0
Matthew, Mrs.	1	0	0
Menetrey, Mrs.	5	0	0
Mitchell, Mr.	1	1	0
Moore, Mrs. Wilton	1	0	0
Morgan, Mrs.	1	0	0
Olding, Mr.	1	0	0
Parkinson, Mr. W. C., L.C.C.	2	0	0
Pearson, Miss	2	0	0
Purdon, Mrs.	16	0	0
Readers of "Christian, per Morgan and Scott, Xmas help for poor do. Children's Day	1	0	0
Do. in the Country	1	0	0
Reckitt, F. Esq.	1	0	0
Shorer, Miss	10	0	0
Smith, Thos. Esq.	6	0	0
Smith, Misses E. & L.	5	0	0
Stone, H. Esq.	1	4	0
Thank-offering A	2	0	0
Torrance, Mr. A. M., J.P., L.C.C.	5	0	0
White, Mrs. T. Eversham	10	0	0
Wood, Mr.	5	0	0
Y.P.S.C.E. Society	18	0	0
Do. for poor distribution	2	0	0
Do.	49	11	5
For Repairs to Harmonium Carriage -			
Andrews, Mr. C.	5	0	0
Brazier, Mr. F. J.	7	6	0
Burch, Miss (collected)	6	8	0
Classy, Mrs.	2	6	0
Four Friends	11	6	0
Grace, Mr.	1	0	0
Mather, Mrs.	5	0	0
Purdon, Mrs.	15	9	1
Richardson, Miss	1	0	0
Roberts, Mrs.	6	1	1
Selzer, Mrs.	1	2	2
Shelton, Mrs.	4	5	0
Shirley, Mrs.	1	6	0
Shorter, Miss	1	4	0
Smith, Misses E. & L.	1	5	3
Swin, Mrs.	1	0	0
Symes, Mr.	1	0	0
Townsend, Mr.	6	5	1
Wyvyan, Miss R.	8	11	1
Wyvyan, Mr. J. J.	15	2	0
Wyvyan, Mrs.	5	9	1
Walker, Mr.	7	10	0
Walker, Mr.	2	10	0
Wells, Mrs.	2	10	0
Williamson, Miss E.	5	1	0
Williamson, Mrs.	14	6	1
Wood, Mr.	1	2	0
Y.P.S.C.E. Working Meeting	2	18	11
Do.	2	18	11
£ 51 10 7			

Collecting Cards and Boxes.



	£	s.	d.
By Akers, Miss	17	6	1
Austen, Mr.	2	0	1
Beebe, Misses	13	5	1
Bird, Mr. H. J.	1	5	7
Brazier, Mr. F. J.	2	17	1
Brinkman, Mrs.	11	2	1
Brown, Miss	1	10	6
Bullock, Mr.	1	2	1
Classy, Mrs.	1	18	0
Cooke, Mrs.	3	6	0
Davis, Misses	2	10	0
Glaze, Miss	1	3	10
Gordon, Miss	1	1	6
Grace, Mr.	1	1	6
Hamden, Mrs.	6	4	0
Hewson, Mrs. F.	2	10	0
Jacobs, Miss A.	5	11	0
Mallett, Mrs.	11	9	0
Millard, Mrs.	7	7	0
Must, Miss A.	1	1	9
Padbury, Mrs.	5	9	0
Peacock, Mr.	5	0	4
Peppitt, Mrs.	8	4	0
Phillips, Mrs.	2	4	0
Purdon, Mrs.	15	9	1
Richardson, Miss	1	0	0
Roberts, Mrs.	6	1	1
Selzer, Mrs.	1	2	2
Shelton, Mrs.	4	5	0
Shirley, Mrs.	1	6	0
Shorter, Miss	1	4	0
Smith, Misses E. & L.	1	5	3
Swin, Mrs.	1	0	0
Symes, Mr.	1	0	0
Townsend, Mr.	6	5	1
Wyvyan, Miss R.	8	11	1
Wyvyan, Mr. J. J.	15	2	0
Wyvyan, Mrs.	5	9	1
Walker, Mr.	7	10	0
Walker, Mr.	2	10	0
Wells, Mrs.	2	10	0
Williamson, Miss E.	5	1	0
Williamson, Mrs.	14	6	1
Wood, Mr.	1	2	0
Y.P.S.C.E. Working Meeting	2	18	11
Do.	2	18	11
£ 51 10 7			

Pastor unpaid. 2 Sisters are only paid agents (their maintenance only cost £41.12 - in the year ending Sept 97) or 16/- a week for the two). 9 or 10 other workers.

Mission is organised as a church: the Lord's Supper twice a month. Membership 91.

Sunday evening service averages 60 - a room full - and they want to throw the passage into the shop so as to have more accommodation. Mostly poor people - some majority women - some bring their babies. Find it difficult to get strangers in or to reach the men.

Get a good proportion of men at the Bible classes. Christian Endeavour Society - 37 members of whom 28 are active. Children's Service on Wed - about 50 - a mixed lot some very poor, other fairly dressed.

Many open air meetings in the neighbourhood. Held in Alexander, Cornwallis, Cottenham, Devonshire Milford + Windsor Roads. Also in Finsbury Park on Sunday morning. About 100 held this year.

Persons Employed

Memberships

Notes on Meetings

Pastor unpaid. 2 Sisters are only paid agents (Their maintenance only cost £41.12 - in the year ending Sept 97) or 16/- a week for the two). 9 or 10 other workers.

Mission is organised as a church: the Lord's Supper twice a month. Membership 91.

Sunday evening service averages 60 - a room full - and they want to throw the passage into the shop so as to have more accommodation. Mostly poor people - some majority women - some bring their babies. Found it difficult to get strangers in or to reach the men.

Get a good proportion of men at the Bibleclasses. Christian Endeavour Society - 37 members of whom 28 are active. Children's Service on Wed - about 50 - a mixed lot some very poor, other fairly dressed.

Many open air meetings in the neighbourhood. Held in Alexander, Cornwallis, Cottenham, Devonshire Milford + Windsor Roads. Also in Finsbury Park on Sunday morning. About 100 held this year.

BALANCE SHEET

For the Tenth Financial Year ending September 30th, 1897.

By Cr.		To Dr.	
Balance brought forward	£ 1 14 7½	Mission Sisters' Maintenance	£ 41 12 0
Donations & Subscriptions	51 10 7	Rent of Holloway Hall	27 2 6
Collected by Cards and Boxes	28 6 8½	Rent of Mission House less Tax (3 quarters)	28 18 11
Collections at Meetings	36 9 6	Rates and Taxes for Mission House	4 11 2½
Rent of Room	9 2 0	Gas and Water a/c	4 0 0
Proceeds of Tea Meetings, etc.	5 10 6½	Printing	4 5 6
		Alterations to Mission Room	1 10 0
		Repairs to Harmonium	2 1 6
		Carriage	2 3 6
		Cost of Annual Tea	12 0
		Communion Wine	4 4 6
		½ Doz. Collecting Boxes	1 1 1½
		Sundry Amounts	9 13 3
		Poor Distribution	4 18 0
		Balance carried forward	
	£132 14 0		£132 14 0

Examined and found correct,
J. J. VVYAN,
6, Montpelier Road, N.
October 17th, 1897.

Visitation

Visitation is however the main work, the two sisters visiting within an area bounded roughly by Seven Sisters Road, Holloway Road, the Midland Railway, Hornsey & Andover Roads. A few cases are visited beyond these bounds as at Yerbury Road. The following extract is from the Annual Report.

Samaritan Work.

Explanation of this branch of our work is scarcely necessary, it is so well-known throughout Holloway. The untiring energy of our two Missionaries, who have now for many years devoted themselves entirely to this Christ-like sphere of service, has been the simple fulfilment of the Scriptures, in speaking a word in season to the weary, comforting those who are cast down, and pointing the sick and sinful to the Great Physician.

Some idea of what has been done can be gathered from the following statistics:—

Visits to Families (largely among the Sick)...	No. 2,237
" " Hospitals, Public Houses, &c. ...	43
Distribution of Tracts and Booklets ...	2,084
Garments Distributed ...	89
Cases Helped with Coals, Food, or Money ...	328

The large cards (p 117) are distributed and the people send to the Mission House. When the calls are not sufficient to keep them employed, the sisters visit a street from house to house - taking the 'most needy' streets first. Beside visitation and nursing, they do anything that is needed in the house etc for the sick; make them puddings etc. to take to them.

As to their methods of work, they appear to act very much on their own initiative both as to

Charitable Relief

The Poor Streets

Campbell Rd

to visitation & relief given. The Relief is not much in amount, only £9.13.3 appearing in the year's accounts, but in addition some small sums are given to the sisters for this purpose and some members of the British Women's Temperance Assⁿ make garments for the poor - 50 cases assisted in this way.

Relief is mainly given to cases of illness, milk provided ~~when~~ ordered by the doctor; groceries to a few old people.

Visitation Cases of sickness are reckoned the more important and visited as often as necessary: old folks etc once a week or even longer intervals. Does not think any cases of sickness are overlooked. Lodgers are mostly likely to be missed. Landladies will not always let you go to them so it is a work of time.

Other visitors in the district are the Scripture Reader from St Marks in Mutford Road. Two ladies from St John's on the west side & the St Stephen's Scripture Reader.

All thought Campbell Road, the worst in the district, although a few respectable people live there,

Ellenborough Road

Cottenham Road

Causes of Distress

After that come Ellenborough & Cottenham Roads.
In Ellenborough Road, the men are labourers, wood-choppers, painters & white washers. Every house is let out, 4 or more families, with old people or man and wife in back rooms. Small back room 2/3 a week.

In Cottenham Road, people are rather better. Labouring men, cab drivers, a few policemen. Most of the women go out to work - charring. Three families one on each floor, sometime a fourth when you get a family in the front room and a single person in the back. Rents 2/- a room. Marcellus & Daubeny Roads are also poor. Ormsley Road is better. Much drinking in Marcellus and a lot of young girls "on the street". Most of the girls do some kind of work - many step cleaning, factory or laundry. Toy (tin) factory in the neighbourhood.

As to causes of distress, drunk, bad management & large families are the most prolific causes in the visitors estimation. I noticed a family - man wife & 2 children living in a back room

